

N. MEXICO OIL CONSERVATION COMMISSION

Well Location and Acreage Dedication Plat

Section A.

Date JANUARY 13, 1959

Operator SINCLAIR OIL & GAS COMPANY Lease W. F. CRIMM
Well No. 2-4 Unit Letter F Section 28 Township 38 NORTH Range 18 EAST NMPM
Located 1910 Feet From NORTH Line, 1650 Feet From WEST Line
County DEA G. L. Elevation _____ Dedicated Acreage 40 Acres
Name of Producing Formation SAN JUAN Pool 2800

1. Is the Operator the only owner* in the dedicated acreage outlined on the plat below?
Yes X No _____.
2. If the answer to question one is "no," have the interests of all the owners been consolidated by communitization agreement or otherwise? Yes _____ No _____. If answer is "yes," Type of Consolidation _____
3. If the answer to question two is "no," list all the owners and their respective interests below:

Owner

Land Description

ILLEGIBLE

Section B

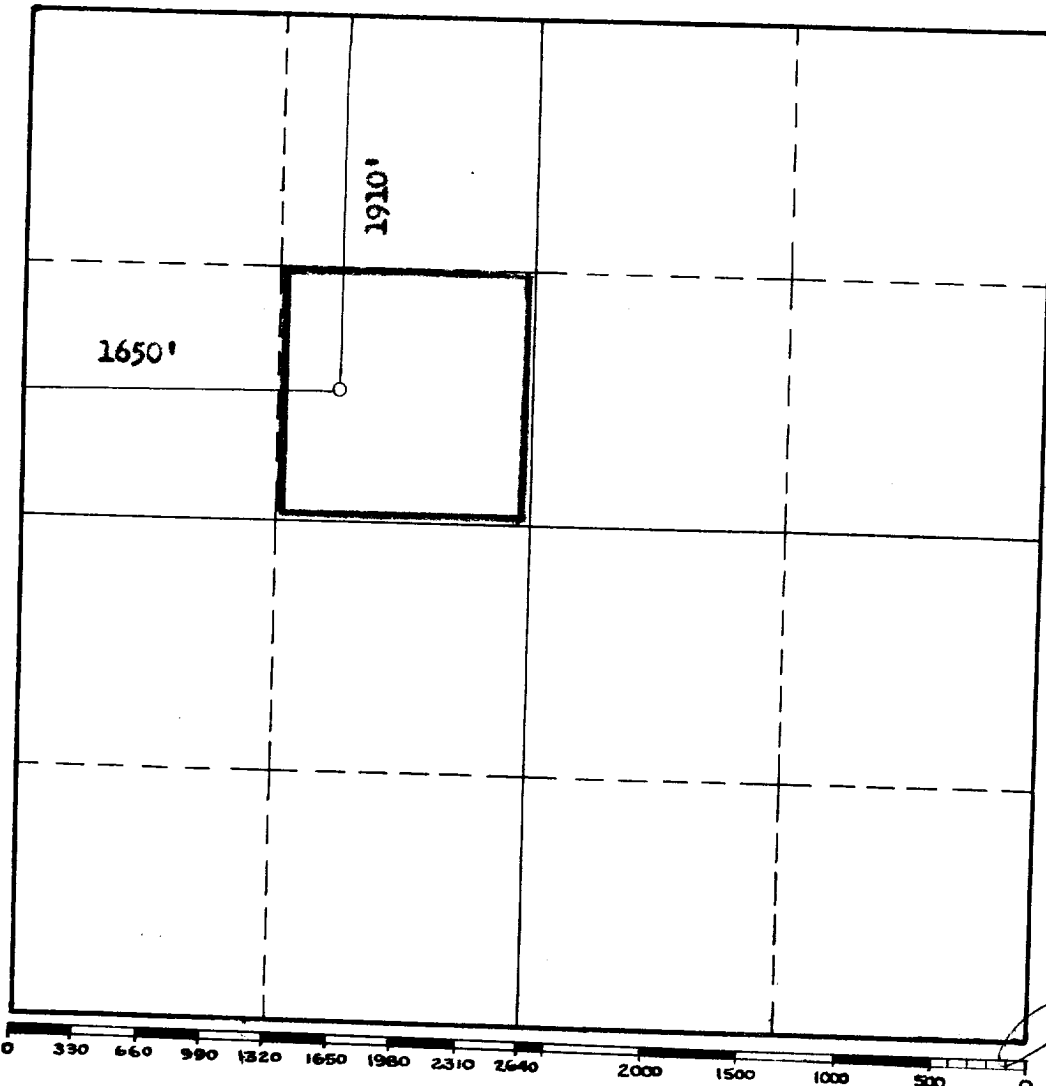

This is to certify that the information in Section A above is true and complete to the best of my knowledge and belief.

SINCLAIR OIL & GAS COMPANY

(Operator)

[Signature]

P. O. BOX 2470 (Representative)

MIDLAND, TEXAS

Address at [Signature]

This is to certify that the well location shown on the plat in Section B was plotted from field notes of actual surveys made by me or under my supervision and that the same is true and correct to the best of my knowledge and belief.

Date Surveyed 1/17/59

[Signature]
Registered Professional
Engineer and/or Land Surveyor.

(See instructions for completing this form on the reverse side)

Certificate No. 676

Abstract

- Injection practice
9-18-86

2/18/81
Jackson Profile
3/29/84
Jackson Log