

NOTICE OF INTENTION TO DRILL

Notice must be given to the District Office of the Oil Conservation Commission and approval obtained before drilling or recompletion begins. If changes in the proposed plan are considered advisable, a copy of this notice showing such changes will be returned to the sender. Submit this notice in QUINTUPPLICATE. One copy will be returned following approval. See additional instructions in Rules and Regulations of the Commission. If State Land submit 6 Copies Attach Form G- 128 in triplicate to first 3 copies of form G-101

Hobbs, New Mexico
(Place)

November 17, 1961
(Date)

OIL CONSERVATION COMMISSION
SANTA FE, NEW MEXICO

Gentlemen:

You are hereby notified that it is our intention to commence the Drilling of a well to be known as

C. W. TRAINER

(Company or Operator)

Hobbs

(Lease)

Well No. 1, in H The well is

(Unit)

located 2485 feet from the North line and 1184 feet from the

East line of Section 34, T. -18-S, R. -38-E, NMPM.

(GIVE LOCATION FROM SECTION LINE)

Hobbs

Pool, Lee County

If State Land the Oil and Gas Lease is No.

If patented land the owner is C. W. Trainer

Address

We propose to drill well with drilling equipment as follows: Cable tools to 240'.

Rotary to TD.

The status of plugging bond is Blanket Bond in Force

Drilling Contractor Ed Burk

We intend to complete this well in the San Andres

formation at an approximate depth of 4300 feet.

CASING PROGRAM

We propose to use the following strings of Casing and to cement them as indicated:

Size of Hole	Size of Casing	Weight per Foot	New or Second Hand	Depth	Sacks Cement
<u>11"</u>	<u>8 5/8"</u>	<u>24#</u>	<u>New</u>	<u>350</u>	<u>350</u>
<u>7 7/8"</u>	<u>5 1/2"</u>	<u>15.5#</u>	<u>New</u>	<u>4300</u>	<u>500</u>

If changes in the above plans become advisable we will notify you immediately.

ADDITIONAL INFORMATION (If recompletion give full details of proposed plan of work.)

This well is being drilled at an unorthodox location under NMCC Case 2396, Order R-2083, and will be directionally drilled to a bottom hole location 2310' FNL and 990' FEL of Section 34.

Approved....., 19.....
Except as follows:

OIL CONSERVATION COMMISSION

By Joe V. Ramez

Sincerely yours,

C. W. TRAINER

(Company or Operator)

By

C. W. Trainer

Position

Owner - Operator
Send Communications regarding well to

Name

C. W. TRAINER

Address

Box 2323, Hobbs, New Mexico

NEW MEXICO OIL CONSERVATION COMMISSION
WELL LOCATION AND ACREAGE DEDICATION PLAT

FORM C-128
 Revised 5-1-57

SEE INSTRUCTIONS FOR COMPLETING THIS FORM ON THE REVERSE SIDE

SECTION A

Operator C.W. Trainer			Lease Hobbs		Well No. 1
Unit Letter H	Section 34	Township 18 South	Range 38 East	County Lea	
Actual Footage Location of Well: 2485 feet from the North line and 1184 feet from the East line					
Ground Level Elev. 3620.32	Producing Formation San Andres		Pool Hobbs	Dedicated Acreage 40 Acres	

1. Is the Operator the only owner in the dedicated acreage outlined on the plat below? **X** YES. (Owner means the person who has the right to drill into and to produce from any pool and to appropriate the production either for himself or for himself and another. (65-3-29 (e) NMSA 1935 Comp.)
2. If the answer to question one is "no," have the interests of all the owners been consolidated by a communitization agreement or otherwise? YES _____ NO _____. If answer is "yes," Type or Consolidation _____
3. If the answer to question two is "no," list all the owners and their respective interests below _____

Owner	Acad Description

SECTION B

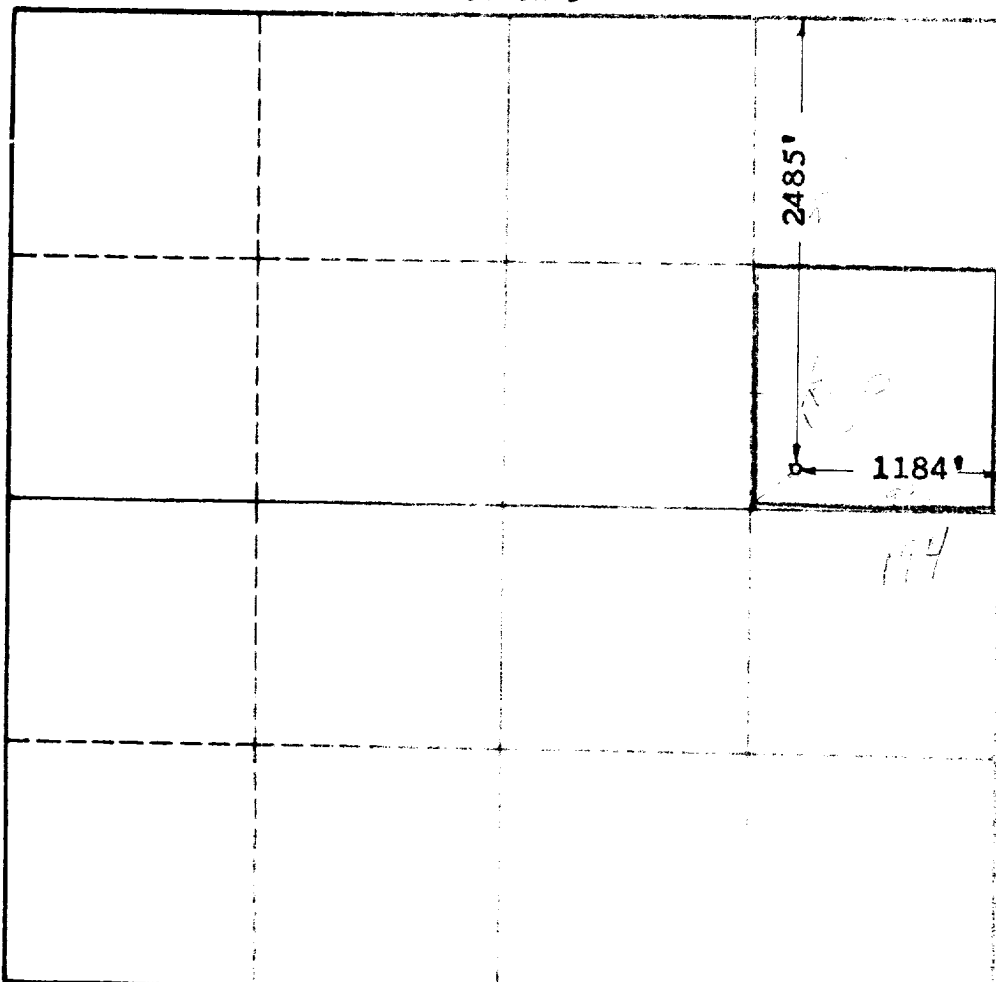

CERTIFICATION

I hereby certify that the information in SECTION A above is true and complete to the best of my knowledge and belief.

Signature C.W. Trainer
Position Owner-Operator
Company C.W. TRAINER
Date Nov 17, 1961

I hereby certify that the well location shown on the plat in SECTION B was picked from field notes of actual survey made by **676** or under my supervision, and that the same is true and correct to the best of my knowledge and belief.

Date Surveyed 8-23-61
Registered Professional Engineer and/or Land Surveyor, JOHN W. WEST
Signature John W. West
Plate No. N.M.P.E. & L.S. NO. 876

0 330 660 990 1320 1650 1980 2310 2640 2970 3300 3630 3960 4290 4620 4950 5280 5610 5940 6270 6600