

NEW MEXICO OIL CONSERVATION COMMISSION  
Well Location and Acreage Dedication Plat

Section A.

Date 8-19-1957

Operator Great Western Drilling Company Henry McQueen  
Well No. 2 Unit Letter F Section 8 Township 18 South Range 39 East NMPM  
Located 1650 Feet From North Line, 2310 Feet From West Line  
County Lea G. L. Elevation 3628.8 Dedicated Acreage 40 Acres  
Name of Producing Formation San Andres Pool South Carter (San Andres)

1. Is the Operator the only owner\* in the dedicated acreage outlined on the plat below?  
Yes ☒ No ☐.
2. If the answer to question one is "no," have the interests of all the owners been consolidated by communitization agreement or otherwise? Yes ☐ No ☐. If answer is "yes," Type of Consolidation \_\_\_\_\_
3. If the answer to question two is "no," list all the owners and their respective interests below:

Owner

Land Description

Section B

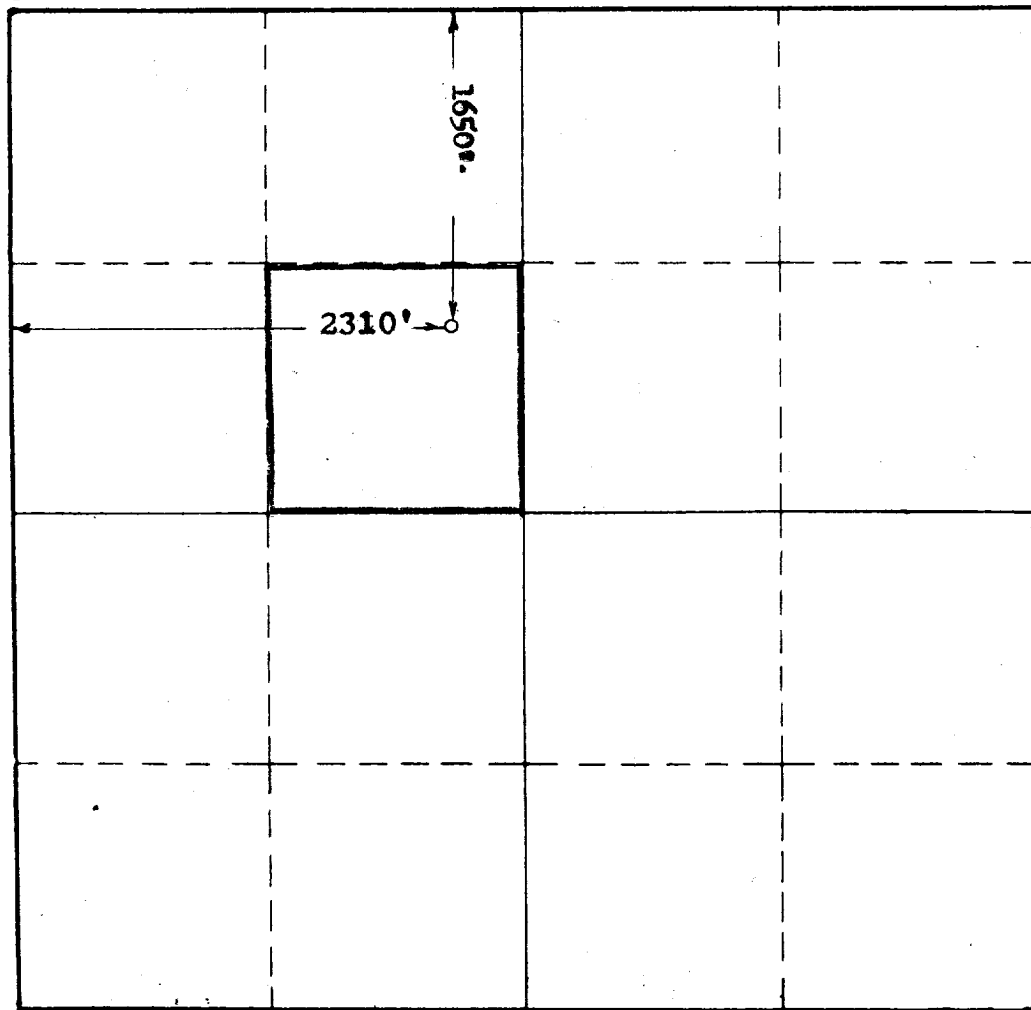

This is to certify that the information in Section A above is true and complete to the best of my knowledge and belief.

Great Western Drilling Company  
(Operator)

McQueen  
(Representative)

Box 1659, Midland, Texas  
Address

This is to certify that the well location shown on the plat in Section B was plotted from field notes of actual surveys made by me or under my supervision and that the same is true and correct to the best of my knowledge and belief.

Date Surveyed 8-19-1957

[Signature]  
Registered Professional  
Engineer and/or Land Surveyor.

Certificate No. 676