

N.

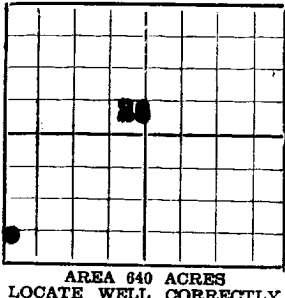

NEW MEXICO STATE LAND OFFICE
SANTA FE, NEW MEXICO

DEPARTMENT OF THE STATE GEOLOGIST

WELL RECORD

Mail to State Geologist, Santa Fe, New Mexico, not more than ten days after completion of well. Indicate questionable data by following it with (?). Submit in duplicate.

Company **Shell Petroleum Corporation** Address **Hobbs, New Mexico.**

Send correspondence to **W D Grimes** Address **Hobbs**

Well No. **1** in **8 1/4** of Sec. **28**, T. **10 S**, R. **30 E**, N. M. P. M., **Hobbs** Oil Field **Lea** County.

If State land the oil and gas lease is No. _____ Assignment No. _____

If patented land the owner is **W D Grimes** Address **Hobbs, N. M.**

The lessee is **Shell Petroleum Corporation** Address **" "**

If not state or patented land, give status _____

Drilling commenced **7-30-30** 19____ Drilling was completed **9-30-30** 19____

Name of drilling contractor **Noble Drilling Company** Address **Hobbs, N. M.**

Elevation above sea level at top of casing **3647** feet.

The information given is to be kept confidential until _____ 19____

OIL SANDS OR ZONES

No. 1, from 2770	to 2885 2845	No. 4, from 3633 1/2	to 3637
No. 2, from 3150	to 3165	No. 5, from 4028	to 4028
No. 3, from _____	to _____	No. 6, from 4140	to 4155

IMPORTANT WATER SANDS

No. 1, from _____	to _____	No. 3, from _____	to _____
No. 2, from _____	to _____	No. 4, from _____	to _____

CASING RECORD

SIZE	WEIGHT PER FOOT	THREADS PER INCH	MAKE	AMOUNT	KIND OF SHOE	CUT AND PULLED FROM	PERFORATED		PURPOSE
							FROM	TO	
1 1/2"	20	8		285	TEX PATENT				
2-3/8"	36	8		2750	Baker Float				
7"	24	10		3900	"	"			

MUDDING AND CEMENTING RECORD

SIZE	WHERE SET	NO. SACKS OF CEMENT	METHODS USED	MUD GRAVITY	AMOUNT OF MUD USED
1 1/2"	285	200 2/3 LBS	Ballston		hole full
2-3/8"	2750	600 2/3	"		" "
7"	3900	225 2/3	"		" "

PLUGS AND ADAPTERS

Heaving plug—Material _____ Length _____ Depth Set _____

Adapters—Material _____ Size _____

SHOOTING RECORD

SIZE	SHELL USED	EXPLOSIVE USED	QUANTITY	DATE	DEPTH SHOT	DEPTH CLEANED OUT

TOOLS USED

Rotary tools were used from **0** feet to **4175** feet, and from _____ feet to _____ feet

Cable tools were used from _____ feet to _____ feet, and from _____ feet to _____ feet

PRODUCTION

Put to producing **10/1/30** 19____

The production of the first 24 hours was **22 X 256** barrels of fluid of which **100** % was oil; _____ % emulsion; _____ % water; and _____ % sediment. Gravity, Be _____

If gas well, cu. ft. per 24 hours **58,940,000** Gallons gasoline per 1,000 cu. ft. of gas **1400**

Rock pressure, lbs. per sq. in. _____

EMPLOYEES

_____, Driller _____, Driller

_____, Driller _____, Driller

FORMATION RECORD ON OTHER SIDE

I hereby swear or affirm that the information given herewith is a complete and correct record of the well and all work done on it so far as can be determined from available records.

Subscribed and sworn to before me this _____ Name _____

day of _____, 19____ Postion _____

_____, Notary Public. _____, Company or Operator

My commission expires _____

FORMATION RECORD

FROM	TO	THICKNESS IN FEET	FORMATION
9	90	81	Hard Sand
90	100	10	Shells and sand
100	120	20	Water and sand
120	124	4	Shells
124	220	96	Hard Sand
220	224	4	Shells
224	244	20	Red Bed
244	264	20	Red Bed & shells
264	280	16	Red Bed
280	1000	720	Shale
1000	1200	200	Red Bed & shells
1200	1204	4	Hard Shells
1204	1212	8	Shale
1212	1220	8	Shale and Shells
1220	1224	4	Sand and other ash
1224	1400	176	Shale and sand
1400	1404	4	Broken ash
1404	1408	4	Shale
1408	1412	4	Lime and ash
1412	1416	4	Potash and ash
1416	1420	4	Broken ash
1420	1424	4	Shale
1424	1428	4	Salt and Potash
1428	1432	4	Lime and shale broken
1432	1436	4	Hard broken ash
1436	1440	4	Shale and lime
1440	1444	4	Hard ash
1444	1448	4	Shale
1448	1452	4	Sandy lime show Gas Top Buff lime 1452
1452	1456	4	Shale and broken lime
1456	1460	4	Shale and lime shells
1460	1464	4	Broken sand low Gas
1464	1468	4	Shale
1468	1472	4	Broken lime and ash
1472	1476	4	Shale and shells
1476	1480	4	Broken lime and ash
1480	1484	4	Shale lime and shells
1484	1488	4	Sand - show oil low Gas
1488	1492	4	Broken lime and ash
1492	1496	4	Shale and shale other
1496	1500	4	Broken lime shells and ash
1500	1504	4	Broken ash
1504	1508	4	Shale
1508	1512	4	Gas sand Gas cleaned the hole
1512	1516	4	Shale
1516	1520	4	Broken ash
1520	1524	4	Shale lime and shells
1524	1528	4	Lime
1528	1532	4	Broken lime and ash
1532	1536	4	Lime
1536	1540	4	Lime
1540	1544	4	Broken lime and ash
1544	1548	4	Broken lime
1548	1552	4	Lime
1552	1556	4	Gray lime
1556	1560	4	Forous lime show Gas
1560	1564	4	White lime (to 1564)
1564	1568	4	Brown lime show oil and gas - lost some structure
1568	1572	4	Forous lime
1572	1576	4	Forous lime

U175
8950
213