

SANTA FE	
P.O. BOX	
U.S.G.S.	
LAND OFFICE	
TRANSPORTER	OIL
	GAS
PRORATION OFFICE	
OPERATOR	

NEW MEXICO OIL CONSERVATION COMMISSION
Santa Fe, New Mexico

Form C-101
Revised (12/1/55)

NOTICE OF INTENTION TO DRILL

HOBBS OFFICE 000

Notice must be given to the District Office of the Oil Conservation Commission and approval obtained before drilling or recompletion begins. If changes in the proposed plan are considered advisable, a copy of this notice showing such changes will be returned to the sender. Submit this notice in **QUINTUPLICATE**. One copy will be returned following approval. See additional instructions in Rules and Regulations of the Commission. If State Land submit 6 Copies Attach Form C- 128 in triplicate to first 3 copies of Form C-101

Hobbs, New Mexico

November 29, 1962

(Place)

(Date)

OIL CONSERVATION COMMISSION
SANTA FE, NEW MEXICO

Gentlemen:

You are hereby notified that it is our intention to commence the Drilling of a well to be known as

Pan American Petroleum Corporation

(Company or Operator)

State "CP"

(Lease)

Well No. 1, in D (Unit) The well is

located 994.3 feet from the North line and 330 feet from the West line of Section 1, T. 18-S, R. 32-E, NMPM.

(GIVE LOCATION FROM SECTION LINE)

Corbin Abo Pool, Lea County

If State Land the Oil and Gas Lease is No. E-8979

If patented land the owner is

Address

We propose to drill well with drilling equipment as follows: OTD with rotary tools

The status of plugging bond is Blanket bond on file with Commission

Drilling Contractor (to be furnished later)

We intend to complete this well in the Abo formation at an approximate depth of 8900' feet.

CASING PROGRAM

We propose to use the following strings of Casing and to cement them as indicated:

Size of Hole	Size of Casing	Weight per Foot	New or Second Hand	Depth	Sacks Cement
<u>17-1/2"</u>	<u>13-3/8"</u>	<u>32.6#</u>	<u>New</u>	<u>300</u>	<u>Circ.</u>
<u>12-1/4"</u>	<u>8-5/8"</u>	<u>24#</u>	<u>New</u>	<u>3200</u>	<u>(1)</u>
<u>7-7/8"</u>	<u>4-1/2"</u>	<u>9.5-11.6#</u>	<u>New</u>	<u>8900</u>	<u>(2)</u>

If changes in the above plans become advisable we will notify you immediately.

ADDITIONAL INFORMATION (If recompletion give full details of proposed plan of work.)

(1) Sufficient to fill to base of salt.

(2) Sufficient to cover 600' above pay.

Approved _____, 19____
Except as follows:

Sincerely yours,

Pan American Petroleum Corporation

Original Signed by (Company or Operator)

By V. E. STALEY

Position Area Superintendent

Send Communications regarding well to

Name V. E. Staley

Address Box 68 - Hobbs, New Mexico

OIL CONSERVATION COMMISSION

By _____

NEW MEXICO OIL CONSERVATION COMMISSION
WELL LOCATION AND ACREAGE DEDICATION PLAT

FORM C-128
Revised 5/1/57

HOBBS OFFICE 000

SEE INSTRUCTIONS FOR COMPLETING THIS FORM ON THE REVERSE SIDE

SECTION A

Operator PAN AMERICAN PET. CORP.		Lease 1962 NOV 30 AM 10:56		Well No. 1
Unit Letter D	Section 1	Township 18 SOUTH	Range 33 EAST	County LEA
Actual Footage Location of Well: 994.3 feet from the NORTH line and 330 feet from the WEST line				
Ground Level Elev. NYA	Producing Formation Abo	Pool Corbin Abo	Dedicated Acreage: 40 Acres	

1. Is the Operator the only owner in the dedicated acreage outlined on the plat below? YES ☒ NO ☐ ("Owner" means the person who has the right to drill into and to produce from any pool and to appropriate the production either for himself or for himself and another. (65-3-29 (e) NMSA 1935 Comp.)
2. If the answer to question one is "no," have the interests of all the owners been consolidated by communitization agreement or otherwise? YES ☐ NO ☐ If answer is "yes," Type of Consolidation _____
3. If the answer to question two is "no," list all the owners and their respective interests below:

Owner	Land Description

SECTION B

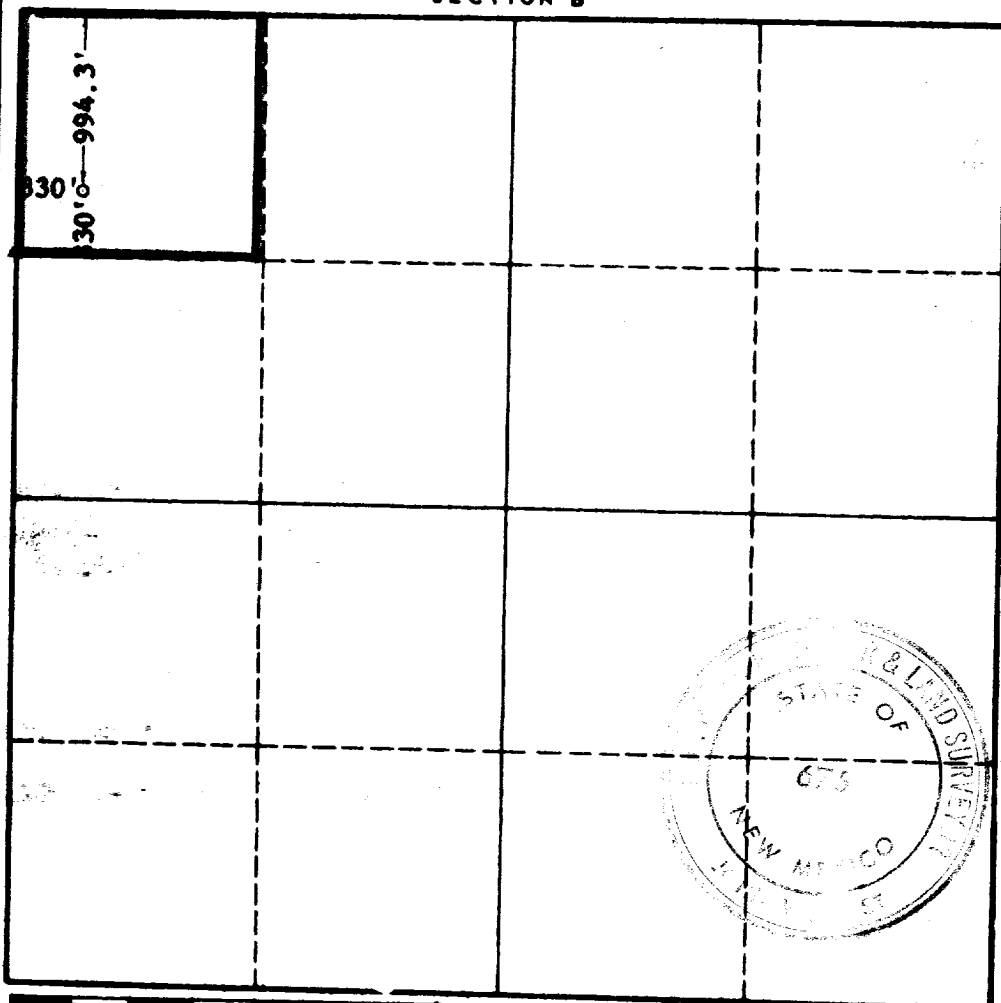

CERTIFICATION

I hereby certify that the information in SECTION A above is true and complete to the best of my knowledge and belief.

Name Original Signed by:
V. E. STALBY

Position

Area Superintendent
Company

Pan American Petroleum Corp.

Date

November 29, 1962

I hereby certify that the well location shown on the plat in SECTION B was plotted from field notes of actual surveys made by me or under my supervision, and that the same is true and correct to the best of my knowledge and belief.

Date Surveyed

NOVEMBER 27, 1962

Registered Professional Engineer
and/or Land Surveyor, **JOHN W. WEST**

John W. West

Certificate No.

N. M. - P. E. & L. S. NO. 678

0 330 660 990 1320 1650 1980 2310 2640 2000 1500 1000 500 0