

NUMBER OF COPIES RECEIVED	
DISTRIBUTION	
SANTA FE	
FILE	
U.S.G.S.	
LAND OFFICE	
TRANSPORTER	OIL GAS
PRORATION OFFICE	
OPERATOR	

NEW MEXICO OIL CONSERVATION COMMISSION
Santa Fe, New Mexico

Form C-101
Revised 12/1/55

NOTICE OF INTENTION TO DRILL

Notice must be given to the District Office of the Oil Conservation Commission ^{1963 JUL 17 PM 2:35} before drilling or recompletion begins. If changes in the proposed plan are considered advisable, a copy of this notice showing such changes will be returned to the sender. Submit this notice in QUINTUPLICATE. One copy will be returned following approval. See additional instructions in Rules and Regulations of the Commission. If State Land submit 6 Copies. Attach Form C-128 in triplicate to first 3 copies of Form C-101.

Midland, Texas

(Place)

July 16, 1963

(Date)

OIL CONSERVATION COMMISSION
SANTA FE, NEW MEXICO

***REVISED TO CHANGE LOCATION FROM 950' FEL TO 990' FWL.**

This Form C-101 supersedes Form C-101 dated 6/6/63.

Gentlemen:

You are hereby notified that it is our intention to commence the Drilling of a well to be known as

TEXACO INC.

(Company or Operator)

State of New Mexico "AE"

(Lease)

Well No. 10, in E The well is

(Unit)

located 1980 feet from the North line and 990 feet from the

West

line of Section 12, T-18-S, R-34-E, NMPM.

(GIVE LOCATION FROM SECTION LINE) Vacuum Abo Reef Pool, Lea County

D	C	B	A
E	F	G	H
L	K	J	I
M	N	O	P

If State Land the Oil and Gas Lease is No. B-1258-1

If patented land the owner is _____

Address _____

We propose to drill well with drilling equipment as follows: Rotary

The status of plugging bond is \$10,000 blanket surety bond of Maryland Casualty Co. filed with State Geologist.

Drilling Contractor Unknown at present

We intend to complete this well in the Abo Reef formation at an approximate depth of 8950 feet.

CASING PROGRAM

We propose to use the following strings of Casing and to cement them as indicated:

Size of Hole	Size of Casing	Weight per Foot	New or Second Hand	Depth	Sacks Cement
15"	11 3/4"	23.72 & 42	New	350'	300
10 5/8"	8 5/8"	24 & 32	New	3110'	1650*
7 7/8"	2 7/8"	6.5	New	8950'	1600**

*1500 sx. 1:1 Pozmix Portland reg. cmt. mixture w/8% gel followed by 150 sx. Portland Neat. **1300 sx.

If changes in the above plans become advisable we will notify you immediately. Class "C" 8% gel followed by 300 sx.

ADDITIONAL INFORMATION (If recompletion give full details of proposed plan of work.)

FORMATION TOPS EXPECTED:

Anhydrite 1650' Seven Rivers 2990' San Andres 4830'
Salt 1745' Queen 3950' Abo Reef 8105'
Yates 2785' Penrose 4150'

Class "C" 4% gel. The 4% gel mixture to contain friction reducing agent so turbulent flow can be approached with this batch.

Approved _____, 19____

Except as follows:

Sincerely yours,

TEXACO INC.
(Company or Operator)

By _____

Position J. J. Velten
Division Civil Engineer

Send Communications regarding well to

Name J. H. Markley

Address P. O. Box 3109, Midland, Texas

OIL CONSERVATION COMMISSION

Re _____

NEW MEXICO OIL CONSERVATION COMMISSION

WELL LOCATION AND ACREAGE DEDICATION PLAT

FORM C-128
Revised 5/1/57

SEE INSTRUCTIONS FOR COMPLETING THIS FORM ON THE REVERSE SIDE

SECTION A			
Operator TEXACO Inc.		Lease State of New Mexico "AE"	
Unit Letter E	Section 12	Township 18 South	Range 34 East
		County Lea	
Actual Footage Location of Well: 1980 feet from the North line and 990 feet from the West line Sec. 12			
Ground Level Elev. 3993	Producing Formation Abo Reef	Pool Vacuum Abo Reef	Dedicated Acreage: 40 Acres

1. Is the Operator the only owner in the dedicated acreage outlined on the plat below? YES ☒ NO ☐ ("Owner" means the person who has the right to drill into and to produce from any pool and to appropriate the production either for himself or for himself and another. (65-3-29 (e) NMSA 1935 Comp.)
2. If the answer to question one is "no," have the interests of all the owners been consolidated by communization agreement or otherwise? YES ☐ NO ☐ If answer is "yes," Type of Consolidation _____
3. If the answer to question two is "no," list all the owners and their respective interests below:

Owner	Land Description

SECTION B

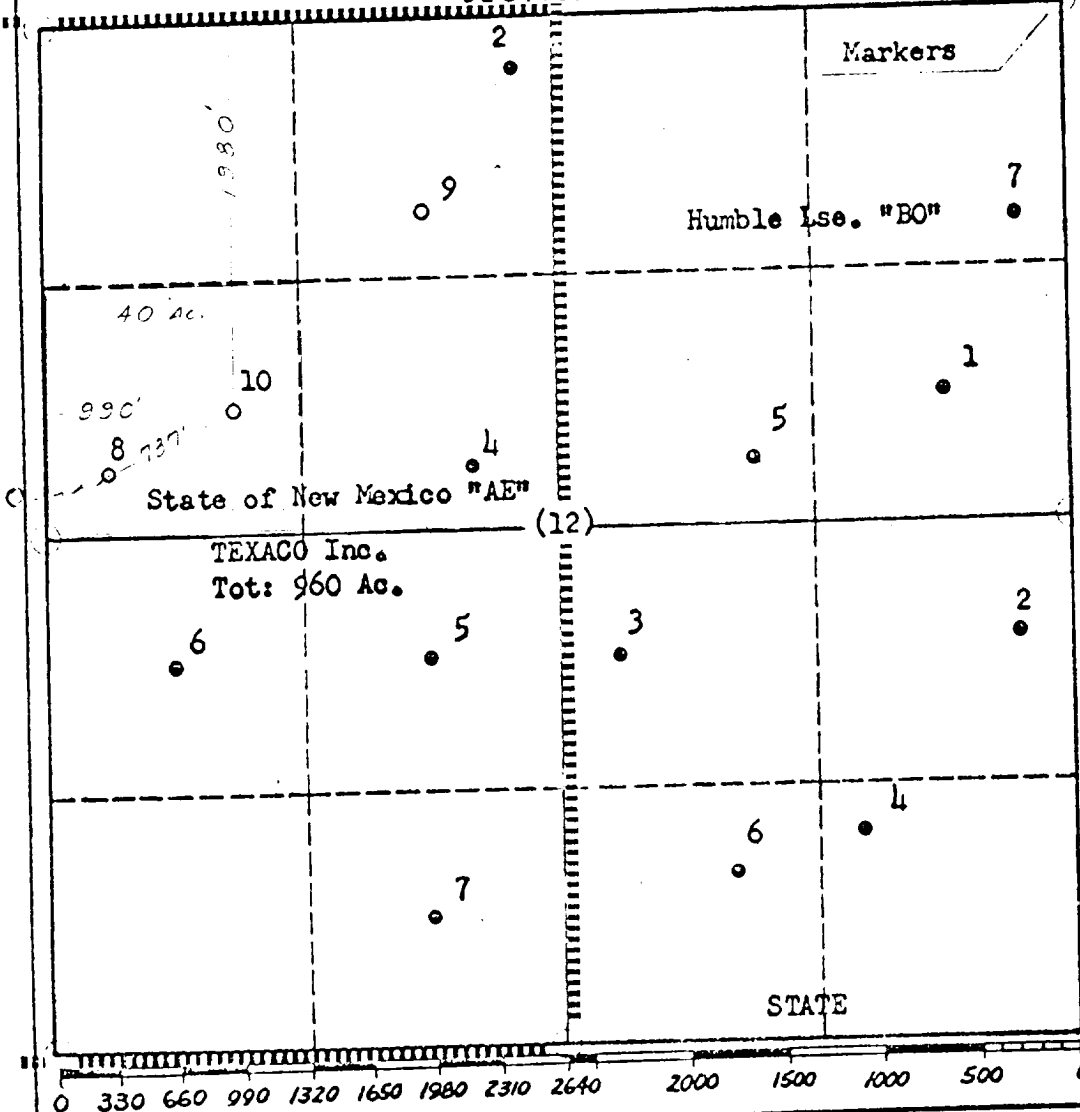

CERTIFICATION

I hereby certify that the information in SECTION A above is true and complete to the best of my knowledge and belief.

Name **J. J. Velten**
 Position **Division Civil Engineer**
 Company **TEXACO Inc.**
 Date **7/16/63**

I hereby certify that the well location shown on the plat in SECTION B was plotted from field notes of actual surveys made by me or under my supervision, and that the same is true and correct to the best of my knowledge and belief.

Date Surveyed **7/11/63**
 Registered Professional Engineer and/or Land Surveyor **J. J. Velten**
 Certificate No. **8174**