

## CONSERVATION DIVISION

P. O. BOX 2088  
SANTA FE, NEW MEXICO 87501Form C-101  
Revised 10-1-78

NO. OF COPIES RECEIVED	
DISTRIBUTION	
SANTA FE	
FILE	
U.S.G.S.	
LAND OFFICE	
OPERATOR	

5A. Indicate Type of Lease
STATE <input checked="" type="checkbox"/> FEE <input type="checkbox"/>
5. State Oil & Gas Lease No.
E-89779

## APPLICATION FOR PERMIT TO DRILL, DEEPEN, OR PLUG BACK

1a. Type of Work		7. Unit Agreement Name	
b. Type of Well DRILL <input type="checkbox"/> DEEPEN <input type="checkbox"/> PLUG BACK <input checked="" type="checkbox"/> OIL WELL <input checked="" type="checkbox"/> GAS WELL <input type="checkbox"/> OTHER <input type="checkbox"/> SINGLE ZONE <input type="checkbox"/> MULTIPLE ZONE <input type="checkbox"/>		8. Farm or Lease Name	
2. Name of Operator		State CP	
3. Address of Operator		9. Well No.	
Amoco Production Company		2	
4. Location of Well		10. Field and Pool, or Wildcat	
UNIT LETTER E LOCATED 1654.3 FEET FROM THE North LINE		E-K Yates	
AND 660 FEET FROM THE West LINE OF SEC. 1 TWP. 18-S RGE. 33-E NMPM		Seven Rivers, Queen	
		UNDESIGNATED	
		12. County	
		Lea	
		19. Proposed Depth	
		4400'	
		19A. Formation	
		Queen	
		20. Rotary or C.T.	
		Rotary	
11. Elevations (show whether DT, RT, etc.)		21A. Kind & Status Plug. bond	
4106' RDB		Blanket-on-file	
		21B. Drilling Contractor	
		N/A	
		22. Approx. Date Work will start	

## PROPOSED CASING AND CEMENT PROGRAM

SIZE OF HOLE	SIZE OF CASING	WEIGHT PER FOOT	SETTING DEPTH	SACKS OF CEMENT	EST. TOP
17-1/2"	13-3/8"	35.6#	318'	365	Surface
11"	8-3/8"	24# 32#	3002'	300	Unknown
7-7/8"	4-1/2"	9.5# 11.6#	8804'	1150	TCMT 2430'

Propose to abandon the Abo and recompleate to the Queen formation as follows:

MISU and kill well with brine water. Pull rods, pump and tbq. RIH with CIBP and set at 8630', cap with 18 sxs Class 'H' neat cmt (200'). Place a 200' cmt. plug from 6960'-6760' with 18 sxs Class 'H' neat cmt. Place a 300' cmt. plug from 4400'-4700' with 27 sxs Class 'H' neat cmt. Mud to be placed between plugs of a min. consistency of that obtained by mixing 25 sxs gal/100 bbls of water. Pul CBL from 5000'-3200' and in free pipe 300-100'. Squeeze brief will be issued if necessary. Perforate Queen interval 4120-60' with a 3-1/8" hollow carrier casing gun w/4JSPF. RIH with a 4-1/2" pkr. and a 2-7/8" workstring. Set pkr at 4020'. Swab and evaluate. Acidize as follows: Run base GR/Temp survey from 4350-3900'. Pump 4000 gals of 15% NEFE HCl acid tagged with R/A material. Flush acid to perfs with 18 bbls of fresh water. Run after acid treatment survey swab and evaluate.

0+5-NMOCD,H 1-J. R. Barnett, HOU Rm. 21.156 1-F. J. Nash, HOU Rm. 4.206 1-GCC

ABOVE SPACE DESCRIBE PROPOSED PROGRAM; IF PROPOSAL IS TO DEEPEN OR PLUG BACK, GIVE DATA ON PRESENT PRODUCTIVE ZONE AND PROPOSED NEW PRODUCTIVE ZONE. GIVE BLOWOUT PREVENTER PROGRAM, IF ANY.

I hereby certify that the information above is true and complete to the best of my knowledge and belief.

Signed Gary C. Clark Title Assist. Admin. Analyst Date 6/13/84

(This space for State Use)

ORIGINAL SIGNED BY JERRY SEXTON

PROVED BY DISTRICT 1 SUPERVISOR TITLE \_\_\_\_\_ DATE JUN 15 1984

NOTATIONS OF APPROVAL, IF ANY:

NEW MEXICO OIL CONSERVATION COMMISSION  
WELL LOCATION AND ACREAGE DEDICATION PLAT

Form C-102  
Supersedes C-128  
Effective 1-1-65

All distances must be from the outer boundaries of the Section.

Operator Amoco Production Company			Lease State CP		Well No. 2
Unit Letter E	Section 1	Township 18-South	Range 33-East	County Lea	
Actual Footage Location of Well: 1654.3 feet from the North line and 660 feet from the West line					
Ground Level Elev. 4091	Producing Formation Queen		Pool E-K Yates, Seven Rivers, Queen		Dedicated Acreage; 40 Acres

1. Outline the acreage dedicated to the subject well by colored pencil or hatchure marks on the plat below.
2. If more than one lease is dedicated to the well, outline each and identify the ownership thereof (both as to working interest and royalty).
3. If more than one lease of different ownership is dedicated to the well, have the interests of all owners been consolidated by communitization, unitization, force-pooling, etc?

☐ Yes ☐ No If answer is "yes," type of consolidation \_\_\_\_\_

If answer is "no," list the owners and tract descriptions which have actually been consolidated. (Use reverse side of this form if necessary.) \_\_\_\_\_

No allowable will be assigned to the well until all interests have been consolidated (by communitization, unitization, forced-pooling, or otherwise) or until a non-standard unit, eliminating such interests, has been approved by the Commission.

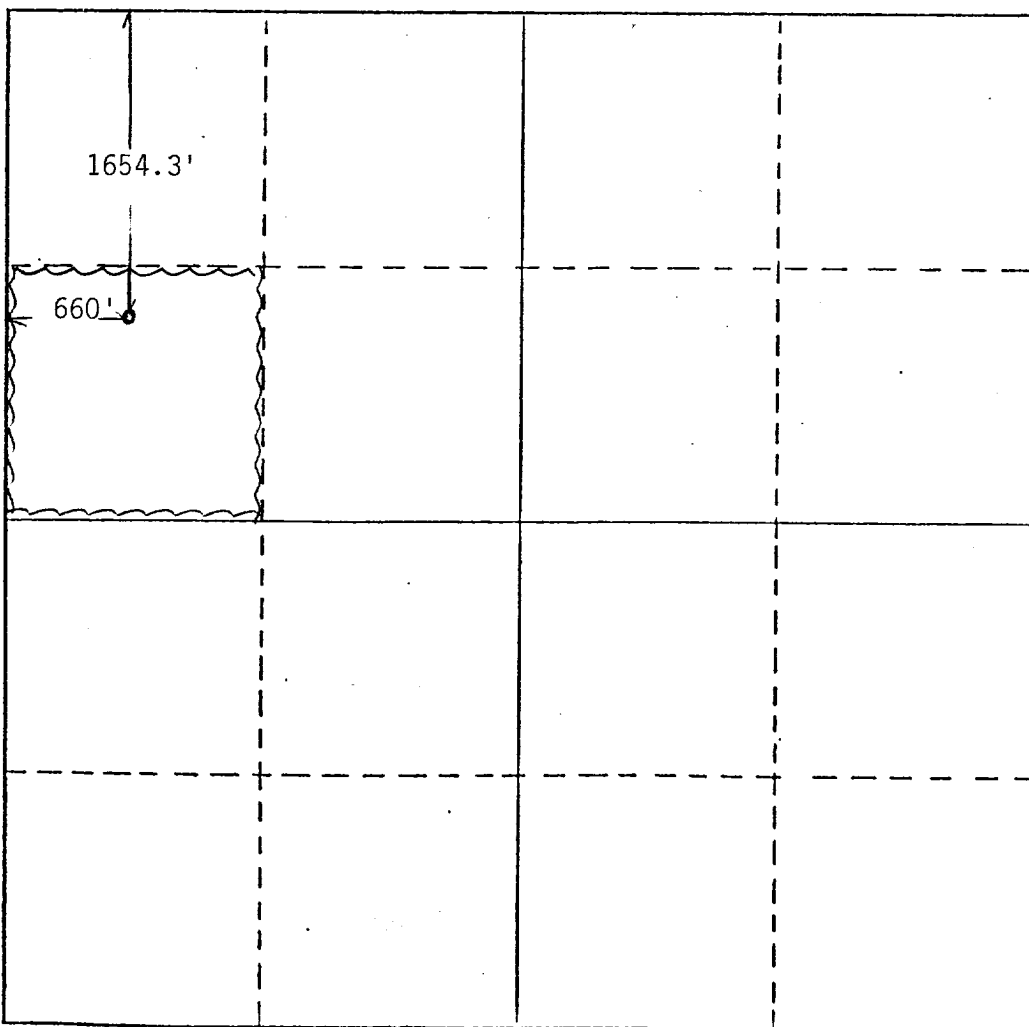

CERTIFICATION

I hereby certify that the information contained herein is true and complete to the best of my knowledge and belief.

Name Mary C. Clark  
Position Assist. Admin. Analyst  
Company Amoco Production Company  
Date 6/13/84

I hereby certify that the well location shown on this plat was plotted from field notes of actual surveys made by me or under my supervision, and that the same is true and correct to the best of my knowledge and belief.

Date Surveyed \_\_\_\_\_

Registered Professional Engineer and/or Land Surveyor

Certificate No. \_\_\_\_\_

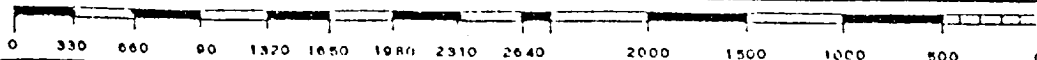

RECEIVED  
JUN 14 1984  
C.C.  
HOBBS OFFICE