

NEW MEXICO OIL CONSERVATION COMMISSION
Santa Fe, New Mexico

Form C-101
Revised (12/1/55)

NOTICE OF INTENTION TO DRILL

Notice must be given to the District Office of the Oil Conservation Commission and approval obtained before drilling or recompletion begins. If changes in the proposed plan are considered advisable, a copy of this notice showing such changes will be returned to the sender. Submit this notice in QUINTUPPLICATE. One copy will be returned following approval. See additional instructions in Rules and Regulations of the Commission. If State Land submit 6 Copies Attach Form C- 128 in triplicate to first 3 copies of form C-101

Midland, Texas

(Place)

March 29, 1963

(Date)

OIL CONSERVATION COMMISSION
SANTA FE, NEW MEXICO

Gentlemen:

You are hereby notified that it is our intention to commence the Drilling of a well to be known as

TEXACO INC.

(Company or Operator)

State of New Mexico "R" NCT-1

(Lease)

Well No. 6

in H

(Unit)

The well is

located 2310 feet from the North line and 760 feet from the

East

line of Section 6

T. -18-S

R. -35-E

NMPM.

(GIVE LOCATION FROM SECTION LINE)

Vacuum-Abo

Pool,

Lea

County

If State Land the Oil and Gas Lease is No. B-1306-1

If patented land the owner is

Address

We propose to drill well with drilling equipment as follows: Rotary

The status of plugging bond is \$10,000 blanket surety bond of Maryland Casualty Co. filed with State Geologist.

Drilling Contractor Unknown at present

We intend to complete this well in the Abo Reef

formation at an approximate depth of 8850 feet.

CASING PROGRAM

We propose to use the following strings of Casing and to cement them as indicated:

Size of Hole	Size of Casing	Weight per Foot	New or Second Hand	Depth	Sacks Cement
15"	11 3/4"	23.72 & 42	New	350'	300
10 5/8"	8 5/8"	24 & 32	New	3080'	1650 *
7 5/8"	2 7/8"	6.5	New	8850'	1550 **

*1500 sks 1:1 Pozmix Portland reg. cmt. mixture w/8% gel. followed by 150 sks Portland Cement.

If changes in the above plans become advisable we will notify you immediately. **1300 sks Incon 8% gel. followed by 250 sks Incon 4% gel.

ADDITIONAL INFORMATION (If recompletion give full details of proposed plan of work.)

FORMATION TOPS EXPECTED:

Anhydrite	1480'	Seven Rivers	3040'	Abo	8145'
Salt	1590'	San Andres	4397'	Abo	
Yates	2905'	Drinkard	7895'	Reef	8645'

Use friction reducer agent in 1st 500 sks of 8% gel. cmt. in order that turbulent flow might be attained with this batch. (rest) tie back

Approved _____, 19____
Except as follows:

Sincerely yours,

into _____ casing

TEXACO INC.

(Company or Operator)

By

T. G. Landwermeyer

Position

Civil Engineer

Send Communications regarding well to

Name J. H. Markley

Address P.O. Box 3109, Midland, Texas

OIL CONSERVATION COMMISSION

By

NEW MEXICO OIL CONSERVATION COMMISSION
WELL LOCATION AND ACREAGE DEDICATION PLAT

FORM C-124
 Revised 5/1/57

SEE INSTRUCTIONS FOR COMPLETING THIS FORM ON THE REVERSE SIDE

SECTION A

Operator TEXACO Inc.			Lease State of New Mexico "R" NCT-1		Well No. 6
Unit Letter H	Section 6	Township 18 South	Range 35 East	County Lea	
Actual Portage Location of Well: 2310 feet from the North line and 760 feet from the East line Sec. 6					
Ground Level Elev. 4993	Producing Formation Abn Reef		Pool Vacuum - Abn		Dedicated Acreage: 40 Acres

1. Is the Operator the only owner in the dedicated acreage outlined on the plat below? YES ☒ NO ☐ . ("Owner" means the person who has the right to drill into and to produce from any pool and to appropriate the production either for himself or for himself and another. (65-3-29 (c) NMSA 1935 Comp.)
2. If the answer to question one is "no," have the interests of all the owners been consolidated by communitization agreement or otherwise? YES ☐ NO ☐ . If answer is "yes," Type of Consolidation _____
3. If the answer to question two is "no," list all the owners and their respective interests below:

Owner	Land Description

SECTION B

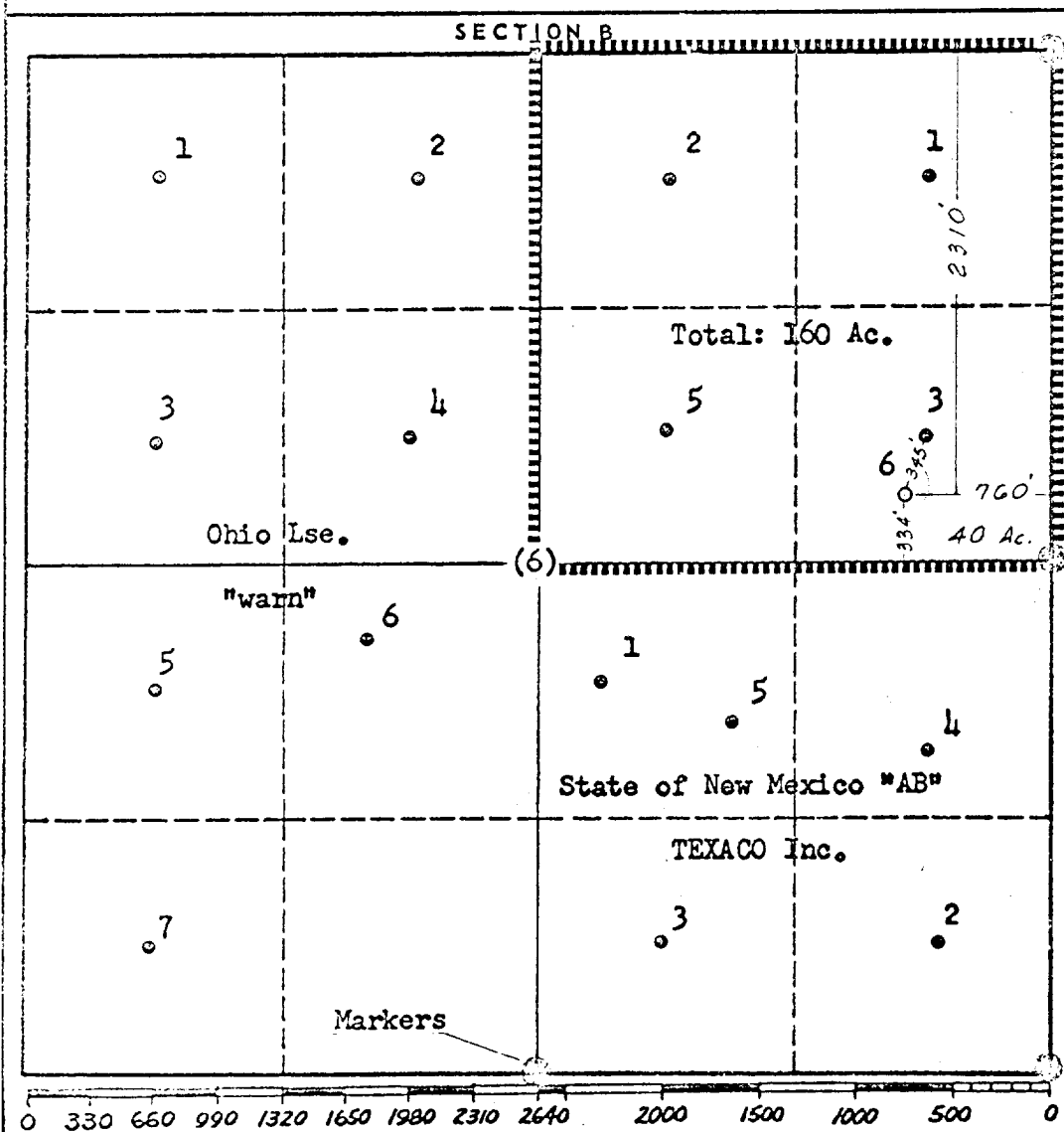

CERTIFICATION

I hereby certify that the information in SECTION A above is true and complete to the best of my knowledge and belief.

Name T. G. Landwermeyer
Position Civil Engineer
Company TEXACO Inc.
Date 3-29-63

I hereby certify that the well location shown on the plat in SECTION B was plotted from field notes of actual surveys made by me or under my supervision, and that the same is true and correct to the best of my knowledge and belief.

Date Surveyed 3-28-63
Registered Professional Engineer and/or Land Surveyor T. G. Landwermeyer
Certificate No. 17617

8/4/97

117

8/4/97