

NOTICE OF INTENTION TO DRILL

Notice must be given to the District Office of the Oil Conservation Commission and approval obtained before drilling or recompletion begins. If changes in the proposed plan are considered advisable, a copy of this notice showing such changes will be returned to the sender. Submit this notice in QUINTUPLICATE. One copy will be returned following approval. See additional instructions in Rules and Regulations of the Commission. If State Land submit 6 Copies Attach Form C-128 in triplicate to first 3 copies of form C-101

Midland, Texas
(Place)

February 8, 1963
(Date)

OIL CONSERVATION COMMISSION
SANTA FE, NEW MEXICO

Gentlemen:

You are hereby notified that it is our intention to commence the Drilling of a well to be known as

TEXACO INC.

(Company or Operator)

State of New Mexico "AE"
(Lease)

Well No. 5, in K The well is
(Unit)

located 1980 feet from the South line and 1980 feet from the West line of Section 12, T. -18-S, R. -34-E, NMPM.

(GIVE LOCATION FROM SECTION LINE) Vacuum Abo Pool, Lea County

If State Land the Oil and Gas Lease is No. B-1258-1

If patented land the owner is

Address

We propose to drill well with drilling equipment as follows: Rotary

The status of plugging bond is \$10,000 blanket surety bond of Maryland Casualty Co. filed with State Geologist

Drilling Contractor Unknown at present

We intend to complete this well in the Abo formation at an approximate depth of feet.

CASING PROGRAM

We propose to use the following strings of Casing and to cement them as indicated:

Size of Hole	Size of Casing	Weight per Foot	New or Second Hand	Depth	Sacks Cement
15"	11 3/4"	23.72	New	320'	300
10 5/8"	8 5/8"	24 & 32	New	3270'	1680 *
8 5/8"	2 7/8"	6.5	New	8950'	1280 **

*1500 sks. of 1:1 Pozmix-Portland reg. cement mixture, w/8% gel followed by

If changes in the above plans become advisable we will notify you immediately. 150 sks. Portland regular.

ADDITIONAL INFORMATION (If recompletion give full details of proposed plan of work.) **950 sks of 1:1 Pozmix-Portland reg. cement

FORMATION TOPS EXPECTED:

Anhydrite	1718'	Queen	4184'
Salt	1803'	Penrose	4389'
Vates	3029'	San Andres	5057'
Sevan Rivers	3244'	Abo Reef	7890'

mixture w/18% gel & 3 lbs. salt per sk. followed by 300 sks of 1:1 Pozmix-Portland reg. cement mixture w/2% gel.

Approved, 19.....
Except as follows:

Sincerely yours,

TEXACO INC.

(Company or Operator)

By J. J. Velten

Position Division Civil Engineer

Send Communications regarding well to

Name J. H. Markley

Address P.O. Box 3109, Midland, Texas

Cement must tie back

into

OIL CONSERVATION COMMISSION

NEW MEXICO OIL CONSERVATION COMMISSION
WELL LOCATION AND ACREAGE DEDICATION PLAT

FORM C-128
 Revised 5/1/57

SEE INSTRUCTIONS FOR COMPLETING THIS FORM ON THE REVERSE SIDE

SECTION A

FEB 11 AM 8 37

Operator TEXACO Inc.		Lease State of New Mexico "AE"		Well No. 5
Unit Letter A	Section 12	Township 18 South	Range 34 East	County Lea
Actual Footage Location of Well: 1980 feet from the South line and 1980 feet from the West line				
Ground Level Elev. 2131	Producing Formation Abo	Pool Vacuum Abo	Dedicated Acreage: 40 Acres	

1. Is the Operator the only owner in the dedicated acreage outlined on the plat below? YES ☒ NO ☐ ("Owner" means the person who has the right to drill into and to produce from any pool and to appropriate the production either for himself or for himself and another. (65-3-29 (e) NMSA 1935 Comp.)
2. If the answer to question one is "no," have the interests of all the owners been consolidated by communitization agreement or otherwise? YES ☐ NO ☐ . If answer is "yes," Type of Consolidation _____
3. If the answer to question two is "no," list all the owners and their respective interests below:

Owner	Land Description

SECTION B

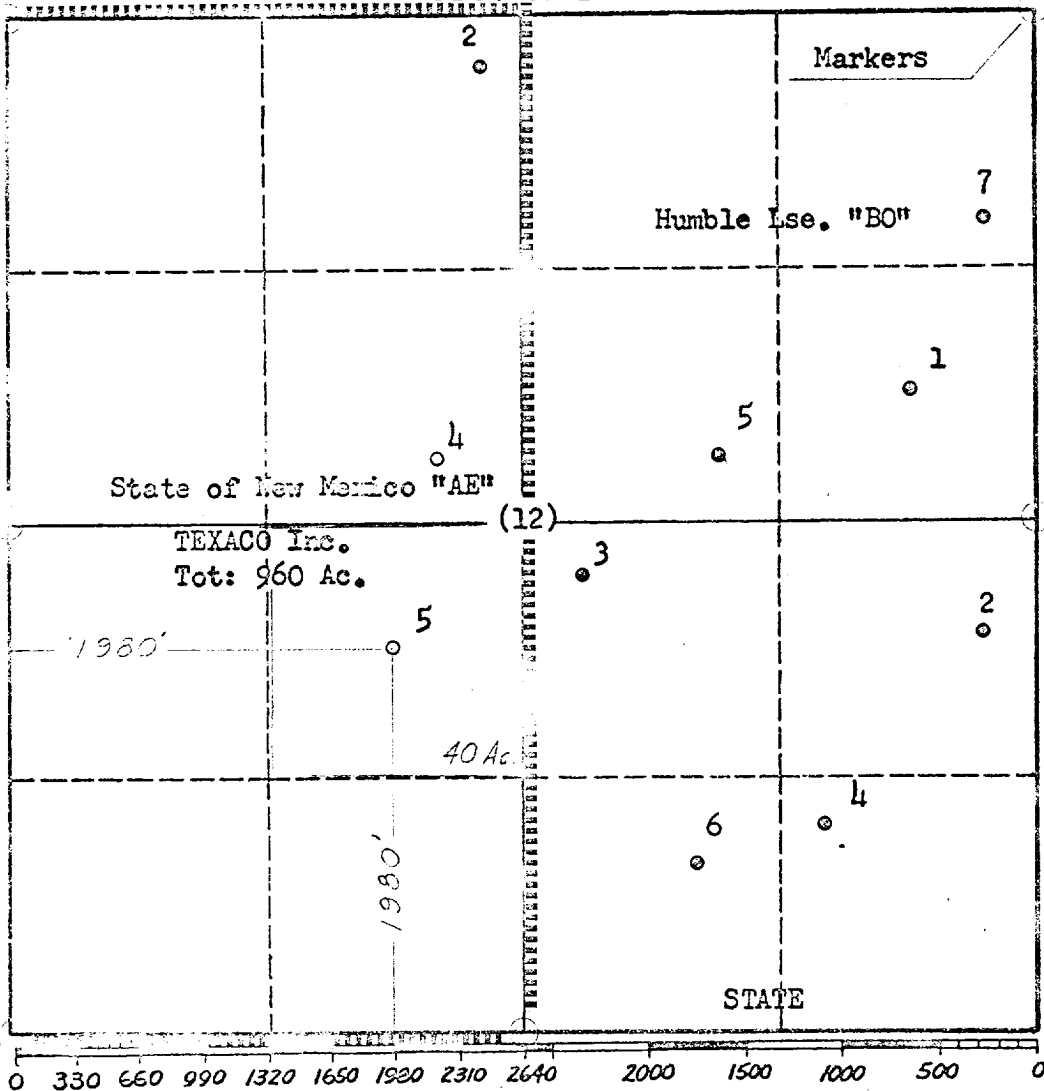

CERTIFICATION

I hereby certify that the information in SECTION A above is true and complete to the best of my knowledge and belief.

Name **J. J. Velten**
 Position **Division Civil Engineer**
 Company **TEXACO Inc.**
 Date **2/8/63**

I hereby certify that the well location shown on the plat in SECTION B was plotted from field notes of actual surveys made by me or under my supervision, and that the same is true and correct to the best of my knowledge and belief.

Date Surveyed **2/7/63**
 Registered Professional Engineer and/or Land Surveyor **J. J. Velten**
 Certificate No. **8174**