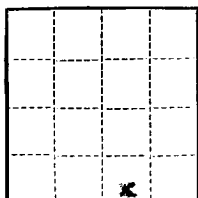

Form 9-331a
(Feb. 1951)

(SUBMIT IN TRIPLICATE)

UNITED STATES
DEPARTMENT OF THE INTERIOR
GEOLOGICAL SURVEY

Land Office New Mexico
 Lease No. NM 272006
 HOBBS OFFICE DEC
Unit C

1962 NOV 20 PM 2:55

SUNDRY NOTICES AND REPORTS ON WELLS

NOTICE OF INTENTION TO DRILL.....	<input checked="" type="checkbox"/>	SUBSEQUENT REPORT OF WATER SHUT-OFF.....	
NOTICE OF INTENTION TO CHANGE PLANS.....		SUBSEQUENT REPORT OF SHOOTING OR ACIDIZING.....	
NOTICE OF INTENTION TO TEST WATER SHUT-OFF.....		SUBSEQUENT REPORT OF ALTERING CASING.....	
NOTICE OF INTENTION TO RE-DRILL OR REPAIR WELL.....		SUBSEQUENT REPORT OF RE-DRILLING OR REPAIR.....	
NOTICE OF INTENTION TO SHOOT OR ACIDIZE.....		SUBSEQUENT REPORT OF ABANDONMENT.....	
NOTICE OF INTENTION TO PULL OR ALTER CASING.....		SUPPLEMENTARY WELL HISTORY.....	
NOTICE OF INTENTION TO ABANDON WELL.....			

(INDICATE ABOVE BY CHECK MARK NATURE OF REPORT, NOTICE, OR OTHER DATA)

November 26, 1962

Big Circle

Well No. 3 is located 660 ft. from [N] line and 1050 ft. from [W] line of sec.SW/4 SE/4 Sec. 24
(1/4 Sec. and Sec. No.)19-S
(Twp.)32-E
(Range)NMPM
(Meridian)South Tonto Yates
(Field)Lea
(County or Subdivision)New Mexico
(State or Territory)

Ground Level

The elevation of the ~~surface~~ above sea level is 3610.7 ft.

DETAILS OF WORK

(State names of and expected depths to objective sands; show sizes, weights, and lengths of proposed casings; indicate mudding jobs, cementing points, and all other important proposed work)

We propose to drill this well with rotary tools to an approximate depth of 3200 feet to test the Yates Sand. We will run approximately the following casing string:
 8-5/8" - 244 @ 300'. Cement to be circulated to surface.
 5-1/2" - 144 @ 3200'. Cement with sufficient volume to return cement to surface. Cement volume to be determined by Caliper Survey.

 RECEIVED
 NOV 28 1962

 U. S. GEOLOGICAL SURVEY
 RECEIVED NOV 28 1962

I understand that this plan of work must receive approval in writing by the Geological Survey before operations may be commenced.

Company Kewanee Oil CompanyAddress P. O. Box 3786Odessa, TexasBy E. F. StucklandTitle Division Superintendent

NEW MEXICO OIL CONSERVATION COMMISSION
WELL LOCATION AND ACREAGE DEDICATION PLAT

FORM C-128
Revised 5/1/57

SEE INSTRUCTIONS FOR COMPLETING THIS FORM ON THE REVERSE SIDE

SECTION A

Operator

Kewanee Oil Company

Lease

Big Circle

Unit Letter

O

Section

24

Township

19 South

Range

32 East

County

Lea

Actual Footage Location of Well:

660

feet from the

south

line and

1650

feet from the

east

line

Ground Level Elev.

3610.7

Producing Formation

Yates Sand

Pool

South Tonto Yates

Dedicated Acreage:

40

Acres

1. Is the Operator the only owner in the dedicated acreage outlined on the plat below? YES ☒ NO ☐ ("Owner" means the person who has the right to drill into and to produce from any pool and to appropriate the production either for himself or for himself and another. (65-3-29 (e) NMSA 1955 Comp.)
2. If the answer to question one is "no," have the interests of all the owners been consolidated by communitization agreement otherwise? YES ☐ NO ☐ If answer is "yes," Type of Consolidation _____
3. If the answer to question two is "no," list all the owners and their respective interests below:

Owner

Land Description

SECTION B

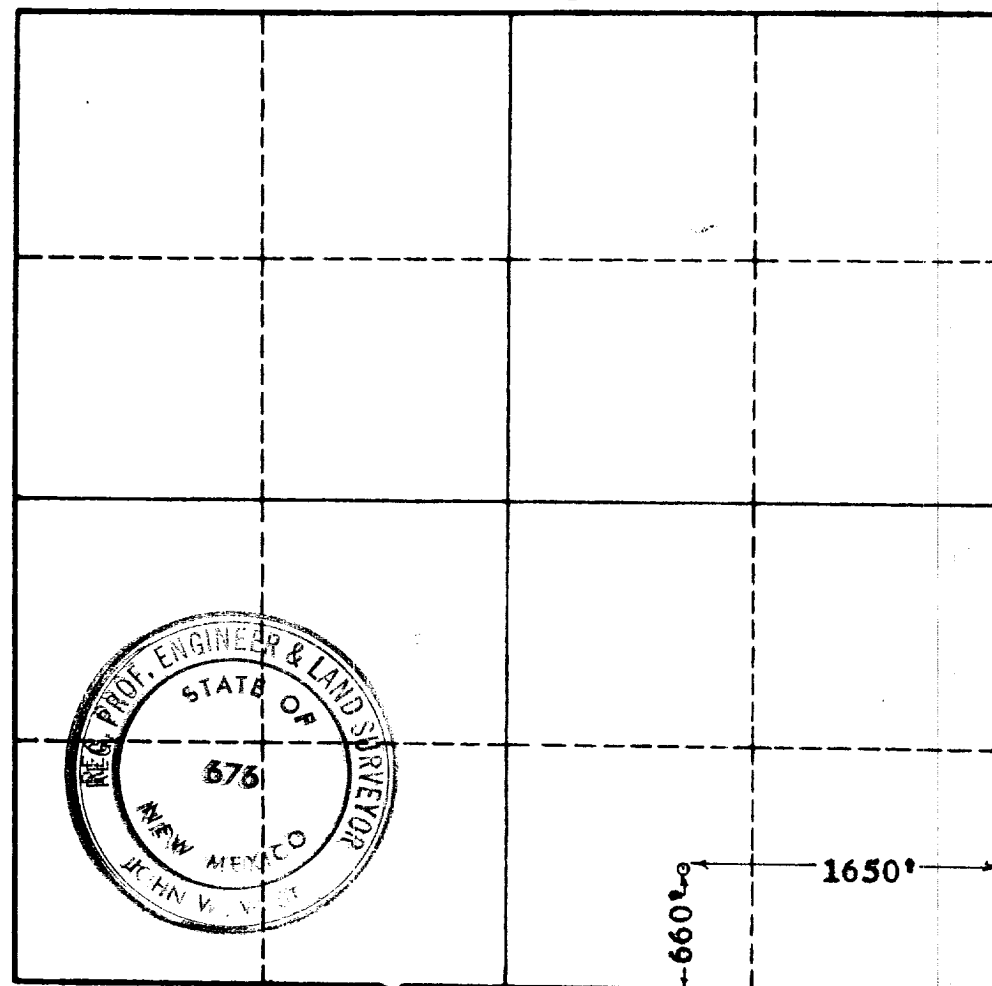

I hereby certify that the information in SECTION A above is true and complete to the best of my knowledge and belief.

Name

Position

Division Superintendent
Company

Kewanee Oil Company

Date

November 26, 1962

I hereby certify that the well location shown on the plat in SECTION B was plotted from field notes of actual surveys made by me or under my supervision, and that the same is true and correct to the best of my knowledge and belief.

Date Surveyed

Nov. 24, 1962

Registered Professional Engineer

and/or Land Surveyor, JOHN W. WEST

Certificate No.

N. M. - P. E. & L. S. NO. 676