

NUMBER OF COPIES RECEIVED	
DISTRIBUTION	
SANTA FE	
FILE	
U.S.G.T.	
LAND OFFICE	
TRANSPORTER	OIL GAS
PRODUCTION OFFICE	
OPERATOR	

NEW MEXICO OIL CONSERVATION COMMISSION
Santa Fe, New Mexico

Form C-101
Revised (12/1/55)

NOTICE OF INTENTION TO DRILL

Notice must be given to the District Office of the Oil Conservation Commission and approval obtained before drilling or recompletion begins. If changes in the proposed plan are considered advisable, a copy of this notice showing such changes will be returned to the sender. Submit this notice in QUINTUPLICATE. One copy will be returned following approval. See additional instructions in Rules and Regulations of the Commission. If State Land submit 6 Copies Attach Form C-128 in triplicate to first 3 copies of form C-101

Hobbs, New Mexico

April 11, 1963

(Place)

(Date)

OIL CONSERVATION COMMISSION
SANTA FE, NEW MEXICO

Gentlemen:

You are hereby notified that it is our intention to commence the Drilling of a well to be known as

Continental Oil Company

State "A" 36A

(Comp. or Oper.) 2

A

Well No. _____, in _____ The well is

located 660 feet from the North line and 660 feet from the East 36 line and 36E

line of Section Goodwin-Abo, T. 18S, R. 36E, NMPM. Lea County

(GIVE LOCATION FROM SECTION LINE)

660 FNL & 660 FEL

If State Land the Oil and Gas Lease is No.

If patented land the owner is.

Address. Rotary

We propose to drill well with drilling equipment as follows:

The status of plugging bond is Blanket Bond on File

Drilling Contractor Carper Drilling Company
200 Carper Building
Artesia, New Mexico

We intend to complete this well in the 660 Feet formation at an approximate depth of 7,550 feet.

CASING PROGRAM

We propose to use the following strings of Casing and to cement them as indicated:

Size of Hole	Size of Casing	Weight per Foot	New or Second Hand	Depth	Sacks Cement
13 3/4	10 3/4	32.75	New	350	240*
9 7/8	7 5/8	24	New	3150	150**
6 3/4	4 1/2	11.6 & 9.5	New	7550	230***

If changes in the above plans become advisable we will notify you immediately.

ADDITIONAL INFORMATION (If recompletion give full details of proposed plan of work.)

*Cement is to circulate.

**Cement is to return to approximately 2,550'

***Cement is to return to approximately 6,000'

Approved _____, 19_____
Except as follows:

Sincerely yours,
Continental Oil Company

(Company or Operator)

By J. C. Lee District Superintendent

Position Send Communications regarding well to
Continental Oil Company

Name Box 427, Hobbs, New Mexico

Address

OIL CONSERVATION COMMISSION

By AMOCO (6) SLD WAM FEE

NEW MEXICO OIL CONSERVATION COMMISSION
WELL LOCATION AND ACREAGE DEDICATION PLAT

FORM C-128
Revised 5/1/57

SEE INSTRUCTIONS FOR COMPLETING THIS FORM ON THE REVERSE SIDE

SECTION A

Operator CONTINENTAL OIL COMPANY		Lease STATE "A" 36-A		Well No. 27
Unit Letter A	Section 36	Township 18 SOUTH	Range 36 EAST	County LEA
Actual Footage Location of Well: 660 feet from the NORTH line and 660 feet from the EAST line				
Ground Level Elev.	Producing Formation Alb. Reef		Pool Goodwin Alb	Dedicated Acreage: 40 Acres

1. Is the Operator the only owner in the dedicated acreage outlined on the plat below? YES ☒ NO ☐ ("Owner" means the person who has the right to drill into and to produce from any pool and to appropriate the production either for himself or for himself and another. (65-3-29 (e) NMSA 1935 Comp.)
2. If the answer to question one is "no," have the interests of all the owners been consolidated by commissioning agreement or otherwise? YES ☐ NO ☐ If answer is "yes," Type of Consolidation _____
3. If the answer to question two is "no," list all the owners and their respective interests below:

Owner	Land Description

SECTION B

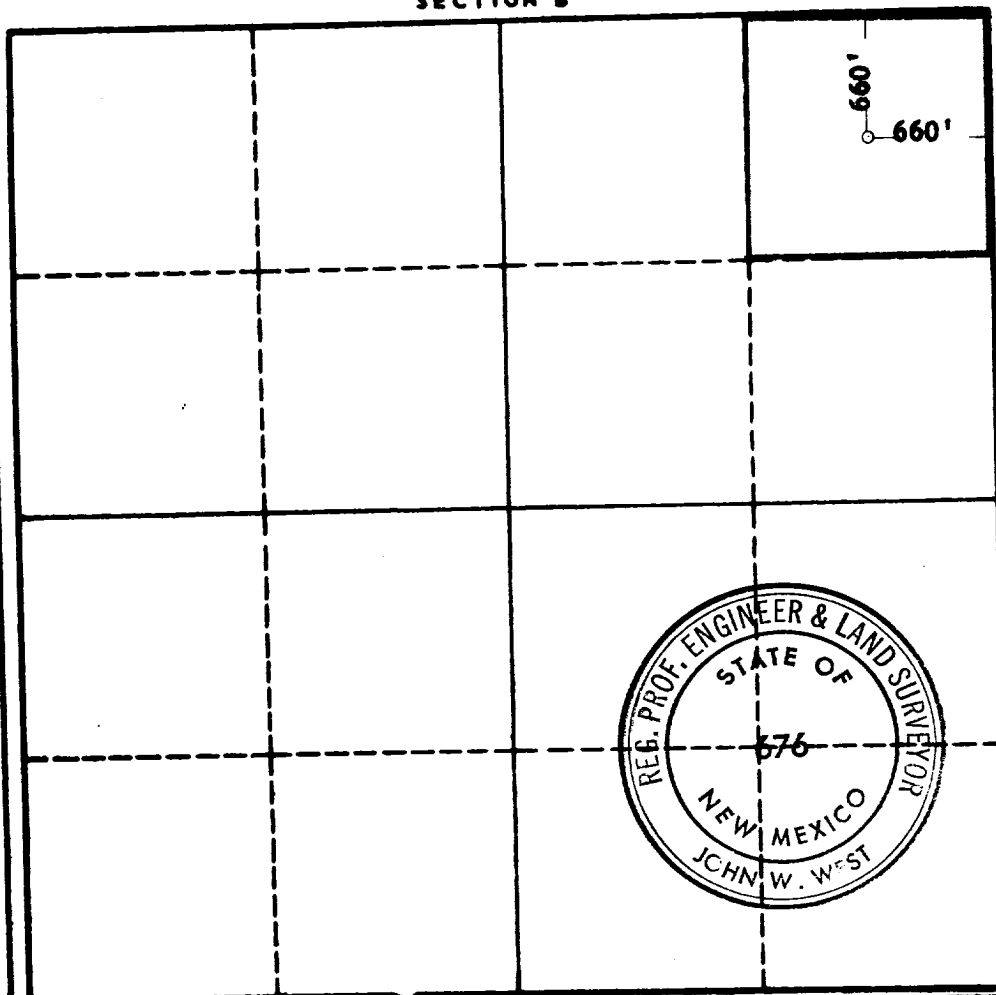

CERTIFICATION

I hereby certify that the information in SECTION A above is true and complete to the best of my knowledge and belief.

Name John W. West
Position District Superintendent
Company Continental Oil Company
Date April 11, 1963

I hereby certify that the well location shown on the plat in SECTION B was plotted from field notes of actual surveys made by me or under my supervision, and that the same is true and correct to the best of my knowledge and belief.

Date Surveyed 4-9-63
Registered Professional Engineer and/or Land Surveyor, JOHN W. WEST
John W. West
Certificate No. N.M. - P.E. & L.S. NO. 676

0 380 660 940 1220 1500 1780 2060 2340 2620 2900 3180 3460 3740 4020 4300 4580 4860 5140 5420 5700 5980 6260 6540 6820 7100 7380 7660 7940 8220 8500 8780 9060 9340 9620 9900 10180 10460 10740 11020 11300 11580 11860 12140 12420 12700 12980 13260 13540 13820 14100 14380 14660 14940 15220 15500 15780 16060 16340 16620 16900 17180 17460 17740 18020 18300 18580 18860 19140 19420 19700 19980 20260 20540 20820 21100 21380 21660 21940 22220 22500 22780 23060 23340 23620 23900 24180 24460 24740 25020 25300 25580 25860 26140 26420 26700 26980 27260 27540 27820 28100 28380 28660 28940 29220 29500 29780 30060 30340 30620 30900 31180 31460 31740 32020 32300 32580 32860 33140 33420 33700 33980 34260 34540 34820 35100 35380 35660 35940 36220 36500 36780 37060 37340 37620 37900 38180 38460 38740 39020 39300 39580 39860 40140 40420 40700 40980 41260 41540 41820 42100 42380 42660 42940 43220 43500 43780 44060 44340 44620 44900 45180 45460 45740 46020 46300 46580 46860 47140 47420 47700 47980 48260 48540 48820 49100 49380 49660 49940 50220 50500 50780 51060 51340 51620 51900 52180 52460 52740 53020 53300 53580 53860 54140 54420 54700 54980 55260 55540 55820 56100 56380 56660 56940 57220 57500 57780 58060 58340 58620 58900 59180 59460 59740 60020 60300 60580 60860 61140 61420 61700 61980 62260 62540 62820 63100 63380 63660 63940 64220 64500 64780 65060 65340 65620 65900 66180 66460 66740 67020 67300 67580 67860 68140 68420 68700 68980 69260 69540 69820 70100 70380 70660 70940 71220 71500 71780 72060 72340 72620 72900 73180 73460 73740 74020 74300 74580 74860 75140 75420 75700 75980 76260 76540 76820 77100 77380 77660 77940 78220 78500 78780 79060 79340 79620 79900 80180 80460 80740 81020 81300 81580 81860 82140 82420 82700 82980 83260 83540 83820 84100 84380 84660 84940 85220 85500 85780 86060 86340 86620 86900 87180 87460 87740 88020 88300 88580 88860 89140 89420 89700 89980 90260 90540 90820 91100 91380 91660 91940 92220 92500 92780 93060 93340 93620 93900 94180 94460 94740 95020 95300 95580 95860 96140 96420 96700 96980 97260 97540 97820 98100 98380 98660 98940 99220 99500 99780 100060 100340 100620 100900 101180 101460 101740 102020 102300 102580 102860 103140 103420 103700 103980 104260 104540 104820 105100 105380 105660 105940 106220 106500 106780 107060 107340 107620 107900 108180 108460 108740 109020 109300 109580 109860 110140 110420 110700 110980 111260 111540 111820 112100 112380 112660 112940 113220 113500 113780 114060 114340 114620 114900 115180 115460 115740 116020 116300 116580 116860 117140 117420 117700 117980 118260 118540 118820 119100 119380 119660 119940 120220 120500 120780 121060 121340 121620 121900 122180 122460 122740 123020 123300 123580 123860 124140 124420 124700 124980 125260 125540 125820 126100 126380 126660 126940 127220 127500 127780 128060 128340 128620 128900 129180 129460 129740 130020 130300 130580 130860 131140 131420 131700 131980 132260 132540 132820 133100 133380 133660 133940 134220 134500 134780 135060 135340 135620 135900 136180 136460 136740 137020 137300 137580 137860 138140 138420 138700 138980 139260 139540 139820 140100 140380 140660 140940 141220 141500 141780 142060 142340 142620 142900 143180 143460 143740 144020 144300 144580 144860 145140 145420 145700 145980 146260 146540 146820 147100 147380 147660 147940 148220 148500 148780 149060 149340 149620 149900 150180 150460 150740 151020 151300 151580 151860 152140 152420 152700 152980 153260 153540 153820 154100 154380 154660 154940 155220 155500 155780 156060 156340 156620 156900 157180 157460 157740 158020 158300 158580 158860 159140 159420 159700 159980 160260 160540 160820 161100 161380 161660 161940 162220 162500 162780 163060 163340 163620 163900 164180 164460 164740 165020 165300 165580 165860 166140 166420 166700 166980 167260 167540 167820 168100 168380 168660 168940 169220 169500 169780 170060 170340 170620 170900 171180 171460 171740 172020 172300 172580 172860 173140 173420 173700 173980 174260 174540 174820 175100 175380 175660 175940 176220 176500 176780 177060 177340 177620 177900 178180 178460 178740 179020 179300 179580 179860 180140 180420 180700 180980 181260 181540 181820 182100 182380 182660 182940 183220 183500 183780 184060 184340 184620 184900 185180 185460 185740 186020 186300 186580 186860 187140 187420 187700 187980 188260 188540 188820 189100 189380 189660 189940 190220 190500 190780 191060 191340 191620 191900 192180 192460 192740 193020 193300 193580 193860 194140 194420 194700 194980 195260 195540 195820 196100 196380 196660 196940 197220 197500 197780 198060 198340 198620 198900 199180 199460 199740 200020 200300 200580 200860 201140 201420 201700 201980 202260 202540 202820 203100 203380 203660 203940 204220 204500 204780 205060 205340 205620 205900 206180 206460 206740 207020 207300 207580 207860 208140 208420 208700 208980 209260 209540 209820 210100 210380 210660 210940 211220 211500 211780 212060 212340 212620 212900 213180 213460 213740 214020 214300 214580 214860 215140 215420 215700 215980 216260 216540 216820 217100 217380 217660 217940 218220 218500 218780 219060 219340 219620 219900 220180 220460 220740 221020 221300 221580 221860 222140 222420 222700 222980 223260 223540 223820 224100 224380 224660 224940 225220 225500 225780 226060 226340 226620 226900 227180 227460 227740 228020 228300 228580 228860 229140 229420 229700 229980 230260 230540 230820 231100 231380 231660 231940 232220 232500 232780 233060 233340 233620 233900 234180 234460 234740 235020 235300 235580 235860 236140 236420 236700 236980 237260 237540 237820 238100 238380 238660 238940 239220 239500 239780 240060 240340 240620 240900 241180 241460 241740 242020 242300 242580 242860 243140 243420 243700 243980 244260 244540 244820 245100 245380 245660 245940 246220 246500 246780 247060 247340 247620 247900 248180 248460 248740 249020 249300 249580 249860 250140 250420 250700 250980 251260 251540 251820 252100 252380 252660 252940 253220 253500 253780 254060 254340 254620 254900 255180 255460 255740 256020 256300 256580 256860 257140 257420 257700 257980 258260 258540 258820 259100 259380 259660 259940 260220 260500 260780 261060 261340 261620 261900 262180 262460 262740 263020 263300 263580 263860 264140 264420 264700 264980 265260 265540 265820 266100 266380 266660 266940 267220 267500 267780 268060 268340 268620 268900 269180 269460 269740 270020 270300 270580 270860 271140 271420 271700 271980 272260 272540 272820 273100 273380 273660 273940 274220 274500 274780 275060 275340 275620 275900 276180 276460 276740 277020 277300 277580 277860 278140 278420 278700 278980 279260 279540 279820 280100 280380 280660 280940 281220 281500 281780 282060 282340 282620 282900 283180 283460 283740 284020 284300 284580 284860 285140 285420 285700 285980 286260 286540 286820 287100 287380 287660 287940 288220 288500 288780 289060 289340 289620 289900 290180 290460 290740 291020 291300 291580 291860 292140 292420 292700 292980 293260 293540 293820 294100 294380 294660 294940 295220 295500 295780 296060 296340 296620 296900 297180 297460 297740 298020 298300 298580 298860 299140 299420 299700 300000