

SANTA FE		OIL	
TRANSPORTER		GAS	
OIL		GAS	
TRANSPORTER		GAS	
OIL		GAS	
TRANSPORTER		GAS	

NEW MEXICO OIL CONSERVATION COMMISSION
Santa Fe, New Mexico

Form C-101
Revised 12/1/55

NOTICE OF INTENTION TO DRILL Oct 23 8 49 AM '63

Notice must be given to the District Office of the Oil Conservation Commission and approval obtained before drilling or recompletion begins. If changes in the proposed plan are considered advisable, a copy of this notice showing such changes will be returned to the sender. Submit this notice in QUINTUPLICATE. One copy will be returned following approval. See additional instructions in Rules and Regulations of the Commission. If State Land submit 6 Copies. Attach Form C-128 in triplicate to first 3 copies of Form C-101.

Midland, Texas

October 25, 1963

(Place)

(Date)

OIL CONSERVATION COMMISSION
SANTA FE, NEW MEXICO

Gentlemen:

You are hereby notified that it is our intention to commence the Drilling of a well to be known as

TEXACO Inc.

(Company or Operator)

State of New Mexico "AB"

(Lease)

Well No. 10

in 1

(Unit)

The well is

located 110 feet from the North line and 10 feet from the

West

line of Section 11

T 10-S

R 1-E

NMPM.

(GIVE LOCATION FROM SECTION LINE)

Wabun 10 reef

Pool, 10

County

D	C	B	A
E	F	G	H
L	K	J	I
M	N	O	P

If State Land the Oil and Gas Lease is No. 10-1055-1

If patented land the owner is _____

Address _____

We propose to drill well with drilling equipment as follows: Rotary

The status of plugging bond is 110,000 Blanket Surety Bond of Maryland Casualty Company filed with State Geologist

Drilling Contractor Unknown at present

We intend to complete this well in the Abc reef

formation at an approximate depth of 6050 feet.

CASING PROGRAM

We propose to use the following strings of Casing and to cement them as indicated:

Size of Hole	Size of Casing	Weight per Foot	New or Second Hand	Depth	Sacks Cement

SEE ATTACHED SHEET

If changes in the above plans become advisable we will notify you immediately.

ADDITIONAL INFORMATION (If recompletion give full details of proposed plan of work.)

CEMENT MUST BE CIRCULATED FIRST

11 1/4 CASING

Approved _____, 19____

Except as follows:

Cement must be back

into _____ casing

OIL CONSERVATION COMMISSION

Sincerely yours,

TEXACO Inc.
(Company or Operator)
By J. H. Markley

Position Division Civil Engineer

Send Communications regarding well to

Name J. H. Markley

Address P.O. Box 3109 --Midland, Texas

CASING PROGRAM

We propose to use the following strings of casing and to cement them as indicated:

SIZE OF HOLE	SIZE OF CASING	WEIGHT PER FT.	NEW OR SECOND HAND	DEPTH	SACKS OR TONS
15"	11-3/4"	42	New	870'	300*
10-5/8"	n 8-5/8"	24 & 32	New	3210'	1750**
7-5/8"	2-7/8"	6.5	New	9050'	1 30***

* Class "A" cement

** 1600 Class "C" with 8% gel followed by 150 Class "C" Neat.

*** 1300 Class "C" 8% gel followed by 300 Class "C" with 4% gel.

FORMATION TOPS

Anhydrite	1730'
Top of Salt	1870'
Yates	2955'
Seven Rivers	3150'
San Andres	4930'
Top of Abo Reef	8305'
Total Depth	9050'

NEW MEXICO OIL CONSERVATION COMMISSION
WELL LOCATION AND ACREAGE DEDICATION PLAT

FORM C-128
Revised 5/1/57

SEE INSTRUCTIONS FOR COMPLETING THIS FORM ON THE REVERSE SIDE

SECTION A

Operator TEXACO Inc.		Lease State of New Mexico "AE"		Well No. 8174	
Unit Letter D	Section 11	Township 18 South	Range 34 East	County Lea	
Actual Footage Location of Well: 660 feet from the North line and 660 feet from the West line Sec. 11					
Ground Level Elev. 4009	Producing Formation Abo Reef		Pool Vacuum Abo Reef	Dedicated Acreage: 40 Acres	

1. Is the Operator the only owner in the dedicated acreage outlined on the plat below? YES X NO ____ . ("Owner" means the person who has the right to drill into and to produce from any pool and to appropriate the production either for himself or for himself and another. (65-3-29 (c) NMSA 1935 Comp.)
2. If the answer to question one is "no," have the interests of all the owners been consolidated by communitization agreement or otherwise? YES ____ NO ____ . If answer is "yes," Type of Consolidation ____
3. If the answer to question two is "no," list all the owners and their respective interests below:

Owner	Land Description

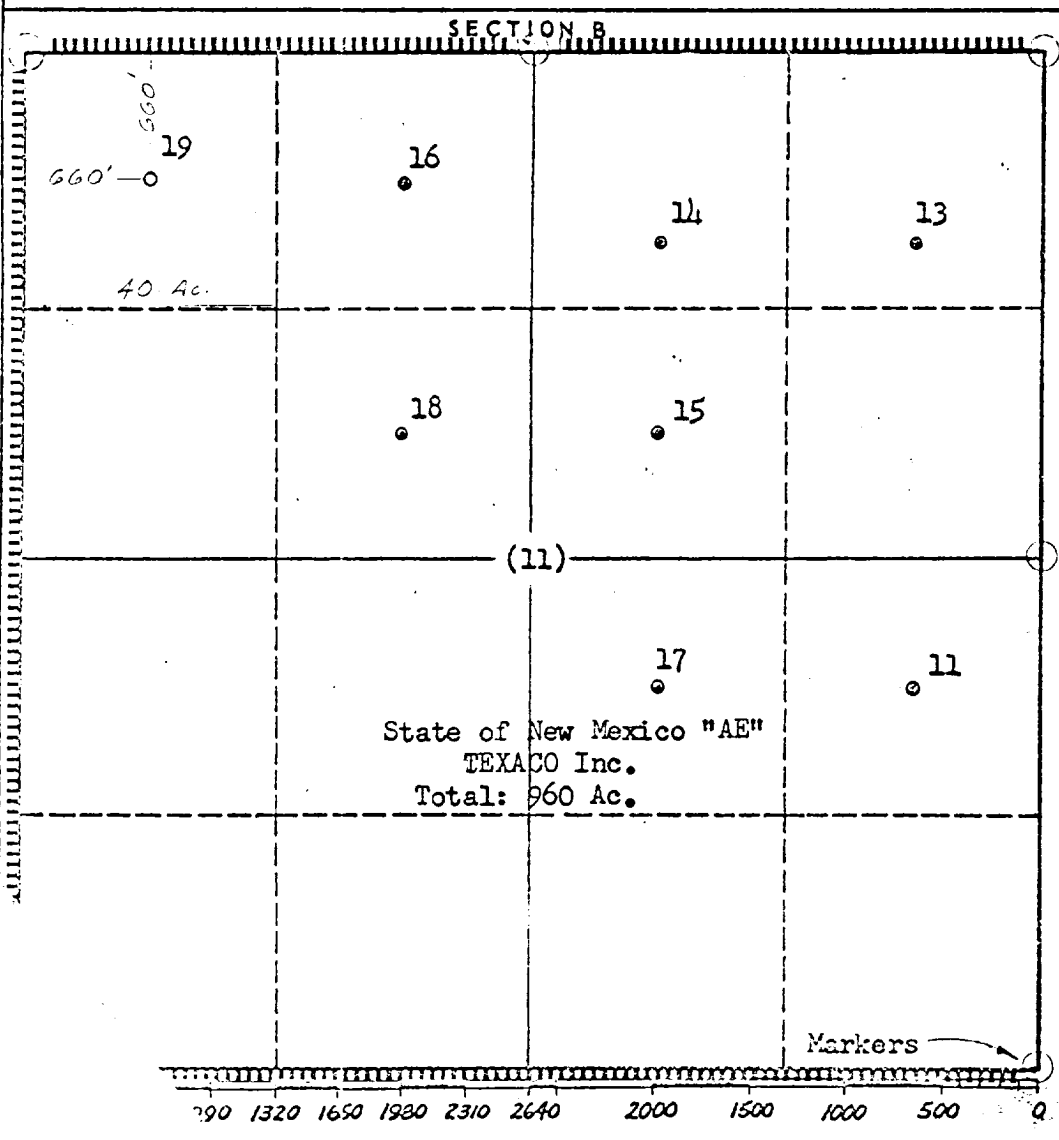

CERTIFICATION

I hereby certify that the information in SECTION A above is true and complete to the best of my knowledge and belief.

Name
J. J. Velten

Position
Division Civil Engineer

Company
TEXACO Inc.

Date
10/25/63

I hereby certify that the well location shown on the plat in SECTION B was plotted from field notes of actual surveys made by me or under my supervision, and that the same is true and correct to the best of my knowledge and belief.

Date Surveyed
10/24/63

Registered Professional Engineer and/or Land Surveyor
J. J. Velten

Certificate No.
8174