

NUMBER OF COPIES RECEIVED	
DISTRIBUTION	
SANTA FE	
FILE	
U.S.G.S.	
LAND OFFICE	
TRANSPORTER	OIL
	GAS
PRODUCTION OFFICE	
OPERATOR	

NEW MEXICO OIL CONSERVATION COMMISSION
Santa Fe, New Mexico

Form G-101
Revised (12/1/55)

NOTICE OF INTENTION TO DRILL

Notice must be given to the District Office of the Oil Conservation Commission and approval obtained before drilling or recompletion begins. If changes in the proposed plan are considered advisable, a copy of this notice showing such changes will be returned to the sender. Submit this notice in **QUINTUPLICATE**. One copy will be returned following approval. See additional instructions in Rules and Regulations of the Commission. If State Land submit 6 Copies Attach Form G-128 in triplicate to first 3 copies of form G-101

Hobbs, New Mexico

(Place)

March 1, 1963

(Date)

OIL CONSERVATION COMMISSION
SANTA FE, NEW MEXICO

Gentlemen:

You are hereby notified that it is our intention to commence the Drilling of a well to be known as

Pan American Petroleum Corp

(Company, or Operator)

State "CL"

(Lease)

Well No. 8

in H

(Unit)

The well is

located 1650 feet from the North line and 990 feet from the East

East

line of Section 7, T. 12-S, R. 3-E, NMPM.

(GIVE LOCATION FROM SECTION LINE)

Vacuum Queen

Pool, Lea

County

County

If State Land the Oil and Gas Lease is No. 2-8714

If patented land the owner is

Address

We propose to drill well with drilling equipment as follows: 4300 with combination rotary-cable tool rig.

The status of plugging bond is: Blanket bond on file with Commission

Drilling Contractor: Cactus Drilling Company
San Angelo, Texas

We intend to complete this well in the Queen formation at an approximate depth of Approx. 4300 feet.

CASING PROGRAM

We propose to use the following strings of Casing and to cement them as indicated:

Size of Hole	Size of Casing	Weight per Foot	New or Second Hand	Depth	Sacks Cement
17-1/2"	13-3/8"	35.6#	New	300	Circulate
8"	4-1/2"	9.5#	New	4300	Sufficient to fill 600' above pay.

If changes in the above plans become advisable we will notify you immediately.

ADDITIONAL INFORMATION (If recompletion give full details of proposed plan of work.)

Contractor may elect to set a cave string of 8-5/8" casing in an 11" hole at a depth of approximately 1750'. Cave string to be removed. Cable tools to be used below cave string.

Approved: _____, 19_____
Except as follows:

Sincerely yours,

Pan American Petroleum Corporation

Original Signed by: (Company or Operator)

V. E. STALEY

By

Position Area Superintendent

Send Communications regarding well to

Name V. E. Staley

Address Box 63 Hobbs, New Mexico

OIL CONSERVATION COMMISSION

By _____

NEW MEXICO OIL CONSERVATION COMMISSION
WELL LOCATION AND ACREAGE DEDICATION PLAT

FORM C-128
Revised 5/1/57

SEE INSTRUCTIONS FOR COMPLETING THIS FORM ON THE REVERSE SIDE

SECTION A

Operator **PAN AMERICAN PETROLEUM CORP.** Lease **STATE CL** Well No. **8**

Unit Letter **H** Section **7** Township **18 SOUTH** Range **34 EAST** County **LEA**

Actual Footage Location of Well:
1650 feet from the **NORTH** line and **990** feet from the **EAST** line

Ground Level Elev. **NEA** Producing Formation **Queen** Pool **Vacuum Queen** Dedicated Acreage: **40** Acres

1. Is the Operator the only owner in the dedicated acreage outlined on the plat below? YES ☒ NO ☐ ("Owner" means the person who has the right to drill into and to produce from any pool and to appropriate the production either for himself or for himself and another. (65-3-29 (e) NMSA 1935 Comp.)
2. If the answer to question one is "no," have the interests of all the owners been consolidated by communitization agreement or otherwise? YES ☐ NO ☐ If answer is "yes," Type of Consolidation _____
3. If the answer to question two is "no," list all the owners and their respective interests below:

Owner	Land Description

SECTION B

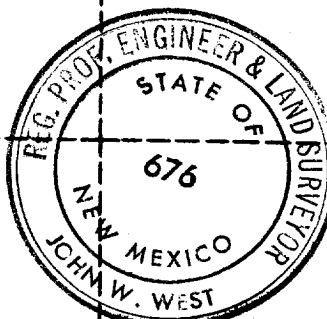
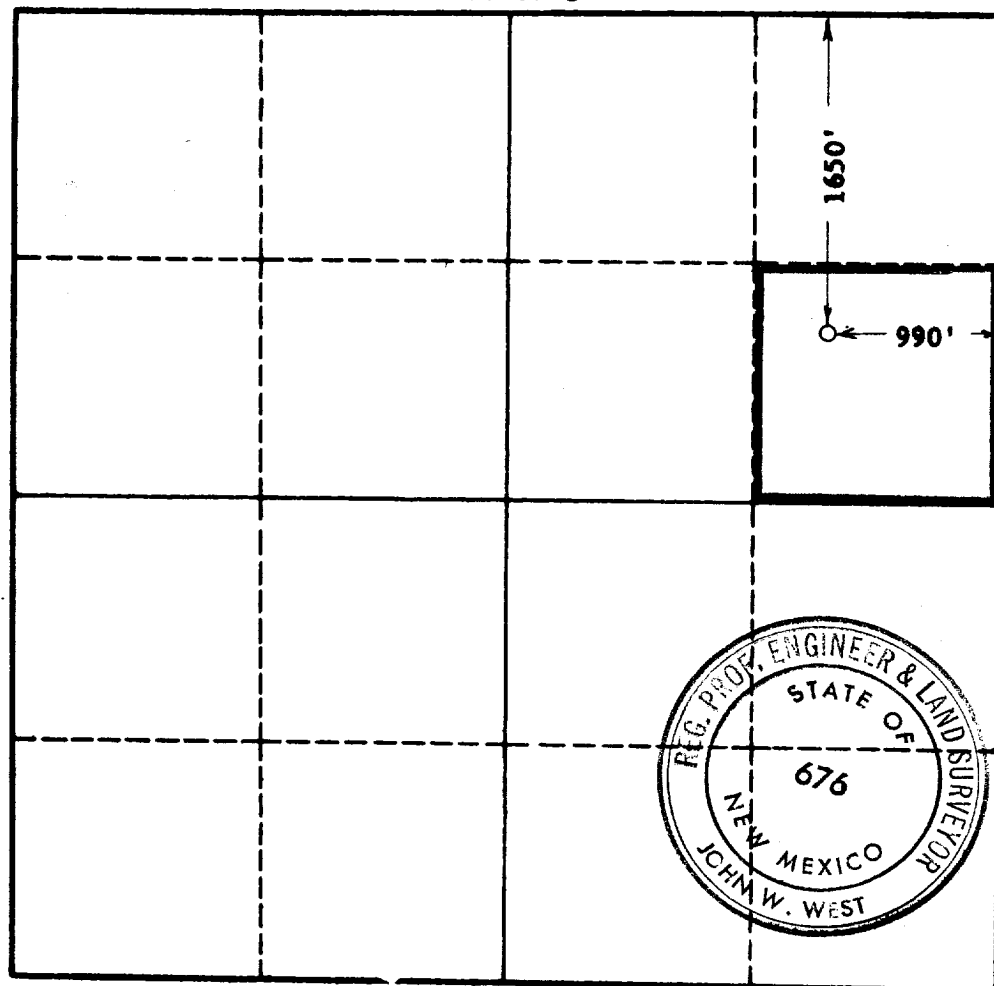

CERTIFICATION

I hereby certify that the information in SECTION A above is true and complete to the best of my knowledge and belief.

Name Original Signed by: **V. E. STALEY**
Position **Area Superintendent**
Company **Pan American Petroleum Corp.**
Date **March 1, 1963**

I hereby certify that the well location shown on the plat in SECTION B was plotted from field notes of actual surveys made by me or under my supervision, and that the same is true and correct to the best of my knowledge and belief.

Date Surveyed **FEB. 27, 1963**
Registered Professional Engineer and/or Land Surveyor, **JOHN W. WEST**
John W. West
Certificate No. **N. M. - P. E. & L. S. NO. 676**