

NUMBER OF COPIES RECEIVED	
DISTRIBUTION	
SANTA FE	
FILE	
U.S.G.A.	
LAND OFFICE	
TRANSPORTER	OIL GAS
PROBATION OFFICE	
OPERATOR	

# NEW MEXICO OIL CONSERVATION COMMISSION

Santa Fe, New Mexico

Form C-101  
Revised 12/1/55

HOBBS OFFICE O. C. C.

## NOTICE OF INTENTION TO DRILL

Notice must be given to the District Office of the Oil Conservation Commission and approval obtained before drilling or recompletion begins. If changes in the proposed plan are considered advisable, a copy of this notice showing such changes will be returned to the sender. Submit this notice in QUINTUPLICATE. One copy will be returned following approval. See additional instructions in Rules and Regulations of the Commission. If State Land submit 6 Copies. Attach Form C-128 in triplicate to first 3 copies of Form C-101.

Midland, Texas

December 2, 1963

(Place)

(Date)

OIL CONSERVATION COMMISSION  
SANTA FE, NEW MEXICO

Gentlemen:

You are hereby notified that it is our intention to commence the Drilling of a well to be known as  
**TEXACO Inc.**

(Company or Operator)

State of New Mexico "AE"

(Lease)

Well No. 21

in E

The well is

located 1980

feet from the

North

line and 660

(Unit)

feet from the

West

line of Section 11

T 18-S

R 34-E

NMPM.

(GIVE LOCATION FROM SECTION LINE)

Vacuum Abo Reef

Pool,

Lea

County

If State Land the Oil and Gas Lease is No. B-1258-1

If patented land the owner is

Address

We propose to drill well with drilling equipment as follows: Rotary

The status of plugging bond is \$10,000 Surety Bond Maryland Casualty Company.

Drilling Contractor Unknown at present

We intend to complete this well in the Abo Reef

formation at an approximate depth of 9050

feet.

### CASING PROGRAM

We propose to use the following strings of Casing and to cement them as indicated:

Size of Hole	Size of Casing	Weight per Foot	New or Second Hand	Depth	Socks Cement
		SEE ATTACHED	SHEET		

If changes in the above plans become advisable we will notify you immediately.

ADDITIONAL INFORMATION (If recompletion give full details of proposed plan of work.)

Approved DEC 4 1963, 19  
Except as follows:

Sincerely yours,

TEXACO Inc.

(Company or Operator)

By

J. J. Velten

Position Division Civil Engineer

Send Communications regarding well to

Name Mr. J. J. Velten

Address P. O. Box 3109, Midland, Texas

OIL CONSERVATION COMMISSION

Bv

# CASING PROGRAM

HOBBS OFFICE O. C. C.

DEC 4 8 51 AM '63

We propose to use the following strings of Casing and to cement them as indicated:

Size of Hole	Size of Casing	Weight per Foot	New or Second Hand	Depth	Sacks Cement
15"	11-3/4"	42# & 23.72#	New	350'	300 sacks
10-5/8"	8-5/8"	24# & 32#	New	3480'	1800 sacks*
7-5/8"	2-7/8"	6.5#	New	9050'	1550 sacks**

\* 1600 sacks of Class "C" 8% gel and 200 sacks Class "C" neat.

\*\* 1300 sacks Class "C" 8% gel and 250 sacks Class "C" 4% gel.

## FORMATION TOPS EXPECTED

Anhydrite	1720'
Salt	1915'
Seven Rivers	3450'
San Andres	5075'
Abo Reef	8710'
Total Depth	9050'

**NEW MEXICO OIL CONSERVATION COMMISS. N**  
**WELL LOCATION AND ACREAGE DEDICATION PLAT**

FORM C-128  
 Revised 5/1/57

SEE INSTRUCTIONS FOR COMPLETING THIS FORM ON THE REVERSE SIDE

**SECTION A**

DEC 4 3 57 AM '63

Operator <b>TEXACO Inc.</b>		Lease <b>State of New Mexico "AE"</b>		Well No. <b>21</b>
Unit Letter <b>E</b>	Section <b>11</b>	Township <b>18 South</b>	Range <b>34 East</b>	County <b>Lea</b>
Actual Footage Location of Well: <b>1980</b> feet from the <b>North</b> line and <b>660</b> feet from the <b>West</b> line <b>Sec. 11</b>				
Ground Level Elev.	Producing Formation <b>Abo Reef</b>	Pool <b>Vacuum Abo Reef</b>	Dedicated Acreage: <b>40</b> Acres	

1. Is the Operator the only owner in the dedicated acreage outlined on the plat below? YES ☒ NO \_\_\_\_ . ("Owner" means the person who has the right to drill into and to produce from any pool and to appropriate the production either for himself or for himself and another. (65-3-29 (e) NMSA 1935 Comp.)
2. If the answer to question one is "no," have the interests of all the owners been consolidated by communitization agreement or otherwise? YES \_\_\_\_ NO \_\_\_\_ . If answer is "yes," Type of Consolidation \_\_\_\_\_
3. If the answer to question two is "no," list all the owners and their respective interests below:

Owner	Land Description

**SECTION B**

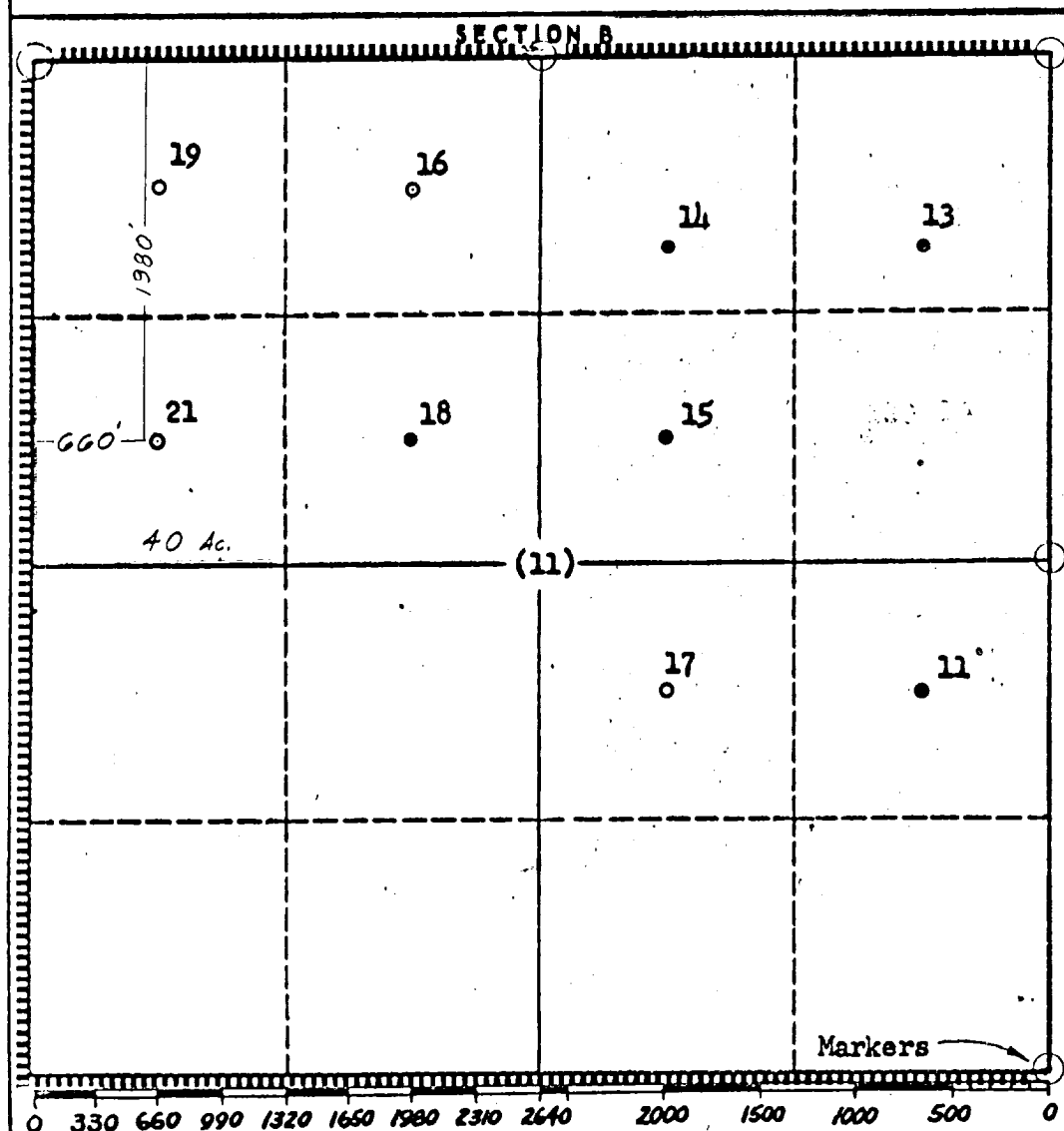

**CERTIFICATION**

I hereby certify that the information in SECTION A above is true and complete to the best of my knowledge and belief.

Name **J. J. Velten**  
 Position **Division Civil Engineer**  
 Company **TEXACO Inc.**  
 Date **12/2/63**

I hereby certify that the well location shown on the plat in SECTION B was plotted from field notes of actual surveys made by me or under my supervision, and that the same is true and correct to the best of my knowledge and belief.

Date Surveyed **12-2-63**  
 Registered Professional Engineer and/or Land Surveyor  
**J. J. Velten**  
 Certificate No. **8174**