

NUMBER OF COPIES RECEIVED	
DISTRIBUTION	
SANTA FE	
FILE	
U.S.G.S.	
LAND OFFICE	
TRANSPORTER	OIL GAS
PRODUCTION OFFICE	
OPERATOR	

NEW MEXICO OIL CONSERVATION COMMISSION
Santa Fe, New Mexico

Form C-101
Revised (12/1/55)

NOTICE OF INTENTION TO DRILL

OCT 2 1963
3:44 PM '63

Notice must be given to the District Office of the Oil Conservation Commission and approval obtained before drilling or re-completion begins. If changes in the proposed plan are considered advisable, a copy of this notice showing such changes will be returned to the sender. Submit this notice in **QUINTUPLICATE**. One copy will be returned following approval. See additional instructions in Rules and Regulations of the Commission. **If State Land submit 6 Copies Attach Form C-128 in triplicate to first 3 copies of form C-101**

Midland, Texas
(Place)

September 30, 1963
(Date)

**OIL CONSERVATION COMMISSION
SANTA FE, NEW MEXICO**

Gentlemen:

You are hereby notified that it is our intention to commence the Drilling of a well to be known as
DOB Oil Properties, Inc.

(Company or Operator)

State M

(Lease)

Well No. 3, in D (Unit) The well is

located 853 feet from the West line and 330 feet from the North line of Section 7, T. 18S, R. 34E, NMPM.

(GIVE LOCATION FROM SECTION LINE) E - K Queen Pool, Lea County

If State Land the Oil and Gas Lease is No. OG 2414

If patented land the owner is _____

Address _____

We propose to drill well with drilling equipment as follows: Rotary & cable tools

The status of plugging bond is Blanket Bond

Drilling Contractor Cactus Drilling Company

Box 32

Midland, Texas

We intend to complete this well in the Queen

formation at an approximate depth of 4520 feet.

CASING PROGRAM

We propose to use the following strings of Casing and to cement them as indicated:

Size of Hole	Size of Casing	Weight per Foot	New or Second Hand	Depth	Sacks Cement
<u>13</u>	<u>10 3/4</u>	<u>32.75</u>	<u>new</u>	<u>350</u>	<u>200</u>
<u>6 3/4</u>	<u>4 1/2</u>	<u>11.60</u>	<u>"</u>	<u>4520</u>	<u>400</u>

If changes in the above plans become advisable we will notify you immediately.

ADDITIONAL INFORMATION (If recompletion give full details of proposed plan of work.)

Approved _____, 19_____
Except as follows:

OIL CONSERVATION COMMISSION

By _____

Sincerely yours,

DOB Oil Properties, Inc.

(Company or Operator)

By [Signature]

Position Agent

Send Communications regarding well to

Name DOB Oil Properties, Inc.

Address Box 953, Midland, Texas

NEW MEXICO OIL CONSERVATION COMMISSION
WELL LOCATION AND ACREAGE DEDICATION PLAT

FORM C-12B
Revised 3/1/57

SEE INSTRUCTIONS FOR COMPLETING THIS FORM ON THE REVERSE SIDE

SECTION A

Operator

DOB OIL PROPERTIES, INC.

Lease

STATE M

Well No. 2

Unit Letter

D

Section

7

Township

18 SOUTH

Range

34 EAST

County

LEA

Actual Footage Location of Well:

853

feet from the

WEST

line and

330

feet from the

NORTH

line

Ground Level Elev.

4102.6

Producing Formation

Queen

Pool

E. K. Queen

Dedicated Acreage:

10.35 Acres

1. Is the Operator the only owner in the dedicated acreage outlined on the plat below? YES ☒ NO ☐ . ("Owner" means the person who has the right to drill into and to produce from any pool and to appropriate the production either for himself or for himself and another. (65-3-29 (c) NMSA 1935 Comp.)
2. If the answer to question one is "no," have the interests of all the owners been consolidated by communitization agreement or otherwise? YES ☐ NO ☐ . If answer is "yes," Type of Consolidation _____
3. If the answer to question two is "no," list all the owners and their respective interests below:

Owner

Land Description

SECTION B

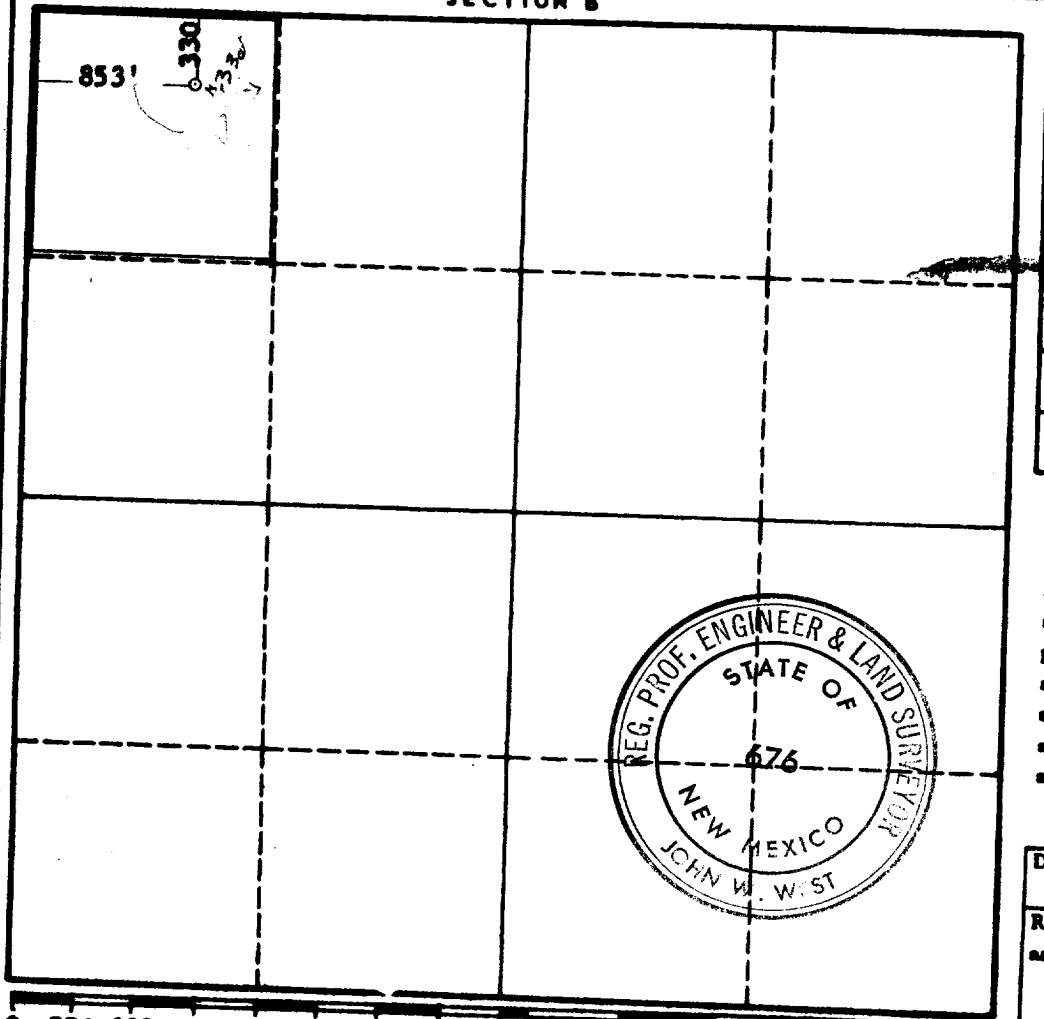

CERTIFICATION

I hereby certify that the information in SECTION A above is true and complete to the best of my knowledge and belief.

Name

Position

Agent

Company

DOB Oil Properties, Inc.

Date

9/30/63

I hereby certify that the well location shown on the plat in SECTION B was plotted from field notes of actual surveys made by me or under my supervision, and that the same is true and correct to the best of my knowledge and belief.

Date Surveyed

4-10-63

Registered Professional Engineer and/or Land Surveyor, JOHN W. WEST

Certificate No.

N.M. - P.E. & L.S. NO. 676