

NEW MEXICO OIL CONSERVATION COMMISSION
Santa Fe, New Mexico

NOTICE OF INTENTION TO DRILL

Notice must be given to the District Office of the Oil Conservation Commission and approval obtained before drilling or re-completion begins. If changes in the proposed plan are considered advisable, a copy of this notice showing such changes will be returned to the sender. Submit this notice in QUINTUPPLICATE. One copy will be returned following approval. See additional instructions in Rules and Regulations of the Commission. If State Land submit 6 Copies. Attach Form C-128 in triplicate to and 3 copies of Form C-101.

Midland, Texas (Place) July 22, 1963 (Date)

OIL CONSERVATION COMMISSION
SANTA FE, NEW MEXICO

Gentlemen:

You are hereby notified that it is our intention to commence the Drilling of a well to be known as

TEXACO INC.

(Company or Operator)

New Mexico "AE" (Lease), Well No. 13, in A (Unit) - The well is

located 660 feet from the North line and 660 feet from the East line of Section 11, T -18-S, R -34-E, NMPM.

(GIVE LOCATION FROM SECTION LINE) Vacuum Abo Reef Pool, Lea County

D	C	B	(A)
E	F	G	H
L	K	J	I
M	N	O	P

If State Land the Oil and Gas Lease is No. B-1258-1

If patented land the owner is _____

Address _____

We propose to drill well with drilling equipment as follows: Rotary

The status of plugging bond is \$10,000 blanket surety bond of Maryland Casualty Co. filed with State Geologist

Drilling Contractor Unknown at present

We intend to complete this well in the Abo Reef formation at an approximate depth of 8950 feet.

CASING PROGRAM

We propose to use the following strings of Casing and to cement them as indicated:

Size of Hole	Size of Casing	Weight per Foot	New or Second Hand	Depth	Sacks Cement
		SEE ATTACHED SHEET			

If changes in the above plans become advisable we will notify you immediately.

ADDITIONAL INFORMATION (If recompletion give full details of proposed plan of work.)

SEE ATTACHED SHEET

Approved _____, 19____
Except as follows:

Sincerely yours,

TEXACO INC.
(Company or Operator)

By J. J. Velten
Position Division Civil Engineer

Send Communications regarding well to

Name J. H. Markley
Address P. O. Box 3109, Midland, Texas

OIL CONSERVATION COMMISSION

CASING PROGRAM

to use the following strings of Casing and to cement them as

1953 JUL 21 PM 2 53

Size of Casing	Weight per Foot	New or Second Hand	Depth	Sacks Cement
11 7/8"	23.7	New	350'	300
8 1/2"	24 & 32	New	3260'	1650*
8 7/8"	6.5	New	8950'	1550**

4100 sx. 1:1 Pozmix-Portland regular cement mixture, 8% gel followed by 150 sx. Portland Heat.

Thoroughly clean & install centralizers & scratchers 8150 - TD. Cement with 800 sx. Class "C", 8% gel containing friction reducing agent, followed by 800 sx. Class "C", 8% gel, followed by 250 sx. Class "C", 4% gel. Pump plug down with acetic acid and water. Cement must tie in with int. casing.

FORMATION TOPS EXPECTED

Top of Anhydrite	1680'
Top of Salt	1840'
Base of Salt	2870'
Top of Yates	2980'
Top of Seven Rivers	3135'
Top of San Andres	4710'
Top of Abb Reef	8080'
Total Depth	8950'

NEW MEXICO OIL CONSERVATION COMMISSION
WELL LOCATION AND ACREAGE DEDICATION PLAT

FORM C-123
 Revised 5/1/57

SEE INSTRUCTIONS FOR COMPLETING THIS FORM ON THE REVERSE SIDE 53

SECTION A

Operator TEXACO Inc.		Lease State of New Mexico "AE"		Well No. 13
Unit Letter A	Section 11	Township 18 South	Range 34 East	County Lea
Actual Footage Location of Well: 990 feet from the North line and 660 feet from the East line Sec. 11				
Ground Level Elev. 4004	Producing Formation Abq Reef	Pool Vacuum Abq Reef	Dedicated Acreage: 40 Acres	

1. Is the Operator the only owner in the dedicated acreage outlined on the plat below? YES ☒ NO ☐ ("Owner" means the person who has the right to drill into and to produce from any pool and to appropriate the production either for himself or for himself and another. (65-3-29 (c) NMSA 1935 Comp.)
2. If the answer to question one is "no," have the interests of all the owners been consolidated by communitization agreement or otherwise? YES ☐ NO ☐ If answer is "yes," Type of Consolidation _____
3. If the answer to question two is "no," list all the owners and their respective interests below:

Owner	Land Description

SECTION B

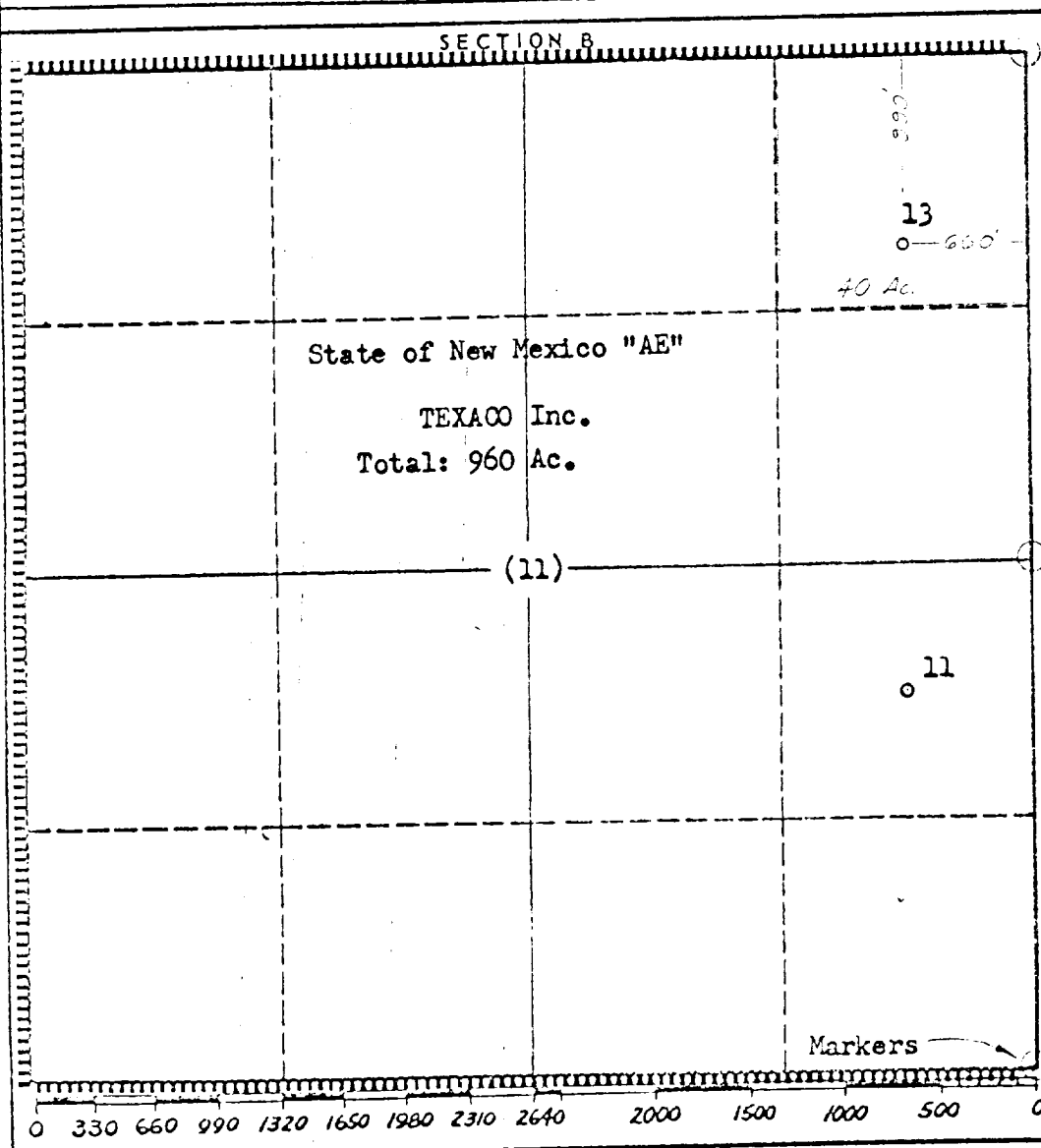

CERTIFICATION

I hereby certify that the information in SECTION A above is true and complete to the best of my knowledge and belief.

Name J. J. Velten
Position Division Civil Engineer
Company TEXACO Inc.
Date 7/22/63

I hereby certify that the well location shown on the plat in SECTION B was plotted from field notes of actual surveys made by me or under my supervision, and that the same is true and correct to the best of my knowledge and belief.

Date Surveyed 7/20/63
Registered Professional Engineer and/or Land Surveyor J. J. Velten
Certificate No. 8174