

UNITED STATES  
DEPARTMENT OF THE INTERIOR  
BUREAU OF LAND MANAGEMENT

APPLICATION FOR PERMIT TO DRILL, DEEPEN, OR PLUG BACK

1a. TYPE OF WORK RE-ENTER  
DRILL ☐ DEEPEN ☐ PLUG BACK ☐

b. TYPE OF WELL  
OIL WELL ☒ GAS WELL ☐ OTHER ☐ SINGLE ZONE ☒ MULTIPLE ZONES ☐

2. NAME OF OPERATOR  
Texaco Inc.

3. ADDRESS OF OPERATOR  
P. O. Box 728, Hobbs, New Mexico 88240

4. LOCATION OF WELL (Report location clearly and in accordance with any State requirements)  
At surface 1980' FSL & 1980' FWL  
At proposed prod. zone Same

14. DISTANCE IN MILES AND DIRECTION FROM NEAREST TOWN OR POST OFFICE\*  
6 Miles N.W. of Halfway, New Mexico

15. DISTANCE FROM PROPOSED\* LOCATION TO NEAREST PROPERTY OR LEASE LINE, FT. (Also to nearest drlg. unit line, if any)  
656'

18. DISTANCE FROM PROPOSED LOCATION\* TO NEAREST WELL, DRILLING, COMPLETED, OR APPLIED FOR, ON THIS LEASE, FT.  
1st Well 11,380' 7000'

21. ELEVATIONS (Show whether DF, RT, GR, etc.)  
3578 KB

23. PROPOSED CASING AND CEMENTING PROGRAM

SIZE OF HOLE	SIZE OF CASING	WEIGHT PER FOOT	SETTING DEPTH	QUANTITY OF CEMENT
17"	13-3/8"	48#	800'	600-Cement Circulated
12"	8-5/8"	32#	4604'	1750-TOC @ 425', Calc 75% fillup
7-7/8"	4-1/2"	11.6#	11,420'	600-TOC @ 8960' by T.S.

This well was originally drilled by New Mexico Oil Corp. in 1964. It was plugged and abandoned in 1971. It is proposed to re-enter the well and complete in the Delaware.

- Clean location. Remove P & A marker. MIRU and install 8-5/8" X 4-1/2" casing spool. Install BOP. Pressure test wellhead to 2000#.
- TIH w/7-7/8" bit. Drill out Surface Plug from 0'-35'. Drill out cement plugs @ 800'-900', 2400'-2500', and 4500'-4620'. Lower bit into 7-7/8" hole and drill out cement plug to 4-1/2" casing stub @ 4700'. Circulate clean. POH.
- TIH w/mill and dress top of 4-1/2" casing stub. TOH.
- TIH w/4-1/2" casing bowl overshot and 4700' of 4-1/2", 10.5# casing. Land casing bowl on stub and set. Set top of 4-1/2" casing in well head. Run 3-7/8" bit and c/o to 7000'

IN ABOVE SPACE DESCRIBE PROPOSED PROGRAM: If proposal is to deepen or plug back, give data on present productive zone and proposed new productive zone. If proposal is to drill or deepen directionally, give pertinent data on subsurface locations and measured and true vertical depths. Give blowout preventer program, if any.

24. SIGNED L. J. Seeman TITLE Dist. Petr. Engr. DATE 5/22/87  
(This space for Federal or State office use)

PERMIT NO. \_\_\_\_\_ APPROVAL DATE \_\_\_\_\_  
APPROVED BY Orig. Sgd. David L. Mari TITLE CARLSBAD RESOURCE AREA DATE 6-5-87  
CONDITIONS OF APPROVAL, IF ANY:

\*See Instructions On Reverse Side

SOUTHERN CALIFORNIA FEDERAL WELL NO. 3  
UNDESIGNATED DELAWARE  
LEA COUNTY, NEW MEXICO

Continuation to Form 3160-3

5. Perforate 2 cement squeeze holes @ 6900'.
6. TIH w/cement retainer and set @ 6850'. Establish rate and attempt to circulate to surface. Cement w/1850 sacks 50-50 Class "H" pozmix w/2% bentonite, 1% FLA, 1/4# Flocele, and 1# gilsonite per sack. (13.6 ppg, 1.43 cu. ft./sx.).
7. WOC. Run temperature survey to locate top of cement if doesn't circulate.
8. Pressure test 4-1/2" casing to 2000# from surface to cement retainer @ 2000'. If leaks occur, isolate and squeeze w/Class "H" cement. WOC. Drill out, pressure test. Re-squeeze if necessary.
9. GIH w/packer, spot acid @ 6660'-6710'. Set packer @ 6550', swab tubing down to 2500'. Load annulus.
10. Perforate @ 6685'-89' and 6692'-6700'. (14 intervals, 28 holes).
11. Acidize perfs @ 6685'-6700' w/3000 gallons 15% NEFE. Pump @ 6-8 BPM, Maximum Pressure 5000#. Flush to top perf, SI one hour. Swab well and test production. If favorable, go to 12 otherwise go to 14.
12. Frac perfs @ 6685'-6700' w/20,000 gallons gelled 2% KCL water and 30,000# 20-40 mesh sand. Pump in 5 stages, 1-4 ppg, 20 BPM, 5500#. SI 2 hours, swab/flow to test.
13. GIH w/RBP and set @ 6500'.
14. GIH w/packer, spot acid 6400-45'. Set packer @ 6300'. Swab fluid to 2200', load annulus.
15. Perf 6423-37'. 15 intervals, 30 holes.
16. Acidize perfs 6423'-37' w/3000 gallons 15% NEFE. Pump @ 6 BPM, 4500#. SI 1 hour. Swab well, test production.
17. Frac perfs 6423'-37' w/20,000 gallons gelled 2% KCL water and 30,000# 20-40 mesh sand. Pump @ 20 BPM in 5 stages, 1-4 ppg. SI two hours and swab/flow to test production.

RECEIVED  
JUN 8 1967  
OCD  
HOBBS OFFICE

SOUTHERN CALIFORNIA FEDERAL WELL NO. 3  
UNDESIGNATED DELAWARE  
LEA COUNTY, NEW MEXICO

Continuation to Form 3160-3

18. Evaluate production. If RBP is present below perfs @ 6423'-27', release and TOH.
19. If test are not favorable, set CIBP @ 6300' and cap w/35' cement.
20. TIH w/packer, spot acid @ 4700-45'. Set packer @ 4600'. Swab fluid down to 2500'. Load annulus.
21. Perforate @ 4718', 4728'-36', 87', 4791'-4801'. (22 intervals, holes).
22. Acidize perfs 4718'-4801' w/3000 gallons 15% NEFE, 6 BPM, 2500#. Flush, SI one hour. Swab and test production. Evaluate.
23. If necessary, frac 4718'-4801' w/20,000 gallons gelled 2% KCL water and 30,000# 20-40 mesh sand. Pump @ 25 BPM, 4500# 5 stages, 1-4 ppg sand. SI 2 hours, swab/flow to test.
24. Evaluate. If favorable, run production equipment.
25. RDPU. Clean location to BLM specs. Test production-

All distances must be from the outer boundaries of the Section.

Operator Texaco Inc.			Lease Southern California Federal		Well No. 3
Unit Letter K	Section 29	Township 19-S	Range 32-E	County Lea	
Actual Footage Location of Well: 1980 feet from the South line and 1980 feet from the West line					
Ground Level Elev. 3551'	Producing Formation Brushy Cherry Canyon/ Canyon		Pool Undesignated Delaware		Dedicated Acreage 40 Acres

1. Outline the acreage dedicated to the subject well by colored pencil or hachure marks on the plat below.
2. If more than one lease is dedicated to the well, outline each and identify the ownership thereof (both as to working interest and royalty).
3. If more than one lease of different ownership is dedicated to the well, have the interests of all owners been consolidated by communitization, unitization, force-pooling, etc?

☐ Yes ☐ No If answer is "yes," type of consolidation \_\_\_\_\_

If answer is "no," list the owners and tract descriptions which have actually been consolidated. (Use reverse side of this form if necessary.) \_\_\_\_\_

No allowable will be assigned to the well until all interests have been consolidated (by communitization, unitization, forced-pooling, or otherwise) or until a non-standard unit, eliminating such interests, has been approved by the Division.

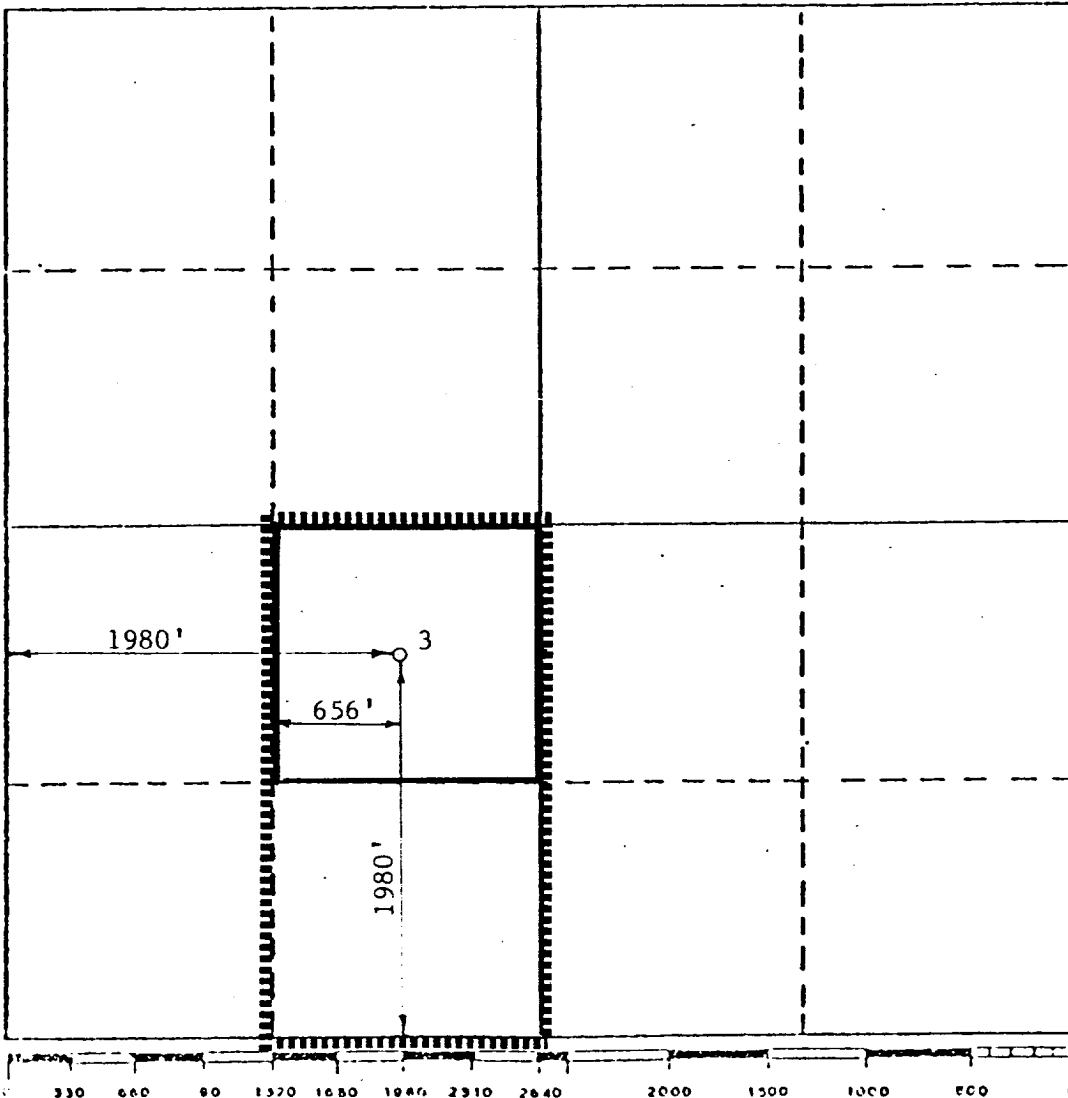

CERTIFICATION

I hereby certify that the information contained herein is true and complete to the best of my knowledge and belief.

*B. L. Eiland*  
Name

B. L. Eiland

Position

Division Surveyor

Company

Texaco Inc.

Date

May 19, 1987

I hereby certify that the well location shown on this plat was plotted from field notes of actual surveys made by me or under my supervision, and that the same is true and correct to the best of my knowledge and belief.

Date Surveyed  
May 13, 1987

Registered Professional Engineer  
and/or Land Surveyor

*B. L. Eiland*  
B. L. Eiland  
Certification No. 4386