

|                           |     |
|---------------------------|-----|
| NUMBER OF COPIES RECEIVED |     |
| DISTRIBUTION              |     |
| SANTA FE                  |     |
| FILE                      |     |
| U.S.G.S.                  |     |
| LAND OFFICE               |     |
| TRANSPORTER               | OIL |
|                           | GAS |
| PROBATION OFFICE          |     |
| OPERATOR                  |     |

NEW MEXICO OIL CONSERVATION COMMISSION  
Santa Fe, New Mexico

# NOTICE OF INTENTION TO DRILL

Notice must be given to the District Office of the Oil Conservation Commission and approval obtained before drilling or recompletion begins. If changes in the proposed plan are considered advisable, a copy of this notice showing such changes will be returned to the sender. Submit this notice in QUINTUPLICATE. One copy will be returned following approval. See additional instructions in Rules and Regulations of the Commission. If State Land submit 6 Copies. Attach Form C-128 in triplicate to first 3 copies of Form C-101.

Midland, Texas  
(Place)

August 14, 1963  
(Date)

OIL CONSERVATION COMMISSION  
SANTA FE, NEW MEXICO

Gentlemen:

You are hereby notified that it is our intention to commence the Drilling of a well to be known as

TEXACO INC.

(Company or Operator)

State of New Mexico "AE"  
(Lease)

Well No. 14

in B  
(Unit)

The well is

located 990 feet from the North line and 1980 feet from the East line of Section 11, T-18-S, R -34-E, NMPM.

(GIVE LOCATION FROM SECTION LINE) Vacuum Abo Reef Pool, Lea County

|   |   |   |   |
|---|---|---|---|
| D | C | B | A |
| E | F | G | H |
| L | K | J | I |
| M | N | O | P |

If State Land the Oil and Gas Lease is No. B-1258-1

If patented land the owner is

Address

We propose to drill well with drilling equipment as follows: Rotary

The status of plugging bond is \$10,000 blanket surety bond of Maryland Casualty Co. filed with State Geologist.

Drilling Contractor Unknown at present

We intend to complete this well in the Abo Reef formation at an approximate depth of 8950 feet.

## CASING PROGRAM

We propose to use the following strings of Casing and to cement them as indicated:

| Size of Hole | Size of Casing | Weight per Foot    | New or Second Hand | Depth | Sacks Cement |
|--------------|----------------|--------------------|--------------------|-------|--------------|
|              |                |                    |                    |       |              |
|              |                | SEE ATTACHED SHEET |                    |       |              |
|              |                |                    |                    |       |              |
|              |                |                    |                    |       |              |

If changes in the above plans become advisable we will notify you immediately.

ADDITIONAL INFORMATION (If recompletion give full details of proposed plan of work.)

SEE ATTACHED SHEET

Approved \_\_\_\_\_, 19\_\_\_\_  
Except as follows:

Sincerely yours,

TEXACO INC.  
(Company or Operator)

By J. J. Velten

Position Division Civil Engineer

Send Communications regarding well to

Name J. H. Markley

Address P. O. Box 3109, Midland, Texas

OIL CONSERVATION COMMISSION

By

# CASING PROGRAM

We propose to use the following strings of Casing and to cement them as indicated:

| Size of Hole | Size of Casing | Weight per Foot | New or Second Hand | Depth | Sacks Cement |
|--------------|----------------|-----------------|--------------------|-------|--------------|
| 15"          | 11 3/4"        | 42 & 23.72      | New                | 350'  | 300          |
| 10 5/8"      | 8 5/8"         | 24 & 32         | New                | 3360' | 1650*        |
| 7 5/8"       | 2 7/8"         | 6.5             | New                | 8950' | 1550**       |
|              |                |                 |                    |       |              |
|              |                |                 |                    |       |              |
|              |                |                 |                    |       |              |
|              |                |                 |                    |       |              |

\* 1500 sx. 1:1 Pozmix-Portland regular cement mixture, 8% gel, followed by 150 sx. Portland Neat.

\*\* Externally clean & install centralizers & scratchers 8150-TD. Cement with 500 sx. Class "C", 8% gel containing friction reducing agent, followed by 800 sx. Class "C", 8% gel followed by 250 sx. Class "C" 4% gel. Pump plug down with acetic acid and water. Cement must tie in with int. casing.

## FORMATION TOPS EXPECTED

|                     |       |
|---------------------|-------|
| Top of Anhydrite    | 1702' |
| Top of Salt         | 1865' |
| Base of Salt        | 2900' |
| Top of Yates        | 3065' |
| Top of Seven Rivers | 3230' |
| Top of San Andres   | 4776' |
| Top of Abo Reef     | 8065' |
| Total Depth         | 8950' |

NEW MEXICO OIL CONSERVATION COMMISSION  
WELL LOCATION AND ACREAGE DEDICATION PLAT

FORM C-128  
Revised 5/1/57

SEE INSTRUCTIONS FOR COMPLETING THIS FORM ON THE REVERSE SIDE

SECTION A

|   |                                 |                                   |                         |                                |
|---|---------------------------------|-----------------------------------|-------------------------|--------------------------------|
| Operator<br>TEXACO Inc.   |                                 | Lease<br>State of New Mexico "AE" |                         | Well No.<br>14                 |
| Unit Letter<br>B  | Section<br>11                   | Township<br>18 South              | Range<br>34 East        | County<br>Loa                  |
| Actual Footage Location of Well:<br>990 feet from the North line and 1980 feet from the East line Sec. 11 |                                 |                                   |                         |                                |
| Ground Level Elev.<br>4000  | Producing Formation<br>Abo Reef |                                   | Pool<br>Vacuum Abo Reef | Dedicated Acreage:<br>40 Acres |

1. Is the Operator the only owner in the dedicated acreage outlined on the plat below? YES ☒ NO ☐ ("Owner" means the person who has the right to drill into and to produce from any pool and to appropriate the production either for himself or for himself and another. (65-3-29 (e) NMSA 1935 Comp.)
2. If the answer to question one is "no," have the interests of all the owners been consolidated by communitization agreement or otherwise? YES ☐ NO ☐ If answer is "yes," Type of Consolidation \_\_\_\_\_
3. If the answer to question two is "no," list all the owners and their respective interests below:

|       |                  |
|-------|------------------|
| Owner | Land Description |
|       |                  |

SECTION B

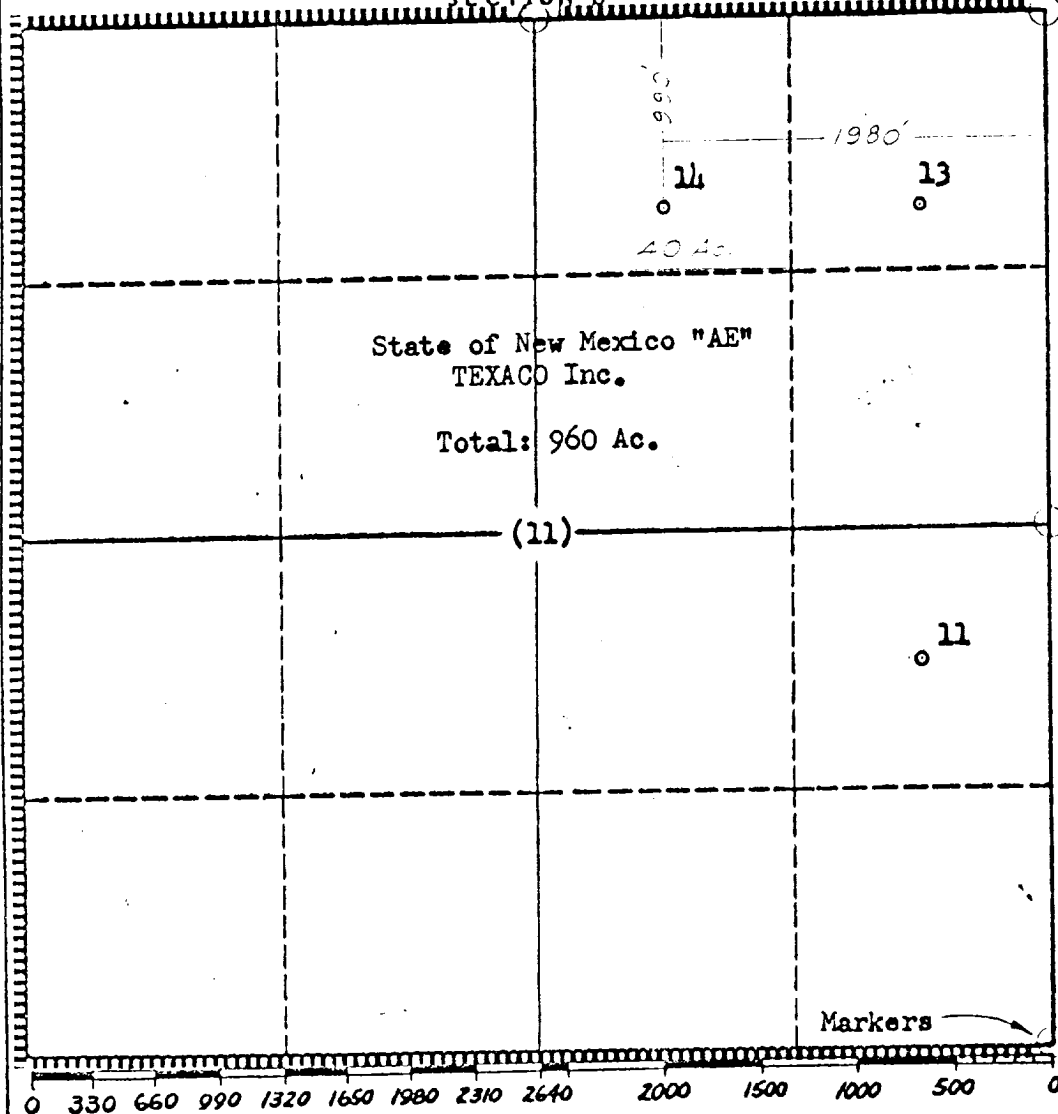

CERTIFICATION

I hereby certify that the information in SECTION A above is true and complete to the best of my knowledge and belief.

|          |                         |
|----------|-------------------------|
| Name     | J. J. Velten            |
| Position | Division Civil Engineer |
| Company  | TEXACO Inc.             |
| Date     | 8/14/63                 |

I hereby certify that the well location shown on the plat in SECTION B was plotted from field notes of actual surveys made by me or under my supervision, and that the same is true and correct to the best of my knowledge and belief.

|   |              |
|---|--------------|
| Date Surveyed   | 8/13/63      |
| Registered Professional Engineer and/or Land Surveyor | J. J. Velten |
| Certificate No.                                       | 8174         |