

UNITED STATES  
DEPARTMENT OF THE INTERIOR  
BUREAU OF LAND MANAGEMENT

SUBMIT IN TRIPLICATE\*  
(Other instructions on  
reverse side)

Form approved.  
Budget Bureau No. 1004-0136  
Expires August 31, 1985

APPLICATION FOR PERMIT TO DRILL, DEEPEN, OR PLUG BACK

1a. TYPE OF WORK RE-ENTER  
DRILL ☐ DEEPEN ☐ PLUG BACK ☐

b. TYPE OF WELL  
OIL WELL ☒ GAS WELL ☐ OTHER ☐ SINGLE ZONE ☒ MULTIPLE ZONE ☐

2. NAME OF OPERATOR  
Texaco Inc.

3. ADDRESS OF OPERATOR  
P. O. Box 728, Hobbs, New Mexico 88240

4. LOCATION OF WELL (Report location clearly and in accordance with any State requirements.)\*  
At surface  
990' FSL & 660' FEL (Unit Letter P)  
At proposed prod. zone  
Same

14. DISTANCE IN MILES AND DIRECTION FROM NEAREST TOWN OR POST OFFICE\*  
6 Miles N.W. of Halfway, New Mexico

15. DISTANCE FROM PROPOSED\*  
LOCATION TO NEAREST  
PROPERTY OR LEASE LINE, FT.  
(Also to nearest drlg. unit line, if any) 660'

18. DISTANCE FROM PROPOSED LOCATION\*  
TO NEAREST WELL, DRILLING, COMPLETED,  
OR APPLIED FOR, ON THIS LEASE, FT. 1st Well 6865' (PBTD)

21. ELEVATIONS (Show whether DF, RT, GR, etc.)  
3547' GR

23. PROPOSED CASING AND CEMENTING PROGRAM

SIZE OF HOLE	SIZE OF CASING	WEIGHT PER FOOT	SETTING DEPTH	QUANTITY OF CEMENT
17"	13-3/8"	48#	809'	600 sxs (Circulated)
11"	8-5/8"	32#	3703'	1810 sxs Top @ 800'
7-7/8"	4-1/2"	11.6#	11,296'	600 sxs Top calc. @ 8500'

This well was originally drilled and completed by Shell Oil Co. in 1963. It was plugged and abandoned in 1968. It is proposed to re-enter the well and complete in the Delaware.

- Clean and rebuild location. Remove P & A marker. MIRU and install new 8-5/8" X 4-1/2" casing head. Install BOP. Pressure test wellhead to 2000#.
- TIH w/7-7/8" bit. Drill out cement plugs from surface to 36', 3629' to 3800', and from 4922' to 5000'. Clean out to 6865'.
- TIH w/5280' of 4-1/2" casing (10.5#) and 1585' 4-1/2" (11.6#). Set in casing head.

Continued on Pg. 2

IN ABOVE SPACE DESCRIBE PROPOSED PROGRAM: If proposal is to deepen or plug back, give data on present productive zone and proposed new productive zone. If proposal is to drill or deepen directionally, give pertinent data on subsurface locations and measured and true vertical depths. Give blowout preventer program, if any.

24. SIGNED L. J. Seeman TITLE Dist. Petr. Engr. DATE July 1, 1987  
(This space for Federal or State office use)

PERMIT NO. \_\_\_\_\_ APPROVAL DATE \_\_\_\_\_  
APPROVED BY Richard L. Mann TITLE \_\_\_\_\_ DATE 7-17-87  
CONDITIONS OF APPROVAL, IF ANY:

\*See Instructions On Reverse Side

Federal (USA) "J" Well No. 1  
Undesignated Delaware  
Lea County, New Mexico

Continuation to Form 3160-3

4. Cement w/950 sacks Lightweight w/1/4# Flocele (12.7 ppg, 1.84 cu.ft./sx). Tail w/310 sacks Class "H" w/1/4# Flocele (15.6 ppg, 1.18 cu. ft./sx.)
5. Run temperature survey if cement doesn't circulate.
6. Pressure test casing to 2000#.
7. GIH w/packer. Spot 100 gallons acetic acid from 6388' to 6239'.
8. Pull up to 6200'. Circulate packer fluid and set packer. Swab fluid level down to 5000'.
9. Perforate w/2 JSPF 6383'-6388'. (6 ft., 12 holes).
10. Acidize perms w/2000 gallon 15% NEFE acid. Maximum rate and pressure: 2 BPM, 3000 psi.
11. Swab/flow back acid residue. Fracture stimulate as necessary.
12. Swab/flow test well. Run production equipment. -- Place on production.

All distances must be from the outer boundaries of the Section.

Operator Texaco Inc.			Lease Federal USA "J"		Well No. 1
Unit Letter P	Section 30	Township 19-S	Range 32-E	County Lea	
Actual Footage Location of Well: 990 feet from the South line and 660 feet from the East line					
Ground Level Elev. 3547'	Producing Formation Brushy Cherry Canyon/Canyon		Pool Undesignated Delaware		Dedicated Acreage: 40 Acres

1. Outline the acreage dedicated to the subject well by colored pencil or hatchure marks on the plat below.
2. If more than one lease is dedicated to the well, outline each and identify the ownership thereof (both as to working interest and royalty).
3. If more than one lease of different ownership is dedicated to the well, have the interests of all owners been consolidated by communitization, unitization, force-pooling, etc?

☐ Yes ☐ No If answer is "yes," type of consolidation \_\_\_\_\_

If answer is "no," list the owners and tract descriptions which have actually been consolidated. (Use reverse side of this form if necessary.) \_\_\_\_\_

No allowable will be assigned to the well until all interests have been consolidated (by communitization, unitization, forced-pooling, or otherwise) or until a non-standard unit, eliminating such interests, has been approved by the Division.

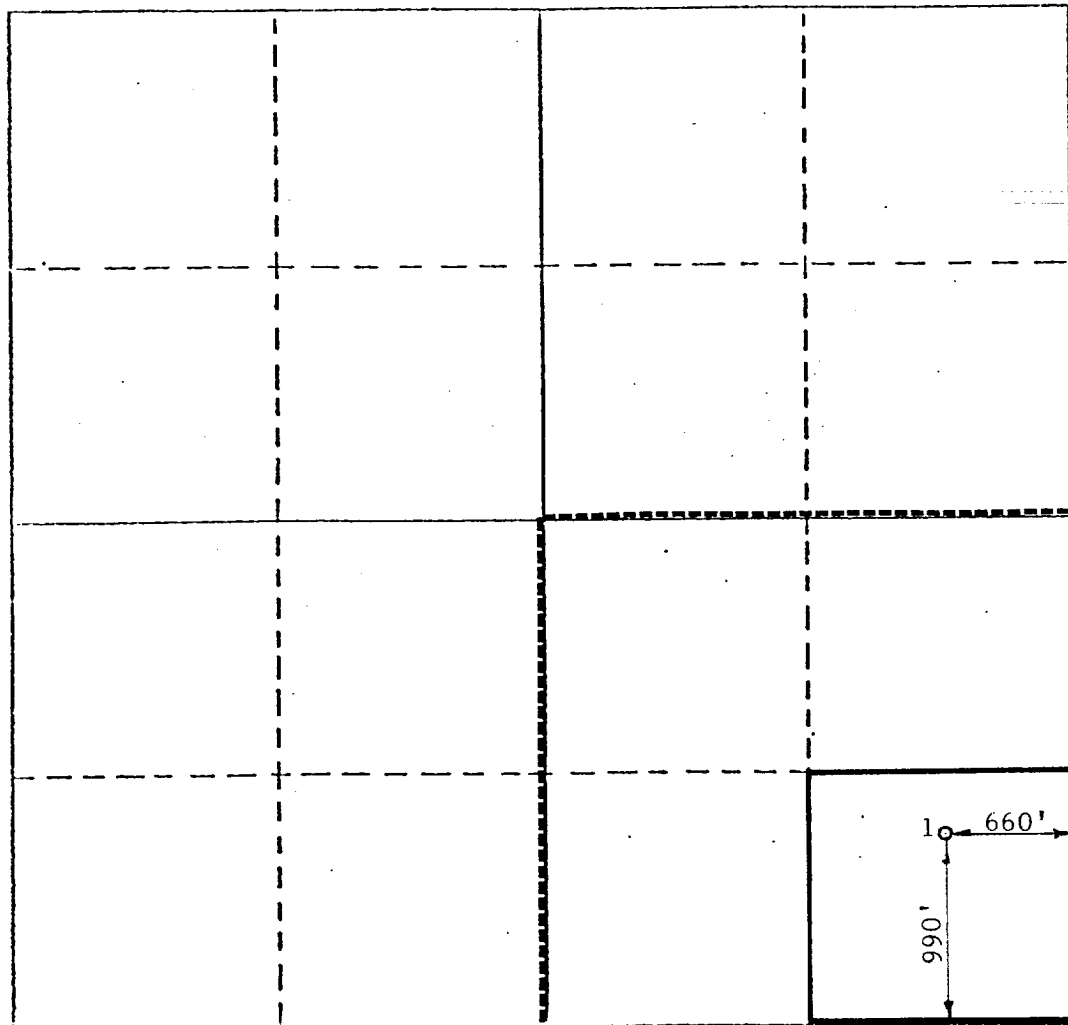

CERTIFICATION

I hereby certify that the information contained herein is true and complete to the best of my knowledge and belief.

*B. L. Eiland*

Name

B. L. Eiland

Position

Division Surveyor

Company

Texaco Inc.

Date

June 8, 1987

I hereby certify that the well location shown on this plat was plotted from field notes of actual surveys made by me or under my supervision, and that the same is true and correct to the best of my knowledge and belief.

Date Surveyed

May 13, 1987

Registered Professional Engineer  
and/or Land Surveyor

*B. L. Eiland*  
B. L. Eiland

Certificate No.

4386

ANTICIPATED WATER, OIL, GAS AND  
MINERALS BEARING FORMATIONS

Well: Federal (USA) "J" Well No. 1

Location: 990' FSL & 660' FEL, Section 30, T-19-S, R-32-E

County: Lea State: New Mexico

Elevation: 3547' Pool: Undesignated Delaware

FORMATION TOPS

DEPTH	FORMATION
880'	Anhydrite
2465'	Yates
2695'	Seven Rivers
4718'	Cherry Canyon
6423'	Brushy Canyon

Anticipated starting date will be within 7 days of approval date.

MUD PROGRAM

<u>DEPTH</u>	<u>TYPE</u>	<u>WEIGHT</u>
0-7000'	<del>Brine Water</del> → fresh	<del>10.0#</del>

Blowout preventer will be installed prior to drilling out cement plugs.

# DRILLING CONTROL CONDITION II-3000 PSI WP

ALL TRADE REGISTERED  
TRADE MARKS

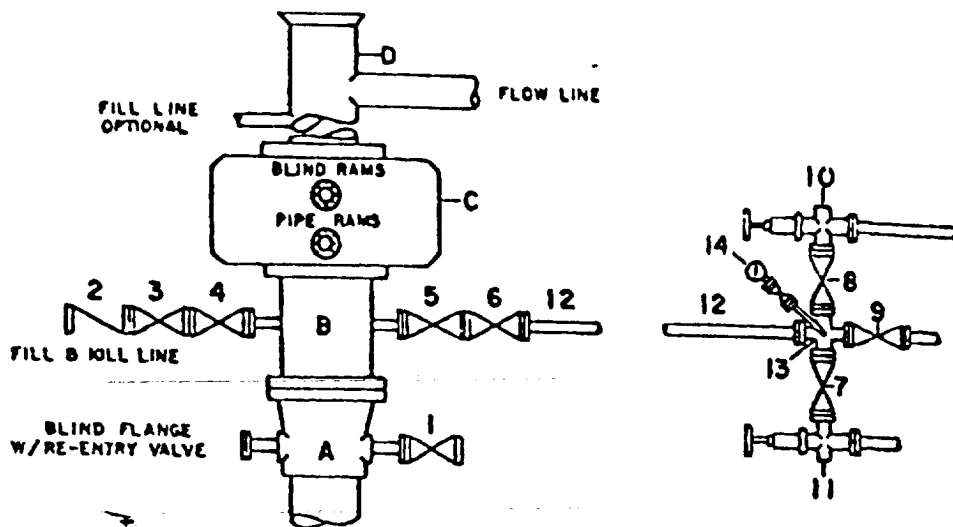

## DRILLING CONTROL

### MATERIAL LIST - CONDITION II

- A Texaco Wellhead
- B 3000# W.P. drilling spool with a 2" minimum flanged outlet for kill-line and 3" minimum flanged outlet for choke line
- C 3000# W.P. Dual ram type preventer, hydraulic operated with 1" steel, 3000# W.P. control lines (where sub-structure height is adequate, 2-3000# W.P. single ram type preventers may be utilized.)
- D Bell nipple with flowline and fill-up outlets. (Kill line may also be used for fill-up line.)
- 1,3,4, 7,8 2" minimum 3000# W.P. flanged full opening steel gate valve, or Halliburton Lo Torc Plug valve.
- 2 2" minimum 3000# W.P. back pressure valve
- 5,6,9 3" minimum 3000# W.P. flanged full opening steel gate valve, or Halliburton Lo Torc Plug valve
- 12 3" minimum schedule 80, Grade "B", seamless line pipe
- 13 2" minimum x 3" minimum 3000# W.P. flanged cross
- 10, 11 2" minimum 3000# W.P. adjustable choke bodies
- 14 Cameron Mud Gauge or equivalent (location optional in choke line.)



TEXACO, INC.  
WELLS DIVISION  
HOUSTON, TEXAS



SCALE	DATE	EST. NO.	CPG. NO.
DRAWN BY			
CHECKED BY			
APPROVED BY			

EXHIBIT B

RECEIVED  
JUL 17 1987  
OCD  
HOBBS OFFICE