

HUMBLE LEASE NO. 37723 NEW MEXICO OIL CONSERVATION COMMISSION
STATE LEASE NO. B 936 Well Location and Acreage Dedication Plat
FEDERAL LEASE NO.

Form C-128
Revised 5/1/57

Section A.

Date March 19, 1963

Operator Humble Oil & Refining Co. Lease New Mexico State "BO"
Well No. 8 Unit Letter "B" Section 12 Township 18 South Range 34 East NMPN
Located 990 Feet From North Line, 1648 Feet From East Line
County Lea G. L. Elevation Later Dedicated Acreage 40 Acres
Name of Producing Formation Abq Pool Vacuum

1. Is the Operator the only owner* in the dedicated acreage outlined on the plat below?

Yes ☒ No ☐

2. If the answer to question one is "no", have the interests of all the owners been consolidated by communitization agreement or otherwise? Yes ☐ No ☐ If answer is "yes," Type of Consolidation _____

3. If the answer to question two is "no," list all the owners and thier respective interests below:

Owner

Land Description

Section B

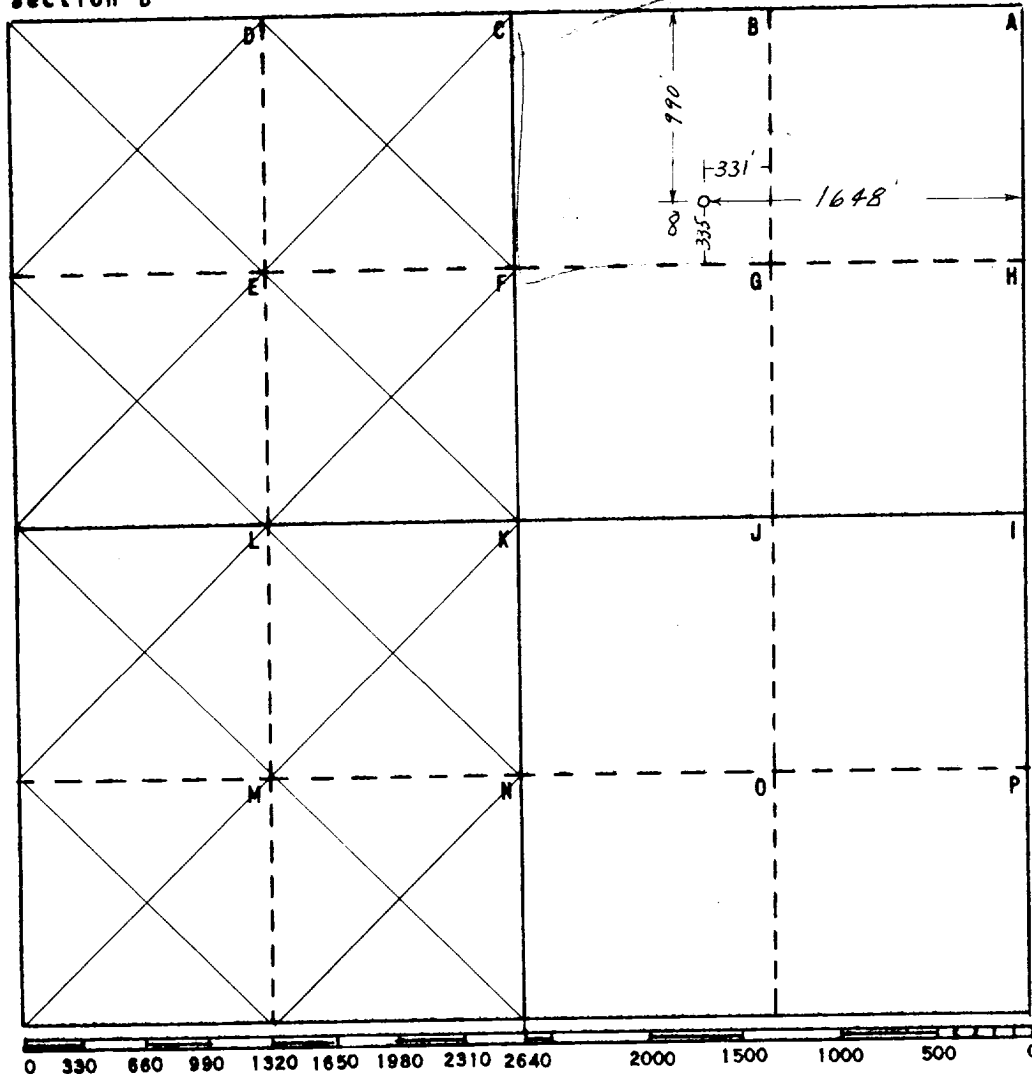

This is to certify that the information in Section A above is true and complete to the best of my knowledge and belief

HUMBLE OIL & REFG. CO.

(Operator)

Henry E. Heald
(Representative)

Box 1600 Midland, Texas
Address

This is to certify that the well location shown on the plat in Section B was plotted from field notes of actual surveys made by me or under my supervision and that the same is true and correct to the best of my knowledge and belief.

Date Surveyed 3-15-63

H. S. Hesterfield
Registered Professional
Engineer and/or Land Surveyor

Certificate No. 1382

FILE NO. W-A-3291