

DISTRIBUTION	
SANTA FE	
FILE	
U.S.S.	
LAND OFFICE	
TRANSPORTER	
OPERATION OFFICE	
OPERATOR	

NEW MEXICO OIL CONSERVATION COMMISSION
Santa Fe, New Mexico

Form O-101
Revised (12/1/55)
JUN 26 10 25 AM '64

NOTICE OF INTENTION TO DRILL

Notice must be given to the District Office of the Oil Conservation Commission and approval obtained before drilling or recompletion begins. If changes in the proposed plan are considered advisable, a copy of this notice showing such changes will be returned to the sender. Submit this notice in QUINTUPLICATE. One copy will be returned following approval. See additional instructions in Rules and Regulations of the Commission. If State Land submit 6 Copies Attach Form O-128 in triplicate to first 3 copies of form O-101

Hobbs, New Mexico

June 25, 1964

(Place)

(Date)

OIL CONSERVATION COMMISSION
SANTA FE, NEW MEXICO

Gentlemen:

You are hereby notified that it is our intention to commence the Drilling of a well to be known as

Marathon Oil Company

(Company, or Operator)

State Warn A/C # 2

Well No. 12

D

The well is

(Lease)

(Unit)

located 560 feet from the West line and 330 feet from the North line of Section 6, T. 18-S, R. 35-E, NMPM.

(GIVE LOCATION FROM SECTION LINE) UNDESIGNATED GLORIETA Lea County

If State Land the Oil and Gas Lease is No. 387

If patented land the owner is

Address

We propose to drill well with drilling equipment as follows: rotary tools

The status of plugging bond is current

Drilling Contractor Lowe Drilling Company, Inc.
Midland, Texas

We intend to complete this well in the Glorieta Prospect formation at an approximate depth of 6300 feet.

CASING PROGRAM

We propose to use the following strings of Casing and to cement them as indicated:

Size of Hole	Size of Casing	Weight per Foot	New or Second Hand	Depth	Sacks Cement
9-7/8"	7"	23#	Used	1500'	600
6-1/4"	4-1/2"	9.5 & 11.6#	New	6300'	1700

If changes in the above plans become advisable we will notify you immediately.

ADDITIONAL INFORMATION (If recompletion give full details of proposed plan of work.)

Approved....., 19.....
Except as follows:

Sincerely yours,

Marathon Oil Company

By

Position Supt.

Send Communications regarding well to

Name Marathon Oil Company

Address Box 220 Hobbs, New Mexico

OIL CONSERVATION COMMISSION

By

NEW MEXICO OIL CONSERVATION COMMISSION
WELL LOCATION AND ACREAGE DEDICATION PLAT

FORM C-128
Revised 5/1/57
HOBBS OFFICE O. C. C.

SEE INSTRUCTIONS FOR COMPLETING THIS FORM ON THE REVERSE SIDE

JUN 28 10 25 AM '64

SECTION A

Operator MARATHON OIL COMPANY			Lease STATE WARM A/C 2		Well No. 12
Unit Letter D	Section 6	Township 18 SOUTH	Range 35 EAST	County LEA	
Actual Footage Location of Well: 560 feet from the WEST line and 330 feet from the NORTH line					
Ground Level Elev.	Producing Formation GLORIETA PROSPECT		Pool UNDESIGNATED GLORIETA		Dedicated Acreage: 37.43 Acres

1. Is the Operator the only owner in the dedicated acreage outlined on the plat below? YES ☒ NO ☐ ("Owner" means the person who has the right to drill into and to produce from any pool and to appropriate the production either for himself or for himself and another. (65-3-29 (e) NMSA 1935 Comp.)
2. If the answer to question one is "no," have the interests of all the owners been consolidated by communization agreement or otherwise? YES ☐ NO ☐ If answer is "yes," Type of Consolidation _____
3. If the answer to question two is "no," list all the owners and their respective interests below:

Owner	Land Description

SECTION B

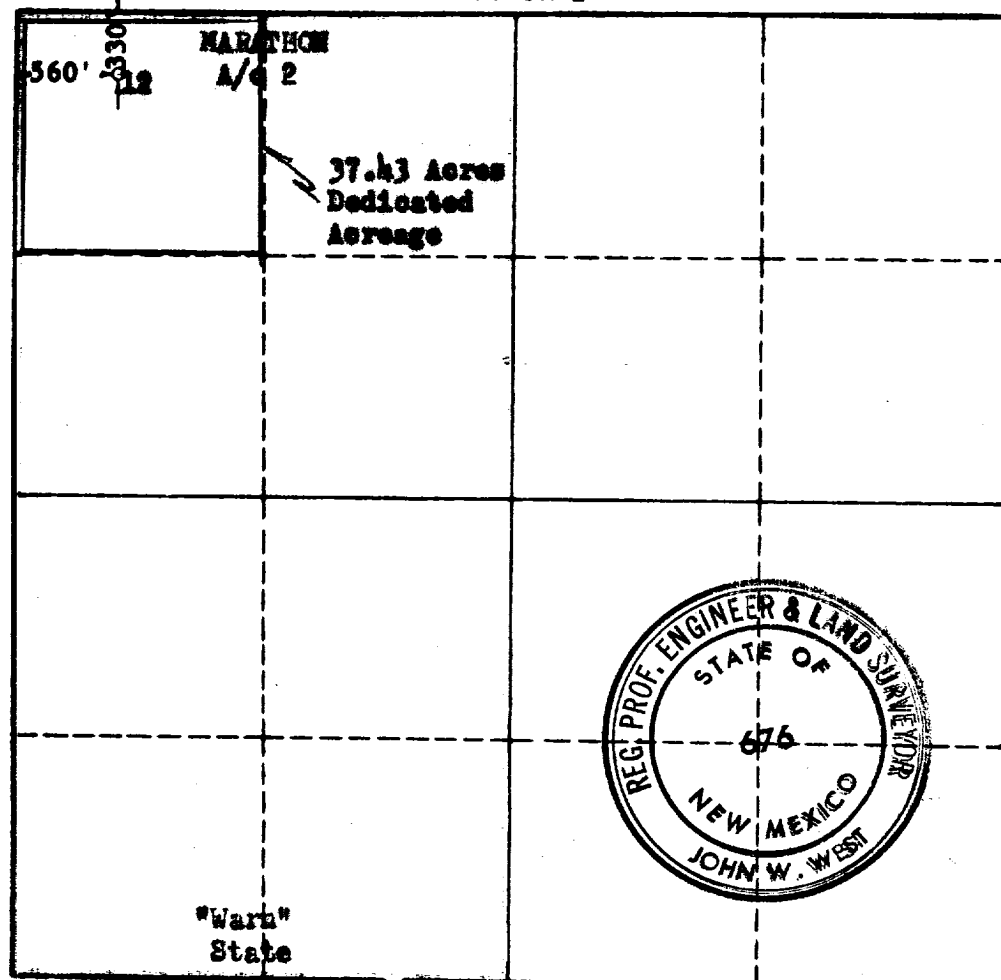

CERTIFICATION

I hereby certify that the information in SECTION A above is true and complete to the best of my knowledge and belief.

Name J. L. Frank
Position Petroleum Engineer
Company Marathon Oil Company
Date 6-24-64

I hereby certify that the well location shown on the plat in SECTION B was plotted from field notes of actual surveys made by me or under my supervision, and that the same is true and correct to the best of my knowledge and belief.

Date Surveyed JUNE 17, 1964
Registered Professional Engineer and/or Land Surveyor, JOHN W. WEST
Certificate No. 676

