

NEW MEXICO OIL CONSERVATION COMMISSION
WELL LOCATION AND ACREAGE DEDICATION PLAT

FORM C-128
Revised 5/1/57

SEE INSTRUCTIONS FOR COMPLETING THIS FORM ON THE REVERSE SIDE

SECTION 2 17 PM '64

Operator Shell Oil Company		Land Middleton Federal "B"		Well No. 2
Unit Letter I	Section 31	Township 19 South	Range 32 East	County Lea
Actual Footage Location of Well: 1980 feet from the south line and 660 feet from the east line				
Ground Level Elev. NOT AVAILABLE	Producing Formation Strawn		Pool Lusk-Strawn	Dedicated Acreage 160 Acres

1. Is the Operator the only owner in the dedicated acreage outlined on the plat below? YES X NO _____ ("Owner" means the person who has the right to drill into and to produce from any pool and to appropriate the production either for himself or for himself and another. (65-3-29 (e) NMSA 1955 Comp.)
2. If the answer to question one is "no," have the interests of all the owners been consolidated by compact, partition, agreement, or otherwise? YES _____ NO _____ If answer is "yes," Type of Consolidation _____
3. If the answer to question two is "no," list all the owners and their respective interests below

Owner	Land Description

RECEIVED
AUG - 4 1964
U. S. GEOLOGICAL SURVEY
ROSWELL, NEW MEXICO

SECTION B

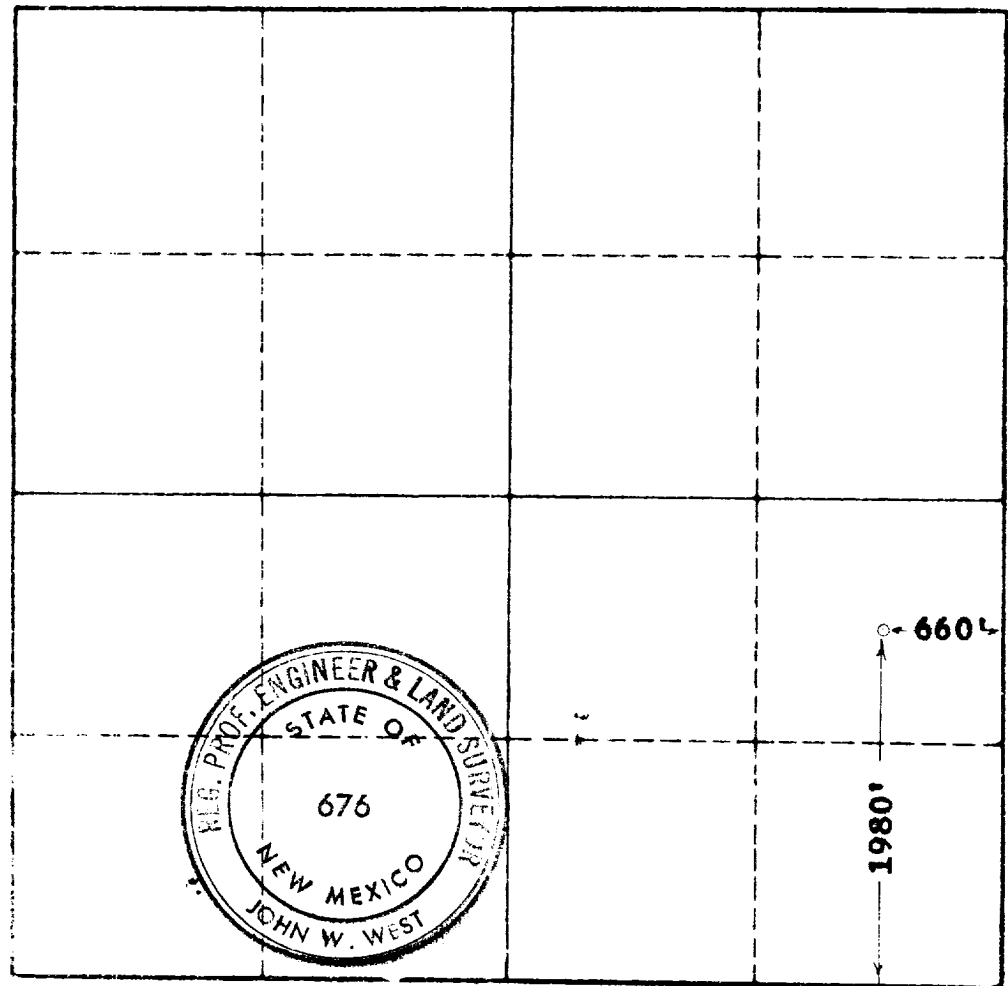

I hereby certify that the information in SECTION A above is true and complete to the best of my knowledge and belief.

Name	R. A. Lowery
Position	Exploitation Engineer
District	District 1
Company	Shell Oil Company
Date	July 30, 1964

I hereby certify that the well location shown on the plat in SECTION B was plotted from field notes of actual surveys made by me or under my supervision, and that the same is true and correct to the best of my knowledge and belief.

Date Surveyed	July 29, 1964
Registered Professional Engineer and/or Land Surveyor	JOHN W. WEST
Certificate No.	N. M. P. E. & L. S. NO. 676