

NUMBER OF COPIES RECEIVED	
DISTRIBUTION	
SANTA FE	
FILE	
U.S.G.S.	
LAND OFFICE	
TRANSPORTER	OIL GAS
PROBATION OFFICE	
OPERATOR	

# NEW MEXICO OIL CONSERVATION COMMISSION

Santa Fe, New Mexico

Form C-101  
Revised 12/1/55

## NOTICE OF INTENTION TO DRILL

HOPE OF OFFICE D.C.C.

Dec 20 10 20 AM '63

Notice must be given to the District Office of the Oil Conservation Commission and approval obtained before drilling or recompletion begins. If changes in the proposed plan are considered advisable, a copy of this notice showing such changes will be returned to the sender. Submit this notice in QUINTUPLICATE. One copy will be returned following approval. See additional instructions in Rules and Regulations of the Commission. If State Land submit 6 Copies. Attach Form C-128 in triplicate to first 3 copies of Form C-101.

Midland, Texas

December 18, 1963

(Place)

(Date)

OIL CONSERVATION COMMISSION  
SANTA FE, NEW MEXICO

Gentlemen:

You are hereby notified that it is our intention to commence the Drilling of a well to be known as  
**TEXACO Inc.**

(Company or Operator)

State of New Mexico "M", Well No. 6, in C The well is

(Lease)

(Unit)

located 460 feet from the North line and 1880 feet from the  
West line of Section 1, T--18-S, R-34-E, NMPM.

(GIVE LOCATION FROM SECTION LINE) Vacuum (Gl. & Bl.) Pool, Lea County

D	C	B	A
E	F	G	H
L	K	J	I
M	N	O	P

If State Land the Oil and Gas Lease is No B-1080-1

If patented land the owner is \_\_\_\_\_

Address \_\_\_\_\_

We propose to drill well with drilling equipment as follows: Rotary

The status of plugging bond is \$10,000 blanket surety bond Maryland Casualty Company filed with State Geologist

Drilling Contractor Unknown at present

We intend to complete this well in the Glorieta and Blinebry formation at an approximate depth of 6800 feet.

### CASING PROGRAM

We propose to use the following strings of Casing and to cement them as indicated:

Size of Hole	Size of Casing	Weight per Foot	New or Second Hand	Depth	Sacks Cement
		SEE ATTACHED SHEET			

If changes in the above plans become advisable we will notify you immediately.

ADDITIONAL INFORMATION (If recompletion give full details of proposed plan of work.)

Approved \_\_\_\_\_, 19\_\_\_\_

Except as follows:

Sincerely yours,

TEXACO Inc.

(Company or Operator)

By J. J. Velten

Position Division Civil Engineer

Send Communications regarding well to

Name J. J. Velten

Address P. O. Box 3109, Midland, Texas

OIL CONSERVATION COMMISSION

# CASING PROGRAM

We propose to use the following strings of Casing and to cement them as indicated:

Size of Hole	Size of Casing	Weight per Foot	New or Second Hand	Depth	Cost
15"	11-3/4"	42#	New	1550'	*1000
11" to 3300'	2-7/8"	6.4#	New	6800'	**
7-7/8" 3300' to TD	2-7/8"	6.4#	New	6800'	

\*800 sacks Class "C" 4% gel followed by 200 sacks Class "C" Neat

\*\*Externally clean, sand coat and install scratchers & centralizers opposite pays. Cement down both strings simultaneously w/ total of 1400 sacks Class "C" 4% gel. Use friction reducer in first 500 sacks. Precede slurry w/ 25 bbls. of salt water wash. Pump plugs down with 500 gal acetic followed with water - both strings.

## FORMATION TOPS EXPECTED

Anhydrite	1485'
Top salt	1600'
Base salt	2680'
Yates	2825'
Seven Rivers	2990'
San Andres	4275'
Glorieta	5800'
Blaine (mkr)	6500'
Total Depth	6800'

NEW MEXICO OIL CONSERVATION COMMISSION  
WELL LOCATION AND ACREAGE DEDICATION PLAT

HOBBS OFFICE L.O.C.-123  
REVISED 5/1/57

Dec 20 11 20 AM '63

SEE INSTRUCTIONS FOR COMPLETING THIS FORM ON THE REVERSE SIDE

SECTION A

Operator TEXACO Inc.			Lease State of New Mexico "M"		Well No. 6
Plat Letter C	Section 1	Township 18 South	Range 34 East	County Lea	
Actual Footage Location of Well: 460 feet from the North line and 1880 feet from the West line Sec. 1					
Ground Level Elev. 3994	Producing Formation Glorieta & Blinbry		Vacuum (Glorieta) Vacuum (Blinbry)		Dedicated Acreage: 40 Acres

1. Is the Operator the only owner in the dedicated acreage outlined on the plat below? YES X NO \_\_\_\_ . ("Owner" means the person who has the right to drill into and to produce from any pool and to appropriate the production either for himself or for himself and another. (65-3-29 (c) NMSA 1935 Comp.)
2. If the answer to question one is "no," have the interests of all the owners been consolidated by communization agreement or otherwise? YES \_\_\_\_ NO \_\_\_\_ . If answer is "yes," Type of Consolidation \_\_\_\_
3. If the answer to question two is "no," list all the owners and their respective interests below:

Owner	Land Description

SECTION B

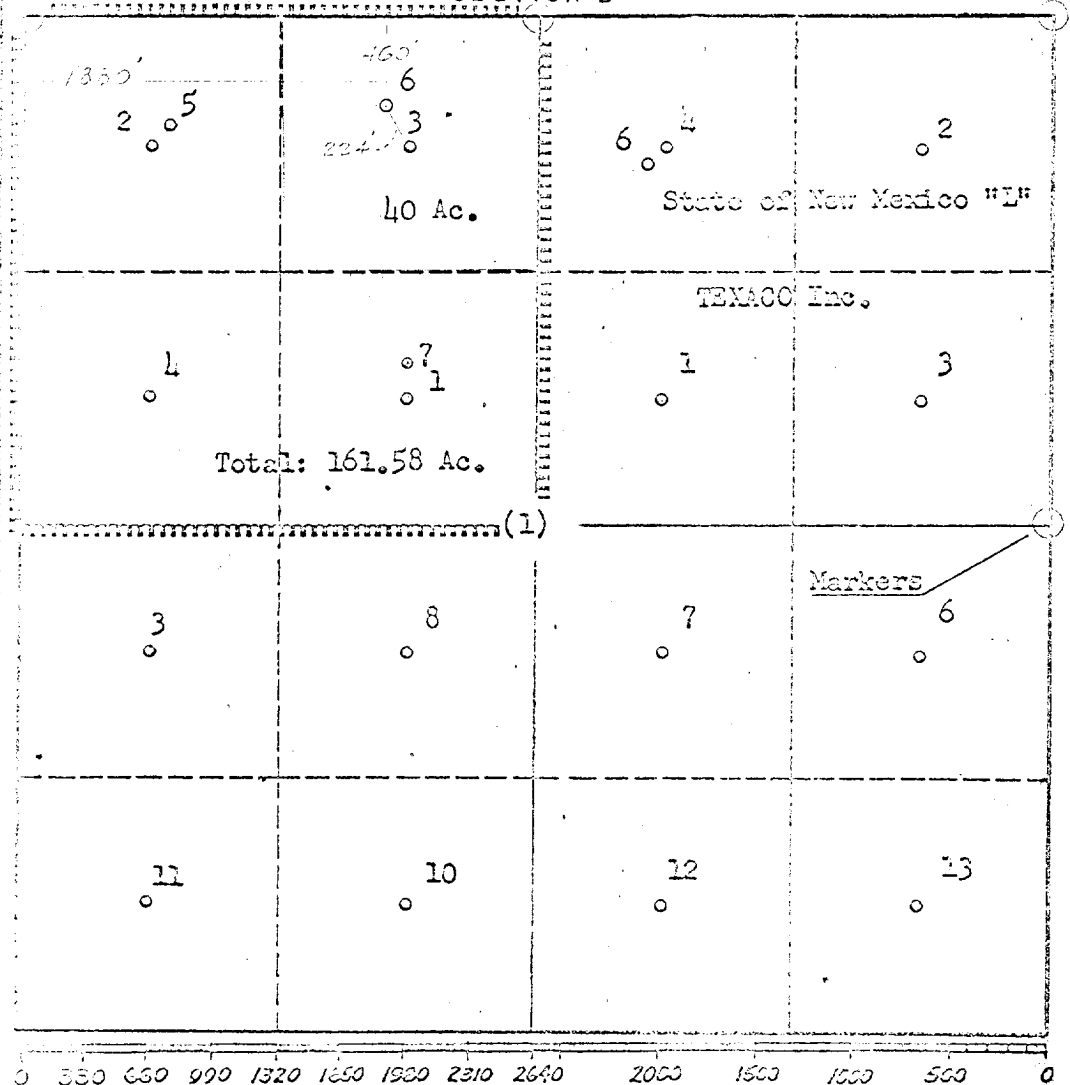

CERTIFICATION

I hereby certify that the information in SECTION A above is true and complete to the best of my knowledge and belief.

Name J. J. Velten  
Position Division Civil Engineer  
Company TEXACO Inc.  
Date 12/18/63

I hereby certify that the well location shown on the plat in SECTION B was plotted from field notes of actual surveys made by me or under my supervision, and that the same is true and correct to the best of my knowledge and belief.

Date Surveyed 12/17/63  
Registered Professional Engineer and/or Land Surveyor J. J. Velten  
Certificate No. 8174