

# NEW MEXICO OIL CONSERVATION COMMISSION

Santa Fe, New Mexico

## NOTICE OF INTENTION TO DRILL

NUMBER OF COPIES RECEIVED	
DISTRIBUTION	
SANTA FE	
FILE	
LAND OFFICE	
TRANSPORTER	OIL
	GAS
OPERATION OFFICE	
OPERATOR	

Notice must be given to the District Office of the Oil Conservation Commission before drilling or recompletion begins. If changes in the proposed plan are considered advisable, a copy of this notice showing such changes will be returned to the sender. Submit this notice in QUINTUPPLICATE. One copy will be returned following approval. See additional instructions in Rules and Regulations of the Commission. If State Land submit 6 Copies. Attach Form C-128 in triplicate to first 3 copies of Form C-101.

Midland, Texas

February 24, 1964

(Place)

(Date)

OIL CONSERVATION COMMISSION  
SANTA FE, NEW MEXICO

Gentlemen:

You are hereby notified that it is our intention to commence the Drilling of a well to be known as

TEXACO Inc.

(Company or Operator)

State of New Mexico "R" NCT-3, Well No. 15, in P The well is

located 487' feet from the south line and 560' feet from the east line of Section 1, T-18-S, R-34-E, NMPM.

(GIVE LOCATION FROM SECTION LINE) VACUUM, NMPM Pool, Lea County

If State Land the Oil and Gas Lease is No. B-1306-1

If patented land the owner is

Address Rotary

We propose to drill well with drilling equipment as follows:

The status of plugging bond is \$10,000 blanket surety bond Maryland Casualty Co. filed with State Geologist

Drilling Contractor unknown at present

We intend to complete this well in the Abo Reef & Wolfcamp formation at an approximate depth of 10,200 feet.

### CASING PROGRAM

We propose to use the following strings of Casing and to cement them as indicated:

Size of Hole	Size of Casing	Weight per Foot	New or Second Hand	Depth	Sacks Cement

If changes in the above plans become advisable we will notify you immediately.

ADDITIONAL INFORMATION (If recompletion give full details of proposed plan of work.)

FEB 27 1964

Approved \_\_\_\_\_, 19\_\_\_\_  
Except as follows:

Cement must tie back  
into 2 5/8 casing

Sincerely yours,

TEXACO Inc.

(Company or Operator)

By J. J. Velten

Position Division Civil Engineer

Send Communications regarding well to

Name J. J. Velten

Address P. O. Box 3109, Midland, Texas

OIL CONSERVATION COMMISSION

Engineer District 1

# CASING PROGRAM

We propose to use the following strings of Casing and to cement them as indicated:

Size of Hole	Size of Casing	Weight per Foot	New or Second Hand	Depth	Sacks Cement
17½"	13-3/8"	35.62#	New	350'	400 w/ accelerator
12¼"	9-5/8"	36# & 40#	New	4,800'	*
8-5/8"	2-7/8"	6.4#	New	10,200'	**
	2-7/8"	6.4#	New	10,200'	
	2-7/8"	6.4#	New	9,050'	

\*1500 sacks Class "C", 8% gel plus 200 sacks Class "C" neat. Should tie into surface casing.

\*\*Externally clean & install centralizers & scratchers over all prospective pays. Pull plug short string and cement down both long strings w/500 sacks Class "C", 2% gel, containing friction reducing agent for turbulent flow, followed by 1500 sacks Class "C", 4% gel followed by 400 sacks Class "C", 2% gel. Displace w/acetic acid - 500 gallons in each long string. Cement to tie into internal casing.

## FORMATION TOPS EXPECTED

San Andres	4465'
Glorieta	5945'
Blinebry (mkr)	6595'
Abo reef	8590'
Wolfcamp	9380'
Wolfcamp reef	9505'
Lower Wolfcamp	9955'
Total Depth	10,200'

**NEW MEXICO OIL CONSERVATION COMMISSION**  
**WELL LOCATION AND ACREAGE DEDICATION PLAT**

FORM C-128  
Revised 5/1/57

SEE INSTRUCTIONS FOR COMPLETING THIS FORM ON THE REVERSE SIDE

DEPT. OF AGRIC. O.C.C.

**SECTION A**

Operator <b>TEXACO Inc.</b>		Lease State of New Mexico "R" FEB 27 1964 NCT-3		Well No. AM '64
Unit Letter <b>P</b>	Section <b>1</b>	Township <b>18 South</b>	Range <b>34 East</b>	County <b>Lea</b>
Actual Footage Location of Well: <b>487</b> feet from the <b>South</b> line and <b>560</b> feet from the <b>East</b> line Sec. 1				
Ground Level Elev. <b>3984</b>	Producing Formation "see attached sheet"	Pool "see attached sheet"	Dedicated Acreage: "see attached sheet" Acres	

1. Is the Operator the only owner in the dedicated acreage outlined on the plat below? YES X NO \_\_\_\_ . ("Owner" means the person who has the right to drill into and to produce from any pool and to appropriate the production either for himself or for himself and another. (65-3-29 (e) NMSA 1935 Comp.)
2. If the answer to question one is "no," have the interests of all the owners been consolidated by communitization agreement or otherwise? YES \_\_\_\_ NO \_\_\_\_ . If answer is "yes," Type of Consolidation \_\_\_\_
3. If the answer to question two is "no," list all the owners and their respective interests below:

Owner	Land Description

**SECTION B**

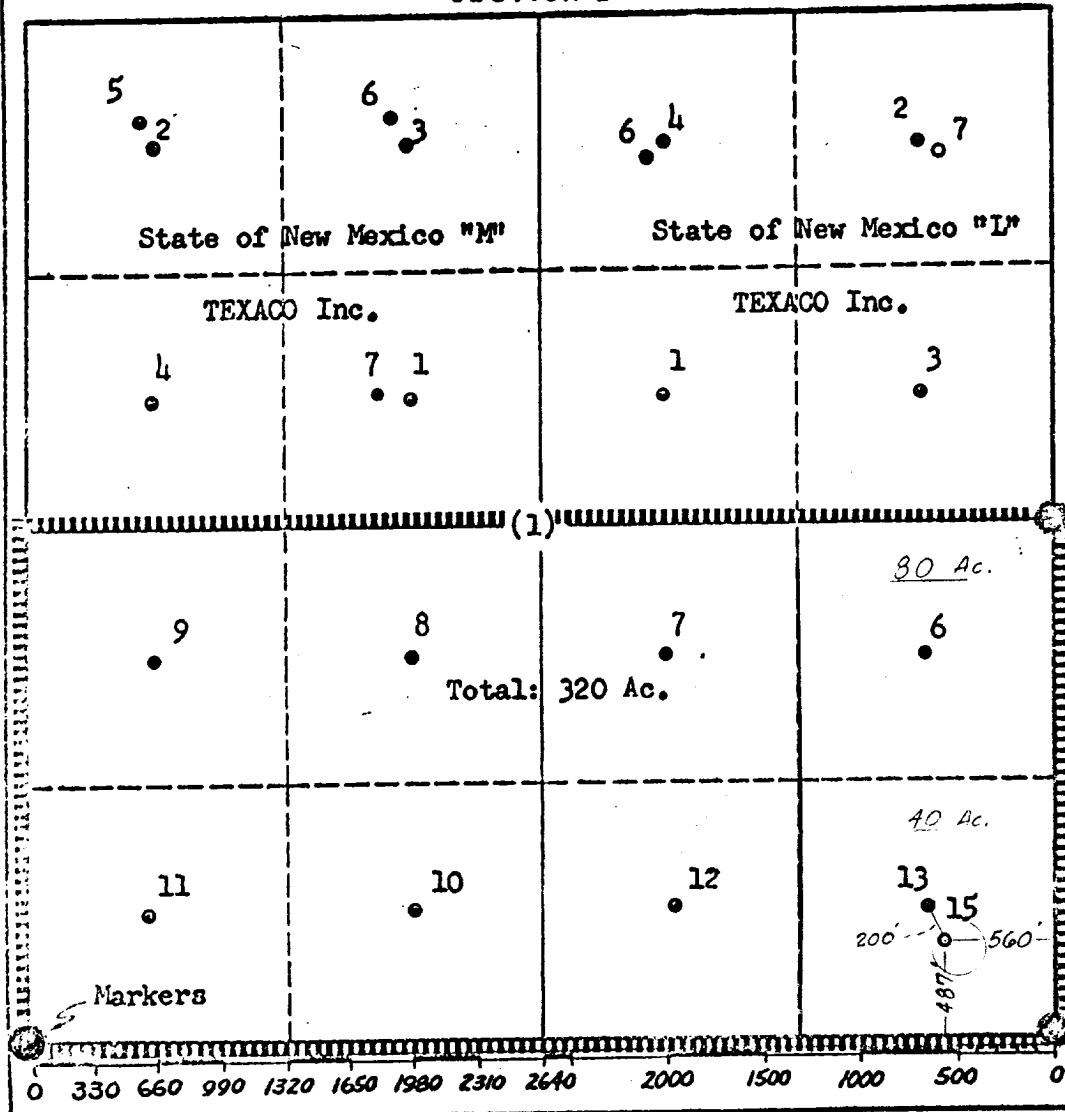

**CERTIFICATION**

I hereby certify that the information in SECTION A above is true and complete to the best of my knowledge and belief.

Name <b>J. J. Velten</b>
Position <b>Division Civil Engineer</b>
Company <b>TEXACO Inc.</b>
Date <b>2/24/64</b>

I hereby certify that the well location shown on the plat in SECTION B was plotted from field notes of actual surveys made by me or under my supervision, and that the same is true and correct to the best of my knowledge and belief.

Date Surveyed <b>2/21/64</b>
Registered Professional Engineer and/or Land Surveyor <b>J. J. Velten</b>
Certificate No. <b>8174</b>

**Producing Formations:**

Abo Reef  
Wolfcamp

**Pools:**

Vacuum- Abo Reef  
Vacuum - Wolfcamp

**Dedicated Acreage:**

Vacuum - Abo Reef	40 Acres
Vacuum - Wolfcamp	80 Acres