

NUMBER OF COPIES RECEIVED	
DISTRIBUTION	
SANTA FE	
FILE	
U.S.G.S.	
LAND OFFICE	
TRANSPORTER	OIL GAS
PROMOTION OFFICE	
OPERATOR	

NEW MEXICO OIL CONSERVATION COMMISSION  
Santa Fe, New Mexico

Form C-101  
Revised 12/1/55

NOTICE OF INTENTION TO DRILL

Notice must be given to the District Office of the Oil Conservation Commission and approval obtained before drilling or recompletion begins. If changes in the proposed plan are considered advisable, a copy of this notice showing such changes will be returned to the sender. Submit this notice in QUINTUPPLICATE. One copy will be returned following approval. See additional instructions in Rules and Regulations of the Commission. If State Land submit 6 Copies. Attach Form C-128 in triplicate to first 3 copies of Form C-101.

Midland, Texas

February 28, 1964

(Place)

(Date)

OIL CONSERVATION COMMISSION  
SANTA FE, NEW MEXICO

Gentlemen:

You are hereby notified that it is our intention to commence the Drilling of a well to be known as  
TEXACO Inc.

(Company or Operator)  
State of New Mexico "AA" NCT-4, Well No. 3, in B (Unit) The well is  
(Lease) located 660 feet from the north line and 1980 feet from the  
east line of Section 10, T-18-S, R-34-E, NMPM.

(GIVE LOCATION FROM SECTION LINE) Vacuum Abo Reef Pool, Lea County

D	C	B	A
E	F	G	H
L	K	J	I
M	N	O	P

If State Land the Oil and Gas Lease is No. B-3936-1

If patented land the owner is

Address

We propose to drill well with drilling equipment as follows: Rotary

The status of plugging bond is \$10,000 blanket surety bond with Maryland Casualty Co. filed with State Geologist

Drilling Contractor Unknown at present

We intend to complete this well in the Abo Reef formation at an approximate depth of 9050 feet.

CASING PROGRAM

We propose to use the following strings of Casing and to cement them as indicated:

Size of Hole	Size of Casing	Weight per Foot	New or Second Hand	Depth	Sacks Cement
		SEE ATTACHED SHEET			

If changes in the above plans become advisable we will notify you immediately.

ADDITIONAL INFORMATION (If recompletion give full details of proposed plan of work.)

Approved \_\_\_\_\_, 19\_\_\_\_  
Except as follows:

Sincerely yours,

TEXACO Inc.

(Company or Operator)

By T. G. Landwermeyer  
Position Civil Engineer

Send Communications regarding well to

Name J. J. Velten

Address P. O. Box 3109, Midland, Texas

OIL CONSERVATION COMMISSION

By \_\_\_\_\_

# CASING PROGRAM

We propose to use the following strings of Casing and to cement them as indicated:

Size of Hole	Size of Casing	Weight per Foot	New or Second Hand	Depth	Sacks Cement
15"	11-3/4"	23.72#	New	350'	300
10-5/8"	8-5/8"	24# & 32#	New	3300'	*
7-5/8"	2-7/8"	6.4#	New	9050'	**

\*1500 Sacks 1:1 Pozmix-Portland regular cement w/ 8% gel followed by 150 sacks Portland neat.

\*\*Externally clean & install centralizers & scratchers 8100-TD. Cement w/500 sacks Class "C" 8% gel containing friction reducing agent followed by 800 sacks Class "C", 8% gel, followed by 300 sacks Class "C" 4% gel. Pump plug down with 400 gallons medium strength acetic acid followed by water.

## FORMATION TOPS EXPECTED

Anhydrite	1740'
Top of Salt	1880'
Base of Salt	3010'
Seven Rivers	3270'
San Andres	5010'
Abo reef	8500'
Total Depth	9050'

FORM C-126  
Revised 5/1/57

15

Operator TEXACO Inc.		Lease State of New Mexico "AA" NCT-4		Well No. 3	
Oil Letter B	Section 10	Township 18 South	Range 34 East	County Lea	
Actual Footage Location of Well: 660 feet from the North line and 1980 feet from the East line Sec. 10					
Ground Level Elev. 4021	Producing Formation Abo Reef	Pool Vacuum Abo Reef		Dedicated Acreage: 40 Acres	

1. Is the Operator the only owner in the dedicated acreage outlined on the plat below? YES X NO \_\_\_\_\_. ("Owner" means the person who has the right to drill into and to produce from any pool and to appropriate the production either for himself or for himself and another. (65-3-29 (c) NMSA 1935 Comp.)
2. If the answer to question one is "no," have the interests of all the owners been consolidated by communitization agreement or otherwise? YES \_\_\_\_ NO \_\_\_\_\_. If answer is "yes," Type of Consolidation \_\_\_\_\_
3. If the answer to question two is "no," list all the owners and their respective interests below:

Owner	Land Description

### CERTIFICATION

I hereby certify that the information  
in SECTION A above is true and com-  
plete to the best of my knowledge and  
belief. *P. P.*

Name T. G. Landwermeyer  
Position Civil Engineer

Company **TEXACO Inc.**

Date 2/28/64

I hereby certify that the well location shown on the plat in SECTION B was plotted from field notes of actual surveys made by me or under my supervision, and that the same is true and correct to the best of my knowledge and belief.

Date Surveyed 2/27/64

Registered Professional Engineer  
and/or Land Surveyor

T. G. Landwerney  
Certificate No. 17617

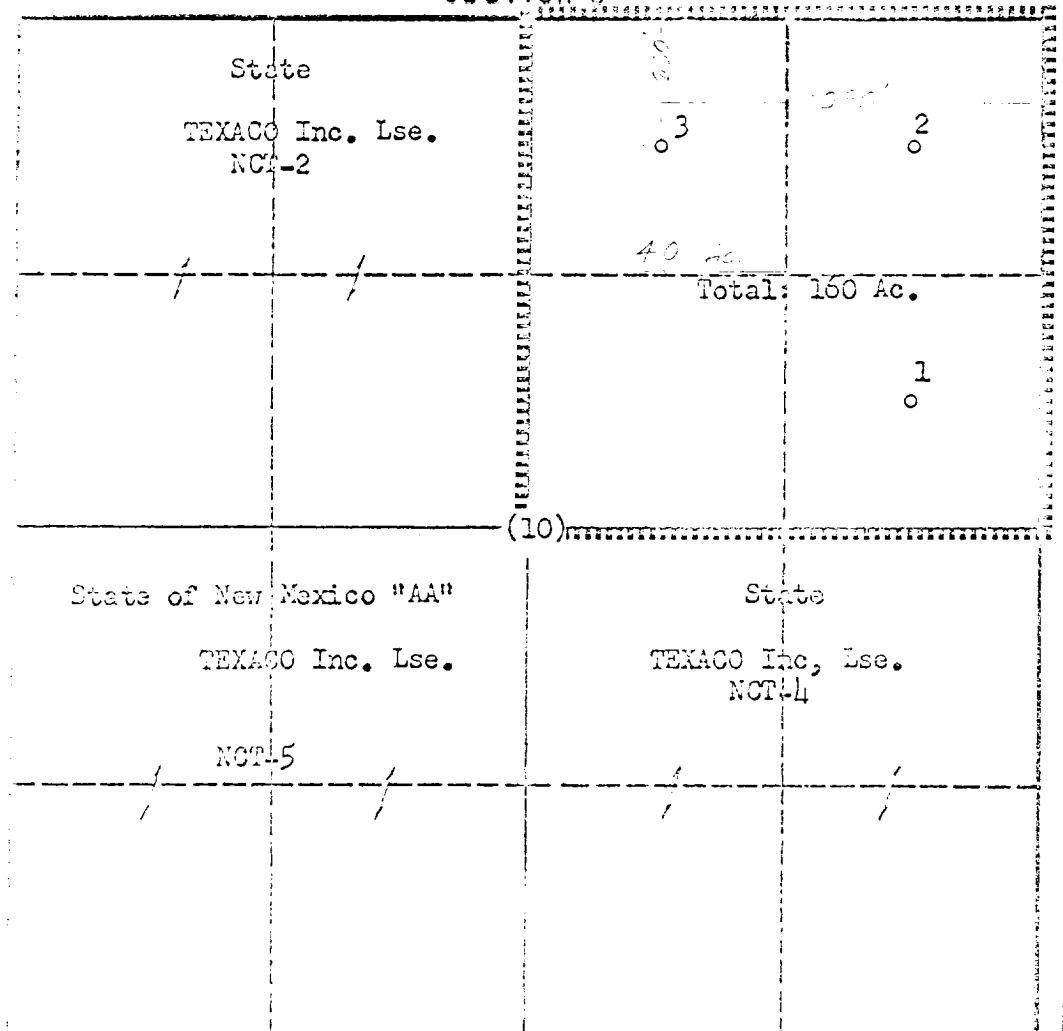

0	350	650	999	1320	1650	1980	2310	2640	2000	1500	1000	500	0
---	-----	-----	-----	------	------	------	------	------	------	------	------	-----	---