

COPIES RECEIVED	
DISTRIBUTION	
LAND OFFICE	
TRANSPORTER	OIL GAS
PRODUCTION OFFICE	
OPERATOR	

NEW MEXICO OIL CONSERVATION COMMISSION
Santa Fe, New Mexico

Form O-101
Revised (12/1/55)

NOTICE OF INTENTION TO DRILL

Notice must be given to the District Office of the Oil Conservation Commission and approval obtained before drilling or recompletion begins. If changes in the proposed plan are considered advisable, a copy of this notice showing such changes will be returned to the sender. Submit this notice in QUINTUPPLICATE. One copy will be returned following approval. See additional instructions in Rules and Regulations of the Commission.

If State Land submit 6 Copies Attach Form G-128 in triplicate to first 3 copies of form G-101

Monahans, Texas

(Place)

April 19, 1965

(Date)

OIL CONSERVATION COMMISSION
SANTA FE, NEW MEXICO

Gentlemen:

You are hereby notified that it is our intention to commence the Drilling of a well to be known as

PERRY R. BASS

(Company or Operator)

State 23

(Lease)

Well No. 4

in L

(Unit)

The well is

located 1650 feet from the South line and 330 feet from the

West

Line of Section 23, T. 18 S, R. 34 E, NMPM.

(GIVE LOCATION FROM SECTION LINE)

EK Queen, East

Pool

Lea

County

If State Land the Oil and Gas Lease is No. E-5014

If patented land the owner is

Address

We propose to drill well with drilling equipment as follows: Rotary tools, surface to total depth.

The status of plugging bond is Active

Drilling Contractor Not yet determined.

We intend to complete this well in the Queen

formation at an approximate depth of 5000 feet.

CASING PROGRAM

We propose to use the following strings of Casing and to cement them as indicated:

Size of Hole	Size of Casing	Weight per Foot	New or Second Hand	Depth	Sacks Cement
12-1/4"	8-5/8"	24	New	450	350
7-7/8"	5-1/2"	14	New	5000	400

If changes in the above plans become advisable we will notify you immediately.

ADDITIONAL INFORMATION (If recompletion give full details of proposed plan of work.)

The well is to be completed as a Queen Sand oil producer. The pay is expected to develop between 4500 and 4800' from the surface, and total depth will not exceed 5000'. Completion is to be made by gun-perforating and stimulating by fracture treatment. Cement will be circulated behind the 8-5/8" OD casing.

Approved: _____, 19_____
Except as follows:

Sincerely yours,

PERRY R. BASS

(Company or Operator)

By

Walter D. Powers

Position Assistant Division Manager

Send Communications regarding well to

Name PERRY R. BASS

Address Box 1178, Monahans, Texas

OIL CONSERVATION COMMISSION

By _____

NEW MEXICO OIL CONSERVATION COMMISSION
WELL LOCATION AND ACREAGE DEDICATION PLAT

FORM C-128
 Revised 5/1/57

SEE INSTRUCTIONS FOR COMPLETING THIS FORM ON THE REVERSE SIDE

SECTION A

Operator PERRY R. BASS			Lease STATE 23		Well No. 4
Unit Letter L	Section 23	Township 18 SOUTH	Range 34 EAST	County LEA	
Actual Footage Location of Well: 330 feet from the WEST line and 1650 feet from the SOUTH line					
Ground Level Elev.	Producing Formation QUEEN		Pool E K QUEEN UNDESIGNATED		Dedicated Acreage: Acres

1. Is the Operator the only owner in the dedicated acreage outlined on the plat below? YES ☒ NO ☐ "Owner" means the person who has the right to drill into and to produce from any pool and to appropriate the production either for himself or for himself and another. (65-3-29 (e) NMSA 1935 Comp.)
2. If the answer to question one is "no," have the interests of all the owners been consolidated by communitization agreement or otherwise? YES ☐ NO ☐ If answer is "yes," Type of Consolidation _____
3. If the answer to question two is "no," list all the owners and their respective interests below:

Owner	Lead Description

SECTION B

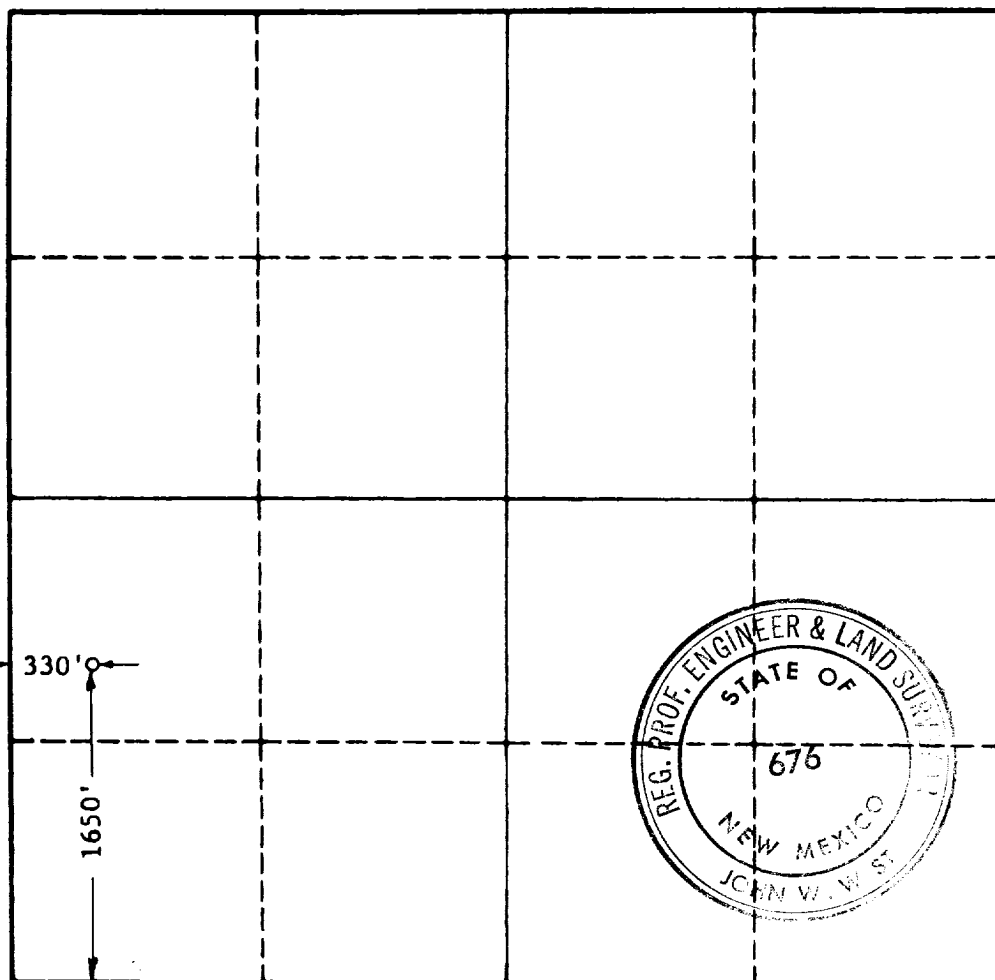

CERTIFICATION

I hereby certify that the information in SECTION A above is true and complete to the best of my knowledge and belief.

Name *John W. West*
 Position *EXPLOITATION ENGR.*
 Company *PERRY R. BASS*
 Date *APRIL 19, 1965*

I hereby certify that the well location shown on the plat in SECTION B was plotted from field notes of actual surveys made by me or under my supervision, and that the same is true and correct to the best of my knowledge and belief.

Date Surveyed
APRIL 17, 1965
 Registered Professional Engineer and/or Land Surveyor, **JOHN W. WEST**
John W. West
 Certificate No.
N.M. - P.E. & L.S. NO. 676

