



STATE OF NEW MEXICO
ENERGY, MINERALS AND NATURAL RESOURCES DEPARTMENT

OIL CONSERVATION DIVISION
HOBBS DISTRICT OFFICE

BRUCE KING
GOVERNOR

POST OFFICE BOX 1980
HOBBS, NEW MEXICO 88241-1980
(505) 393-6161

OIL CONSERVATION DIVISION
P. O. BOX 2088
SANTA FE, NEW MEXICO 87501

RE: Proposed:

MC _____
DHC _____
NSL X NSL-375A - amend to revise dedicated acreage
NSP _____
SWD _____
WFX _____
PMX _____

Gentlemen:

I have examined the application for the:

Southland Royalty Co. Uncle com #1-C 28-18-33
Operator Lease & Well No. Unit S-T-R

and my recommendations are as follows:

OK

Yours very truly,

Jerry Sexton
Jerry Sexton
Supervisor, District 1

/ed

MERIDIAN OIL

April 9, 1991

Mr. Michael Stogner
Oil Conservation Division
P. O. Box 2088
Santa Fe, New Mexico 87504-2088

RE: ADMINISTRATIVE ORDER NSL-375-A
SOUTHLAND ROYALTY COMPANY
UNCLE COM. WELL NO. 1
UNIT C, SEC. 28, T18S, R33E
LEA COUNTY, NEW MEXICO

need to amend

Dear Mr. Stogner:

Administrative Order NSL-375-A indicates the N/2 NW/4 of Sec. 28, T18S, R33E will be dedicated to the well to form a standard 80 acres spacing and proration unit for the well. In the NW/4 NW/4 of Sec. 28, Southland has rights to produce from the Morrow only. Therefore, the spacing and proration unit must be changed. A Form C-102 showing the E/2 NW/4 of Sec. 28 dedicated to this well is attached.

If other information is needed, please contact me at 915-686-5678.

Sincerely,



Robert L. Bradshaw
Sr. Staff Environmental Rep.

RLB/sm

c: Well File
Matador Petroleum Corp.
Road & Stevens, Inc.
BLM - Carlsbad
OCD - Hobbs
D. D. McBee

Submit to Appropriate
District Office
State Lease - 4 copies
Fee Lease - 3 copies

State of New Mexico
Energy, Minerals and Natural Resources Department

Form C-102
Revised 1-1-89

OIL CONSERVATION DIVISION

P.O. Box 2088
Santa Fe, New Mexico 87504-2088

DISTRICT I

P.O. Box 1980, Hobbs, NM 88240

DISTRICT II

P.O. Drawer DD, Artesia, NM 88210

DISTRICT III

1000 Rio Brazos Rd., Aztec, NM 87410

WELL LOCATION AND ACREAGE DEDICATION PLAT

All Distances must be from the outer boundaries of the section

Operator Southland Royalty Company			Lease Uncle Federal		Well No. 1
Unit Letter C	Section 28	Township 18 South	Range 33 East	County NMPM	Lea
Actual Footage Location of Well: 660 feet from the North line and 1650 feet from the West line					
Ground level Elev.		Producing Formation Wolfcamp	Pool South Corbin	Dedicated Acreage: 80 Acres	

1. Outline the acreage dedicated to the subject well by colored pencil or hatchure marks on the plat below.
2. If more than one lease is dedicated to the well, outline each and identify the ownership thereof (both as to working interest and royalty).
3. If more than one lease of different ownership is dedicated to the well, have the interest of all owners been consolidated by communitization, unitization, force-pooling, etc.?
☐ Yes ☐ No If answer is "yes" type of consolidation _____
If answer is "no" list the owners and tract descriptions which have actually been consolidated. (Use reverse side of this form if necessary).
No allowable will be assigned to the well until all interests have been consolidated (by communitization, unitization, forced-pooling, or otherwise) or until a non-standard unit, eliminating such interest, has been approved by the Division.

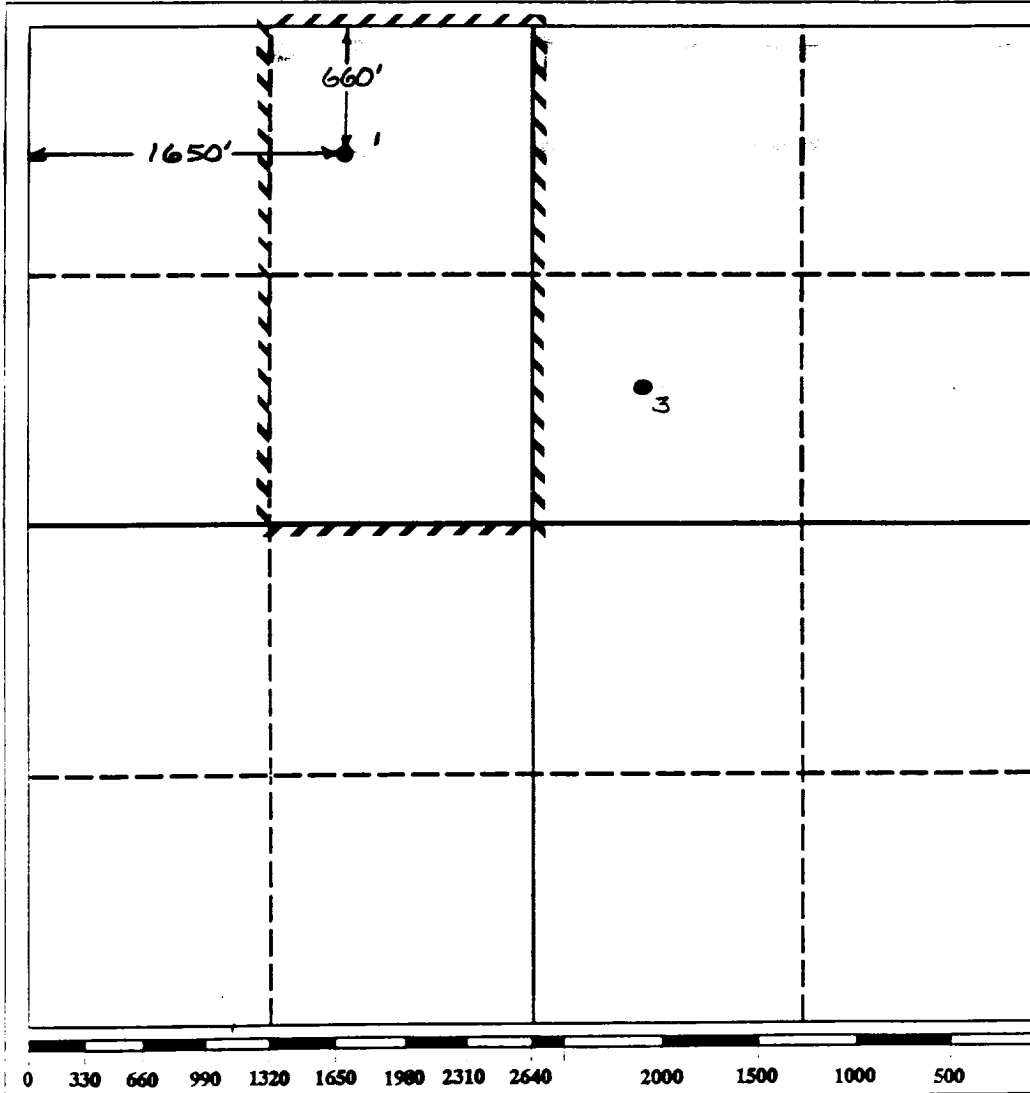

OPERATOR CERTIFICATION

I hereby certify that the information contained herein is true and complete to the best of my knowledge and belief.

Signature

Robert L. Bradshaw

Printed Name

Robert L. Bradshaw

Position

Meridian Oil Inc.

Company

09 April 1991

Date

SURVEYOR CERTIFICATION

I hereby certify that the well location shown on this plat was plotted from field notes of actual surveys made by me or under my supervision, and that the same is true and correct to the best of my knowledge and belief.

Date Surveyed

Signature & Seal of
Professional Surveyor

Certificate No.