

NO. OF COPIES RECEIVED	
DISTRIBUTION	
SANTA FE	
FILE	
U.S.G.S.	
LAND OFFICE	
OPERATOR	

NEW MEXICO OIL CONSERVATION COMMISSION

Sep 8 11 19 34 '65

Form C-101
Revised 1-1-65

5A. Indicate Type of Lease	STATE <input checked="" type="checkbox"/> FEE <input type="checkbox"/>
----------------------------	--

5. State Oil & Gas Lease No.
B-1258-1

APPLICATION FOR PERMIT TO DRILL, DEEPEN, OR PLUG BACK

1a. Type of Work		7. Unit Agreement Name	
b. Type of Well OIL WELL <input checked="" type="checkbox"/> GAS WELL <input type="checkbox"/> OTHER <input type="checkbox"/>		8. Farm or Lease Name	
c. Name of Operator		9. Well No.	
Texaco Inc.		22	
3. Address of Operator		10. Field and Pool, or Wildcat	
P. O. Box 3109, Midland, Texas		Vacuum Grayburg-San Andres	
4. Location of Well		12. County	
UNIT LETTER D LOCATED 330 FEET FROM THE North LINE		Lea	
AND 985 FEET FROM THE West LINE OF SEC. 12 TWP. 18-S RGE. 34-E NMPM			
19. Proposed Depth		19A. Formation	
4725		Grayburg	
20. Rotary or C.T.		Rotary	
21. Elevations (Show whether DF, RT, etc.)		22. Approx. Date Work will start	
GR - 3990		At once	
21A. Kind & Status Plug. Bond		21B. Drilling Contractor	
\$10,000 blanket		Unknown	

PROPOSED CASING AND CEMENT PROGRAM

SIZE OF HOLE	SIZE OF CASING	WEIGHT PER FOOT	SETTING DEPTH	SACKS OF CEMENT	EST. TOP
9 7/8"	7 5/8"	24#, 15.28#, 17.74#	1600'	700 *	300% to circ.
6 3/4"	4 1/2"	10.5#	4725'	300**	150% to base of salt

*Cement with 500 sx TLW 110% wtr., 12.0#/gal followed by 200 sx Class "C" neat with 1% calcium chloride. **Cement with 300 sx Incor 4% gel 13.86#/gal. 8.35 gals. wtr./sx with 0.5% FRA.

COMPLETION PROGRAM

1. Selectively perforate pay with 1jspi. 2. Acidize with 2000 gals 15% NE acid using ball sealers. 3. Fracture with 5000 gals gelled lease crude with 1/20# of adomite per gal followed by 10,000 gals of gelled lease crude with 1/40# of adomite & 1# sand per gal.

FORMATION TOPS EXPECTED

Anhydrite	1571'	Queen
Base of Salt	2656'	Grayburg (x)
Yates	2846'	San Andres
Total Depth	4725'	

3871'
4261'
4676'
EXPIRES

IN ABOVE SPACE DESCRIBE PROPOSED PROGRAM: IF PROPOSAL IS TO DEEPEN OR PLUG BACK, GIVE DATA ON PRESENT PRODUCTIVE ZONE AND PROPOSED NEW PRODUCTIVE ZONE. GIVE BLOWOUT PREVENTER PROGRAM, IF ANY.

I hereby certify that the information above is true and complete to the best of my knowledge and belief.

Signed P. G. Landwehrmeyer Title Civil Engineer Date 9/8/65
(This space for State Use)

APPROVED BY _____ TITLE _____ DATE _____
CONDITIONS OF APPROVAL, IF ANY:

NEW MEXICO OIL CONSERVATION COMMISSION
WELL LOCATION AND ACREAGE DEDICATION PLAT

FORM C-128
Revised 5/1/57

SEE INSTRUCTIONS FOR COMPLETING THIS FORM ON THE REVERSE SIDE

SECTION A

Operator TEXACO Inc.		Lease State of New Mexico "AE"		Well No. 22
Unit Letter D	Section 12	Township 18 South	Range 34 East	County Lea
Actual Footage Location of Well: 330' feet from the North line and 985' feet from the West line Sec. 12				
Ground Level Elev. 3990'	Producing Formation Grayburg	Pool Vacuum Grayburg-San Andres	Dedicated Acreage: 40 Acres	

1. Is the Operator the only owner in the dedicated acreage outlined on the plat below? YES ☒ NO ☐ ("Owner" means the person who has the right to drill into and to produce from any pool and to appropriate the production either for himself or for himself and another. (63-3-29 (e) NMSA 1935 Comp.)
2. If the answer to question one is "no," have the interests of all the owners been consolidated by communitization agreement or otherwise? YES ☐ NO ☐ . If answer is "yes," Type of Consolidation _____
3. If the answer to question two is "no," list all the owners and their respective interests below:

Owner	Land Description

SECTION B

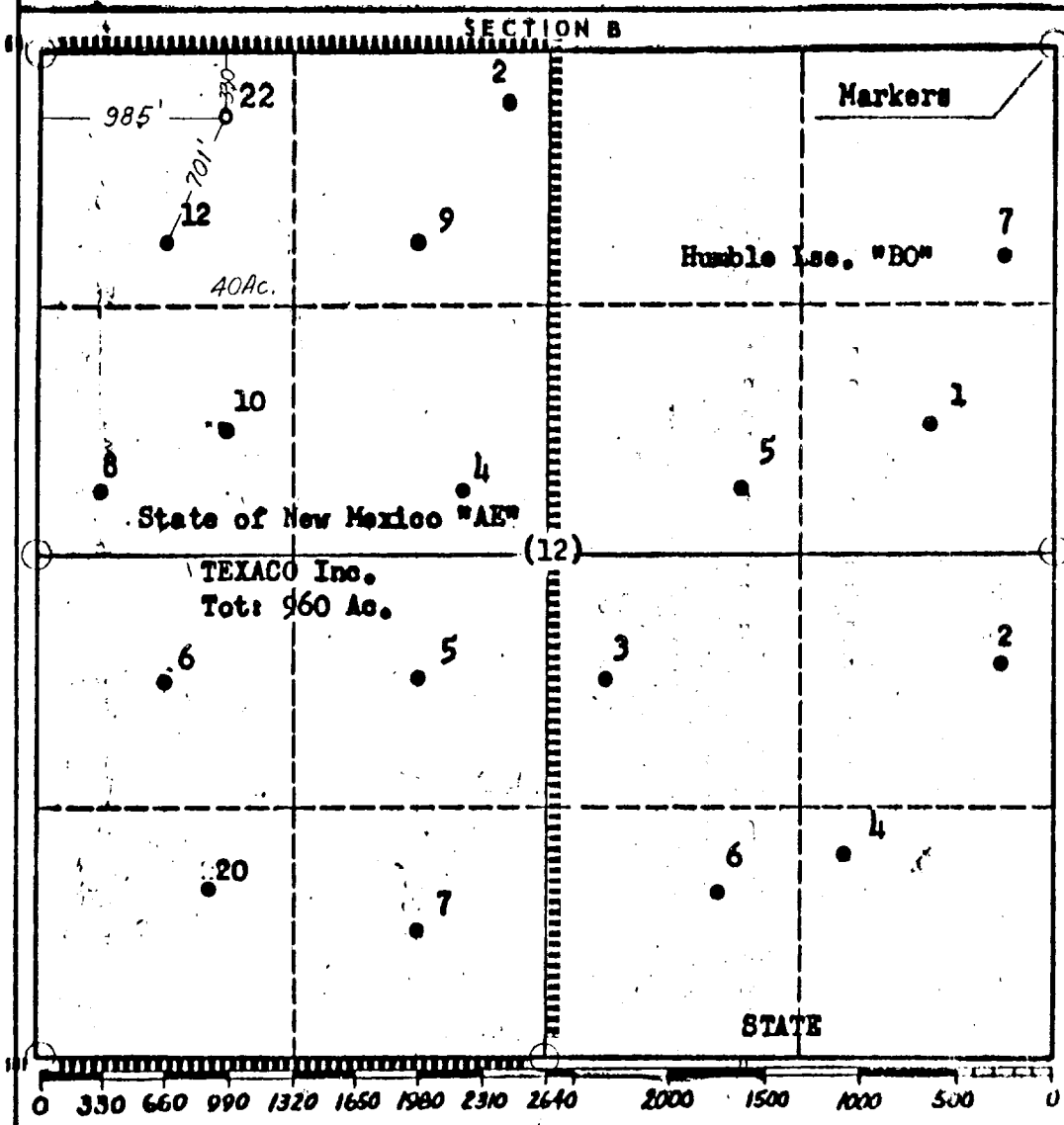

CERTIFICATION

I hereby certify that the information in SECTION A above is true and complete to the best of my knowledge and belief.

Name
T. G. Landwermeyer
Position
Civil Engineer
Company
TEXACO Inc.
Date
9/8/65

I hereby certify that the well location shown on the plat in SECTION B was plotted from field notes of actual surveys made by me or under my supervision, and that the same is true and correct to the best of my knowledge and belief.

Date Surveyed
9/7/65
Registered Professional Engineer and/or Land Surveyor
T. G. Landwermeyer
Certificate No.
17617