

NO. OF COPIES RECEIVED	
DISTRIBUTION	
SANTA FE	
FILE	
U.S.G.S.	
LAND OFFICE	
OPERATOR	

NEW MEXICO OIL CONSERVATION COMMISSION

Form C-101
Revised 1-1-65

5A. Indicate Type of Lease
STATE <input checked="" type="checkbox"/> FEE <input type="checkbox"/>
5. State Oil & Gas Lease No.
B-1502

APPLICATION FOR PERMIT TO DRILL, DEEPEN, OR PLUG BACK

1a. Type of Work		7. Unit Agreement Name	
b. Type of Well DRILL <input type="checkbox"/> DEEPEN <input type="checkbox"/> PLUG BACK <input checked="" type="checkbox"/>		8. Farm or Lease Name	
OIL WELL <input checked="" type="checkbox"/> GAS WELL <input type="checkbox"/> OTHER <input type="checkbox"/> SINGLE ZONE <input checked="" type="checkbox"/> MULTIPLE ZONE <input type="checkbox"/>		Santa Fe	
2. Name of Operator		9. Well No.	
Phillips Petroleum Company		112	
3. Address of Operator		10. Field and Pool, or Wildcat	
Room 711, Phillips Building, Odessa, Texas 79761		Vacuum Grayburg/San And.	
4. Location of Well		12. County	
UNIT LETTER E LOCATED 1655 FEET FROM THE north LINE		Lea	
AND 330 FEET FROM THE west LINE OF SEC. 5 TWP. 18-S RGE. 35-E NMPM			
19. Proposed Depth		19A. Formation	
5000' Grayburg/San Andres		20. Rotary or C.T.	
21. Elevations (Show whether DF, RT, etc.)		22. Approx. Date Work will start	
3983' RKB		Upon approval	
21A. Kind & Status Plug. Bond		21B. Drilling Contractor	
blanket		--	

23. PROPOSED CASING AND CEMENT PROGRAM

SIZE OF HOLE	SIZE OF CASING	WEIGHT PER FOOT	SETTING DEPTH	SACKS OF CEMENT	EST. TOP
12-1/4"	8-5/8"	24#	1530'	(450 sx LS Incor w/20% DD) - Circ 35 sx (200 sx LS Incor w/2% CaCl ₂)	
7-7/8"	4-1/2"	9.5#	6250'	(500 sx Tr. LW and 20% DD plus) -- (300 sx reg. Temp survey) (TOC at 2600')	

Propose spotting 50 sx cmt over Vacuum Glorieta perforations 6050-64'; abandon Glorieta zone.

Recomplete in Vacuum Grayburg/San Andres zone at approximately 4100-4700'.

This well is in the same Vacuum Grayburg/San Andres proration unit as Santa Fe No. 3 which will be shut in upon completion of No. 112, or have production limited on combined production to one unit allowable.

IN ABOVE SPACE DESCRIBE PROPOSED PROGRAM: IF PROPOSAL IS TO DEEPEN OR PLUG BACK, GIVE DATA ON PRESENT PRODUCTIVE ZONE AND PROPOSED NEW PRODUCTIVE ZONE. GIVE BLOWOUT PREVENTER PROGRAM, IF ANY.

I hereby certify that the information above is true and complete to the best of my knowledge and belief.

Signed W. J. Mueller Title Senior Reservoir Engineer Date October 6, 1972

(This space for State Use)

APPROVED BY [Signature] TITLE SUPERVISOR DISTRICT I DATE OCT 13 1972

CONDITIONS OF APPROVAL, IF ANY:

**NEW MEXICO OIL CONSERVATION COMMISSION
WELL LOCATION AND ACREAGE DEDICATION PLAT**

Form C-102
Supersedes C-128
Effective 1-1-65

All distances must be from the outer boundaries of the Section.

Operator Phillips Petroleum Company			Lease Santa Fe		Well No. 112
Unit Letter E	Section 5	Township 18-S	Range 35-E	County Lea	
Actual Footage Location of Well: 330 feet from the west line and 1655 feet from the north line					
Ground Level Elev. 3983' RKB	Producing Formation Grayburg/San Andres		Pool Vacuum Grayburg San Andres		Dedicated Acreage: 40 Acres

1. Outline the acreage dedicated to the subject well by colored pencil or hatchure marks on the plat below.
2. If more than one lease is dedicated to the well, outline each and identify the ownership thereof (both as to working interest and royalty).
3. If more than one lease of different ownership is dedicated to the well, have the interests of all owners been consolidated by communitization, unitization, force-pooling, etc?

☐ Yes ☐ No If answer is "yes," type of consolidation _____

If answer is "no," list the owners and tract descriptions which have actually been consolidated. (Use reverse side of this form if necessary.) _____

No allowable will be assigned to the well until all interests have been consolidated (by communitization, unitization, forced-pooling, or otherwise) or until a non-standard unit, eliminating such interests, has been approved by the Commission.

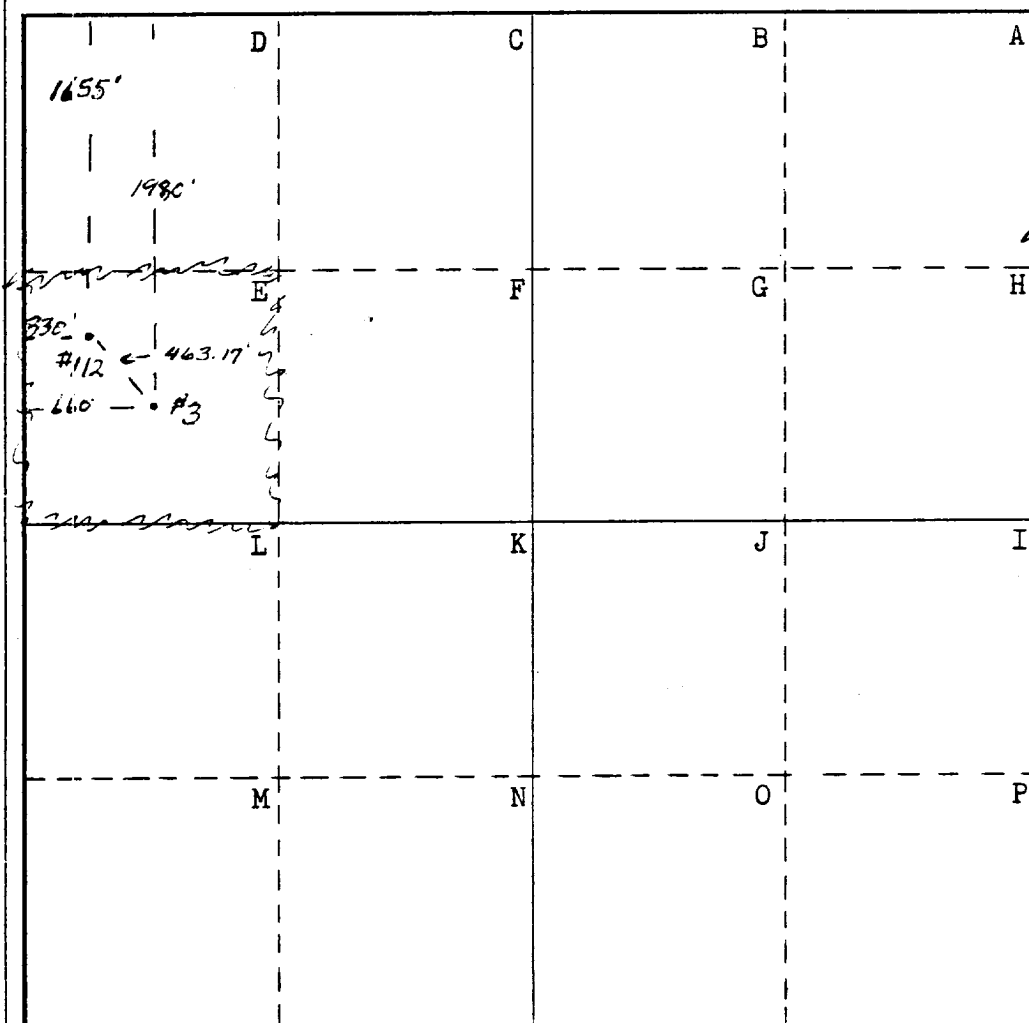

CERTIFICATION

I hereby certify that the information contained herein is true and complete to the best of my knowledge and belief.

Name _____
W. J. Mueller
 Position
Senior Reservoir Engineer
 Company
Phillips Petroleum Company
 Date
October 6, 1972

I hereby certify that the well location shown on this plat was plotted from field notes of actual surveys made by me or under my supervision, and that the same is true and correct to the best of my knowledge and belief.

Date Surveyed
8-3-65
 Registered Professional Engineer
 and/or Land Surveyor

M. E. Spry
 Certificate No.

679

