

MP
606

UNITED STATES
DEPARTMENT OF THE INTERIOR
GEOLOGICAL SURVEY

HOOBBS OFFICE O.C.G.

JAN 13 11 09 AM '67

10-52233 (2)

1. NAME OF WORK

WELL

DEPTH

PLUG BACK

2. NAME OF COMPANY

3. TYPE OF WORK

WELL

WELL

WELL

Core Test

WELL

WELL

4. NAME OF COMPANY

5. NAME OF COMPANY

Libble Oil & Refining Co.

6. LOCATION OF WELL

Box 1690, Midland, Texas

7. STATE OF TEXAS, TO BE ACCORDED TO BY AND IN ACCORDANCE WITH ANY STATE REQUIREMENTS*

400 FSL 2240 REL. Sec. 30

8. PROPOSED PRODUCTION

WELL

9. DISTANCE IN FEET AND DIRECTION FROM NEAREST TOWN OR PORT OFFICE*

2 miles West Hobbs, N. M.

10. DEPTH OF WELL

400'

11. NO. OF FEET IN TUBING

300

12. DEPTH OF PROPOSED WELL

400'

13. PROPOSED DEPTH

50'

14. ELEVATION (Below surface of, sea level, etc.)

None run

15. PROPOSED CASING AND CEMENTING PROGRAM

DEPTH OF CASING	WEIGHT PER FOOT	SETTING DEPTH	AMOUNT OF CEMENT
No casing program planned.			

IN ABOVE SPACE DESCRIBE PROPOSED PROGRAM: If proposal is to deepen or plug back, give data on present productive zone and proposed new productive zone. If proposal is to drill or deepen directionally, give pertinent data on subsurface locations and measured and true vertical depths. Give brief of proposed program if any.

Signature: JE Pinkerton TITLE: Agent DATE: 1-12-67

APPROVAL (If required by State or other agency)

APPROVAL DATE

TITLE

CONTINUATION OF ABOVE, IF ANY

Humble Lse. No. 31029

NEW MEXICO OIL CONSERVATION COMMISSION

Form C-102
Supersedes C-128
Effective 1-1-65

State Lse. No. _____

WELL LOCATION AND ACREAGE DEDICATION PLAT

Federal Lse. No. LC-032253 (4)

All distances must be from the outer boundaries of the Section.

HOBBS OFFICE, O. C. C.

Operator Humble Oil & Refining Co.		Lease BOWERS JAN 13 11 09 AM '67		Well No. 18
Unit Letter O	Section 50	Township 18 SOUTH	Range 38 EAST	County Lea
Actual Footage Location of Well: 400 feet from the SOUTH line and 2240 feet from the EAST line				
Ground Level Elev:	Producing Formation	Pool CORRECTION	Dedicated Acreage: Acres	

1. Outline the acreage dedicated to the subject well by colored pencil or hachure marks on the plat below.
2. If more than one lease is dedicated to the well, outline each and identify the ownership thereof (both as to working interest and royalty).
3. If more than one lease of different ownership is dedicated to the well, have the interests of all owners been consolidated by communitization, unitization, force-pooling, etc?

☐ Yes ☒ No If answer is "yes," type of consolidation _____

If answer is "no," list the owners and tract descriptions which have actually been consolidated. (Use reverse side of this form if necessary.) _____

No allowable will be assigned to the well until all interests have been consolidated (by communitization, unitization, forced-pooling, or otherwise) or until a non-standard unit, eliminating such interests, has been approved by the Commission.

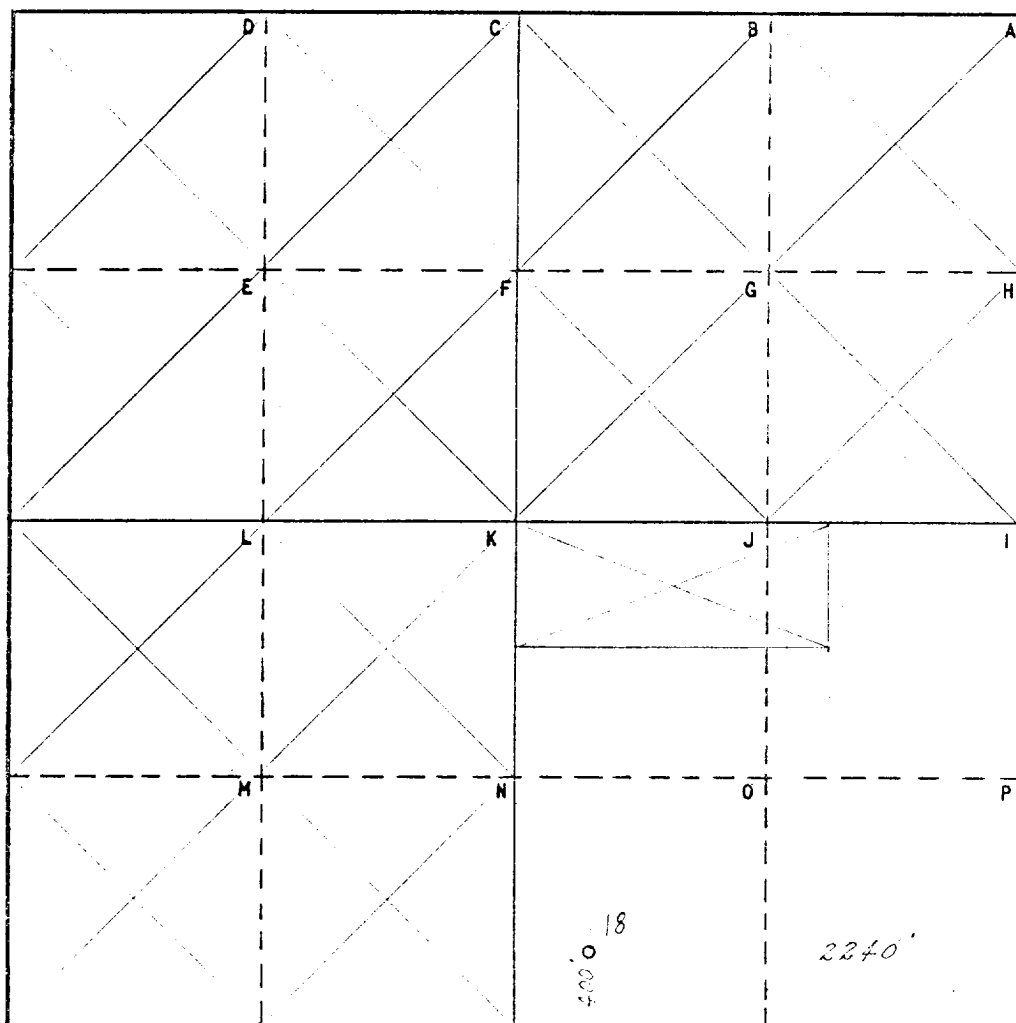

CERTIFICATION

I hereby certify that the information contained herein is true and complete to the best of my knowledge and belief.

Name: J. E. Pinkerton
Position: Proctor & Surveyor
Company: Humble Oil & Refining Co.
Box 1600 Midland, Texas
Date: _____

I hereby certify that the well location shown on this plat was plotted from field notes of actual surveys made by me or under my supervision, and that the same is true and correct to the best of my knowledge and belief.

Date Surveyed: Jan. 10, 1967
Registered Professional Engineer
and/or Land Surveyor

Certificate No. 1222

2 Miles West of Hobbs, N. M., New Mexico

C.E. Sec. File No. W A - 5 6 3