

UNITED STATES  
DEPARTMENT OF THE INTERIOR  
GEOLOGICAL SURVEY

APPLICATION FOR PERMIT TO DRILL, DEEPEN, OR PLUG BACK

1. TYPE OF WORK  
DRILL ☒ DEEPEN ☐ PLUG BACK ☐

2. TYPE OF WELL  
Oil ☐ GAS ☐ OTHER ☒ Core Test  
SINGLE ZONE ☐ MULTIPLE ZONE ☐

3. NAME OF OPERATOR  
Humble Oil & Refining Co.

4. ADDRESS OF OPERATOR  
Box 1000, Midland, Texas

5. LOCATION OF WELL (Report location clearly and in accordance with any State requirements.)  
2475 FHL 1815 FSL Sec. 30

6. AT PROPOSED PROD. ZONE  
SRNO

7. DISTANCE IN MILES AND DIRECTION FROM NEAREST TOWN OR POST OFFICE  
2 miles West of Hobbs, NM

8. DISTANCE FROM PROPOSED  
POST OFFICE TO NEAREST  
TOWN OR POST OFFICE, FT.  
Also to nearest orig. oil line, (ft.) 165

9. DISTANCE FROM PROPOSED LOCAT. OF  
NEAREST WELL, DRILLING COMPLETED,  
OR ABANDONED, ON THIS LEASE, FT.

10. PROPOSED DEPTH  
50

11. NO. OF ACRES IN LEASE  
300

12. NO. OF ACRES ABANDONED  
TO THIS WELL

13. ROTARY OR OTHER TOOLS  
Core Log

14. APPROX. DATE WORK WILL START  
1-31-67

21. ELEVATIONS (Show whether DF, RT, GR, etc.)  
not run

PROPOSED CASING AND CEMENTING PROGRAM

SIZE OF HOLE	SIZE OF CASING	WEIGHT PER FOOT	SETTING DEPTH	QUANTITY OF CEMENT
No csg program planned.				

IN ABOVE SPACE DESCRIBE PROPOSED PROGRAM: If proposal is to deepen or plug back, give data on present productive zone and proposed new productive zone. If proposal is to drill or deepen directionally, give pertinent data on subsurface conditions and measured and true vertical depths. Give flow at proposed program, if any.

24. SIGNED J. B. Finkbeiner TITLE Agent  
(This space for Federal or State office use)

PERMIT NO. APPROVAL DATE

APPROVED BY TITLE DATE  
CONDITIONS OF APPROVAL, IF ANY:

Federal Lse. No. LC-08235

All distances must be from the outer boundaries of the Section.

Operator Humble Oil & Refining Co.		Lease ED 2 CROWNED "LA 57		FEDERAT.		Well No. 716	
Unit Letter " J "	Section 30	Township 18 NORTH	Range 30 EAST	County Leon			
Actual Footage Location of Well: 194 feet from the NORTH line and 2475 feet from the EAST line							
Ground Level Elev.	Producing Formation		Pool CORE TRAP			Dedicated Acreage: Acres	

1. Outline the acreage dedicated to the subject well by colored pencil or hatchure marks on the plat below.
2. If more than one lease is dedicated to the well, outline each and identify the ownership thereof (both as to working interest and royalty).
3. If more than one lease of different ownership is dedicated to the well, have the interests of all owners been consolidated by communitization, unitization, force-pooling, etc?

☐ Yes ☒ No If answer is "yes," type of consolidation \_\_\_\_\_

If answer is "no," list the owners and tract descriptions which have actually been consolidated. (Use reverse side of this form if necessary.) \_\_\_\_\_

No allowable will be assigned to the well until all interests have been consolidated (by communitization, unitization, forced-pooling, or otherwise) or until a non-standard unit, eliminating such interests, has been approved by the Commission.

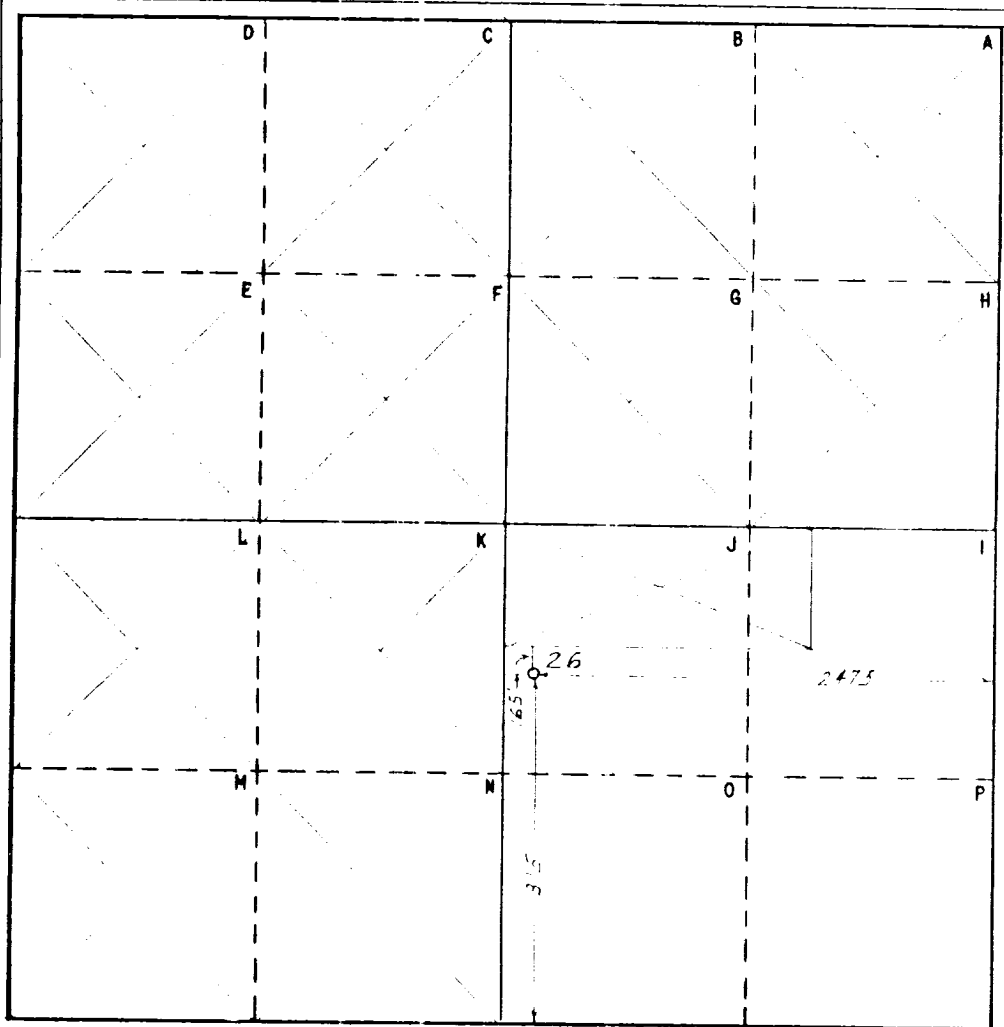

### CERTIFICATION

I hereby certify that the information contained herein is true and complete to the best of my knowledge and belief.

Name: E. J. Anderson

Position  
F. W. Lupton

Company Humble Oil & Refining Co.

Box 1600 Midland, Texas

Date 1-31-67

I hereby certify that the well location shown on this plat was plotted from field notes of actual surveys made by me or under my supervision, and that the same is true and correct to the best of my knowledge and belief.

Date Surveyed \_\_\_\_\_

February 17, 1967

Registered Professional Engineer  
and/or Land Surveyor

Certificate No. \_\_\_\_\_

2582