

District I
1625 N. French Dr., Hobbs, NM 88240
District II
811 S. 1st Street, Artesia, NM 88210
District III
1000 Rio Brazos Rd., Aztec, NM 87410
District IV
2040 South Pacheco, Santa Fe, NM 87505

State of New Mexico
Energy, Minerals & Natural Resources

Form C-101
Revised March 17, 1999

Oil Conservation Division
2040 South Pacheco
Santa Fe, NM 87505

Submit to appropriate District Office
State Lease - 6 Copies
Fee Lease - 5 Copies

☐ AMENDED REPORT

APPLICATION FOR PERMIT TO DRILL, RE-ENTER, DEEPEN, PLUGBACK, OR ADD A ZONE

¹ Operator Name and Address Marathon Oil Company P.O. Box 552 Midland, TX 79702		² OGRID Number 14021
		³ API Number 30-025-22171
⁴ Property Code 19741	⁵ Property Name Silverstrand State	⁶ Well No. # 2

⁷ Surface Location

UL or lot no.	Section	Township	Range	Lot. Idn	Feet from the	North/South Line	Feet from the	East/West line	County
"D"	2	17-S	34-E		660'	North	660'	West	Lea

⁸ Proposed Bottom Hole Location If Different From Surface

UL or lot no.	Section	Township	Range	Lot. Idn	Feet from the	North/South Line	Feet from the	East/West line	County
"C"	2	17-S	34-E		660'	North	1865'	West	Lea

⁹ Proposed Pool 1

North Vacuum Abo

¹⁰ Proposed Pool 2

¹¹ Work Type Code E	¹² Well Type Code O	¹³ Cable/Rotary Rotary	¹⁴ Lease Type Code S	¹⁵ Ground Level Elevation 4050'
¹⁶ Multiple N	¹⁷ Proposed Depth 8630'	¹⁸ Formation Abo	¹⁹ Contractor Key	²⁰ Spud Date APR 2003 RECEIVED Hobbs OCD

²¹ Proposed Casing and Cement Program

Hole Size	Casing Size	Casing weight/foot	Setting Depth	Sacks of Cement	Estimated TOC
17"	*11-3/4"	N/A	401'	275 sx.	Surface
12-3/4"	*8-5/8"	N/A	4095'	675 sx	Surface
4-3/4"	Open Hole	N/A			

²² Describe the proposed program. If this application is to DEEPEN or PLUG BACK, give the data on the present productive zone and proposed new productive zone.

Describe the blowout prevention program, if any. Use additional sheets if necessary.

Marathon Oil Company is proposing to Re-enter the Angle St. # 1 well, to be renamed the Silverstrand St. # 2 and drill a horizontal well. Nipple up new well head equipment, Drill out all plugs, Set 5-1/2" casing @ approx. 8630'. Drill out casing shoe, drill 150' radius curve section and approx. 970' of open hole horizontal drain section. There will be a total of 1205' of open hole horizontal drain section. * 11-3/4" and 8-5/8" are cemented in place. All BOPE shall be installed and operated in accordance with OCD rule #'s 109,114.

Permit Expires 1 Year From Approval Date Unless Drilling Underway

Re-entry

²³ I hereby certify that the information given above is true and complete to the best of my knowledge and belief.

Signature: *Jerry Fletcher*

Printed name: **Jerry Fletcher**

Title: **Engineer Tech.**

Date: **1/13/03**

Phone: **915-687-8360**

OIL CONSERVATION DIVISION

Approved by:

Title:

Approval Date: **1/13/03**

Conditions of Approval:

Attached ☐

Expiration Date:

ORIGINAL SIGNED BY
PAUL F. KAUTZ
PETROLEUM ENGINEER

DISTRICT I
P.O. Box 1980, Hobbs, NM 88241-1980

DISTRICT II
P.O. Drawer DD, Artesia, NM 88211-0710

DISTRICT III
1000 Rio Brazos Rd., Artesia, NM 87410

DISTRICT IV
P.O. BOX 2088, SANTA FE, N.M. 87504-2088

State of New Mexico
Energy, Minerals and Natural Resources Department

OIL CONSERVATION DIVISION
P.O. Box 2088
Santa Fe, New Mexico 87504-2088

Form C-102
Revised February 10, 1994
Submit to Appropriate District Office
State Lease - 4 Copies
Fee Lease - 3 Copies

WELL LOCATION AND ACREAGE DEDICATION PLAT

☐ AMENDED REPORT

API Number 30-025-22171	Pool Code 61760	Pool Name North Vacuum Abo
Property Code 19741	Property Name Silverstrand State	Well Number # 2
OGRID No. 14021	Operator Name MARATHON OIL COMPANY	Elevation 4050'

Surface Location

UL or lot No.	Section	Township	Range	Lot Idn	Feet from the	North/South line	Feet from the	East/West line	County
"D"	2	17-S	34-E		660'	NORTH	660'	WEST	Lea

Bottom Hole Location If Different From Surface

UL or lot No.	Section	Township	Range	Lot Idn	Feet from the	North/South line	Feet from the	East/West line	County
"C"	2	17-S	34-E		660'	NORTH	1865'	WEST	Lea
Dedicated Acres 80 N/2, NW/4	Joint or Infill	Consolidation Code	Order No.						

NO ALLOWABLE WILL BE ASSIGNED TO THIS COMPLETION UNTIL ALL INTERESTS HAVE BEEN CONSOLIDATED
OR A NON-STANDARD UNIT HAS BEEN APPROVED BY THE DIVISION

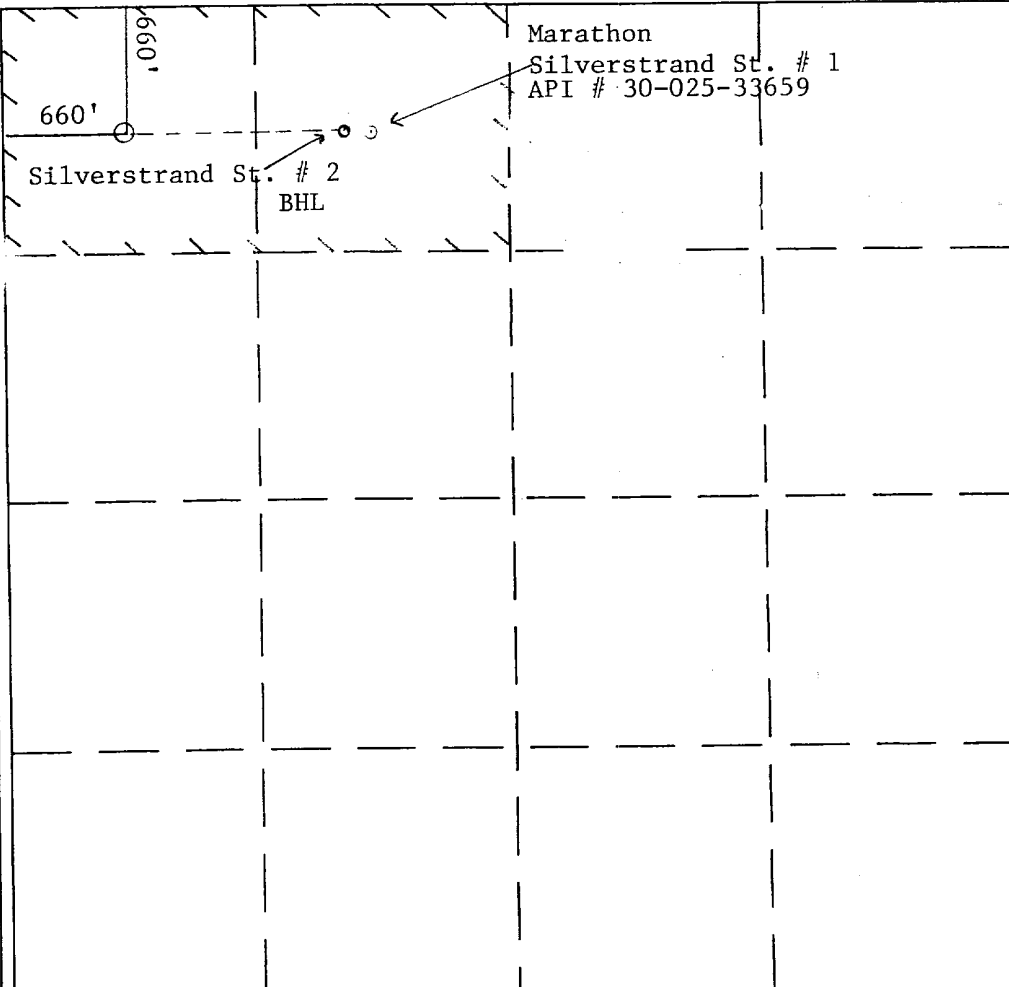
	<p>OPERATOR CERTIFICATION</p> <p>I hereby certify the the information contained herein is true and complete to the best of my knowledge and belief.</p> <p><i>Jerry Fletcher</i> Signature Jerry Fletcher Printed Name Engineer Tech. Title 1/8/03 Date</p>
	<p>SURVEYOR CERTIFICATION</p> <p>I hereby certify that the well location shown on this plat was plotted from field notes of actual surveys made by me or under my supervision, and that the same is true and correct to the best of my knowledge and belief.</p> <p>Date Surveyed</p>
	<p>Signature & Seal of Professional Surveyor</p>
	<p>Certificate No.</p>

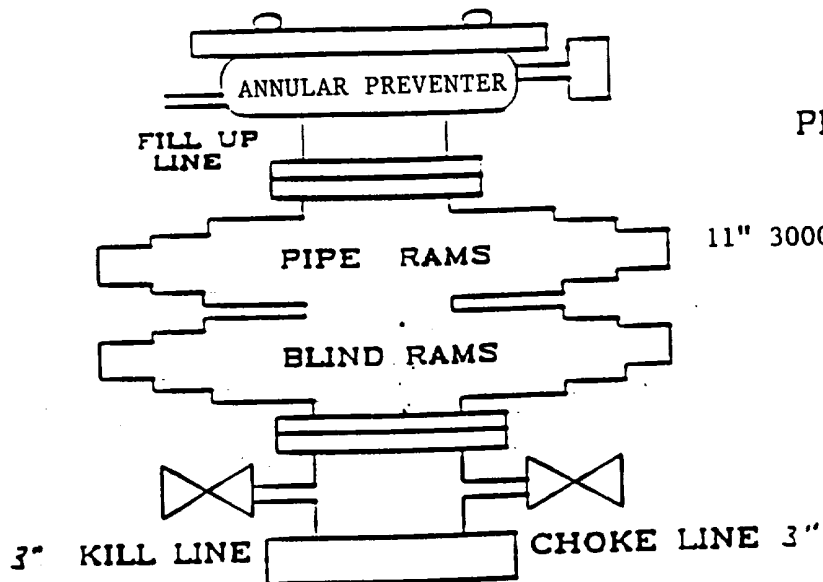

PRODUCTION
STACK

11" 3000 #

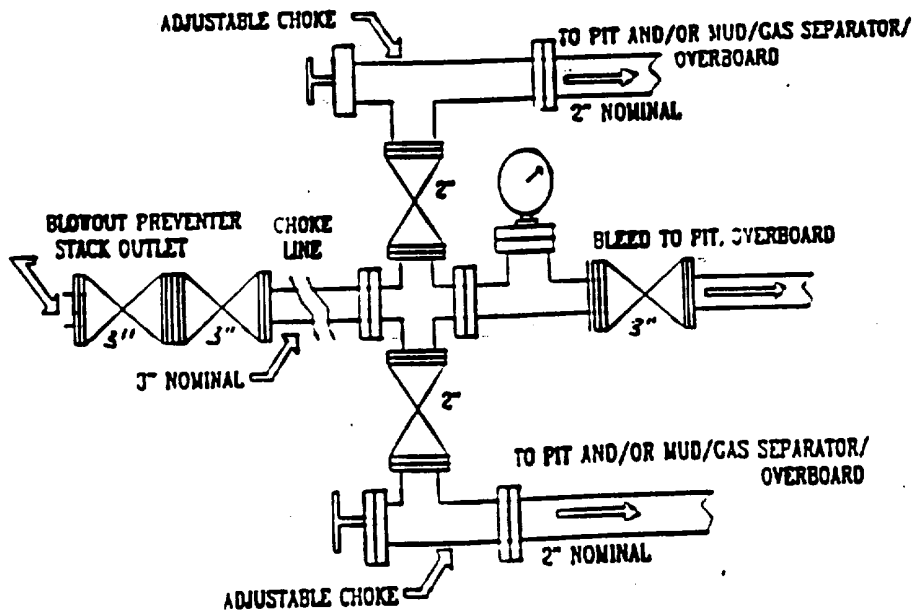

RECEIVED
Hobbs
OCD

Well Name & No.		Angle State #1		Field	North Vacuum		Date 11/15/02	
County	LEA	API	30 025 22171	State	NEW MEXICO	By	R. S. Bose	
Spudded	7/4/1967	P&A	8/13/1967	Location	660' FNL & 660' FWL, Section 2, Township 17S, Range 34E, UL 'D'			

