

NEW MEXICO OIL CONSERVATION COMMISSION
WELL LOCATION AND ACREAGE DEDICATION PLAT

Form O-100
Supersedes O-128
Effective 1-1-61

All distances must be from the outer boundaries of the Section.

Operator Mobil Oil Corporation		County Bridges State		Well No. 125
Unit Letter H	Section 14	Township 17S	Range 34E	County Lea
Actual Footage Location of Well: 660' feet from the East line to 2180' feet from the North line.				
Ground Elevation, 4017	Forming Formation Abo & Upper Penn	Undesignated		Dedicated Acreage 80

- Outline the acreage dedicated to the subject well by colored pencil or hatchure marks on the plat below.
- If more than one lease is dedicated to the well outline each and identify the ownership thereof (both as to working interest and royalty).
- If more than one lease of different ownership is dedicated to the well, have the interests of all owners been consolidated by communitization, unitization, force-pooling, etc?

☐ Yes ☐ No If answer is "yes," type of consolidation _____
 If answer is "no," list the owners and tract descriptions which have actually been consolidated (Use reverse side of this form if necessary.) _____

No allowable will be assigned to the well until all interests have been consolidated (by communitization, unitization, forced-pooling, or otherwise) or until a non-standard unit, eliminating such interests, has been approved by the Commission.

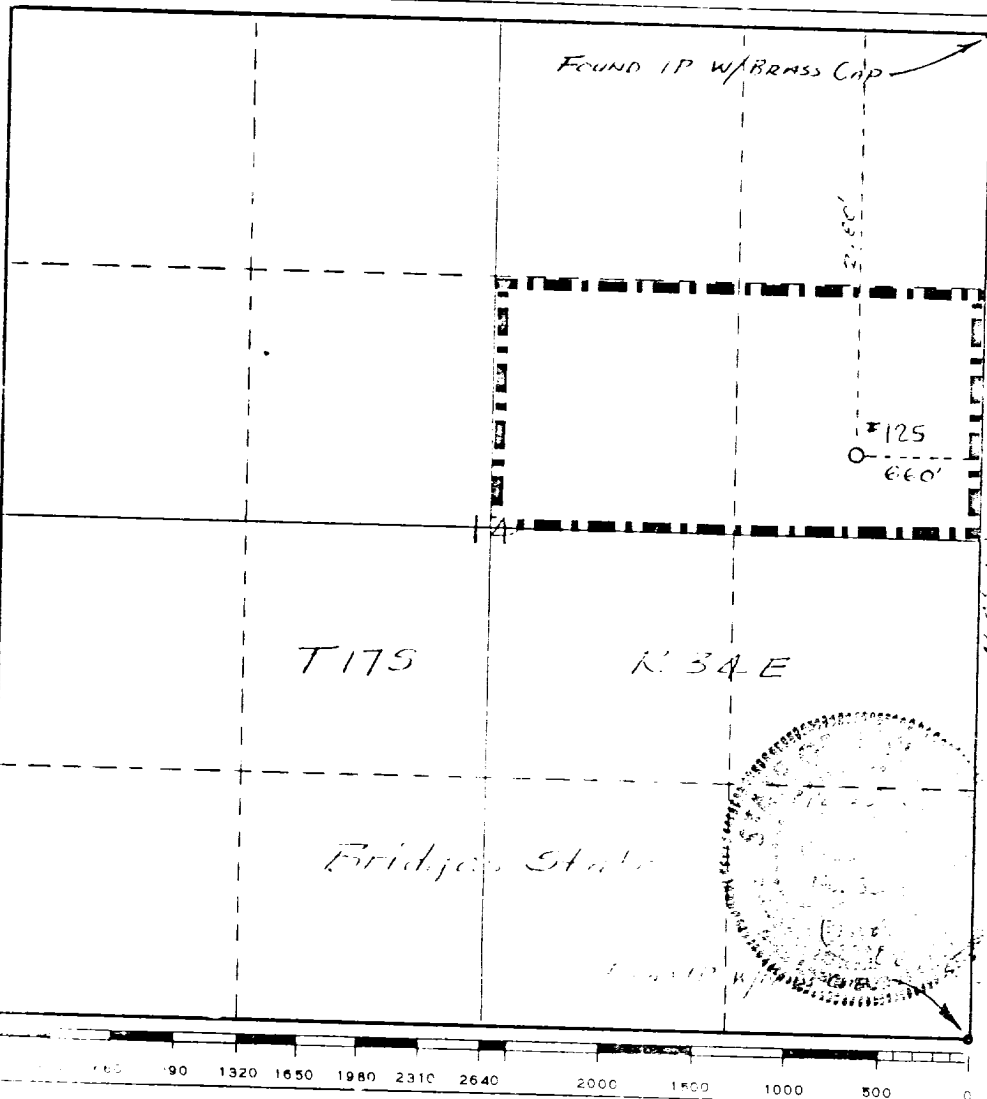

CERTIFICATION

I hereby certify that the information contained herein is true and complete to the best of my knowledge and belief.

Name
A. D. Bond
 Position
Proration Staff Assistant
 Company
Mobil Oil Corporation
 Date
December 28, 1967

I hereby certify that the well location shown on this plat was plotted from field notes of actual surveys made by me or under my supervision, and that the same is true and correct to the best of my knowledge and belief.

Date Surveyed
December 27, 1967

Registered Professional Engineer and/or Land Surveyor

Curtis A. Callaway

Certificate No.

3342