

Submit to Appropriate
District Office
State Lease - 4 copies
Fee Lease - 3 copies

State of New Mexico
Energy, Minerals and Natural Resources Department

Form C-102
Revised 1-1-89

OIL CONSERVATION DIVISION

P.O. Box 2088
Santa Fe, New Mexico 87504-2088

DISTRICT I
P.O. Box 1980, Hobbs, NM 88240

DISTRICT II
P.O. Drawer DD, Artesia, NM 88210

DISTRICT III
1000 Rio Brazos Rd., Aztec, NM 87410

WELL LOCATION AND ACREAGE DEDICATION PLAT

All Distances must be from the outer boundaries of the section

| | | | | | |
|--|----------------------|-------------------------------------|--------------------------------|---|---------------------------------------|
| Operator ROBERT N. ENFIELD | | | Lease HUDSON FEDERAL | | Well No. 4 |
| Unit Letter K | Section 29 | Township 18 SOUTH | Range 33 EAST | County LEA | |
| Actual Footage Location of Well: 1980 feet from the SOUTH line and 1980 feet from the WEST line | | | | | |
| Ground level Elev. 3766.2' | | Producing Formation QUEEN | | Pool UNDESIGNATED BUFFALO QUEEN | Dedicated Acreage: 40 Acres |

1. Outline the acreage dedicated to the subject well by colored pencil or hachure marks on the plat below.
2. If more than one lease is dedicated to the well, outline each and identify the ownership thereof (both as to working interest and royalty).
3. If more than one lease of different ownership is dedicated to the well, have the interest of all owners been consolidated by communitization, unitization, force-pooling, etc.?
☐ Yes ☐ No If answer is "yes" type of consolidation _____
If answer is "no" list the owners and tract descriptions which have actually been consolidated. (Use reverse side of this form if necessary.) _____
No allowable will be assigned to the well until all interests have been consolidated (by communitization, unitization, forced-pooling, or otherwise) or until a non-standard unit, eliminating such interest, has been approved by the Division.

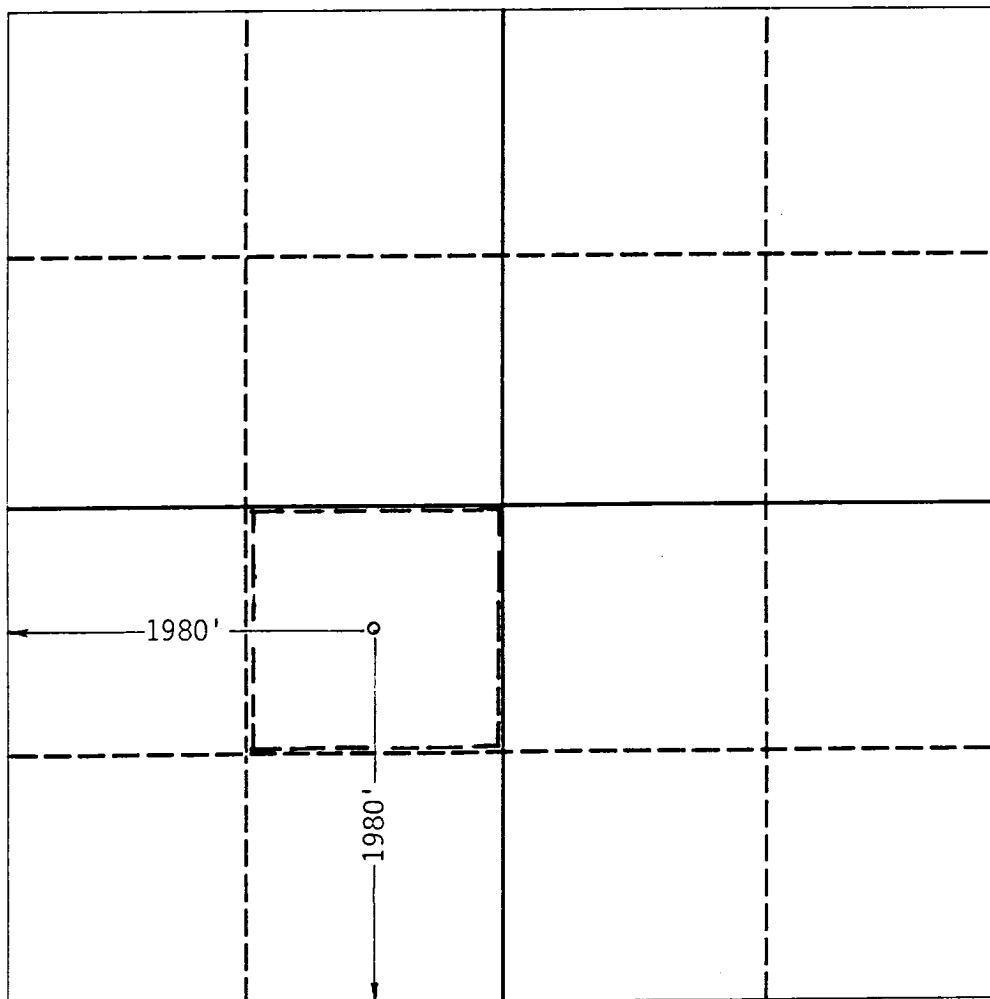

OPERATOR CERTIFICATION

I hereby certify that the information contained herein is true and complete to the best of my knowledge and belief.

Signature
Arthur R. Brown
Printed Name
Arthur R. Brown
Position
Agent
Company
ROBERT N. ENFIELD
Date
JULY 12, 1991

SURVEYOR CERTIFICATION

I hereby certify that the well location shown on this plat was plotted from field notes of actual surveys made by me or under my supervision, and that the same is true and correct to the best of my knowledge and belief.

Date Surveyed
MAY 16, 1968
Signature & Seal of Professional Surveyor
SEE ORIGINAL PLAT
Certificate No.

SURFACE USE AND OPERATIONS PLAN

TO RE-ENTER A PLUGGED AND ABANDONED WELL

ROBERT N. ENFIELD
HUDSON FEDERAL WELL NO. 4
(FORMERLY PENNZOIL UNITED, INC. HUDSON 29 FEDERAL WELL NO.2)
1980'FSL & 1980'FWL SEC.29, T.18 S., R.33 E.
LEA COUNTY, NEW MEXICO

LOCATED: 11 miles south-southeast of Maljamar, New Mexico.

FEDERAL LEASE NUMBER: LC-069276.

LEASE DATE: July 1, 1949. Lease is in producing status.

ACRES IN LEASE: 2470.16.

RECORD LESSEE: Iverson Trust and Edward R. and W. A. Hudson.

SURFACE OWNERSHIP: Federal.

GRAZING PERMITTEE: Caviness Cattle Company
c/o Gary Caviness 505-676-4201
East Star Route
Maljamar, New Mexico 88264

POOL: Undesignated Buffalo Queen

POOL RULES: Statewide Rules. 40 acre spacing for oil.

EXHIBITS: A. Road Map
B. Plat Showing Pertinent Wells and Pertinent Roads

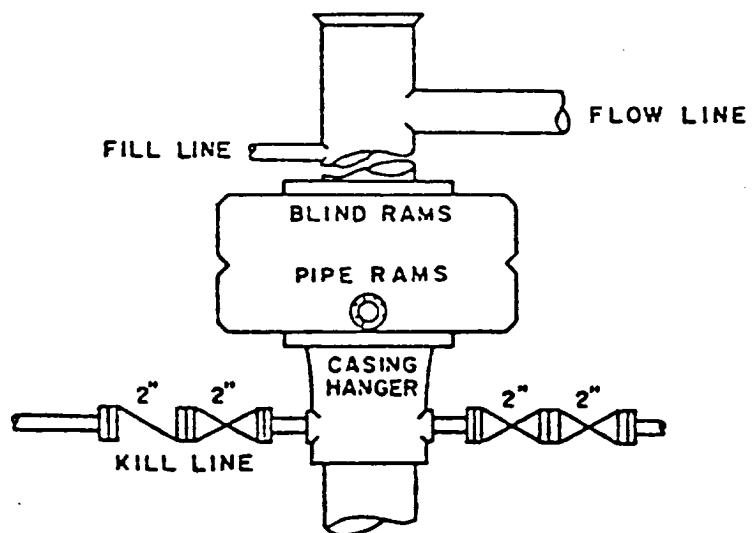

BOP STACK

2000 PSI WORKING PRESSURE

BOP ARRANGEMENT