

HUMBLE OIL & REFINING COMPANY

MIDLAND, TEXAS 79701

July 18, 1969

POST OFFICE BOX 1600

PRODUCTION DEPARTMENT

SOUTHWESTERN DIVISION

C. A. LANGNER
OPERATIONS MANAGER

Application to Dual Complete
Bowers "A" Federal Com. ~~31~~, Well No. 31
Hobbs Blinbry and Hobbs Drinkard Pools
Lea County, New Mexico

New Mexico Oil Conservation Commission
P. O. Box 2038
Santa Fe, New Mexico

Attention: Mr. A. L. Porter, Jr.

Gentlemen:

Humble Oil & Refining Company respectfully requests administrative approval to dual complete its Bowers "A" Federal Com. 31, Well No. 31, located in Unit E, Section 29, T-18-S, R-38-E.

It is proposed to dually complete this well in such a manner as to permit the Blinbry and Drinkard Pools to be produced through parallel strings of 2-1/16" O. D. tubing as shown on the attached sketch.

Very truly yours,

C. A. LANGNER

DLC/ms

Orig & 1 cc: N.M.O.C.C., Santa Fe, New Mexico
2 cc: N.M.O.C.C., Hobbs, New Mexico
1 cc: Hobbs District

APPLICATION FOR MULTIPLE COMPLETION

JUL 22 9 50 AM '69

Operator Humble Oil & Refining Company		County Lea		Date July 18, 1969
Address Box 1600, Midland, Texas		Lease Bowers "A" Federal Com. 53		Well No. 31
Location of Well E	Unit 29	Section 18 South	Range 38 East	

1. Has the New Mexico Oil Conservation Commission heretofore authorized the multiple completion of a well in these same pools or in the same zones within one mile of the subject well? YES ☒ NO ☐
2. If answer is yes, identify one such instance: Order No. _____; Operator Lease, and Well No.: Standard Oil Co. of Texas, New Mexico State 1, Well No. 5 (Hearing to be held July 23, 1969)

3. The following facts are submitted:	Upper Zone	Intermediate Zone	Lower Zone
a. Name of Pool and Formation	Hobbs Blinebry		Hobbs Drinkard
b. Top and Bottom of Pay Section (Perforations)	5896-5955		6975-6991
c. Type of production (Oil or Gas)	Oil		Oil
d. Method of Production (Flowing or Artificial Lift)	Artificial Lift		Flowing

4. The following are attached. (Please check YES or NO)

Yes	No	
<input checked="" type="checkbox"/>	<input type="checkbox"/>	a. Diagrammatic Sketch of the Multiple Completion, showing all casing strings, including diameters and setting depths, centralizers and/or turbolizers and location thereof, quantities used and top of cement, perforated intervals, tubing strings, including diameters and setting depth, location and type of packers and side door chokes, and such other information as may be pertinent.
<input checked="" type="checkbox"/>	<input type="checkbox"/>	b. Plat showing the location of all wells on applicant's lease, all offset wells on offset leases, and the names and addresses of operators of all leases offsetting applicant's lease.
<input checked="" type="checkbox"/>	<input type="checkbox"/>	c. Waivers consenting to such multiple completion from each offset operator, or in lieu thereof, evidence that said offset operators have been furnished copies of the application.*
<input type="checkbox"/>	<input checked="" type="checkbox"/>	d. Electrical log of the well or other acceptable log with tops and bottoms of producing zones and intervals of perforation indicated thereon. (If such log is not available at the time application is filed it shall be submitted as provided by Rule 112-A.)

5. List all offset operators to the lease on which this well is located together with their correct mailing address.

Amerada Petroleum Corporation, Box 312, Midland, Texas 79701

Cities Service Oil Company, Box 4906, Midland, Texas 79701

Continental Oil Company, Box 431, Midland, Texas 79701

Getty Oil Company, Box 1231, Midland, Texas 79701

Gulf Oil Corporation, Box 1150, Midland, Texas 79701

Marathon Oil Company, Box 552, Midland, Texas 79701

Skelly Oil Company, Box 1727, Midland, Texas 79701

Shell Oil Company, Box 1509, Midland, Texas 79701

6. Were all operators listed in Item 5 above notified and furnished a copy of this application? YES ☒ NO ☐. If answer is yes, give date of such notification July 18, 1969.

CERTIFICATE: I, the undersigned, state that I am the Agent of the Humble Oil & Refining Company (company), and that I am authorized by said company to make this report; and that this report was prepared under my supervision and direction and that the facts stated therein are true, correct and complete to the best of my knowledge.

A. L. Clemmer, D. L. Clemmer
Signature

*Should waivers from all offset operators not accompany an application for administrative approval, the New Mexico Oil Conservation Commission will hold the application for a period of twenty (20) days from date of receipt by the Commission's Santa Fe office. If, after said twenty-day period, no protest nor request for hearing is received by the Santa Fe office, the application will then be processed.

NOTE: If the proposed multiple completion will result in an unorthodox well location and/or a non-standard perforation unit in one or more of the producing zones, then separate application for approval of the same should be filed simultaneously with this application.

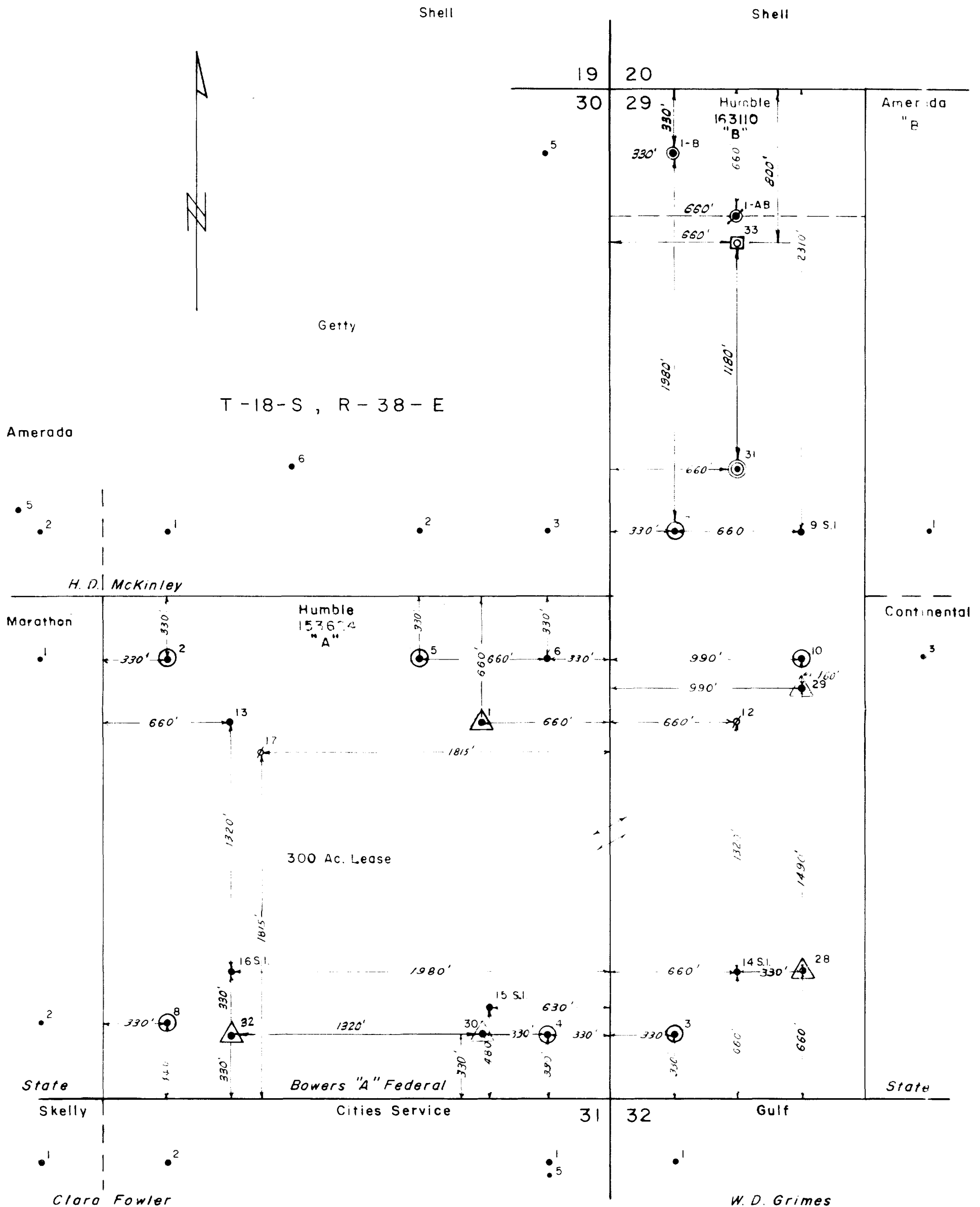

-LEGEND-

- Bowers Seven Rivers
- ▲ Hobbs Blinbry
- ⊙ Hobbs San Andres Grayburg
- ⊞ Hobbs San Andres Grayburg - Blinbry Dual
- ⊙ Hobbs Drinkard - Blinbry Dual



THIS APPLICATION FOR WELL NO. 31

BOWERS "A" FEDERAL - LSE # 153624 SE/4 SEC. 30 & S-140 AC. OF W/4 SEC. 29 T-18-S, R-38-E LEA CO., N.M.		HUMBLE OIL & REFINING COMPANY SOUTHWEST REGION PRODUCTION DEPARTMENT MIDLAND, TEXAS	
DRAWN W. M. B.	ENGR. SECTION	SCALE 1" = 500'	JOB NO.
CHECKED	APPROVED	DATE 5-14-69	FILE NO. W-B 1475

