

NO. OF COPIES RECEIVED	
DISTRIBUTION	
SANTA FE	
FILE	
U.S.G.S.	
LAND OFFICE	
OPERATOR	

NEW MEXICO OIL CONSERVATION COMMISSION

Form C-101
Revised 1-1-65

APPLICATION FOR PERMIT TO DRILL, DEEPEN, OR PLUG BACK		5A. Indicate Type of Lease STATE <input type="checkbox"/> FEE <input checked="" type="checkbox"/>
		5. State Oil & Gas Lease No.
1a. Type of Work b. Type of Well OIL WELL <input checked="" type="checkbox"/> GAS WELL <input type="checkbox"/> OTHER <input type="checkbox"/> DRILL <input checked="" type="checkbox"/> DEEPEN <input type="checkbox"/> PLUG BACK <input type="checkbox"/> SINGLE ZONE <input type="checkbox"/> MULTIPLE ZONE <input type="checkbox"/>		7. Unit Agreement Name
2. Name of Operator Getty Oil Company		8. Farm or Lease Name H. D. McKinley
3. Address of Operator Box 219, Hobbs, New Mexico		9. Well No. 9
4. Location of Well UNIT LETTER G LOCATED 2235 FEET FROM THE North LINE AND 2310 FEET FROM THE East LINE OF SEC. 30 TWP. 18S RGE. 38E NMPM		10. Field and Pool, or Wildcat UNDEVELOPED
		12. County Lea
19. Proposed Depth 6050		19A. Formation Blinberry
20. Rotary or C.T. Rotary		
21. Elevations (Show whether DF, RT, etc.) 3653.5 OR	21A. Kind & Status Plug. Bond Blanket	21B. Drilling Contractor Pending
		22. Approx. Date Work will start 7-15-69

PROPOSED CASING AND CEMENT PROGRAM

SIZE OF HOLE	SIZE OF CASING	WEIGHT PER FOOT	SETTING DEPTH	SACKS OF CEMENT	EST. TOP
17-1/2	13-3/8	48	360	450	Surface
11	8-5/8	24 & 32	3850	1120*	Surface
7-7/8	5-1/2	15.5	6050	650	3300'

* Actual volume to be determined by fluid check

It is proposed to drill a 17-1/2" hole to 360' where the 13-3/8" surface casing will be set and cemented to the surface with 140 sx Class C w/4% gel and 2% calcium chloride per sack followed with 200 sx Class C w/2% CaCl₂ per sack. Then an 11" hole will be drilled to 3850' where the 8-5/8" casing will be set. The 8-5/8" casing will be cemented as follows: Stage 1, 260 sx Class C w/4% Gel and 3% salt per sack followed with 150 sx Class C with 3% salt per sack. Stage 2 through DV tool @ 2600', 140 sx Class C w/16% gel and 49% salt per sack. Then a 7-7/8" hole is to be drilled to 6050' where open hole logs will be run (Borehole compensated sonic-Gamma Ray, Dual Induction, Laterolog, Microlog). The 5-1/2" casing to be set at 6050', and cemented with 230 sx Class C w/4% gel and 1 1/4% sx Cello-Flake followed w/200 sx Class H w/1% CFR-2 and 1 1/4% floccs per sack. Perforations in Blinberry zone to be selected after logging.

IN ABOVE SPACE DESCRIBE PROPOSED PROGRAM: IF PROPOSAL IS TO DEEPEN OR PLUG BACK, GIVE DATA ON PRESENT PRODUCTIVE ZONE AND PROPOSED NEW PRODUCTIVE ZONE. GIVE BLOWOUT PREVENTER PROGRAM, IF ANY.

I hereby certify that the information above is true and complete to the best of my knowledge and belief.

Signed C. L. WADE Title Area Superintendent Date July 3, 1969

(This space for State Use)

APPROVED BY [Signature] TITLE DATE

CONDITIONS OF APPROVAL, IF ANY:

13 7/8
10-14-69

NEW MEXICO OIL CONSERVATION COMMISSION
WELL LOCATION AND ACREAGE DEDICATION PLAT

Form C-102
Supersedes C-128
Effective 1-1-65

All distances must be from the outer boundaries of the Section.

Operator GETTY OIL COMPANY			Lease 12-00 MCKINLEY		Well No. 9
Unit Letter G	Section 30	Township 18 SOUTH	Range 38 EAST	County LEA	
Actual Footage Location of Well: 2235 feet from the NORTH line and 2310 feet from the EAST line					
Ground Level Elev. 3693.5	Producing Formation Blinney	Pool UNDESIGNATED	Dedicated Acreage: 40 Acres		

1. Outline the acreage dedicated to the subject well by colored pencil or hachure marks on the plat below.
2. If more than one lease is dedicated to the well, outline each and identify the ownership thereof (both as to working interest and royalty).
3. If more than one lease of different ownership is dedicated to the well, have the interests of all owners been consolidated by communitization, unitization, force-pooling, etc?

☐ Yes ☐ No If answer is "yes," type of consolidation _____

If answer is "no," list the owners and tract descriptions which have actually been consolidated. (Use reverse side of this form if necessary.) _____

No allowable will be assigned to the well until all interests have been consolidated (by communitization, unitization, forced-pooling, or otherwise) or until a non-standard unit, eliminating such interests, has been approved by the Commission.

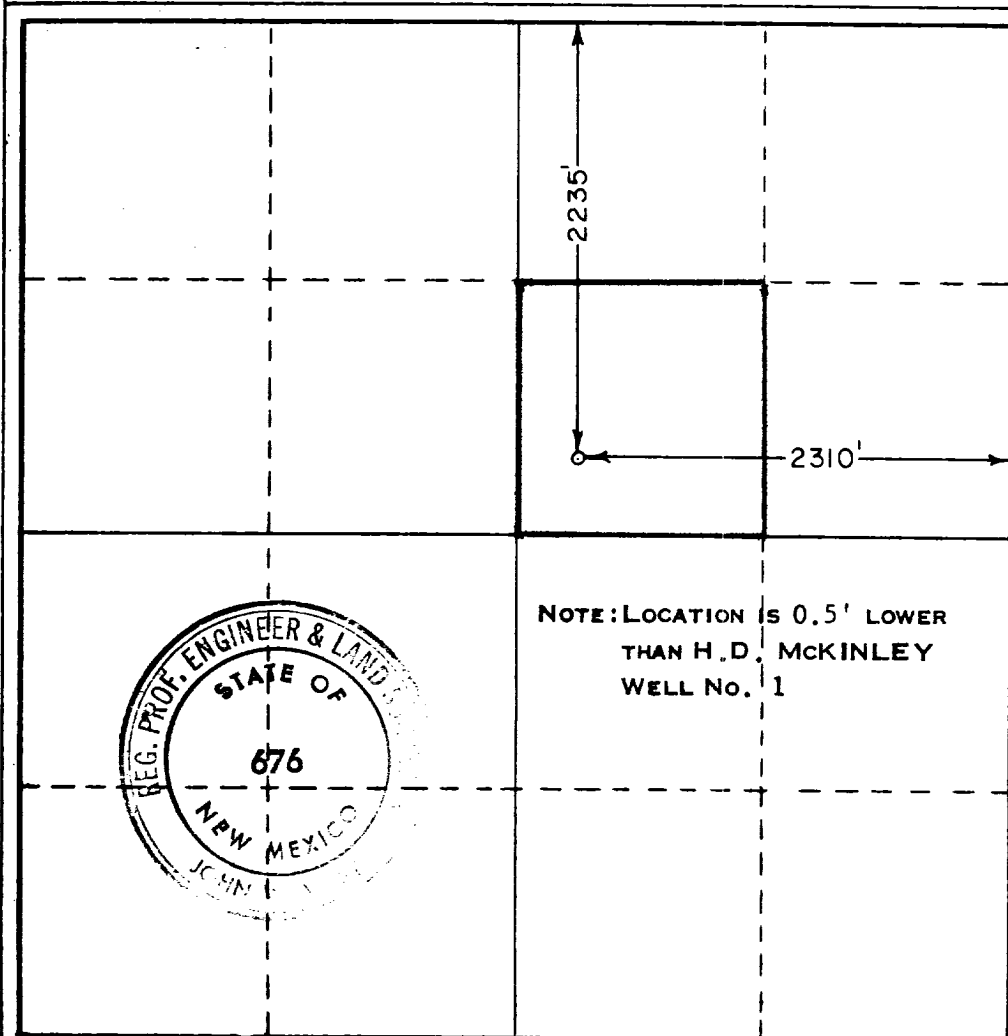

CERTIFICATION

I hereby certify that the information contained herein is true and complete to the best of my knowledge and belief.

Original Signed By

Name **G. L. WADE**

G. L. Wade

Position

Area Superintendent

Company

Getty Oil Company

Date

July 1, 1969

I hereby certify that the well location shown on this plat was plotted from field notes of actual surveys made by me or under my supervision, and that the same is true and correct to the best of my knowledge and belief.

Date Surveyed

JULY 2, 1969

Registered Professional Engineer and/or Land Surveyor

John W West

Certificate No.

676

