

HUMBLE OIL & REFINING COMPANY

MIDLAND, TEXAS 79701

PRODUCTION DEPARTMENT
SOUTHWESTERN DIVISION
E. C. BARFIELD
OPERATIONS MANAGER

August 27, 1969

POST OFFICE BOX 1800

Application to Dual Complete Bowers "A"
Federal Well No. 32, Hobbs Drinkard and
Hobbs Blinebry Pools, Lea County,
New Mexico

New Mexico Oil Conservation Commission
P. O. Box 2088
Santa Fe, New Mexico 87501

Attention: Mr. A. L. Porter, Jr.

Gentlemen:

Humble Oil & Refining Company respectfully requests administrative approval to dual complete its Bowers "A" Federal Well No. 32, located in Unit O, Section 30, T-18-S, R-38-E.

It is proposed to dually complete this well in such a manner as to permit the Drinkard and Blinebry pools to be produced through parallel strings of 2-3/8" O.D. tubing as shown on the attached sketch.

Yours very truly,



E. C. Barfield

DLC/ms
attachments

Orig & 1 cc: NMOCC - Santa Fe, New Mexico
2 cc: NMOCC - Hobbs, New Mexico
1 cc: Hobbs District
1 cc: Central File
1 cc: Offset Operators

NEW MEXICO OIL CONSERVATION COMMISSION
SANTA FE, NEW MEXICO
APPLICATION FOR MULTIPLE COMPLETION

Form C-107
5-1-61

Operator Humble Oil & Refining Company		County Lea	Date August 26, 1969
Address Box 1600, Midland, Texas 79701		Lease Bowers "A" Federal	Well No. 32
Location of Well 0	Unit 30	Township 18 South	Range 38-East

1. Has the New Mexico Oil Conservation Commission heretofore authorized the multiple completion of a well in these same pools or in the same zones within one mile of the subject well? YES ☒ NO ☐
2. If answer is yes, identify one such instance: Order No. **MC-1875**; Operator Lease, and Well No.: **Humble Oil & Refining Company, Bowers "A" Federal Com. 31, Well No. 31**

3. The following facts are submitted:	Upper Zone	Intermediate Zone	Lower Zone
a. Name of Pool and Formation	Blinebry		Drinkard
b. Top and Bottom of Pay Section (Perforations)	5940-5954		6974-6982
c. Type of production (Oil or Gas)	Oil		Oil
d. Method of Production (Flowing or Artificial Lift)	Artificial Lift		Flowing

4. The following are attached. (Please check YES or NO)

- | | | |
|-------------------------------------|-------------------------------------|---|
| Yes | No | |
| <input checked="" type="checkbox"/> | <input type="checkbox"/> | a. Diagrammatic Sketch of the Multiple Completion, showing all casing strings, including diameters and setting depths, centralizers and/or turbolizers and location thereof, quantities used and top of cement, perforated intervals, tubing strings, including diameters and setting depth, location and type of packers and side door chokes, and such other information as may be pertinent. |
| <input checked="" type="checkbox"/> | <input type="checkbox"/> | b. Plat showing the location of all wells on applicant's lease, all offset wells on offset leases, and the names and addresses of operators of all leases offsetting applicant's lease. |
| <input checked="" type="checkbox"/> | <input type="checkbox"/> | c. Waivers consenting to such multiple completion from each offset operator, or in lieu thereof, evidence that said offset operators have been furnished copies of the application.* |
| <input type="checkbox"/> | <input checked="" type="checkbox"/> | d. Electrical log of the well or other acceptable log with tops and bottoms of producing zones and intervals of perforation indicated thereon. (If such log is not available at the time application is filed it shall be submitted as provided by Rule 112-A.) |

5. List all offset operators to the lease on which this well is located together with their correct mailing address.

Amerada Petroleum Corporation, Box 312, Midland, Texas 79701

Cities Service Oil Company, Box 4906, Midland, Texas 79701

Getty Oil Company, Box 1231, Midland, Texas 79701

Continental Oil Company, Box 431, Midland, Texas 79701

Gulf Oil Corporation, Box 1150, Midland, Texas 79701

Skelly Oil Company, Box 1727, Midland, Texas 79701

Marathon Oil Company, Box 552, Midland, Texas 79701

Shell Oil Company, Box 1509, Midland, Texas 79701

6. Were all operators listed in Item 5 above notified and furnished a copy of this application? YES ☒ NO ☐ . If answer is yes, give date of such notification **8-27-69**.

CERTIFICATE: I, the undersigned, state that I am the **Agent** of the **Humble Oil & Refining Company** (company), and that I am authorized by said company to make this report; and that this report was prepared under my supervision and direction and that the facts stated therein are true, correct and complete to the best of my knowledge.

A. L. Clemmer
Signature **A. L. Clemmer**

*Should waivers from all offset operators not accompany an application for administrative approval, the New Mexico Oil Conservation Commission will hold the application for a period of twenty (20) days from date of receipt by the Commission's Santa Fe office. If, after said twenty-day period, no protest nor request for hearing is received by the Santa Fe office, the application will then be processed.

NOTE: If the proposed multiple completion will result in an unorthodox well location and/or a non-standard proration unit in one or more of the producing zones, then separate application for approval of the same should be filed simultaneously with this application.

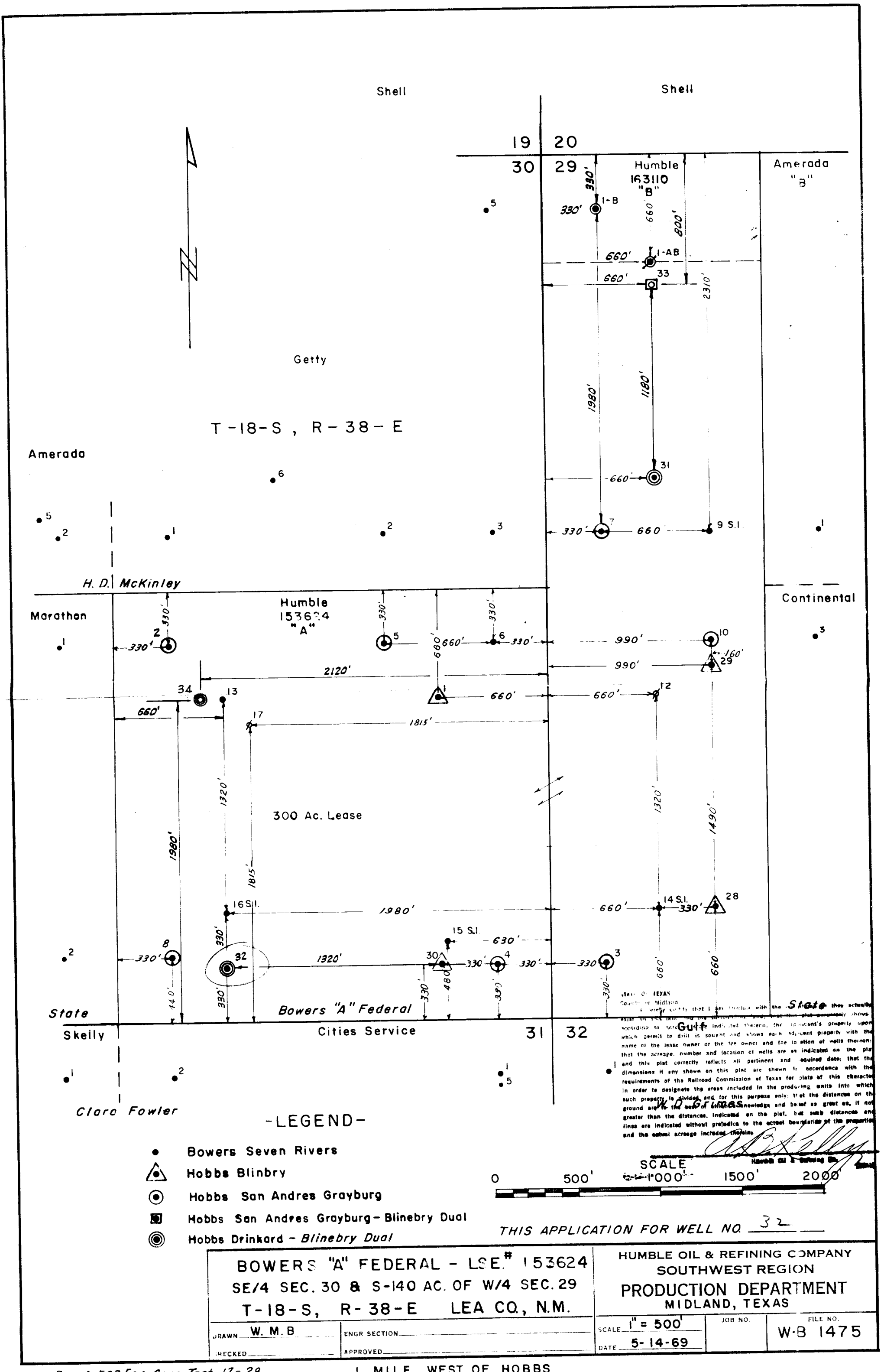

HOBBS - BLINEBRY - DRINKARD POOLS DUAL (DOUBLE COMPLETION)
 NON-CONCENTRIC 3-1/2" O.D. 7.7#, J-55, N.U. 10" O.D. THD. CSG. STRINGS
 TWO CSG. STRINGS

BOWERS "A" FEDERAL #32

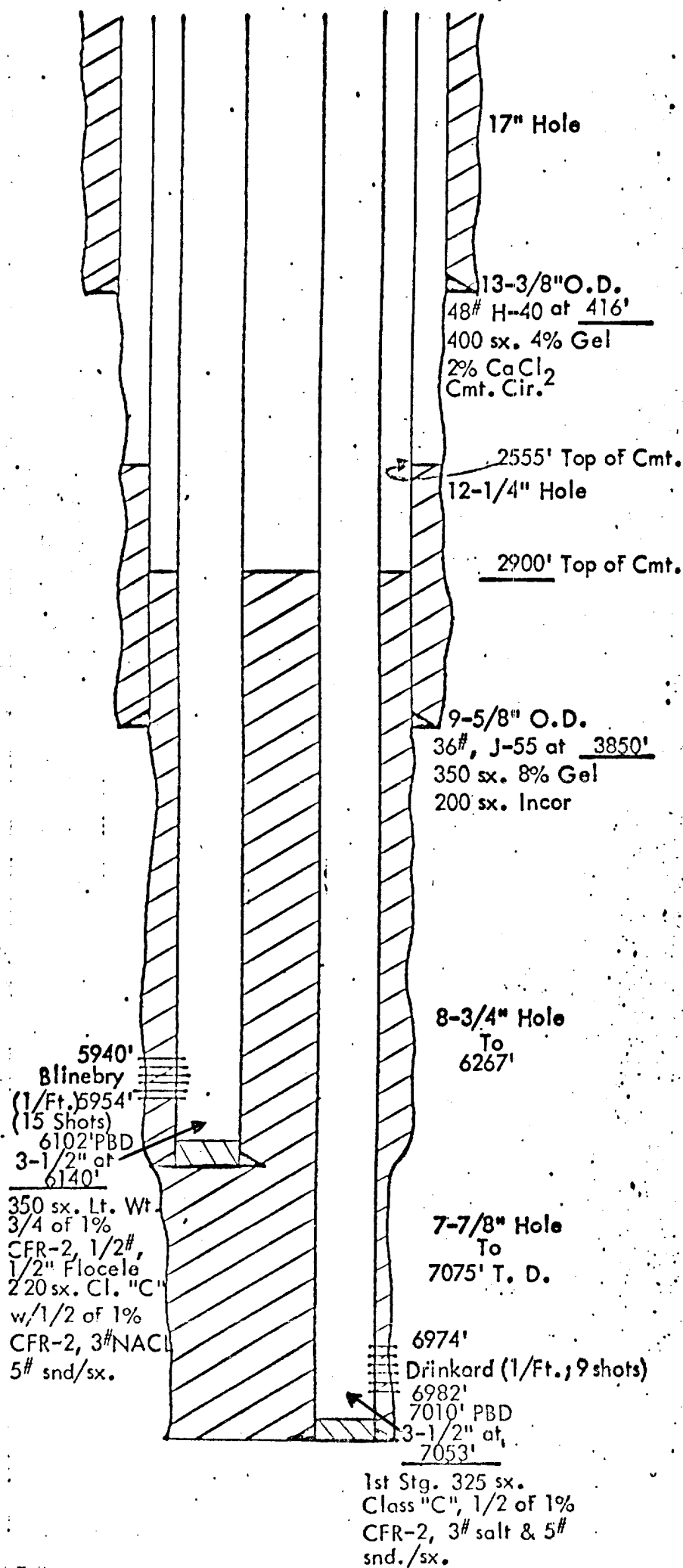

2 Strings - 3-1/2" O.D., 3.068" I.D., 7.7#, J-55 Tbg. - 4.25" Cplg. O.D.; Jt. Yld. 89,470#

Capacity - 0.914 Bbl./100 Ft.; 2.943" Drift

2 Strings - 2-3/8" O.D., N.U., Tbg. (I.D. 1.995") J-55 Cplg. O.D. - 2.875", Jt. Yld. 49,450#
 Int. Yld. - 7,700 Psi, Collapse - 7180 Psi; Capacity 0.387 Bbls./100 Ft.

9-5/8", 36#, I.D. - 8.921", Drift 8.765", J-55, Collapse - 2220 Psi (1-1/8 S.F.)