

COUNTY LEA FIELD Hcbbs STATE NM 30-02 23246

OPR SHELL OIL CO.

9 Grimes

Sec 28, T-18-S, R-38-E

731' FSL, 731' FWL of Sec.

Spd 8-9-69

Cmp 10-5-69

CSG & SX - TUBING
13 3/8" at 372' w/350 sx
9 5/8" at 3787' w/1400 sx
7" lnr 3513-7102' w/720 sx

LOGS EL GR RA IND HC A

CLASS		E	
FORMATION	DATUM	FORMATION	DATUM

TD 7102'; PBD 7065'

IP (Blinebry) Perfs 5892-5979' Swbd 93 BOPD + 55 BW. Pot based on 24 hr test. GOR 500; Grav 35.6.

IP (Drinkard) Perfs 6629-6956' F 236 BOPD + 44 BW. Pot based on 24 hr test thru 24/64" chk. GOR 815; Grav 36.8; TP 150#.

Distribution limited and publication prohibited by subscribers' agreement.
Reproduction rights reserved by Williams & Lee Scouting Service, Inc.

CONT. Moran
DATE

PROP DEPTH 7100' TYPE

F.R. 8-19-69
PD 7100' (Drinkard)
Contractor - Moran
8-18-69 Drlg. 3773' anhy & dolo
8-25-69 Drlg. 5970'
9-2-69 TD 7102'; WOC
Cored 6902-53', rec 51' lmy dolo, bldg oil from
vert fracs
Cored 6953-7004', rec 51' lmy dolo
9-8-69 TD 7102'; Prep Perf
9-15-69 TD 7102'; PBD 7065'; Swbg
Perf (L. Drinkard) @ 6765', 6910', 6913', 6937',
6944', 6946', 6954', 6956' w/1 SPI
Acid (6765-6956') 7000 gals
Flwd 236 BOPD + 44 BWPD in 24 hrs thru 24/64" chk,

LEA
SHELL OIL CO.

Hobbs
9 Grimes

NM Sec 28, T18S, R38E
Page #2

9-15-69 Continued
GOR 815, Grav 36.8, TP 150# (6765-6956')
9-22-69 TD 7102'; PBD 7065'; Swbg
Perf (U. Drinkard) @ 6705', 6707' w/1 SPI
Acid (6705-07') 1000 gals (15%)
Swbd 97 BO + 15 BW in 9 hrs (6705-07')
Perf (U. Drinkard) @ 6629', 6631', 6667', 6669'
w/1 SPI
Acid (6629-69') 800 gals (15%)
Swbd 159 BO + 23 BW in 24 hrs (10% BS&W) (6629-69')
9-29-69 TD 7102'; PBD 7065'; Tstg
Acid (6629-6765') 10,000 gals
Flwd 12 BO + 70 BW in 24 hrs thru 32/64" chk,
GOR 8400, TP 50# (6629-6765')

9-29-69 Continued
Flwd 198 BO + 40 BW in 24 hrs thru 24/64" chk,
TP 400-25# (6629-6956')
10-6-69 TD 7102'; PBD 7065'; Swbg
Perf (Blinebry) @ 5892', 5901', 5904', 5910',
5918', 5928', 5934', 5939', 5949', 5953', 5956',
5960', 5966', 5979' w/1 SPI
Acid (5892-5979') 5000 gals
Swbd 8 BO + 3 BLW in 4 hrs (5892-5979')
Acid (5892-5979') 3000 gals
Swbd 93 BO + 44 BLW + 11 BW in 24 hrs,
GOR 500, Grav 35.6
10-13-69 TD 7102'; PBD 7065'; COMPLETE
Drinkard Completed 9-11-69

LEA
SHELL OIL CO.

Hobbs
9 Grimes

NM Sec 28,T18S,R38E
Page #3

10-13-69

Continued

LOG TOPS: Yates 2644', Queen 3367', Grayburg
3680', San Andres 3971', Glorieta 5344',
Blinbry 5742', Tubb 6444', Drinkard 6550'

10-16-69

COMPLETION REPORTED

AMENDED *

NEW MICO OIL CONSERVATION COMMISSION
WELL LOCATION AND ACREAGE DEDICATION PLAT

Form C-102
Supersedes C-128
Effective 1-1-65

All distances must be from the outer boundaries of the Section.

Operator Shell Oil Company			Lease Grinds		Well No. 9
Unit Letter M	Section 28	Township 18-S	Range 38-E	County Lea	
Actual Footage Location of Well: 730.7 feet from the south line and 730.7 feet from the Lea line					
Ground Level Elev. Not Available	Producing Formation Drinkard - Blinberry		Pool Hobbs - Drinkard Hobbs - Blinberry	Dedicated Acreage: 80* Acres	

1. Outline the acreage dedicated to the subject well by colored pencil or hachure marks on the plat below.
2. If more than one lease is dedicated to the well, outline each and identify the ownership thereof (both as to working interest and royalty).
3. If more than one lease of different ownership is dedicated to the well, have the interests of all owners been consolidated by communitization, unitization, force-pooling, etc?

☐ Yes ☐ No If answer is "yes," type of consolidation _____

If answer is "no," list the owners and tract descriptions which have actually been consolidated. (Use reverse side of this form if necessary.) _____

No allowable will be assigned to the well until all interests have been consolidated (by communitization, unitization, forced-pooling, or otherwise) or until a non-standard unit, eliminating such interests, has been approved by the Commission.

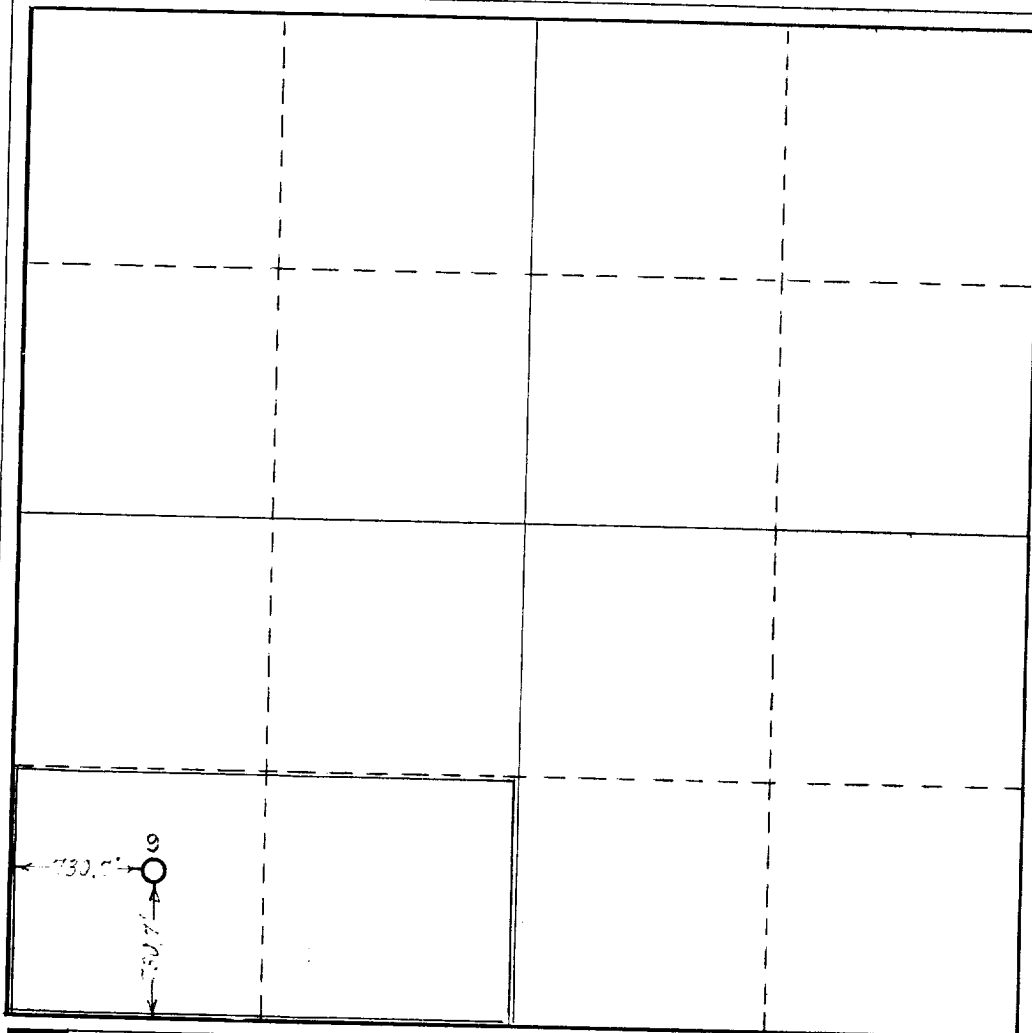

CERTIFICATION

I hereby certify that the information contained herein is true and complete to the best of my knowledge and belief.

M.O. Traugott M.O. Traugott

Name

Petrophysical Engineer

Position

Shell Oil Company

Company

September 3, 1969

Date

I hereby certify that the well location shown on this plat was plotted from field notes of actual surveys made by me or under my supervision, and that the same is true and correct to the best of my knowledge and belief.

Date Surveyed

Registered Professional Engineer and/or Land Surveyor

Certificate No.

