

NO. OF COPIES RECEIVED	
DISTRIBUTION	
SANTA FE	
FILE	
U.S.G.S.	
LAND OFFICE	
OPERATOR	

# NEW MEXICO OIL CONSERVATION COMMISSION

Form C-101  
Revised 1-1-65

5A. Indicate Type of Lease	
STATE <input type="checkbox"/>	FEE <input checked="" type="checkbox"/>
5. State Oil & Gas Lease No.	

## APPLICATION FOR PERMIT TO DRILL, DEEPEN, OR PLUG BACK

1a. Type of Work		7. Unit Agreement Name	
b. Type of Well OIL WELL <input checked="" type="checkbox"/> GAS WELL <input type="checkbox"/> OTHER <input type="checkbox"/>		8. Farm or Lease Name Grimes	
2. Name of Operator Shell Oil Company		9. Well No. 11	
3. Address of Operator P. O. Box 1509, Midland, Texas 79701		10. Field and Pool, or Wildcat Hobbs (Paddock)	
4. Location of Well UNIT LETTER <u>N</u> LOCATED <u>1700'</u> FEET FROM THE <u>East</u> LINE AND <u>750</u> FEET FROM THE <u>South</u> LINE OF SEC. <u>28</u> TWP. <u>18S</u> RGE. <u>38E</u> NMPM		12. County Lea	
19. Proposed Depth PB 5500		19A. Formation Paddock	
20. Rotary or C.T.			
21. Elevations (Show whether DF, RT, etc.) 3655 DF		21A. Kind & Status Plug. Bond Blanket	
21B. Drilling Contractor		22. Approx. Date Work will start Upon approval	

23.

## PROPOSED CASING AND CEMENT PROGRAM

SIZE OF HOLE	SIZE OF CASING	WEIGHT PER FOOT	SETTING DEPTH	SACKS OF CEMENT	EST. TOP
	13 3/8"	48#	348'	250	surface
	9 5/8"	36#	3805'	1400	
	7"	23#	3602-6350'	497	

Set CIBP at 5520'± and cap with 2 sx cement to abandon Hobbs (Blinebry).

Perforate 7" casing w/1 JSPF 5361-5432' (11 holes).

Acidize and complete as warranted.

APPROVAL MADE  
FOR 90 DAY PERIOD  
DRILLING COMMENCED,

EXPIRES 3/2/75

IN ABOVE SPACE DESCRIBE PROPOSED PROGRAM: IF PROPOSAL IS TO DEEPEN OR PLUG BACK, GIVE DATA ON PRESENT PRODUCTIVE ZONE AND PROPOSED NEW PRODUCTIVE ZONE. GIVE BLOWOUT PREVENTER PROGRAM, IF ANY.

I hereby certify that the information above is true and complete to the best of my knowledge and belief.

Signed N. W. Harrison Title Staff Production Engineer Date 11-26-74

(This space for State Use)

APPROVED BY \_\_\_\_\_ TITLE \_\_\_\_\_ DATE \_\_\_\_\_

CONDITIONS OF APPROVAL, IF ANY:

NEW MEXICO OIL CONSERVATION COMMISSION  
WELL LOCATION AND ACREAGE DEDICATION PLAT

Form C-102  
Supersedes C-128  
Effective 1-1-65

All distances must be from the outer boundaries of the Section.

Operator <b>Shell Oil Company</b>			Lease <b>Grimes</b>			Well No. <b>11</b>		
Unit Letter <b>N</b>	Section <b>28</b>	Township <b>18S</b>	Range <b>38E</b>	County <b>Lea</b>				
Actual Footage Location of Well: <b>1700</b> feet from the <b>East</b> line and <b>750</b> feet from the <b>South</b> line								
Ground Level Elev:		Producing Formation <b>Hobbs (Paddock)</b>		Pool <b>Paddock</b>			Dedicated Acreage: <b>40</b> Acres	

1. Outline the acreage dedicated to the subject well by colored pencil or hachure marks on the plat below.
2. If more than one lease is dedicated to the well, outline each and identify the ownership thereof (both as to working interest and royalty).
3. If more than one lease of different ownership is dedicated to the well, have the interests of all owners been consolidated by communitization, unitization, force-pooling, etc?

☐ Yes ☐ No If answer is "yes," type of consolidation \_\_\_\_\_

If answer is "no," list the owners and tract descriptions which have actually been consolidated. (Use reverse side of this form if necessary.) \_\_\_\_\_

No allowable will be assigned to the well until all interests have been consolidated (by communitization, unitization, forced-pooling, or otherwise) or until a non-standard unit, eliminating such interests, has been approved by the Commission.

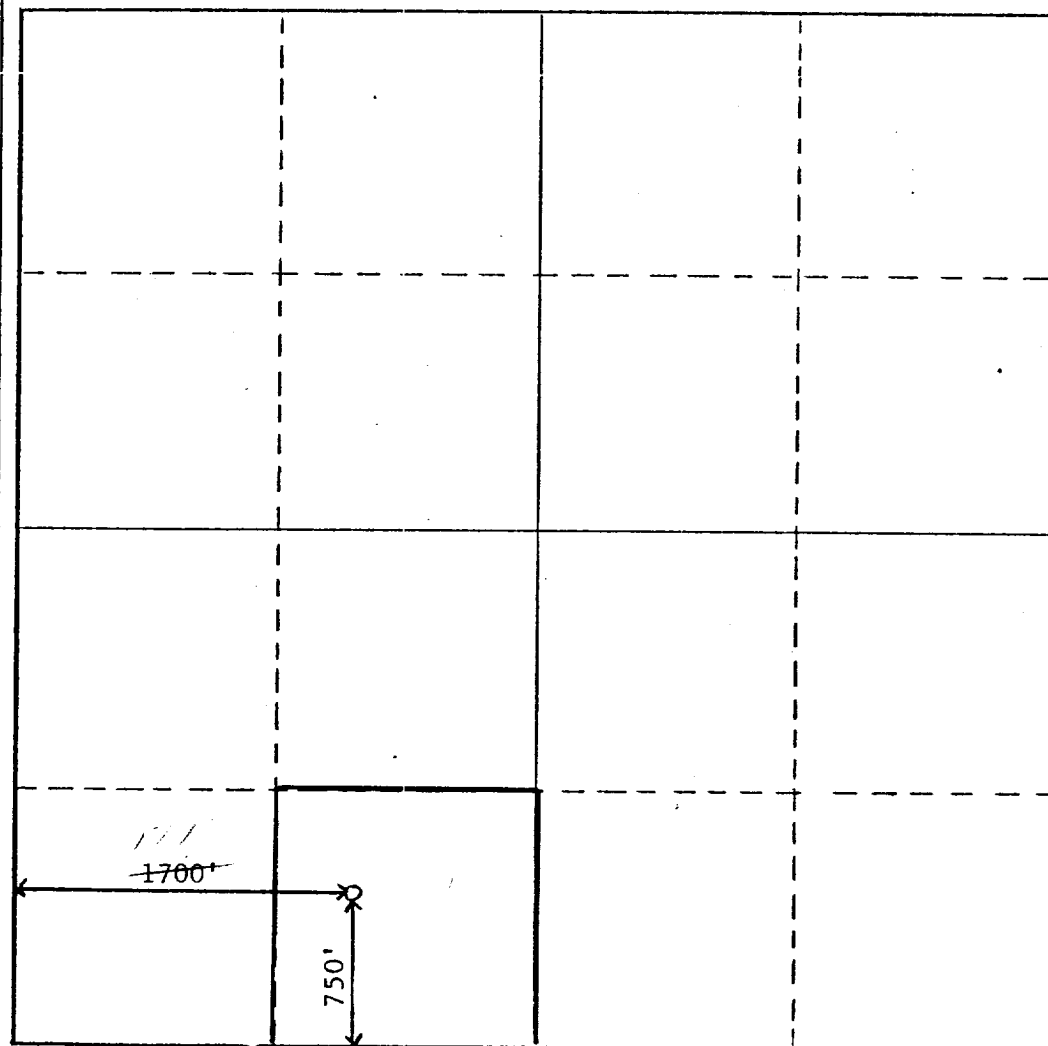

CERTIFICATION

I hereby certify that the information contained herein is true and complete to the best of my knowledge and belief.

*N. W. Harrison*

Name

**N. W. Harrison**

Position

**Staff Production Engineer**

Company

**Shell Oil Company**

Date

**11-26-74**

I hereby certify that the well location shown on this plat was plotted from field notes of actual surveys made by me or under my supervision, and that the same is true and correct to the best of my knowledge and belief.

Date Surveyed

Registered Professional Engineer and/or Land Surveyor

Certificate No.

