

NO. OF COPIES RECEIVED	
DISTRIBUTION	
SANTA FE	
FILE	
U.S.G.S.	
LAND OFFICE	
OPERATOR	

# NEW MEXICO OIL CONSERVATION COMMISSION

Form C-101  
Revised 1-1-65

5A. Indicate Type of Lease STATE: <input checked="" type="checkbox"/> FEE <input type="checkbox"/>
5. State Oil & Gas Lease No. <b>B-2229</b>

## APPLICATION FOR PERMIT TO DRILL, DEEPEN, OR PLUG BACK

1a. Type of Work b. Type of Well DRILL <input checked="" type="checkbox"/> DEEPEN <input type="checkbox"/> PLUG BACK <input type="checkbox"/> OIL WELL <input type="checkbox"/> GAS WELL <input type="checkbox"/> OTHER <input type="checkbox"/> SINGLE ZONE <input checked="" type="checkbox"/> MULTIPLE ZONE <input type="checkbox"/>		7. Unit Agreement Name
2. Name of Operator <b>Phillips Petroleum Company</b>		8. Farm or Lease Name <b>Philmax</b>
3. Address of Operator <b>Room B-2, Phillips Building, Odessa, Texas 79760</b>		9. Well No. <b>10</b>
4. Location of Well UNIT LETTER <b>K</b> LOCATED <b>1981</b> FEET FROM THE <b>south</b> LINE AND <b>1976</b> FEET FROM THE <b>west</b> LINE OF SEC. <b>27</b> TWP. <b>17-S</b> RGE. <b>33-E</b> NMPM		10. Field and Pool, or Wildcat <b>Maljamar-Grayburg/San A</b>
		12. County <b>Lea</b>
		19. Proposed Depth <b>4600</b>
		19A. Formation <b>Grayburg/San A.</b>
		20. Rotary or C.T. <b>rotary</b>
21. Elevations (Show whether DF, RT, etc.) <b>later</b>	21A. Kind & Status Plug. Bond <b>blanket</b>	21B. Drilling Contractor <b>later</b>
		22. Approx. Date Work will start <b>upon approval</b>

## PROPOSED CASING AND CEMENT PROGRAM

SIZE OF HOLE	SIZE OF CASING	WEIGHT PER FOOT	SETTING DEPTH	SACKS OF CEMENT	EST. TOP
12-1/4"	8-5/8"	24#	350'	275	Circulate
7-7/8"	4-1/2"	11.6#	T.D.	275	Sufficient to cover prod. intervals.

Series 900 B.O.P. equipment, hydraulically operated.

Mud additives as required.

Jan 23, 1969

IN ABOVE SPACE DESCRIBE PROPOSED PROGRAM: IF PROPOSAL IS TO DEEPEN OR PLUG BACK, GIVE DATA ON PRESENT PRODUCTIVE ZONE AND PROPOSED NEW PRODUCTIVE ZONE. GIVE BLOWOUT PREVENTER PROGRAM, IF ANY.

I hereby certify that the information above is true and complete to the best of my knowledge and belief.

Signed W. J. Mueller Title Associate Reservoir Engineer Date 10-21-69  
(This space for State Use)

APPROVED BY John W. Ruggen TITLE Geologist DATE OCT 24 1969  
CONDITIONS OF APPROVAL, IF ANY:

**NEW MEXICO OIL CONSERVATION COMMISSION  
WELL LOCATION AND ACREAGE DEDICATION PLAT**

Form C-102  
Supersedes C-128  
Effective 1-1-65

All distances must be from the outer boundaries of the Section.

Operator <b>PHILLIPS PETROLEUM COMPANY</b>			Lease <b>PHILMEX</b>		Well No. <b>10</b>
Unit Letter <b>K</b>	Section <b>27</b>	Township <b>17 SOUTH</b>	Range <b>33 EAST</b>	County <b>LEA</b>	
Actual Footage Location of Well: <b>1981</b> feet from the <b>SOUTH</b> line and <b>1976</b> feet from the <b>WEST</b> line					
Ground Level Elev. <b>Later</b>	Producing Formation <b>Grayburg-San Andres</b>	Pool <b>Maljamar - Grayburg/San Andres</b>	Dedicated Acreage: <b>40</b> Acres		

1. Outline the acreage dedicated to the subject well by colored pencil or hachure marks on the plat below.
2. If more than one lease is dedicated to the well, outline each and identify the ownership thereof (both as to working interest and royalty).
3. If more than one lease of different ownership is dedicated to the well, have the interests of all owners been consolidated by communitization, unitization, force-pooling, etc?

☐ Yes ☒ No If answer is "yes," type of consolidation \_\_\_\_\_

If answer is "no," list the owners and tract descriptions which have actually been consolidated. (Use reverse side of this form if necessary.) \_\_\_\_\_

No allowable will be assigned to the well until all interests have been consolidated (by communitization, unitization, forced-pooling, or otherwise) or until a non-standard unit, eliminating such interests, has been approved by the Commission.

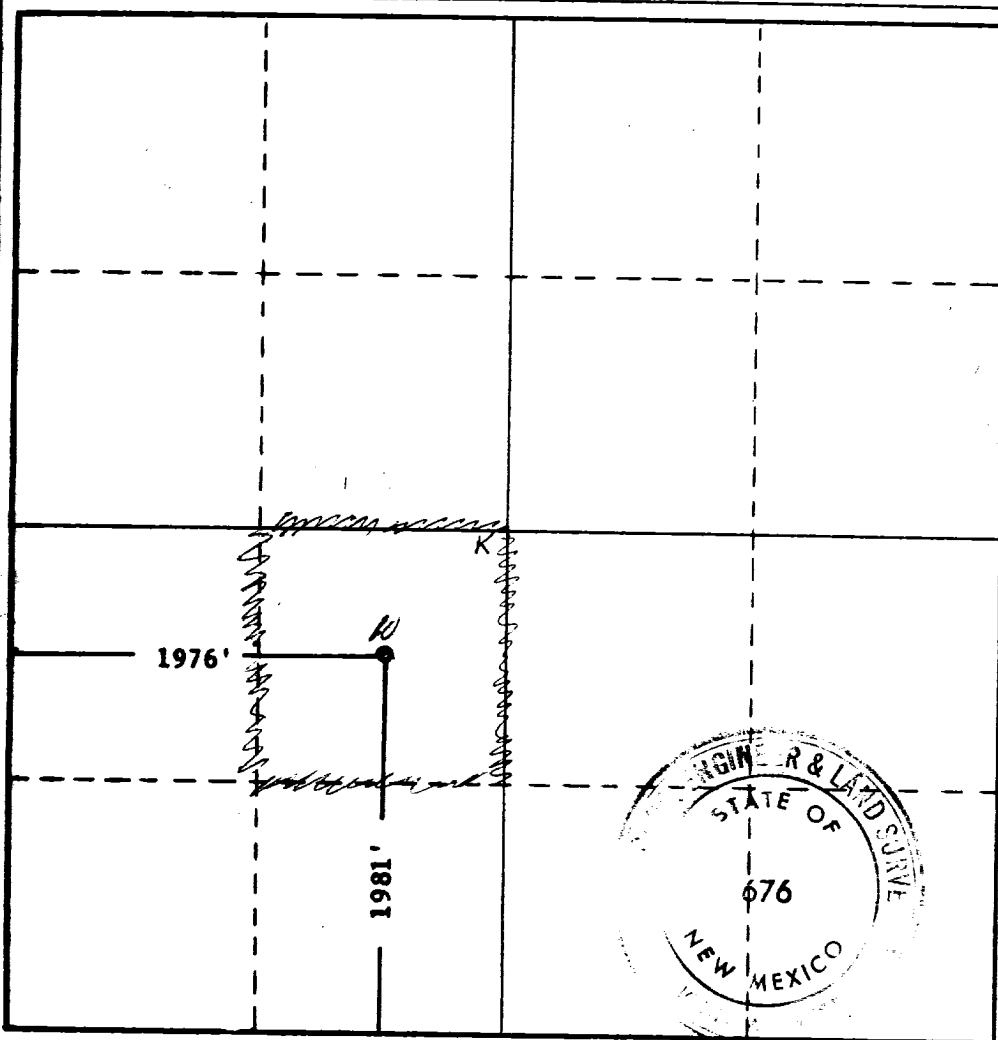

**CERTIFICATION**

I hereby certify that the information contained herein is true and complete to the best of my knowledge and belief.

Name **W. J. Mueller**

Position **Associate Reservoir Engineer**

Company **Phillips Petroleum Company**

Date **October 21, 1969**

I hereby certify that the well location shown on this plat was plotted from field notes of actual surveys made by me or under my supervision, and that the same is true and correct to the best of my knowledge and belief.

Date Surveyed **10-18-1969**

Registered Professional Engineer and/or Land Surveyor

**John W. West**  
Certificate No. **676**