

UNITED STATES
DEPARTMENT OF THE INTERIOR
GEOLOGICAL SURVEY

APPLICATION FOR PERMIT TO DRILL, DEEPEN, OR PLUG BACK

1a. TYPE OF WORK DRILL <input checked="" type="checkbox"/> DEEPEN <input type="checkbox"/> PLUG BACK <input type="checkbox"/>		5. LEASE DESIGNATION AND SERIAL NO. N.M. 0558133		
b. TYPE OF WELL OIL WELL <input checked="" type="checkbox"/> GAS WELL <input type="checkbox"/> OTHER <input type="checkbox"/> SINGLE ZONE <input checked="" type="checkbox"/> MULTIPLE ZONE <input type="checkbox"/>		6. IF INDIAN, ALLOTTEE OR TRIBE NAME		
2. NAME OF OPERATOR Hanson Oil Company		7. UNIT AGREEMENT NAME		
3. ADDRESS OF OPERATOR P. O. Box 1515, Roswell, New Mexico 88201		8. FARM OR LEASE NAME Pennzoil Federal		
4. LOCATION OF WELL (Report location clearly and in accordance with any State requirements.)* At surface 330' FSL & 2310' FEL At proposed prod. zone Sec. 19, T-18-S, R-34-E Lea County, New Mexico		9. WELL NO. 1		
14. DISTANCE IN MILES AND DIRECTION FROM NEAREST TOWN OR POST OFFICE* 25 miles west of Hobbs, New Mexico		10. FIELD AND POOL, OR WILDCAT E-K Queen		
15. DISTANCE FROM PROPOSED* LOCATION TO NEAREST PROPERTY OR LEASE LINE, FT. (Also to nearest drlg. unit line, if any) 330'	16. NO. OF ACRES IN LEASE 40	11. SEC., T., R., M., OR BLK. AND SURVEY OR AREA Sec. 19 - 18S - 34E		
18. DISTANCE FROM PROPOSED LOCATION* TO NEAREST WELL, DRILLING, COMPLETED, OR APPLIED FOR, ON THIS LEASE, FT. 330'	19. PROPOSED DEPTH 4900'	12. COUNTY OR PARISH Lea		
21. ELEVATIONS (Show whether DF, RT, GR, etc.) 3950' GL		13. STATE N. Mex.		
22. APPROX. DATE WORK WILL START* Nov. 20, 1969				
23. PROPOSED CASING AND CEMENTING PROGRAM				
SIZE OF HOLE 12" 7-7/8"	SIZE OF CASING 8-5/8" 5-1/2"	WEIGHT PER FOOT 24# 15-1/2#	SETTING DEPTH 250' 4900'	QUANTITY OF CEMENT 150 sx. (circulate) 250 sx.

It is proposed that the captioned well be drilled with rotary to a total depth of 4900 feet in the Queen Formation and that if commercial oil or gas is encountered that the proposed casing program be followed and that the well be perforated and fractured with lease oil.

IN ABOVE SPACE DESCRIBE PROPOSED PROGRAM: If proposal is to deepen or plug back, give data on present productive zone and proposed new productive zone. If proposal is to drill or deepen directionally, give pertinent data on subsurface locations and measured and true vertical depths. Give blowout preventer program, if any.

24. SIGNED *Harry F. Schram* TITLE Exec. Vice President DATE 11-14-69
(This space for Federal or State office use)

PERMIT NO. _____ APPROVAL DATE _____

APPROVED BY _____ TITLE _____ DATE _____

CONDITIONS OF APPROVAL, IF ANY:

*See Instructions On Reverse Side

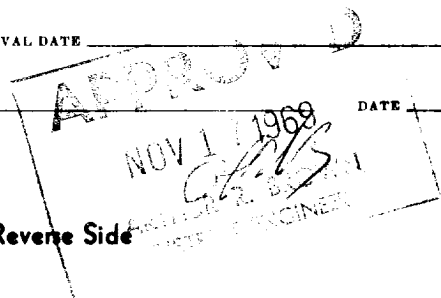

NEW MEXICO OIL CONSERVATION COMMISSION
WELL LOCATION AND ACREAGE DEDICATION PLAT

Form C-102
Supersedes C-128
Effective 1-1-65

All distances must be from the outer boundaries of the Section.

Operator HANSON OIL COMPANY			Lease Pennzoil Federal		Well No. 1
Unit Letter O	Section 19	Township 18 SOUTH	Range 34 EAST	County LEA	
Actual Footage Location of Well: 330 feet from the SOUTH line and 2310 feet from the EAST line					
Ground Level Elev. 3950'	Producing Formation Queen		Pool E-K Queen		Dedicated Acreage: 40 Acres

1. Outline the acreage dedicated to the subject well by colored pencil or hatchure marks on the plat below.
2. If more than one lease is dedicated to the well, outline each and identify the ownership thereof (both as to working interest and royalty).
3. If more than one lease of different ownership is dedicated to the well, have the interests of all owners been consolidated by communitization, unitization, force-pooling, etc?

☐ Yes ☐ No If answer is "yes," type of consolidation _____

If answer is "no," list the owners and tract descriptions which have actually been consolidated. (Use reverse side of this form if necessary.) _____

No allowable will be assigned to the well until all interests have been consolidated (by communitization, unitization, forced-pooling, or otherwise) or until a non-standard unit, eliminating such interests, has been approved by the Commission.

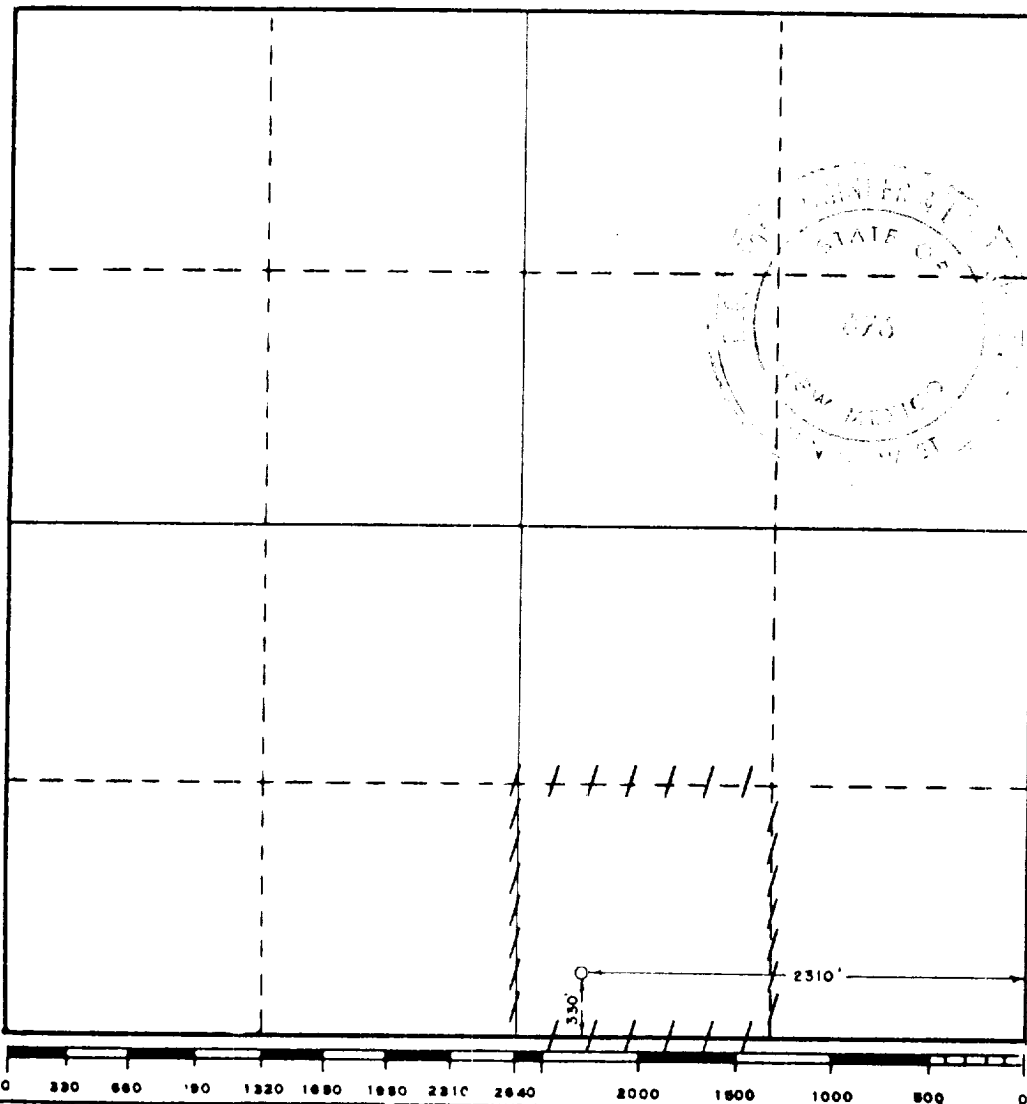

CERTIFICATION

I hereby certify that the information contained herein is true and complete to the best of my knowledge and belief.

Name
Harry F. Schmitt
Position
Exec. Vice President
Company
Hanson Oil Company
Date
November 14, 1969

I hereby certify that the well location shown on this plat was plotted from field notes of actual surveys made by me or under my supervision, and that the same is true and correct to the best of my knowledge and belief.

Date Surveyed
NOVEMBER 12, 1969

Registered Professional Engineer and/or Land Surveyor

John W. West
Certificate No.
676