

NO. OF COPIES RECEIVED	
DISTRIBUTION	
SANTA FE	
FILE	
U.S.G.S.	
LAND OFFICE	
OPERATOR	

NEW MEXICO OIL CONSERVATION COMMISSION

Form C-101
Revised 12-65

5A. Indicate Type of Lease
STATE <input type="checkbox"/> FEDERAL <input checked="" type="checkbox"/>
5. State Oil & Gas Lease No.

APPLICATION FOR PERMIT TO DRILL, DEEPEN, OR PLUG BACK

1a. Type of Work		7. Unit Agreement Name	
DRILL <input checked="" type="checkbox"/> DEEPEN <input type="checkbox"/> PLUG BACK <input type="checkbox"/>			
b. Type of Well OIL WELL <input checked="" type="checkbox"/> GAS WELL <input type="checkbox"/> OTHER <input type="checkbox"/>		8. Farm or Lease Name	
		McKinley A	
2. Name of Operator		9. Well No.	
Shell Oil Company		11. Designated Hobbs-Drinkard Hobbs-Blinbry	
3. Address of Operator		12. County	
P. O. Box 1509, Midland, Texas 79701		Lea	
4. Location of Well		19. Proposed Depth	
UNIT LETTER <u>N</u> LOCATED <u>420</u> FEET FROM THE <u>south</u> LINE AND <u>1980</u> FEET FROM THE <u>west</u> LINE OF SEC. <u>19</u> TWP. <u>18-S</u> RGE. <u>38-E</u> NMPM		7100'	
		19A. Formation	
		Drinkard	
		20. Rotary or C.T.	
		Rotary	
21. Elevations (Show whether DF, RT, etc.)		21B. Drilling Contractor	
Est. 3660' DF		Not Determined	
21A. Kind & Status Plug. Bond		22. Approx. Date Work will start	
Blanket		On Approval	

23.

PROPOSED CASING AND CEMENT PROGRAM

SIZE OF HOLE	SIZE OF CASING	WEIGHT PER FOOT	SETTING DEPTH	SACKS OF CEMENT	EST. TOP
17 1/2"	13 3/8"		350'		Circ. Cm.
12 1/2"	9 5/8"		3820'		TOC 1300'
8 3/4"	7" Liner		7100'		Circ. Cm.
					Top of liner @ 3650'

Unorthodox location. Copies of Form C-101 and C-102 mailed to offset operators with request for waiver letters 3-10-70.

NSL 457

IN ABOVE SPACE DESCRIBE PROPOSED PROGRAM: IF PROPOSAL IS TO DEEPEN OR PLUG BACK, GIVE DATA ON PRESENT PRODUCTIVE ZONE AND PROPOSED NEW PRODUCTIVE ZONE. GIVE BLOWOUT PREVENTER PROGRAM, IF ANY.

I hereby certify that the information above is true and complete to the best of my knowledge and belief.

Signed J.D. Duren Title Staff Operations Engineer Date March 10, 1970

(This space for State Use)

APPROVED BY [Signature] TITLE DATE

CONDITIONS OF APPROVAL, IF ANY:

**NEW MEXICO OIL CONSERVATION COMMISSION
WELL LOCATION AND ACREAGE DEDICATION PLAN**

Form C-102
Supersedes C-128
Effective 1-1-65

All distances must be from the outer boundaries of the Section.

Operator SHELL OIL COMPANY			Lease MCKINLEY "A"		Well No. 11
Unit Letter N	Section 19	Township 18 SOUTH	Range 38 EAST	County LEA	
Actual Footage Location of Well: <div style="display: flex; justify-content: space-between;"> 420 feet from the SOUTH line and 1980 feet from the WEST line </div>					
Ground Level Elev. Est. 3660' 07"	Producing Formation Permian-Silurian	Pool Hotchkiss	Dedicated Acreage: 40 Acres		

1. Outline the acreage dedicated to the subject well by colored pencil or hachure marks on the plat below.
2. If more than one lease is dedicated to the well, outline each and identify the ownership thereof (both as to working interest and royalty).
3. If more than one lease of different ownership is dedicated to the well, have the interests of all owners been consolidated by communitization, unitization, force-pooling, etc?

☐ Yes ☐ No If answer is "yes," type of consolidation _____

If answer is "no," list the owners and tract descriptions which have actually been consolidated. (Use reverse side of this form if necessary.) _____

No allowable will be assigned to the well until all interests have been consolidated (by communitization, unitization, forced-pooling, or otherwise) or until a non-standard unit, eliminating such interests, has been approved by the Commission.

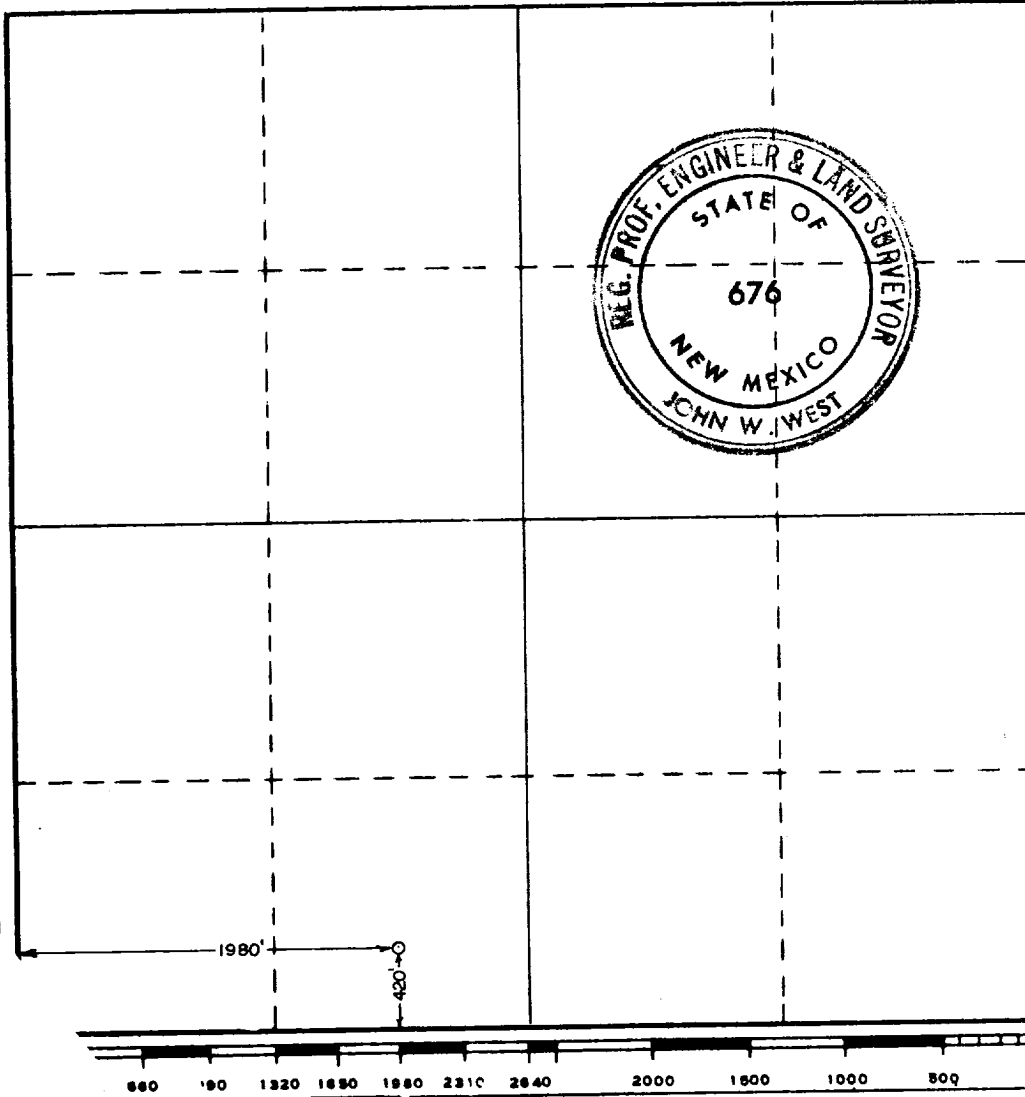

CERTIFICATION

I hereby certify that the information contained herein is true and complete to the best of my knowledge and belief.

Name *J. D. Dusen*
Staff Operations Engineer

Position
Shell Oil Company

Company
March 10, 1970

Date

I hereby certify that the well location shown on this plat was plotted from field notes of actual surveys made by me or under my supervision, and that the same is true and correct to the best of my knowledge and belief.

Date Surveyed
MARCH 6, 1970

Registered Professional Engineer and/or Land Surveyor

John W. West
Certificate No. **676**