

NO. OF COPIES RECEIVED	
DISTRIBUTION	
SANTA FE	
FILE	
U.S.G.S.	
LAND OFFICE	
OPERATOR	

# NEW MEXICO OIL CONSERVATION COMMISSION

Form C-103  
Supersedes Old  
C-102 and C-103  
Effective 1-1-65

5a. Indicate Type of Lease State <input checked="" type="checkbox"/> Fee <input type="checkbox"/>
5. State Oil & Gas Lease No. B-1520
7. Unit Agreement Name
8. Farm or Lease Name Bridges State
9. Well No. 147
10. Field and Pool, or Wildcat Undesignated
12. County Lea

## SUNDRY NOTICES AND REPORTS ON WELLS

(DO NOT USE THIS FORM FOR PROPOSALS TO DRILL OR TO DEEPEN OR PLUG BACK TO A DIFFERENT RESERVOIR.  
USE "APPLICATION FOR PERMIT - A" (FORM C-101) FOR SUCH PROPOSALS.)

1. OIL WELL <input checked="" type="checkbox"/> GAS WELL <input type="checkbox"/> OTHER <input type="checkbox"/>
2. Name of Operator Mobil Oil Corporation
3. Address of Operator P. O. Box 633, Midland, Texas 79701
4. Location of Well UNIT LETTER F 2180 FEET FROM THE North LINE AND 1880 FEET FROM THE West LINE, SECTION 13 TOWNSHIP 17-S RANGE 34-E N.M.P.M.
15. Elevation (Show whether DF, RT, GR, etc.) 4017 GL

16. Check Appropriate Box To Indicate Nature of Notice, Report or Other Data	
NOTICE OF INTENTION TO:	SUBSEQUENT REPORT OF:
PERFORM REMEDIAL WORK <input type="checkbox"/>	REMEDIAL WORK <input type="checkbox"/>
TEMPORARILY ABANDON <input type="checkbox"/>	COMMENCE DRILLING OPNS. <input type="checkbox"/>
PULL OR ALTER CASING <input type="checkbox"/>	CASING TEST AND CEMENT JOBS <input type="checkbox"/>
PLUG AND ABANDON <input type="checkbox"/>	ALTERING CASING <input type="checkbox"/>
CHANGE PLANS <input checked="" type="checkbox"/>	PLUG AND ABANDONMENT <input type="checkbox"/>
OTHER <input type="checkbox"/>	OTHER <input type="checkbox"/>

17. Describe Proposed or Completed Operations (Clearly state all pertinent details, and give pertinent dates, including estimated date of starting any proposed work) SEE RULE 1103.

See Form C-101 dated July 14, 1970 for casing, mud and logging programs. This well was drilled to Morrow formation, this pay was non-productive and permission is therefore requested to plug back and dually complete in Abo and Middle Penn formations.

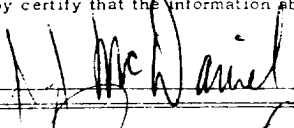
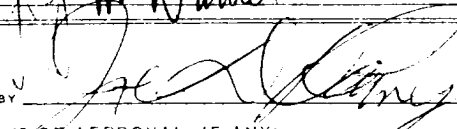
18. I hereby certify that the information above is true and complete to the best of my knowledge and belief.		
SIGNED 	TITLE Authorized Agent	DATE 10/30/70
APPROVED BY 	TITLE	DATE
CONDITIONS OF APPROVAL, IF ANY:		

NEW MEXICO OIL CONSERVATION COMMISSION  
WELL LOCATION AND ACREAGE DEDICATION PLAT

Form C-102  
Supersedes C-128  
Effective 1-1-65

All distances must be from the outer boundaries of the Section.

Operator <b>Mobil Oil Corporation</b>			Lessee <b>Bridges State</b>		Well No. <b>147</b>
Unit Letter <b>F</b>	Section <b>13</b>	Township <b>17 S</b>	Range <b>34 E</b>	County <b>Lea</b>	
Actual Postage Location of Well: <b>2180</b> feet from the <b>N</b> line and <b>1880</b> feet from the <b>W</b> line					
Ground Level Elev. <b>4017</b>	Producing Formation <b>Middle Penn.</b>		Pool <b>Undesignated</b>		Dedicated Acreage: <b>40</b> Acres

1. Outline the acreage dedicated to the subject well by colored pencil or hachure marks on the plat below.
2. If more than one lease is dedicated to the well, outline each and identify the ownership thereof (both as to working interest and royalty).
3. If more than one lease of different ownership is dedicated to the well, have the interests of all owners been consolidated by communitization, unitization, force-pooling, etc?

☐ Yes ☐ No If answer is "yes," type of consolidation \_\_\_\_\_

If answer is "no," list the owners and tract descriptions which have actually been consolidated. (Use reverse side of this form if necessary.) \_\_\_\_\_

No allowable will be assigned to the well until all interests have been consolidated (by communitization, unitization, forced-pooling, or otherwise) or until a non-standard unit, eliminating such interests, has been approved by the Commission.

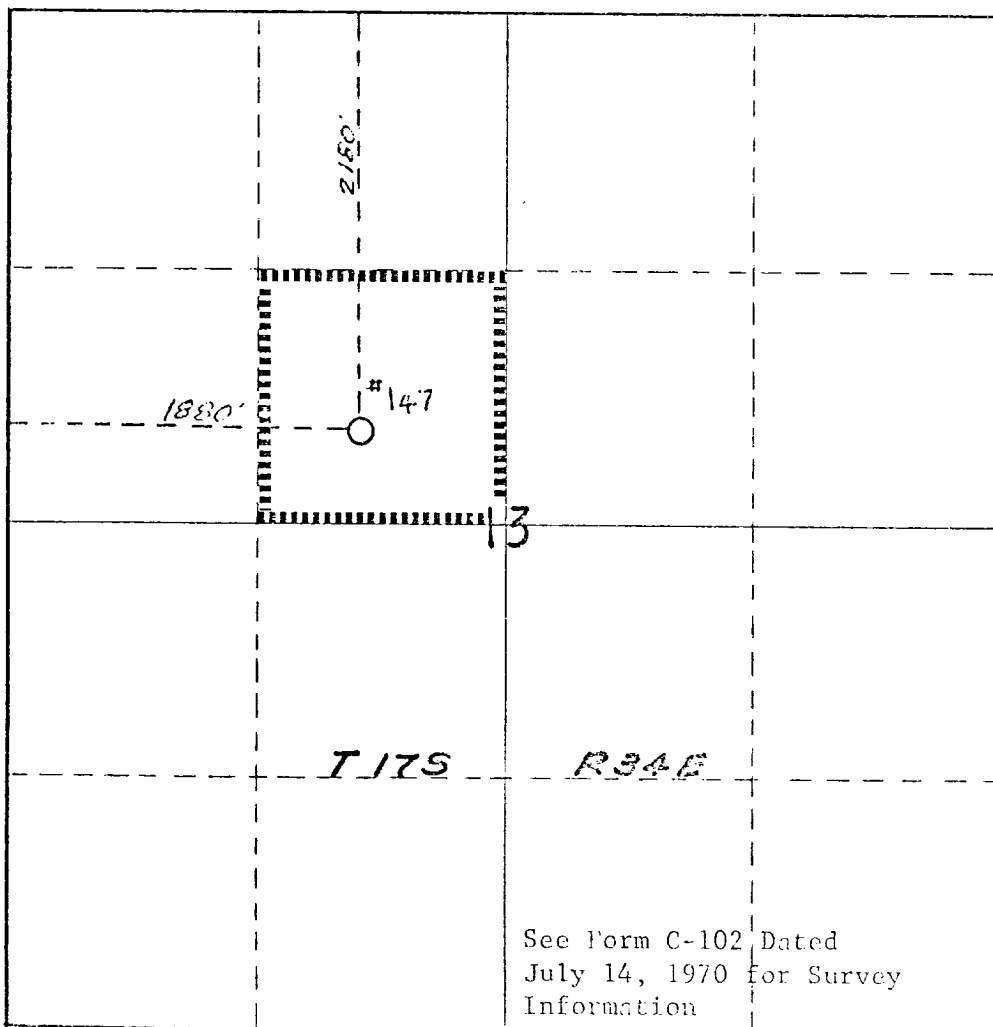

CERTIFICATION	
I hereby certify that the information contained herein is true and complete to the best of my knowledge and belief.	
<i>A. D. Bond</i>	
Name	A. D. Bond
Position	Proration Staff Assistant
Company	Mobil Oil Corporation
Date	October 26, 1970
I hereby certify that the well location shown on this plat was plotted from field notes of actual surveys made by me or under my supervision, and that the same is true and correct to the best of my knowledge and belief.	
Date Surveyed	
Registered Professional Engineer and/or Land Surveyor	
Certificate No.	

RECEIVED

OCT 20 1970

OIL CONSERVATION COMM.  
HOBBS, N. M.

NEW MEXICO OIL CONSERVATION COMMISSION  
WELL LOCATION AND ACREAGE DEDICATION PLAT

Form C-102  
Supersedes C-128  
Effective 1-1-65

All distances must be from the outer boundaries of the Section.

Operator <b>Mobil Oil Corporation</b>		Lease <b>Bridges State</b>		Well No. <b>147</b>
Unit Letter <b>F</b>	Section <b>13</b>	Township <b>17 S</b>	Range <b>34 E</b>	County <b>Lea</b>
Actual Footage Location of Well:				
<b>2180</b> feet from the <b>N</b> line and		<b>1880</b> feet from the <b>W</b> line		
Ground Level Elev. <b>4017</b>	Producing Formation <b>Abo</b>	Pool <b>Undesignated</b>	Dedicated Acreage: <b>80</b> Acres	

1. Outline the acreage dedicated to the subject well by colored pencil or hachure marks on the plat below.
2. If more than one lease is dedicated to the well, outline each and identify the ownership thereof (both as to working interest and royalty).
3. If more than one lease of different ownership is dedicated to the well, have the interests of all owners been consolidated by communitization, unitization, force-pooling, etc?

☐ Yes ☐ No If answer is "yes," type of consolidation \_\_\_\_\_

If answer is "no," list the owners and tract descriptions which have actually been consolidated. (Use reverse side of this form if necessary.) \_\_\_\_\_

No allowable will be assigned to the well until all interests have been consolidated (by communitization, unitization, forced-pooling, or otherwise) or until a non-standard unit, eliminating such interests, has been approved by the Commission.

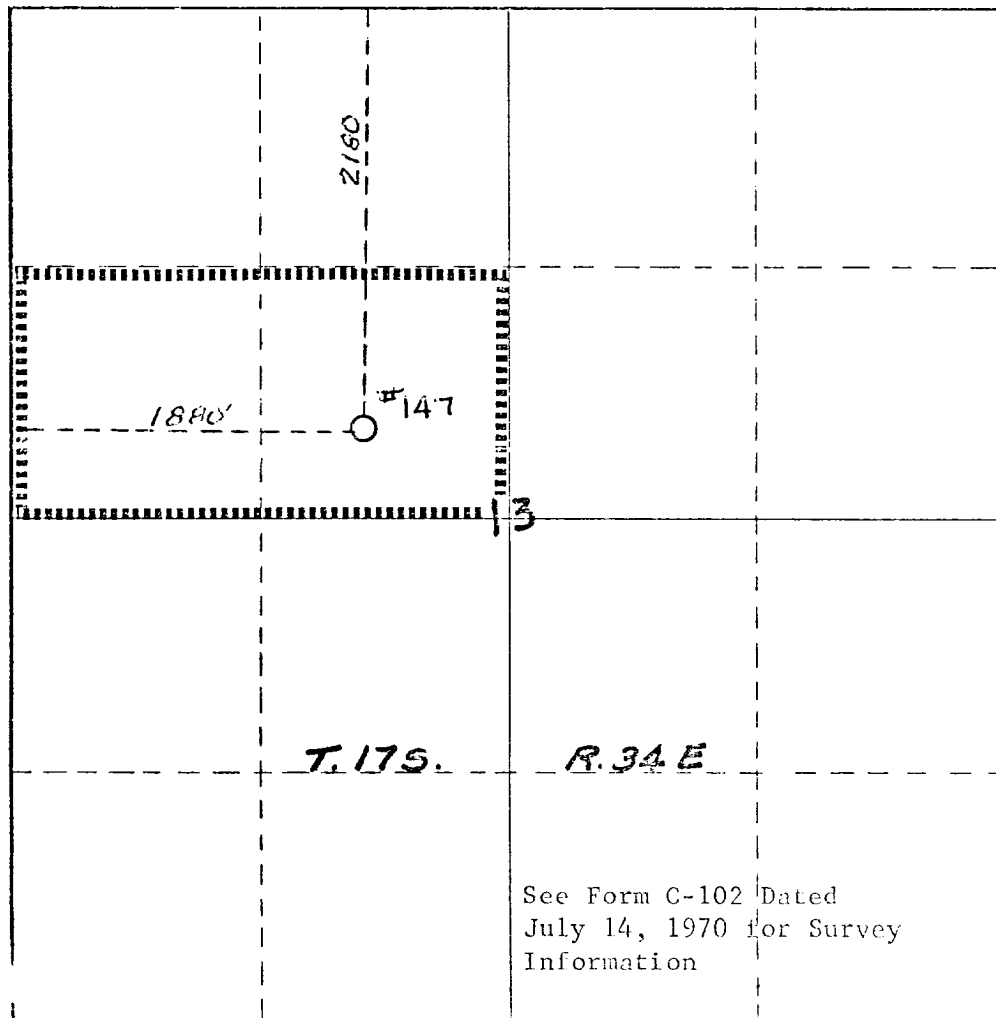

CERTIFICATION

I hereby certify that the information contained herein is true and complete to the best of my knowledge and belief.

*A. D. Bond*  
Name **A. D. Bond**

Position  
**Proration Staff Assistant**

Company  
**Mobil Oil Corporation**

Date  
**October 26, 1970**

I hereby certify that the well location shown on this plat was plotted from field notes of actual surveys made by me or under my supervision, and that the same is true and correct to the best of my knowledge and belief.

Date Surveyed

Registered Professional Engineer and/or Land Surveyor

Certificate No.

RECEIVED

OCT 28 1970

OIL CONSERVATION COMM.  
HOBBS, N. M.