

NO. OF COPIES RECEIVED		
DISTRIBUTION		
SANTA FE		
FILE		
U.S.G.S.		
LAND OFFICE		
OPERATOR		

NEW MEXICO OIL CONSERVATION COMMISSION

Form C-101
Revised 1-1-65

5A. Indicate Type of Lease
STATE <input checked="" type="checkbox"/> FEE <input type="checkbox"/>
5. State Oil & Gas Lease No.
B-1502

APPLICATION FOR PERMIT TO DRILL, DEEPEN, OR PLUG BACK

1a. Type of Work		7. Unit Agreement Name	
b. Type of Well		8. Farm or Lease Name	
DRILL <input checked="" type="checkbox"/> DEEPEN <input type="checkbox"/> PLUG BACK <input type="checkbox"/>		Santa Fe	
OIL WELL <input checked="" type="checkbox"/> GAS WELL <input type="checkbox"/> OTHER <input type="checkbox"/>		9. Well No.	
SINGLE ZONE <input checked="" type="checkbox"/> MULTIPLE ZONE <input type="checkbox"/>		118	
2. Name of Operator		10. Field and Pool, or Wildcat	
Phillips Petroleum Company		Vacuum Grayburg/San And	
3. Address of Operator		12. County	
Room B-2, Phillips Bldg., Odessa, Texas 79760		Lea	
4. Location of Well		19. Proposed Depth	
UNIT LETTER F LOCATED 1650 FEET FROM THE north LINE		4700	
AND 2310 FEET FROM THE west LINE OF SEC. 5 TWP. 18-S RGE. 35-E NMPM		19A. Formation	
		Grayburg/San Andres	
		20. Rotary or C.T.	
		Rotary	
21. Elevations (Show whether DF, RT, etc.)		21B. Drilling Contractor	
later		later	
21A. Kind & Status Plug. Bond		22. Approx. Date Work will start	
blanket		Upon approval	

23. PROPOSED CASING AND CEMENT PROGRAM

SIZE OF HOLE	SIZE OF CASING	WEIGHT PER FOOT	SETTING DEPTH	SACKS OF CEMENT	EST. TOP
12-1/4"	8-5/8"	20#	390'	(350sx Class H w/25 CaCl ₂) Circ.to	
				(w/1/4#Flocele 1st 150sx) surface	
7-7/8"	4-1/2"	11.6#	4700'	(150sx Class H w/40#DD & 125 sx Class H neat	Sufficient t
					cover all
					producing in-
					tervals.

Use Series 900 hydraulically operated BOP equipment.

This well is in the same proration unit as No. 45.

EXPIRES 5-8-71

IN ABOVE SPACE DESCRIBE PROPOSED PROGRAM: IF PROPOSAL IS TO DEEPEN OR PLUG BACK, GIVE DATA ON PRESENT PRODUCTIVE ZONE AND PROPOSED NEW PRODUCTIVE ZONE. GIVE BLOWOUT PREVENTER PROGRAM, IF ANY.

I hereby certify that the information above is true and complete to the best of my knowledge and belief.

Signed [Signature] J. J. Mueller Title Associate Reservoir Engineer Date 2-4-71

SUPERVISOR DISTRICT

APPROVED BY [Signature] TITLE DATE FEB 8 1971

CONDITIONS OF APPROVAL, IF ANY:

RECEIVED

FEB 6 1971

OIL CONSERVATION COM. AL.
HODES. AL. AL.

**NEW MEXICO OIL CONSERVATION COMMISSION
WELL LOCATION AND ACREAGE DEDICATION PLAT**

Form C-102
Supersedes C-128
Effective 1-1-65

All distances must be from the outer boundaries of the Section.

Operator Phillips Petroleum Company			Lease Santa Fe		Well No. 118
Unit Letter F	Section 5	Township 18-S	Range 35-E	County Lea	
Actual Footage Location of Well: 1650 feet from the north line and 2310 feet from the west line					
Ground Level Elev. later	Producing Formation Grayburg/San Andres		Pool Vacuum Grayburg/San Andres		Dedicated Acreage: 40 Acres

1. Outline the acreage dedicated to the subject well by colored pencil or hatchure marks on the plat below.
2. If more than one lease is dedicated to the well, outline each and identify the ownership thereof (both as to working interest and royalty).
3. If more than one lease of different ownership is dedicated to the well, have the interests of all owners been consolidated by communitization, unitization, force-pooling, etc?

☐ Yes ☐ No If answer is "yes," type of consolidation _____

If answer is "no," list the owners and tract descriptions which have actually been consolidated. (Use reverse side of this form if necessary.) _____

No allowable will be assigned to the well until all interests have been consolidated (by communitization, unitization, forced-pooling, or otherwise) or until a non-standard unit, eliminating such interests, has been approved by the Commission.

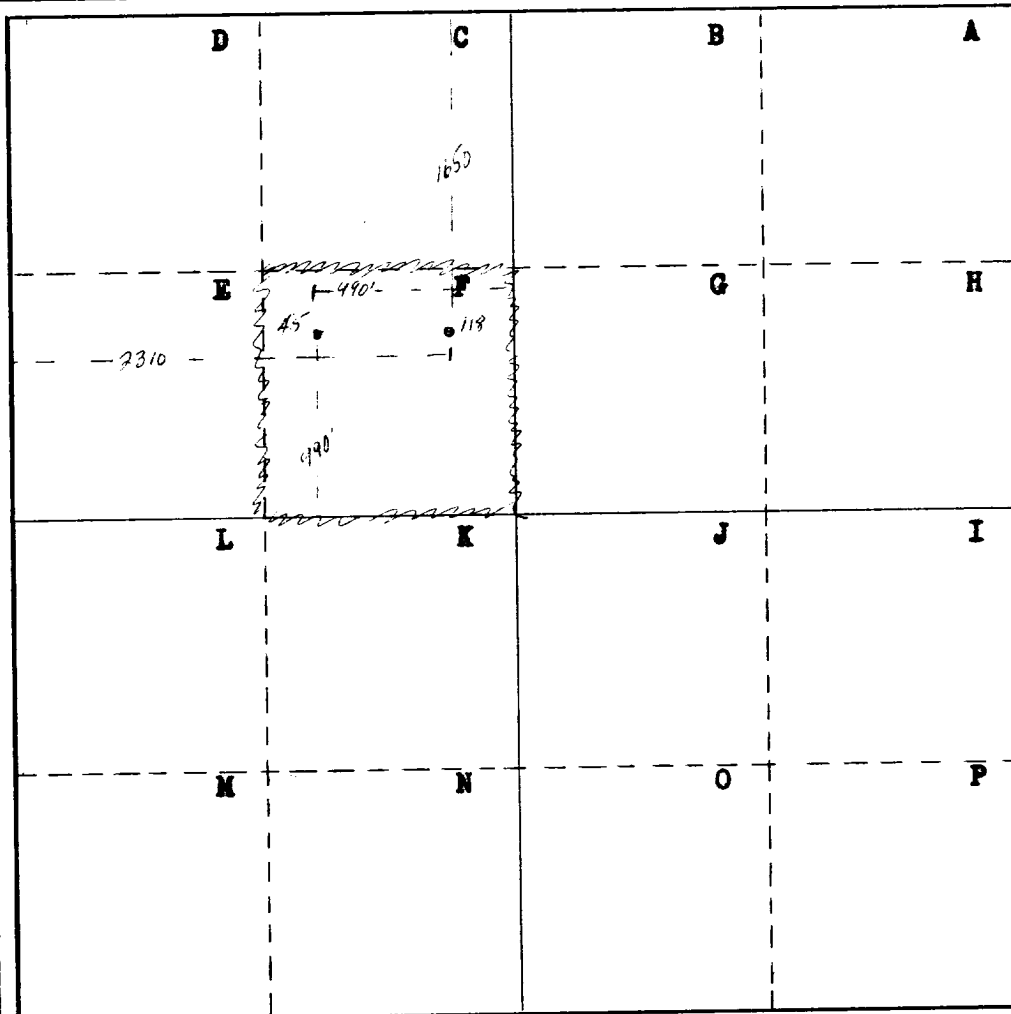

CERTIFICATION

I hereby certify that the information contained herein is true and complete to the best of my knowledge and belief.

Name W. J. Mueller

Position
Associate Reservoir Engr.

Company
Phillips Petroleum Company

Date
February 4, 1971

I hereby certify that the well location shown on this plat was plotted from field notes of actual surveys made by me or under my supervision, and that the same is true and correct to the best of my knowledge and belief.

Date Surveyed
February 3, 1971

Registered Professional Engineer and/or Land Surveyor
Roger L. Leffler
Roger Leffler

Certificate No.
4357

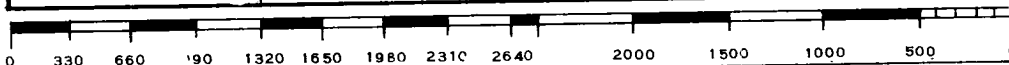

173

RECEIVED

FEB 6 1971

OIL CONSERVATION COM. AM.
HOUSTON, TEX.