

NO. OF COPIES RECEIVED	
DISTRIBUTION	
SANTA FE	
FILE	
U.S.G.S.	
LAND OFFICE	
OPERATOR	

NEW MEXICO OIL CONSERVATION COMMISSION

Form C-101  
Revised 1-1-65

5A. Indicate Type of Lease  
STATE  FEE

5. State Oil & Gas Lease No.

APPLICATION FOR PERMIT TO DRILL, DEEPEN, OR PLUG BACK

1a. Type of Work  
 b. Type of Well DRILL  DEEPEN  PLUG BACK   
 OIL WELL  GAS WELL  OTHER  SINGLE ZONE  MULTIPLE ZONE

2. Name of Operator  
**Gulf Oil Corporation**

3. Address of Operator  
**Box 670, Hobbs, New Mexico 88240**

4. Location of Well  
 UNIT LETTER **0** LOCATED **580** FEET FROM THE **South** LINE  
 AND **2310** FEET FROM THE **East** LINE OF SEC. **18** TWP. **18-S** RGE. **38-E** NMPM

7. Unit Agreement Name  
8. Farm or Lease Name **Dan W. Hardin**  
9. Well No. **9**  
10. Field and Pool, or Wildcat **Hobbs**

12. County **Lea**

19. Proposed Depth **4350'** 19A. Formation **Grayburg** 20. Rotary or C.T. **Rotary**

21. Elevations (Show whether DF, RT, etc.) 21A. Kind & Status Plug. Bond **Blanket** 21B. Drilling Contractor **To be furnished later** 22. Approx. Date Work will start **May 15, 1971**

23. PROPOSED CASING AND CEMENT PROGRAM

SIZE OF HOLE	SIZE OF CASING	WEIGHT PER FOOT	SETTING DEPTH	SACKS OF CEMENT	EST. TOP
11"	8-5/8"	21#	300'	Circulate	
7-7/8"	5-1/2"	15.5#	4,350'	Base of Salt	

8 5/4

8-10-71

IN ABOVE SPACE DESCRIBE PROPOSED PROGRAM; IF PROPOSAL IS TO DEEPEN OR PLUG BACK, GIVE DATA ON PRESENT PRODUCTIVE ZONE AND PROPOSED NEW PRODUCTIVE ZONE, GIVE BLOWOUT PREVENTER PROGRAM, IF ANY.

I hereby certify that the information above is true and complete to the best of my knowledge and belief.  
 ORIGINAL SIGNED BY **C. F. KALTEYER** Title **Area Petroleum Engineer** Date **May 7, 1971**

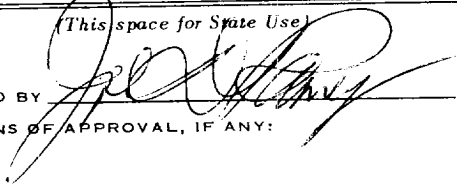
(This space for State Use)  
 APPROVED BY  TITLE **SUPERVISOR DISTRICT** DATE **MAY 10 1971**  
 CONDITIONS OF APPROVAL, IF ANY:

RECEIVED

U.S. DEPARTMENT OF  
ENERGY

MAY 5 1971

OIL CONSERVATION COMM.  
HOBBS, N. M.

**NEW MEXICO OIL CONSERVATION COMMISSION  
WELL LOCATION AND ACREAGE DEDICATION PLAT**

Form C-102  
Supersedes C-128  
Effective 1-1-65

All distances must be from the outer boundaries of the Section

Operator <b>GULF OIL CORPORATION</b>			Lease <b>DAN W. HARDIN</b>		Well No. <b>9</b>
Unit Letter <b>0</b>	Section <b>18</b>	Township <b>18 SOUTH</b>	Range <b>38 EAST</b>	County <b>LEA</b>	
Actual Footage Location of Well: <b>580</b> feet from the <b>SOUTH</b> line and <b>2310'</b> feet from the <b>EAST</b> line					
Ground Level Elev.	Producing Formation <b>Grayburg</b>		Pool <b>Hobbs</b>	Dedicated Acreage: <b>40</b> Acres	

1. Outline the acreage dedicated to the subject well by colored pencil or hachure marks on the plat below.
2. If more than one lease is dedicated to the well, outline each and identify the ownership thereof (both as to working interest and royalty).
3. If more than one lease of different ownership is dedicated to the well, have the interests of all owners been consolidated by communitization, unitization, force-pooling, etc?

Yes     No    If answer is "yes," type of consolidation \_\_\_\_\_

If answer is "no," list the owners and tract descriptions which have actually been consolidated. (Use reverse side of this form if necessary.) \_\_\_\_\_

No allowable will be assigned to the well until all interests have been consolidated (by communitization, unitization, forced-pooling, or otherwise) or until a non-standard unit, eliminating such interests, has been approved by the Commission.

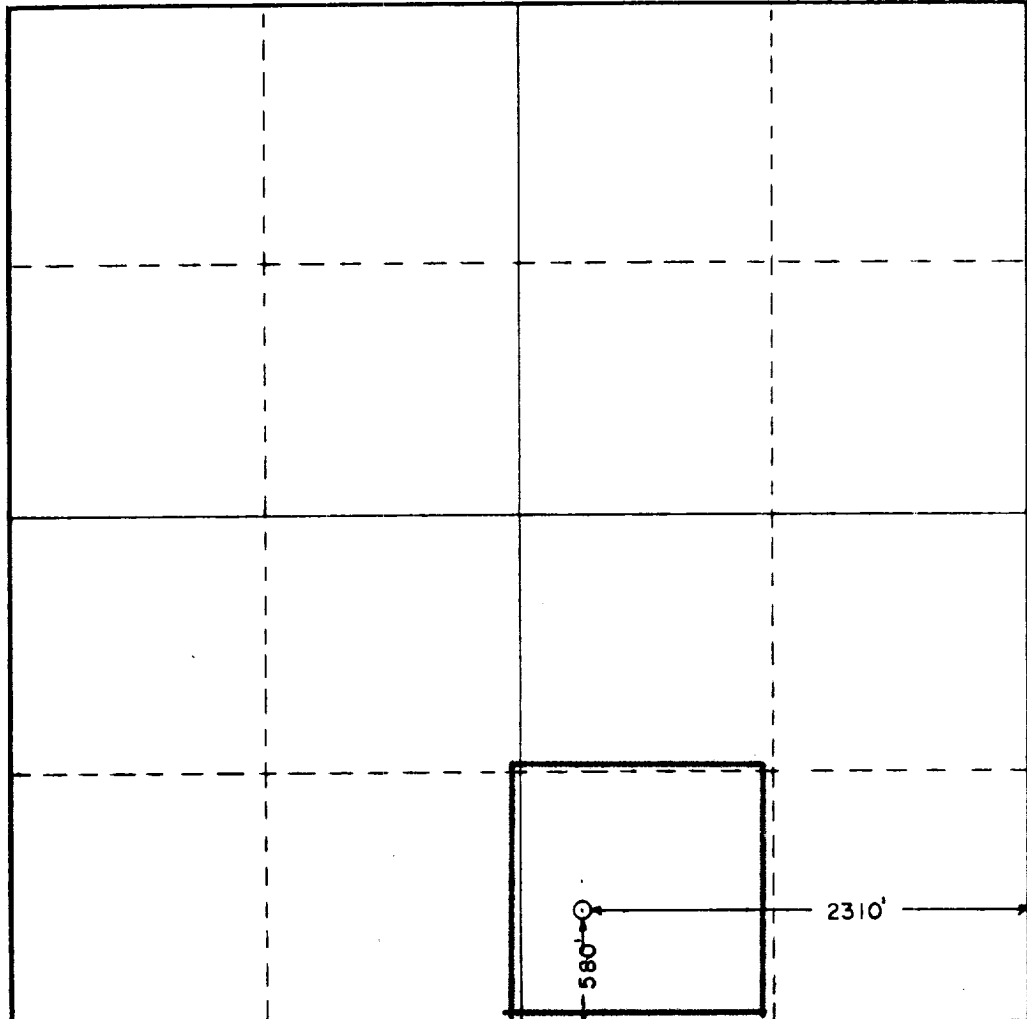

**CERTIFICATION**

*I hereby certify that the information contained herein is true and complete to the best of my knowledge and belief.*

**ORIGINAL SIGNED BY  
C. F. KALTEYER**

Name  
**C. F. KALTEYER**

Position  
**Area Petroleum Engineer**

Company  
**Gulf Oil Corporation**

Date  
**May 7, 1971**

*I hereby certify that the well location shown on this plat was plotted from field notes of actual surveys made by me or under my supervision, and that the same is true and correct to the best of my knowledge and belief.*

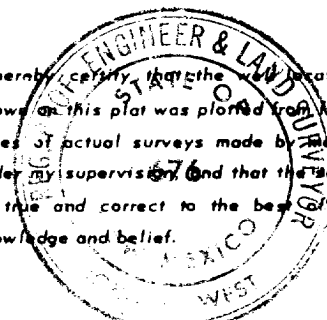

Date Surveyed  
**May 5, 1971**

Registered Professional Engineer  
and/or Land Surveyor

*John W. West*

Certificate No. **676**



JTG

RECEIVED

MAY - 7 1971

OIL CONSERVATION COMM.  
HOBBS, N. M.

*9/28/80  
Camm + Bond T*