

NO. OF COPIES RECEIVED	
DISTRIBUTION	
SANTA FE	
FILE	
U.S.G.S.	
LAND OFFICE	
OPERATOR	

NEW MEXICO OIL CONSERVATION COMMISSION

Form C-101
Revised 1-1-65

5A. Indicate Type of Lease
STATE <input checked="" type="checkbox"/> FEE <input type="checkbox"/>

5. State Oil & Gas Lease No.
E 1774-2

APPLICATION FOR PERMIT TO DRILL, DEEPEN, OR PLUG BACK

1a. Type of Work		7. Unit Agreement Name	
b. Type of Well OIL WELL <input checked="" type="checkbox"/> GAS WELL <input type="checkbox"/> OTHER <input type="checkbox"/>		8. Farm or Lease Name Miller State "B" <i>Del</i>	
2. Name of Operator Koch Exploration Company		9. Well No. 2	
3. Address of Operator P. O. Box 2256, Wichita, Kansas 67201		10. Field and Pool, or Wildcat Undesignated	
4. Location of Well UNIT LETTER <u>N</u> LOCATED <u>660</u> FEET FROM THE <u>south</u> LINE AND <u>2105</u> FEET FROM THE <u>west</u> LINE OF SEC. <u>3</u> TWP. <u>17S</u> RGE. <u>34E</u> NMPM		12. County Lea	
19. Proposed Depth 8900		19A. Formation Abo	
20. Rotary or C.T. rotary		21. Elevations (Show whether DF, RT, etc.) 4064 GL	
21A. Kind & Status Plug. Bond blanket		21B. Drilling Contractor Moran Oil Producing & Drilling Corp.	
22. Approx. Date Work will start July 20, 1972			

23.

PROPOSED CASING AND CEMENT PROGRAM

SIZE OF HOLE	SIZE OF CASING	WEIGHT PER FOOT	SETTING DEPTH	SACKS OF CEMENT	EST. TOP
17 1/2	13-3/8	48#	350	350	circulate
11	8-5/8	24# & 32#	3100	500	1500
7-7/8	5 1/2	17# & 15.5#	8900	250	7650*

*A DV tool will also be set at the base of the San Andres and cement will be placed over this horizon.

APPROVED FOR
FOR THE STATE OF NEW MEXICO
DRILLING COMMISSION

EXPIRES 10-24-78

IN ABOVE SPACE DESCRIBE PROPOSED PROGRAM; IF PROPOSAL IS TO DEEPEN OR PLUG BACK, GIVE DATA ON PRESENT PRODUCTIVE ZONE AND PROPOSED NEW PRODUCTIVE ZONE. GIVE BLOWOUT PREVENTER PROGRAM, IF ANY.

I hereby certify that the information above is true and complete to the best of my knowledge and belief.

Signed [Signature] Title Vice Pres. - Production Date July 14, 1972

(This space for State Use)

APPROVED BY [Signature] TITLE SUPERVISOR DISTRICT I DATE JUL 24 1972

CONDITIONS OF APPROVAL, IF ANY:

RECEIVED

JUL 17 1972

OIL CONSERVATION COM.
R.D. 1

**NEW MEXICO OIL CONSERVATION COMMISSION
WELL LOCATION AND ACREAGE DEDICATION PLAT**

Form C-102
Supersedes C-128
Effective 1-1-65

All distances must be from the outer boundaries of the Section.

Operator KOCH EXPLORATION COMPANY			Lease MILLER STATE "B" State		Well No. 2
Unit Letter N	Section 3	Township 17 SOUTH	Range 34 EAST	County LEA	
Actual Footage Location of Well:					
660 feet from the SOUTH line and		2105 feet from the WEST line			
Ground Level Elev. 4063.9	Producing Formation Abo	Pool Undesignated	Dedicated Acreage: 80 Acres		

1. Outline the acreage dedicated to the subject well by colored pencil or hachure marks on the plat below.
2. If more than one lease is dedicated to the well, outline each and identify the ownership thereof (both as to working interest and royalty).
3. If more than one lease of different ownership is dedicated to the well, have the interests of all owners been consolidated by communitization, unitization, force-pooling, etc?

☐ Yes ☐ No If answer is "yes," type of consolidation _____

If answer is "no," list the owners and tract descriptions which have actually been consolidated. (Use reverse side of this form if necessary.) _____

No allowable will be assigned to the well until all interests have been consolidated (by communitization, unitization, forced-pooling, or otherwise) or until a non-standard unit, eliminating such interests, has been approved by the Commission.

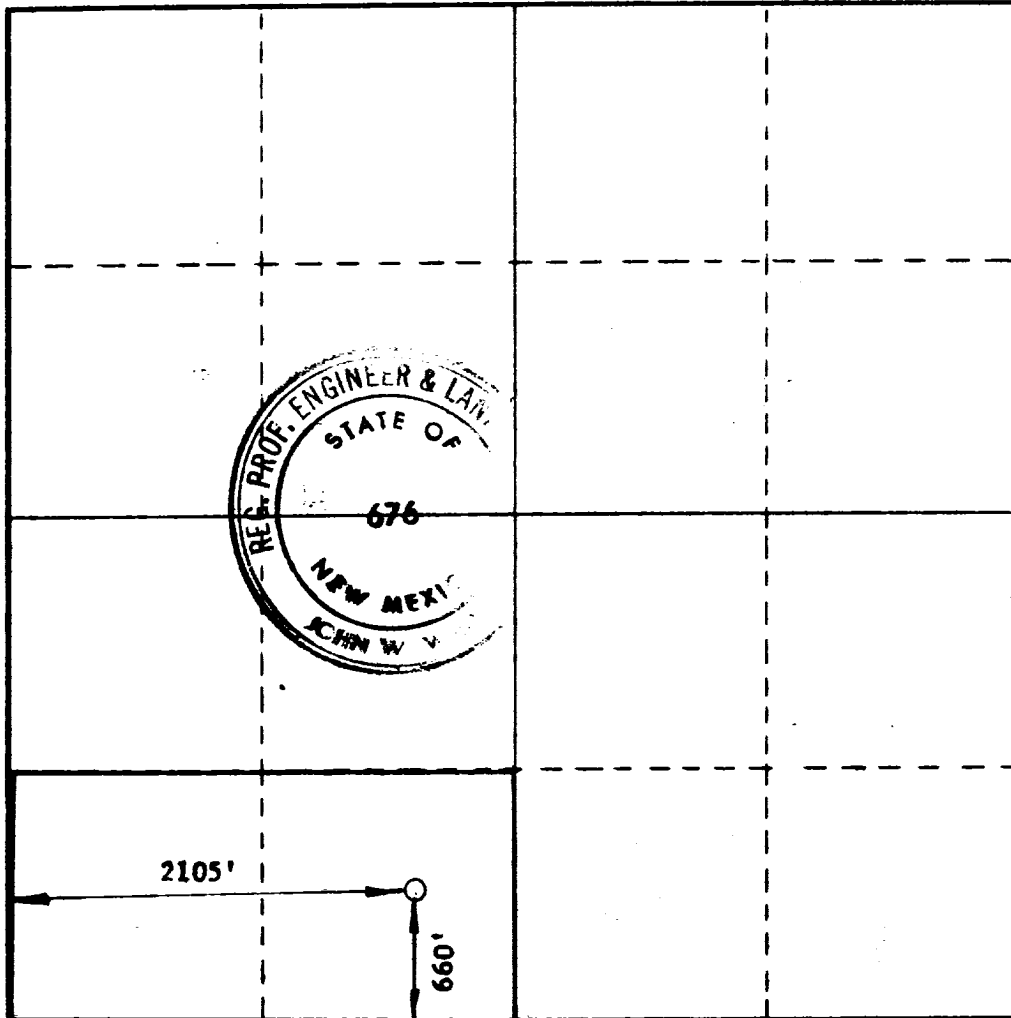

CERTIFICATION

I hereby certify that the information contained herein is true and complete to the best of my knowledge and belief.

Name _____
 Position **Vice Pres. - Production**
 Company **Koch Exploration Company**
 Date **June 14, 1972**

I hereby certify that the well location shown on this plat was plotted from field notes of actual surveys made by me or under my supervision, and that the same is true and correct to the best of my knowledge and belief.

Date Surveyed **JULY 12, 1972**
 Registered Professional Engineer and/or Land Surveyor

 Certificate No. **676**

173

RECEIVED

JUL 21 1972

D.L. CONSERVATION COMM.
HOBBS, N. M.

RECEIVED

JUL 17 1972

D.L. CONSERVATION COMM.
HOBBS, N. M.