

NO. OF COPIES RECEIVED	
DISTRIBUTION	
SANTA FE	
FILE	
U.S.G.S.	
LAND OFFICE	
OPERATOR	

NEW MEXICO OIL CONSERVATION COMMISSION

Form C-101
Revised 1-1-65

5A. Indicate Type of Lease STATE <input checked="" type="checkbox"/> FEE <input type="checkbox"/>
5. State Oil & Gas Lease No. B-1306-1
7. Unit Agreement Name
8. Farm or Lease Name New Mexico "R" State NCT-3
9. Well No. 18
10. Field and Pool, or Wildcat Vacuum (Grayburg SA)
12. County Lea
19. Proposed Depth 4710'
19A. Formation Grayburg SA
20. Rotary or C.T. Rotary
21. Elevations (Show whether DF, RT, etc.) GR 3999'
21A. Kind & Status Plug. Bond \$10,000 Blanket
21B. Drilling Contractor Unknown
22. Approx. Date Work will start At Once

APPLICATION FOR PERMIT TO DRILL, DEEPEN, OR PLUG BACK	
1a. Type of Work b. Type of Well DRILL <input checked="" type="checkbox"/> DEEPEN <input type="checkbox"/> PLUG BACK <input type="checkbox"/> OIL WELL <input checked="" type="checkbox"/> GAS WELL <input type="checkbox"/> OTHER <input type="checkbox"/> SINGLE ZONE <input checked="" type="checkbox"/> MULTIPLE ZONE <input type="checkbox"/>	
2. Name of Operator TEXACO INC. % DARRELL SMITH	
3. Address of Operator P.O. BOX 3109, MIDLAND, TEXAS 79701	
4. Location of Well UNIT LETTER L LOCATED 30' FEET FROM THE West LINE AND 2630' FEET FROM THE south LINE OF SEC. 1 TWP. 18S RGE. 34E NMPM	
23.	

PROPOSED CASING AND CEMENT PROGRAM

SIZE OF HOLE	SIZE OF CASING	WEIGHT PER FOOT	SETTING DEPTH	SACKS OF CEMENT	EST. TOP
11"	8 5/8"	20#	350'	* 210 sx	300% to circulate
7 7/8"	5 1/2"	14#	4710'	** 500 sx	200% to bring cmt. top to 2000'

* 210 sx Class C + 2% CaCl, 14.8 PPG (Cement must circulate) 300% to circulate.

** 300 sx Class C + 12% Gel, 12.38 PPG followed by 200 sx Class C 14.8 PPG - 200% to bring cement top to 2000'

FORMATION TOPS

Grayburg 4230'
San Andres 4430'
TOTAL DEPTH 4710'

APPROVAL VALID
FOR 90 DAYS UNLESS
DRILLING COMMENCED,

EXPIRES 3-26-73

(This well is being drilled under authority granted by N.M.O.C.C. Order No. R-4442 dated 11/27/72)

IN ABOVE SPACE DESCRIBE PROPOSED PROGRAM: IF PROPOSAL IS TO DEEPEN OR PLUG BACK, GIVE DATA ON PRESENT PRODUCTIVE ZONE AND PROPOSED NEW PRODUCTION ZONE. GIVE BLOWOUT PREVENTER PROGRAM, IF ANY.

hereby certify that the information above is true and complete to the best of my knowledge and belief.

Signed J. J. Veiten Title Division Civil Engineer Date 12/12/72

(This space for State Use)

SUPERVISOR DISTRICT I

APPROVED BY [Signature] TITLE DATE DEC 26 1972

CONDITIONS OF APPROVAL, IF ANY:

Form C-102
Supersedes C-128
Effective 1-1-65

Operator TEXACO Inc.		Lease New Mexico "R" State NCT-3		Well No. 18
Unit Letter L	Section 1	Township 18 South	Range 34 East	County Lea
Actual Footage Location of Well: 2630 feet from the South line and 30 feet from the West line Sec. 1				
Ground Lvel Elev. 3999	Producing Formation Vacuum (Grayburg SA)	Pool Grayburg San Andres		Dedicated Acreage: 40 Acres

- * See note on Form C-101

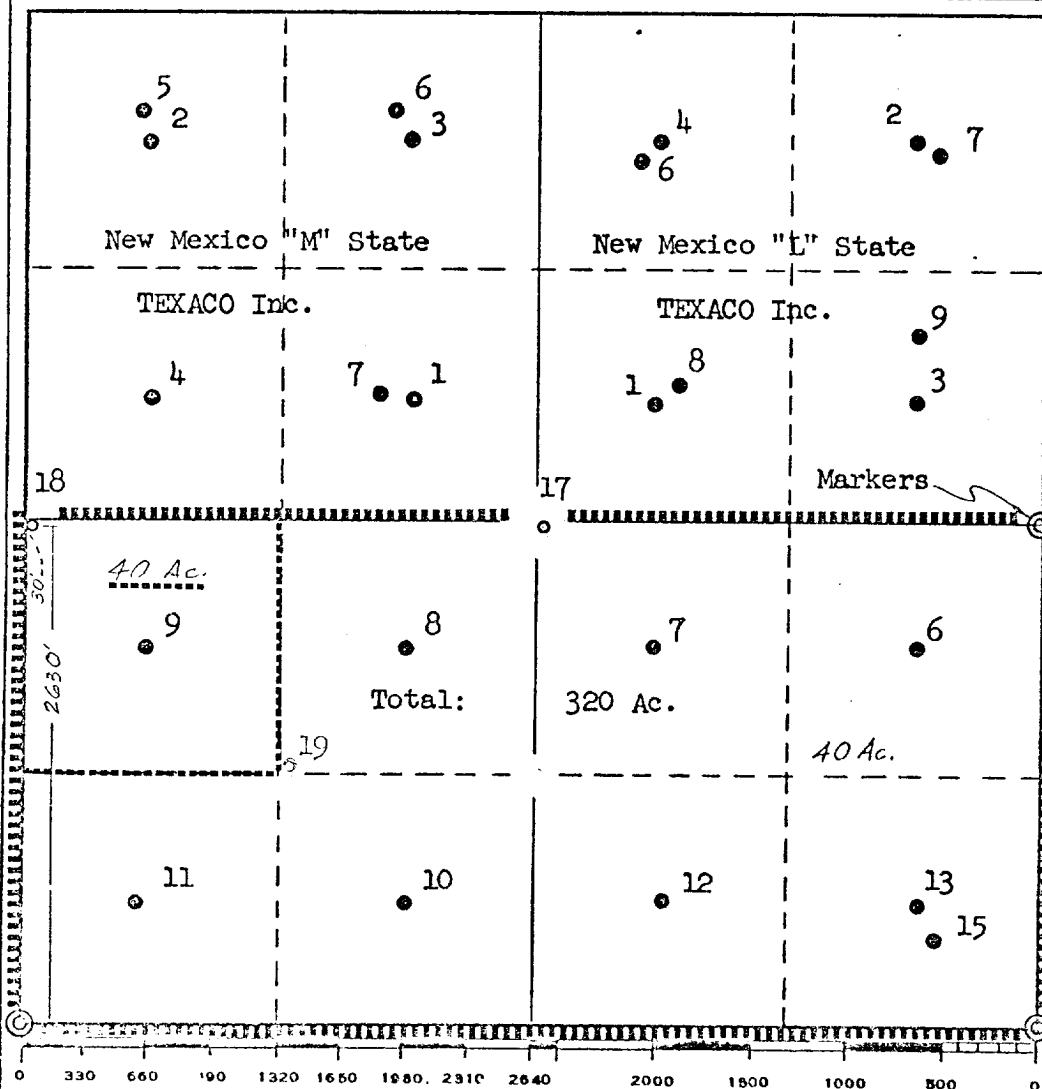

Certificate No. 8174

173