

NO. OF COPIES RECEIVED	
DISTRIBUTION	
SANTA FE	
FILE	
U.S.G.S.	
LAND OFFICE	
OPERATOR	

NEW MEXICO OIL CONSERVATION COMMISSION

Form C-101
Revised 1-1-65

5A. Indicate Type of Lease	
STATE <input checked="" type="checkbox"/>	FEE <input type="checkbox"/>
5. State Oil & Gas Lease No.	
B-1306-1	
7. Unit Agreement Name	
8. Farm or Lease Name New Mexico	
"R" State NCT-3	
9. Well No.	
22	
10. Field and Pool, or Wildcat	
Vacuum (Grayburg SA)	
12. County	
Lea	
19. Proposed Depth	19A. Formation
4710'	Grayburg SA
20. Rotary or C.T.	
	Rotary
21. Elevations (Show whether DF, RT, etc.)	21A. Kind & Status Plug, Bond
GR 3999'	\$10,000 Blanket
21B. Drilling Contractor	22. Approx. Date Work will start
Unknown	At Once

APPLICATION FOR PERMIT TO DRILL, DEEPEN, OR PLUG BACK

1a. Type of Work	
b. Type of Well	
DRILL <input checked="" type="checkbox"/>	DEEPEN <input type="checkbox"/>
OIL WELL <input checked="" type="checkbox"/>	GAS WELL <input type="checkbox"/>
OTHER <input type="checkbox"/>	
SINGLE ZONE <input checked="" type="checkbox"/>	
MULTIPLE ZONE <input type="checkbox"/>	
2. Name of Operator	
TEXACO INC. % DARRELL SMITH	
3. Address of Operator	
P.O. BOX 3109, MIDLAND, TEXAS 79701	
4. Location of Well	
UNIT LETTER M	LOCATED 220
FEET FROM THE South LINE	
AND 100'	FEET FROM THE West
LINE OF SEC. 1 TWP. 18S RGE. 34E NMPM	
19. Proposed Depth	
4710'	
19A. Formation	
Grayburg SA	
20. Rotary or C.T.	
Rotary	
21. Elevations (Show whether DF, RT, etc.)	
GR 3999'	
21A. Kind & Status Plug, Bond	
\$10,000 Blanket	
21B. Drilling Contractor	
Unknown	
22. Approx. Date Work will start	
At Once	

PROPOSED CASING AND CEMENT PROGRAM

SIZE OF HOLE	SIZE OF CASING	WEIGHT PER FOOT	SETTING DEPTH	SACKS OF CEMENT	EST. TOP
11"	8 5/8"	20#	350'	* 210	300% to circulate
7 7/8"	5 1/2"	14#	4710'	** 500	200% to bring cmt. top to 2000'

* 210 sx Class C + 2% CaCl, 14.8 PPG (Cement must circulate) 300% to circulate

** 300 sx Class C + 12% Gel, 12.38 PPG followed by 200 sx Class C 14.8 PPG - 200 % to bring cement top to 2000'

FORMATION TOPS

Grayburg 4110'
San Andres 4510'
TOTAL DEPTH 4710'

APPROVAL VALID
FOR 90 DAYS UNLESS
DRILLING COMMENCED,

EXPIRES 3-26-73

(This well is being drilled under authority granted by N.M.O.C.C. Order No. R-4442 dated 11/27/72)

IN ABOVE SPACE DESCRIBE PROPOSED PROGRAM: IF PROPOSAL IS TO DEEPEN OR PLUG BACK, GIVE DATA ON PRESENT PRODUCTIVE ZONE AND PROPOSED NEW PRODUCTIVE ZONE. GIVE BLOWOUT PREVENTER PROGRAM, IF ANY.

I hereby certify that the information above is true and complete to the best of my knowledge and belief.

Signed J. J. Velten Title Division Civil Engineer Date 12/12/72

(This space for State Use)

APPROVED BY [Signature] TITLE SUPERVISOR DISTRICT I DATE DEC 26 1972

CONDITIONS OF APPROVAL, IF ANY

**NEW MEXICO OIL CONSERVATION COMMISSION
WELL LOCATION AND ACREAGE DEDICATION PLAT**

Form C-102
Supersedes C-128
Effective 1-1-65

All distances must be from the outer boundaries of the Section.

Operator TEXACO Inc.			Lease New Mexico "R" State NCT-3		Well No. 22
Unit Letter M	Section 1	Township 18 South	Range 34 East	County Lea	
Actual Footage Location of Well: 220 feet from the South line and 100 feet from the West line Sec. 1					
Ground Level Elev. 3999	Producing Formation Vacuum (Grayburg SA)		Pool Grayburg San Andres		Dedicated Acreage: * 40 Acres

1. Outline the acreage dedicated to the subject well by colored pencil or hachure marks on the plat below.
2. If more than one lease is dedicated to the well, outline each and identify the ownership thereof (both as to working interest and royalty).
3. If more than one lease of different ownership is dedicated to the well, have the interests of all owners been consolidated by communitization, unitization, force-pooling, etc?

☐ Yes ☐ No If answer is "yes," type of consolidation _____

If answer is "no," list the owners and tract descriptions which have actually been consolidated. (Use reverse side of this form if necessary.) _____

No allowable will be assigned to the well until all interests have been consolidated (by communitization, unitization, forced-pooling, or otherwise) or until a non-standard unit, eliminating such interests, has been approved by the Commission.
* See note on Form C-101

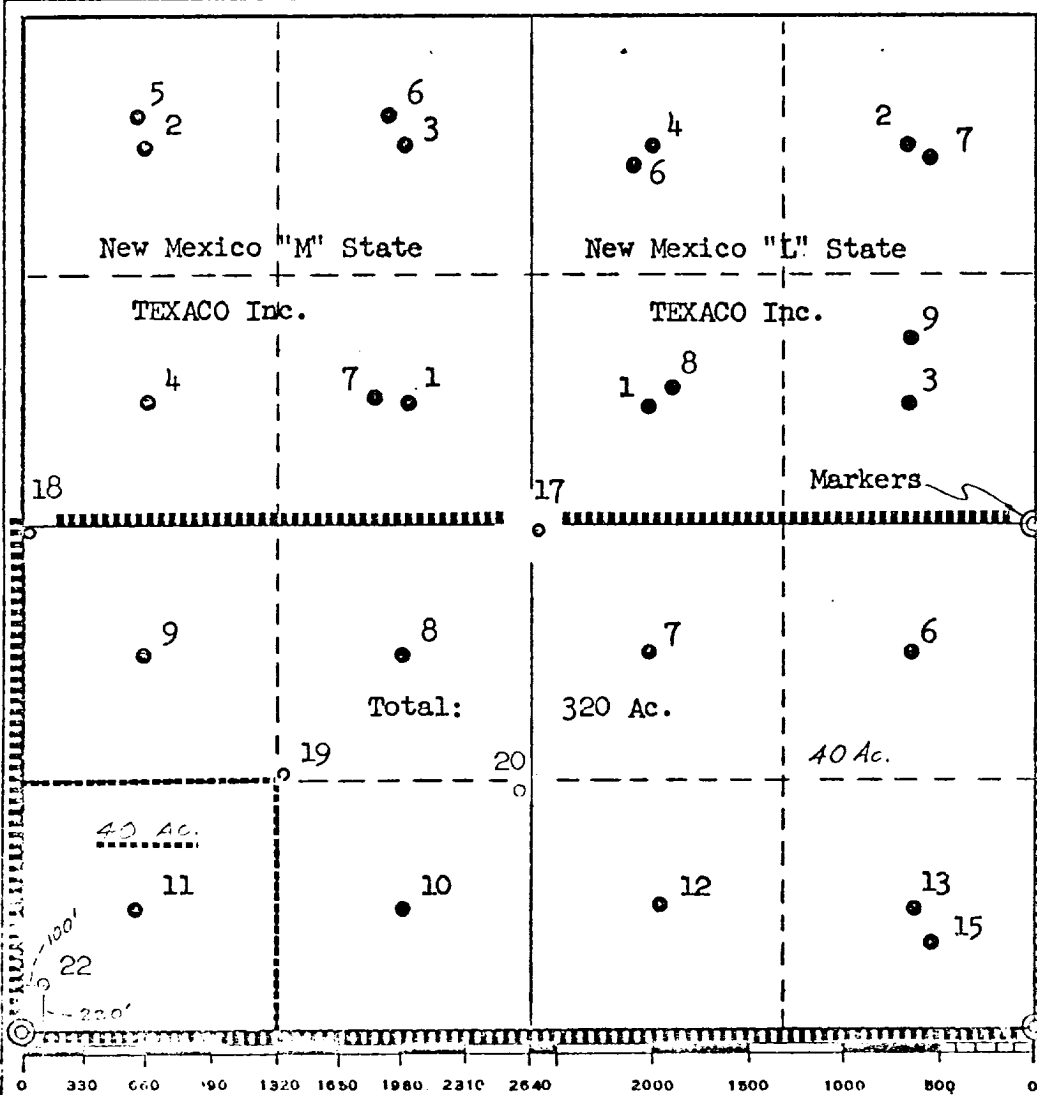

CERTIFICATION

I hereby certify that the information contained herein is true and complete to the best of my knowledge and belief.

Name **J. J. Velten**

Position
Division Civil Engineer

Company
TEXACO Inc.

Date
12/12/72

I hereby certify that the well location shown on this plat was plotted from field notes of actual surveys made by me or under my supervision, and that the same is true and correct to the best of my knowledge and belief.

Date Surveyed
12/7/72

Registered Professional Engineer
and/or Land Surveyor

J. J. Velten

Certificate No.
8174