

UNITED STATES  
DEPARTMENT OF THE INTERIOR  
GEOLOGICAL SURVEYSUBMIT IN TRIPLICATE  
(Other instructions on  
reverse side)Form approved.  
Budget Bureau No. 42-R1424.5. LEASE DESIGNATION AND SERIAL NO.  
**NM-0392867**

6. IF INDIAN, ALLOTTEE OR TRIBE NAME

7. UNIT AGREEMENT NAME

8. FARM OR LEASE NAME

**Cinco de Mayo Federal**

9. WELL NO.

**3**10. FIELD AND POOL, OR WILDCAT  
**Shinnery Queen**11. SEC., T., R., M., OR BLK. AND  
SURVEY OR AREA**Sec. 24, T-18-S, R-32-E**

12. COUNTY OR PARISH

**Lea**

13. STATE

**N. M.**

## SUNDRY NOTICES AND REPORTS ON WELLS

(Do not use this form for proposals to drill or to deepen or plug back to a different reservoir.  
Use "APPLICATION FOR PERMIT—" for such proposals.)

1. OIL WELL <input checked="" type="checkbox"/> GAS WELL <input type="checkbox"/> OTHER <input type="checkbox"/>	2. NAME OF OPERATOR <b>Burleson &amp; Huff</b>
3. ADDRESS OF OPERATOR <b>P. O. Box 935, Midland, Texas 79701</b>	4. LOCATION OF WELL (Report location clearly and in accordance with any State requirements.* See also space 17 below.) At surface <b>990' from the North and 990' from the West of lines of Section 24, T-18-S, R-32-E</b>
14. PERMIT NO.	15. ELEVATIONS (Show whether DF, RT, GR, etc.) <b>3797.6GR</b>

16. Check Appropriate Box To Indicate Nature of Notice, Report, or Other Data

## NOTICE OF INTENTION TO:

TEST WATER SHUT-OFF ☐FRACTURE TREAT ☐SHOOT OR ACIDIZE ☐REPAIR WELL ☐

(Other)

PULL OR ALTER CASING ☐MULTIPLE COMPLETE ☐ABANDON\* ☐CHANGE PLANS ☒

## SUBSEQUENT REPORT OF:

WATER SHUT-OFF ☐FRACTURE TREATMENT ☐SHOOTING OR ACIDIZING ☐

(Other)

REPAIRING WELL ☐ALTERING CASING ☐ABANDONMENT\* ☐(NOTE: Report results of multiple completion on Well  
Completion or Recompletion Report and Log form.)

17. DESCRIBE PROPOSED OR COMPLETED OPERATIONS (Clearly state all pertinent details, and give pertinent dates, including estimated date of starting any proposed work. If well is directionally drilled, give subsurface locations and measured and true vertical depths for all markers and zones pertinent to this work.)\*

Change plans and move location to 990' from the North and West lines of Section 24 from our previous designated plat which was 660' from the North and West lines. Plan to drill this well with cable tools instead of rotary and the pipe program will be altered from the original form as follows: Surface pipe will remain the same. Mud string will be set approximately 600 to 800' with 8-5/8" casing if we encounter water and below this the same pipe program for the 4-1/2" will be in effect with sufficient cement to come to the base of the salt.

A drilling head will be placed on the well from the Base of the Salt to T.D. to prevent blow-outs, with oil saver to control any fluid. A preventor will be placed on the well when the oil string is run to control any possible blow out while pipe is being run.

18. I hereby certify that the foregoing is true and correct

SIGNED

TITLE

**Partner**

DATE

**7-26-74**

(This space for Federal or State office use)

APPROVED BY

TITLE

CONDITIONS OF APPROVAL, IF ANY:

\*See Instructions on Reverse Side

## Instructions

**General:** This form is designed for submitting proposals to perform certain well operations, and reports of such operations when completed, as indicated, on Federal and Indian lands pursuant to applicable Federal law and regulations, and, if approved or accepted by any State, on all lands in such State, pursuant to applicable State law and regulations. Any necessary special instructions concerning the use of this form and the number of copies to be submitted, particularly with regard to local, area, or regional procedures and practices, either are shown below or will be issued by, or may be obtained from, the local Federal and/or State office.

**Item 4:** If there are no applicable State requirements, locations on Federal or Indian land should be described in accordance with Federal requirements. Consult local State or Federal office for specific instructions.

**Item 17:** Proposals to abandon a well and subsequent reports of abandonment should include such special information as is required by local Federal and/or State offices. In addition, such proposals and reports should include reasons for the abandonment; data on any former or present productive zones, or other zones with present significant fluid contents not sealed off by cement or otherwise; depths (top and bottom) and method of placement of cement plugs; mud or other material placed below, between and above plugs; amount, size, method of parting of any casing, liner or tubing pulled and the depth to top of any left in the hole; method of closing top of well; and date well site conditioned for final inspection looking to approval of the abandonment.

NEW MEXICO OIL CONSERVATION COMMISSION  
WELL LOCATION AND ACREAGE DEDICATION PL

Form C-102  
Supersedes C-128  
Effective 1-1-65

All distances must be from the outer boundaries of the Section

Operator <b>Burleson &amp; Huff</b>			Lease <b>Cinco de Mayo</b>		Well No. <b>3</b>
Unit Letter <b>D</b>	Section <b>24</b>	Township <b>18 South</b>	Range <b>32 East</b>	County <b>Lea</b>	
Actual Footage Location of Well: <b>990</b> feet from the <b>North</b> line and <b>990</b> feet from the <b>West</b> line					
Ground Level Elev. <b>3797'</b>	Producing Formation <b>Gravel Sand</b>		Pool <b>Shinnery-Queen</b>	Dedicated Acreage: <b>4.3</b>	

1. Outline the acreage dedicated to the subject well by colored pencil or hachure marks on the plat below.
2. If more than one lease is dedicated to the well, outline each and identify the ownership thereof (both as to working interest and royalty).
3. If more than one lease of different ownership is dedicated to the well, have the interests of all owners been consolidated by communitization, unitization, force-pooling, etc?

☐ Yes ☐ No If answer is "yes," type of consolidation \_\_\_\_\_

If answer is "no," list the owners and tract descriptions which have actually been consolidated. (Use reverse side of this form if necessary.) \_\_\_\_\_

No allowable will be assigned to the well until all interests have been consolidated (by communitization, unitization, forced-pooling, or otherwise) or until a non-standard unit, eliminating such interests, has been approved by the Commission.

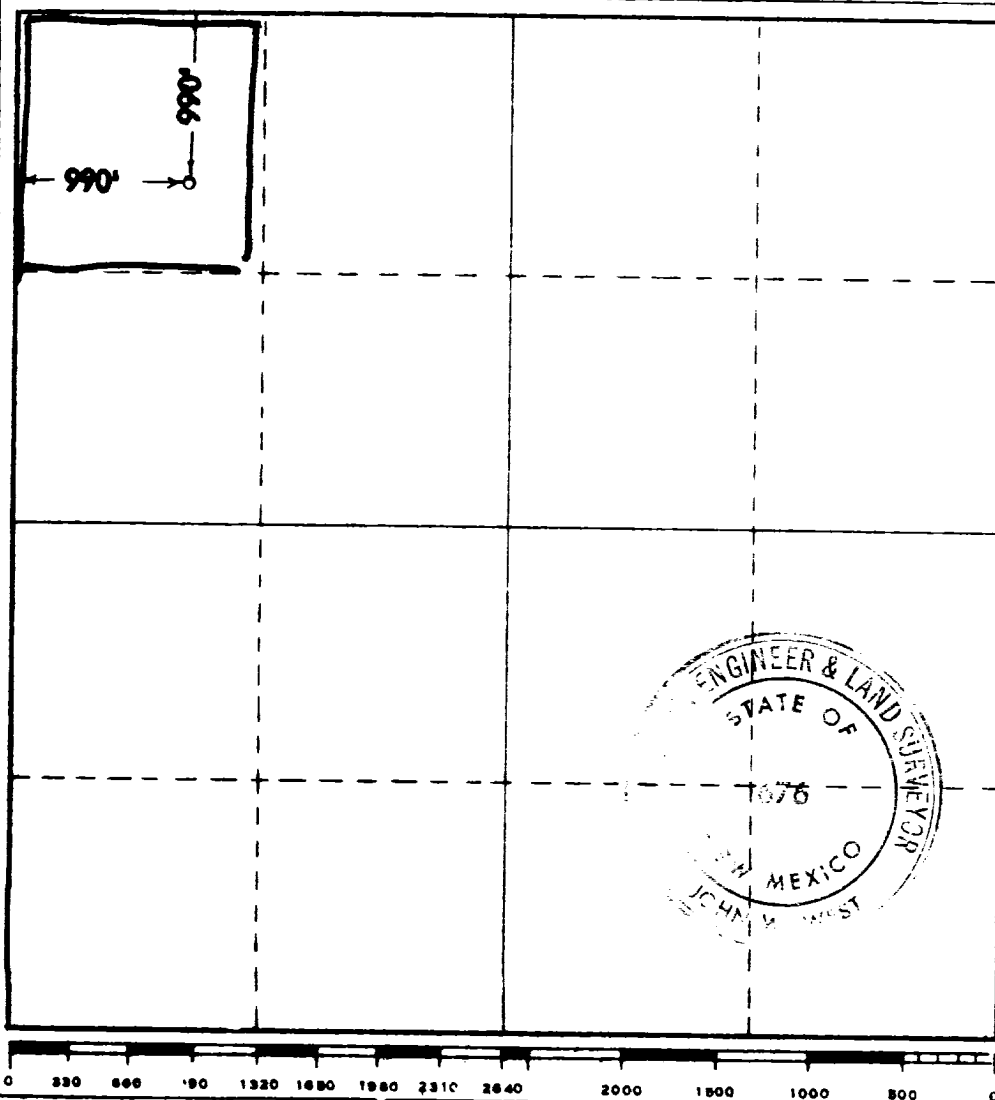

CERTIFICATION

I hereby certify that the information contained herein is true and complete to the best of my knowledge and belief.

*John B. Burleson*  
**John B. Burleson**

**Partner**

**Burleson and Huff**

Date **July 19, 1974**

I hereby certify that the well location shown on this plat was plotted from field notes of actual surveys made by me or under my supervision, and that the same is true and correct to the best of my knowledge and belief.

Date Surveyed

**July 26, 1974**

Registered Professional Engineer and/or Land Surveyor

*John M. West*  
Certificate No. **676**