

U

NO. OF COPIES RECEIVED	
DISTRIBUTION	
SANTA FE	
FILE	
U.S.G.S.	
LAND OFFICE	
OPERATOR	

NEW MEXICO OIL CONSERVATION COMMISSION

Form C-101  
Revised 1-1-65 *3-125-7400*

5A. Indicate Type of Lease STATE <input checked="" type="checkbox"/> FEE <input type="checkbox"/>	
5. State Oil & Gas Lease No. <b>K-5029</b>	
7. Unit Agreement Name <b>Com</b>	
8. Farm or Lease Name <b>State-Com</b>	
9. Well No. <b>1</b>	
10. Field and Pool <b>Vacuum Abo</b>	
12. County <b>Lea</b>	
19. Proposed Depth <b>9,000'</b>	19A. Formation <b>Vacuum Abo</b>
20. Rotary or C.T. <b>Rotary</b>	
21. Elevations (Show whether DF, RT, etc.) <b>4045.3'</b>	21A. Kind & Status Plug. Bond <b>Blanket</b>
21B. Drilling Contractor <b>KKA Drilling Company</b>	
22. Approx. Date Work will start <b>4/14/75</b>	

APPLICATION FOR PERMIT TO DRILL, DEEPEN, OR PLUG BACK	
1a. Type of Work b. Type of Well OIL WELL <input checked="" type="checkbox"/> GAS WELL <input type="checkbox"/> OTHER <input type="checkbox"/> DRILL <input checked="" type="checkbox"/> DEEPEN <input type="checkbox"/> PLUG BACK <input type="checkbox"/> SINGLE ZONE <input type="checkbox"/> MULTIPLE ZONE <input type="checkbox"/>	
2. Name of Operator <b>K. K. Amini</b>	
3. Address of Operator <b>204 Gulf Building, Midland, Texas 79701</b>	
4. Location of Well UNIT LETTER <b>H</b> LOCATED <b>460</b> FEET FROM THE <b>East</b> LINE AND <b>1980</b> FEET FROM THE <b>North</b> LINE OF SEC. <b>2</b> TWP. <b>17S</b> RGE. <b>34E</b> NMPM	
23.	

PROPOSED CASING AND CEMENT PROGRAM

SIZE OF HOLE	SIZE OF CASING	WEIGHT PER FOOT	SETTING DEPTH	SACKS OF CEMENT	EST. TOP
11"	8-5/8"	28#	2000'	400 sks.	circulate
7-7/8"	4-1/2"	11.60 & 10.50#	9000'	300 sks.	7000'

APPROVAL VALID  
EXPIRES UNLESS  
RENEWED, EXPIRES 7/15/75

IN ABOVE SPACE DESCRIBE PROPOSED PROGRAM: IF PROPOSAL IS TO DEEPEN OR PLUG BACK, GIVE DATA ON PRESENT PRODUCTIVE ZONE AND PROPOSED NEW PRODUCTIVE ZONE. GIVE BLOWOUT PREVENTER PROGRAM, IF ANY.

I hereby certify that the information above is true and complete to the best of my knowledge and belief.

Signed <i>[Signature]</i>	Title <b>Comptroller</b>	Date <b>April 4, 1975</b>
(This space for State Use)		
<b>SUPERVISOR DISTRICT 1</b>		
APPROVED BY <i>[Signature]</i>	TITLE	DATE
CONDITIONS OF APPROVAL, IF ANY:		

RECEIVED

APR 7 1973

OIL CONSERVATION COMM.  
LEEDS, N. H.

NEW MEXICO OIL CONSERVATION COMMISSION  
WELL LOCATION AND ACREAGE DEDICATION PLAT

Form C-102  
Supersedes C-128  
Effective 12-55

All distances must be from the outer boundaries of the Section

K. K. Amini			Lease		State- Com.		Well No. 1	
Section		Township		Range		County		
H 2		17 South		34 East		Lea		
Acreage of land in Section of Well								
460		feet from the East line and		1980		feet from the North line		
4045.3		Producing Production		Pool		Dedicated Acreage		Acres

- Outline the acreage dedicated to the subject well by colored pencil or hatchure marks on the plat below.
- If more than one lease is dedicated to the well, outline each and identify the ownership thereof (both as to working interest and royalty).
- If more than one lease of different ownership is dedicated to the well, have the interests of all owners been consolidated by communitization, unitization, force-pooling, etc?

☐ Yes ☒ No If answer is "yes," type of consolidation \_\_\_\_\_

If answer is "no," list the owners and tract descriptions which have actually been consolidated. (Use reverse side of this form if necessary.) See back of sheet

No allowable will be assigned to the well until all interests have been consolidated (by communitization, unitization, forced-pooling, or otherwise) or until a non-standard unit, eliminating such interests, has been approved by the Commission.

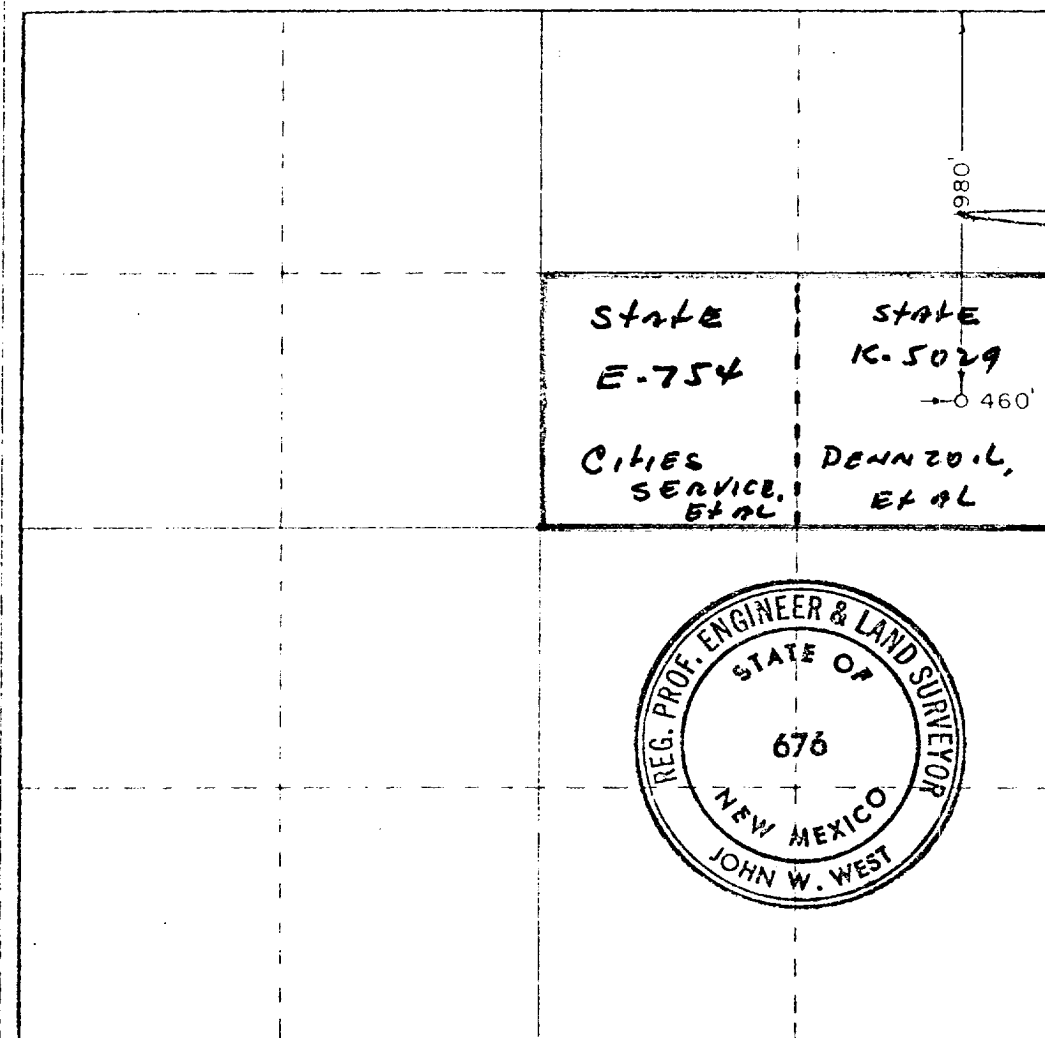

CERTIFICATION

I hereby certify that the information contained herein is true and complete to the best of my knowledge and belief.

*[Signature]*

Name  
Position  
K. K. Amini  
Date  
April 4, 1975

I hereby certify that the well location shown on this plat was plotted from field notes of actual surveys made by me or under my supervision, and that the same is true and correct to the best of my knowledge and belief.

Date Surveyed  
March 6, 1975  
Registered Professional Engineer  
and Land Surveyor

*[Signature]*  
Certificate No.

676

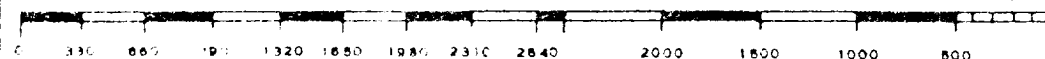

3. If production is obtained a communitization agreement will be filed covering the S/2 of NE/4.

RECEIVED

APR 7 1978

U.S. DEPARTMENT OF COMMERCE  
BUREAU OF ECONOMIC ANALYSIS

NO. OF COPIES RECEIVED	
DISTRIBUTION	
SANTA FE	
FILE	
U.S.G.S.	
LAND OFFICE	
OPERATOR	

# NEW MEXICO OIL CONSERVATION COMMISSION

Form C-103  
Supersedes Old  
C-102 and C-103  
Effective 1-1-65

5a. Indicate Type of Lease	
State <input checked="" type="checkbox"/>	Fee <input type="checkbox"/>
5. State Oil & Gas Lease No. K-5029	

## SUNDRY NOTICES AND REPORTS ON WELLS (DO NOT USE THIS FORM FOR PROPOSALS TO DRILL OR TO DEEPEN OR PLUG BACK TO A DIFFERENT RESERVOIR. USE "APPLICATION FOR PERMIT -" (FORM C-101) FOR SUCH PROPOSALS.)

1. OIL WELL <input checked="" type="checkbox"/> GAS WELL <input type="checkbox"/> OTHER- <input type="checkbox"/>		7. Unit Agreement Name Com.
2. Name of Operator K. K. Amini		8. Farm or Lease Name State Com.
3. Address of Operator 204 Gulf Building, Midland, Texas 79701		9. Well No. 1 1
4. Location of Well UNIT LETTER <u>H</u> <u>460</u> FEET FROM THE <u>East</u> LINE AND <u>1980</u> FEET FROM THE <u>North</u> LINE, SECTION <u>2</u> TOWNSHIP <u>17S</u> RANGE <u>34E</u> NMPM.		10. Field and Pool, or Wildcat Vacuum Abo
15. Elevation (Show whether DF, RT, GR, etc.) 4045.3' GL		12. County Lea

## Check Appropriate Box To Indicate Nature of Notice, Report or Other Data NOTICE OF INTENTION TO: SUBSEQUENT REPORT OF:

PERFORM REMEDIAL WORK <input type="checkbox"/>	PLUG AND ABANDON <input type="checkbox"/>	REMEDIAL WORK <input type="checkbox"/>	ALTERING CASING <input type="checkbox"/>
TEMPORARILY ABANDON <input type="checkbox"/>	CHANGE PLANS <input type="checkbox"/>	COMMENCE DRILLING OPNS. <input type="checkbox"/>	PLUG AND ABANDONMENT <input type="checkbox"/>
PULL OR ALTER CASING <input type="checkbox"/>	OTHER <input type="checkbox"/>	CASING TEST AND CEMENT JOB <input type="checkbox"/>	OTHER <input type="checkbox"/>

17. Describe Proposed or Completed Operations (Clearly state all pertinent details, and give pertinent dates, including estimated date of starting any proposed work) SEE RULE 1103.

Proposed Blowout Equipment.

0 - 2000' - No blowout equipment. - Surface Hole

2000' - 8800' T.D. - 10" Double Shaffer w/blind rams & pipe rams. Hydraulic closing unit.

18. I hereby certify that the information above is true and complete to the best of my knowledge and belief.

SIGNED Paul Sims TITLE Production Superintendent DATE April 8, 1975

APPROVED BY Joe D. Ramey TITLE Director DATE APR 14 1975  
CONDITIONS OF APPROVAL, IF ANY:

RECEIVED

APR 11 1968  
U.S. DEPARTMENT OF COMMERCE  
WASHINGTON, D. C.

177